

**ELEVATION - PANELS 18 THRU 20**

(Looking at Front Face)  
(Dimensions Measured along Front Face)

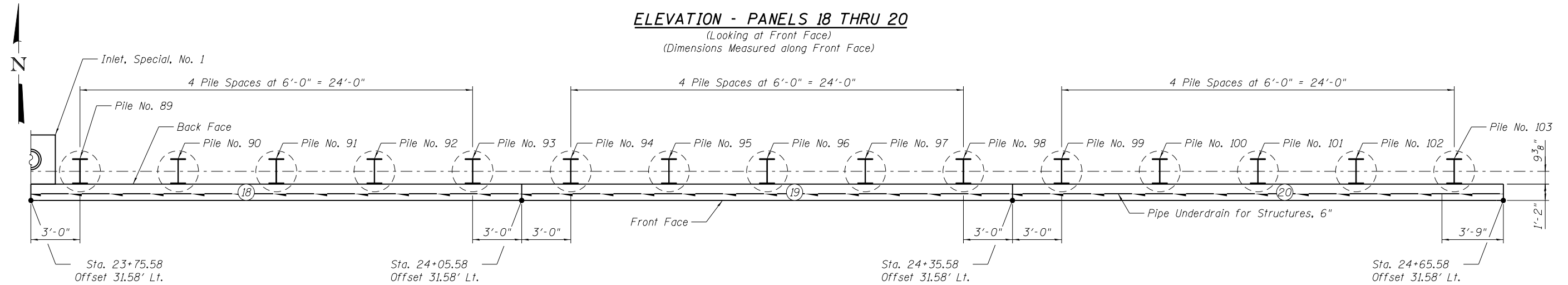

**PLAN**

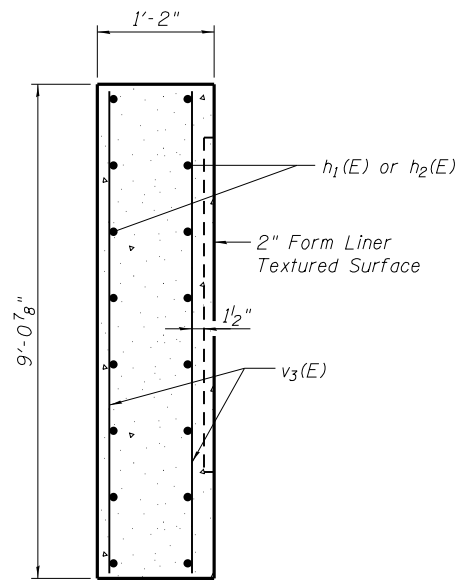

**SECTION THRU  
CIP FACING**

**MINIMUM BAR LAP**  
#5 bar = 3'-3"

**LEGEND**

⊕ = Panel Number  
E.F. = Each Face

Notes:  
For Top of Pile Elevations & Pile Tip Elevations,  
see Soldier Pile Summary on Sheet SD-3 of SD-18.  
Space reinforcement to miss shear studs.

**BAR LIST**

Bar	No.	Size	Length	Shape
h <sub>1</sub> (E)	20	#5	29'-9"	—
h <sub>2</sub> (E)	40	#5	33'-3"	—
v <sub>3</sub> (E)	180	#5	8'-8"	—

(Sheet 7 of 10)