

Benchmark: "O" in the word "open" on Fire Hydrant
Sta. 294+65.77, (L. Rte 5) Offset 108.75' Rt., Elev. 579.42

Existing Structure: None.

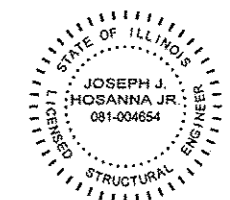
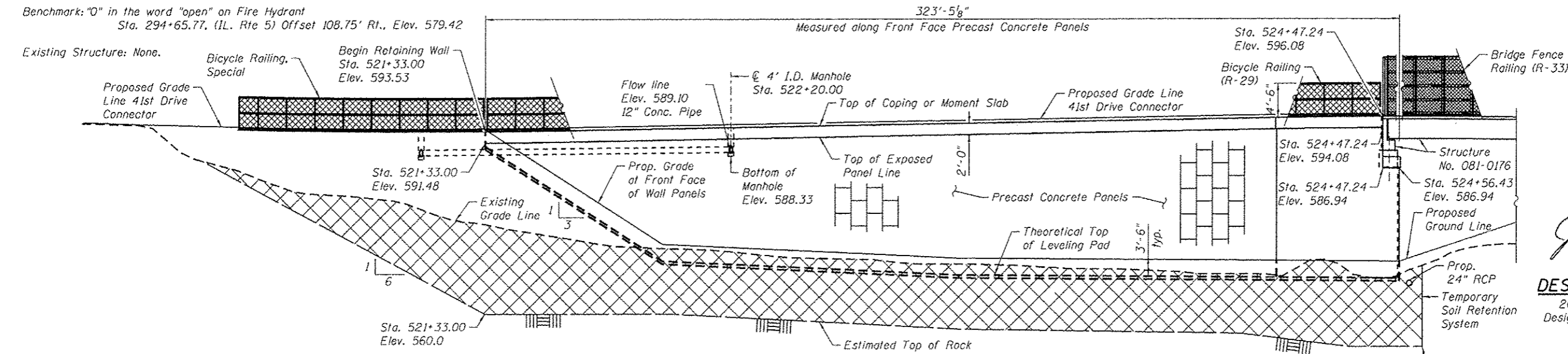

DATE: 3/11/2013
SEAL EXPIRES: 11/30/2014

Joseph J. Hosanna Jr.

DESIGN SPECIFICATIONS

2012 AASHTO LRFD Bridge Design Specifications, 6th Edition with 2012 Interims

DESIGN STRESSES

FIELD UNITS

f'c = 3,500 psi
fy = 60,000 psi (Reinforcement)

PRECAST UNITS

f'c = 4,500 psi (Precast Face Panels)

NOTES:

- For Sections A-A & G-G see Sheet SA-3. For Section H-H & I-I see Sheet SA-10.
- Offsets are measured from the centerline of 41st Drive Connector to the front face of wall.
- Ashlar stone formliner to be used on MSE wall panels.

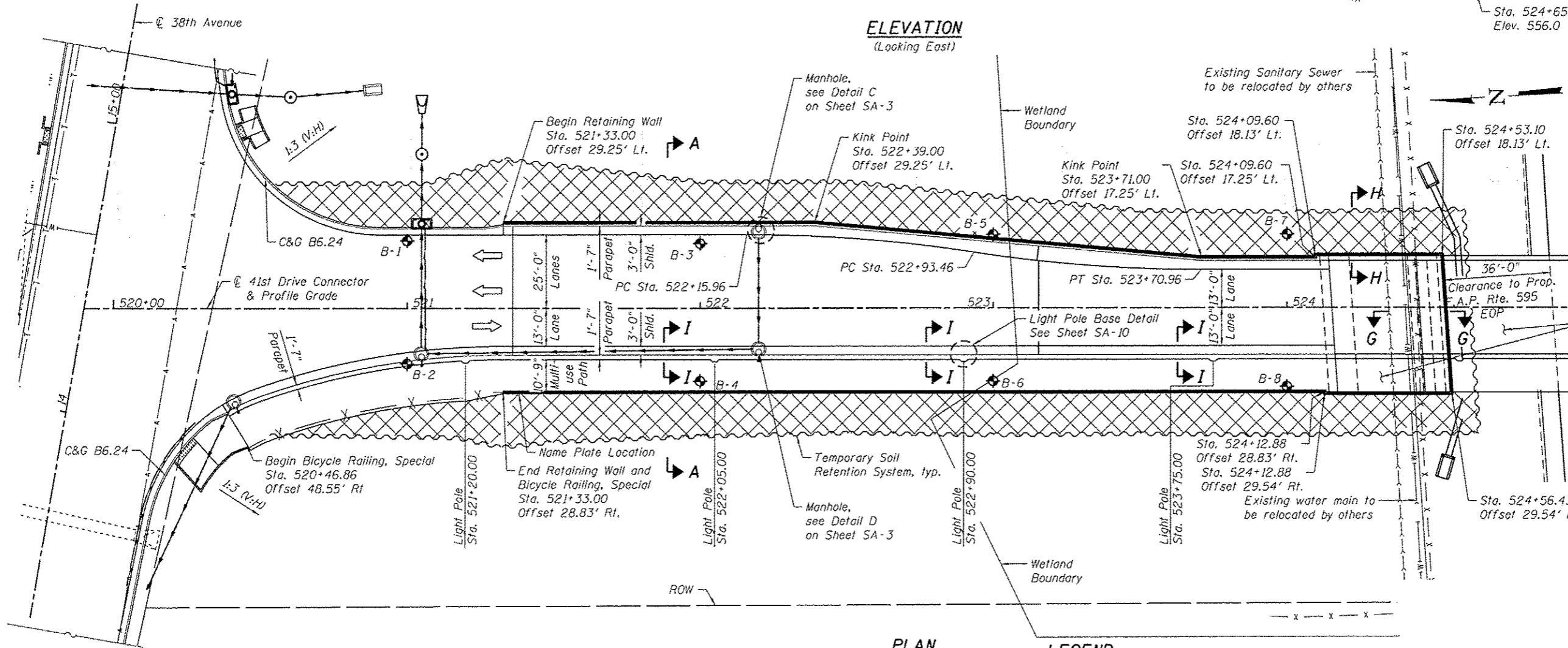

ELEVATION
(Looking East)

PLAN

LEGEND:

- Soil Boring
- Removal and Disposal of Unsuitable Materials. Rockfill is to be placed up to the top of existing ground or bottom of MSE Wall leveling pad, whichever is lower. See Roadway plans for Removal and Disposal of Unsuitable Materials and Rock Fill quantities.

* Cross hatching not shown under roadway and path for clarity.

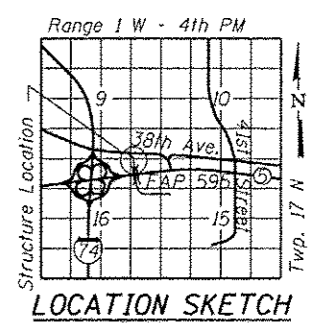

APPROVED
For Structural Adequacy Only

De Carl Pappas
Engineer of Bridges & Structures

GENERAL PLAN & ELEVATION
F.A.P. RTE. 595 - SEC. (142-1)R-1 AND 142-1HB
ROCK ISLAND COUNTY
STATION 521+33.00 TO 524+56.43
STRUCTURE NO. 081-7002



USER NAME: rdanley	DESIGNED: APD	REVISIONS:
PLOT SCALE: 40:1 1" = 40'	CHECKED: BWS	REVISIONS:
PLOT DATE: 3/21/2013	DRAWN: RD	REVISIONS:
	CHECKED: JJH	REVISIONS:

STATE OF ILLINOIS
DEPARTMENT OF TRANSPORTATION

SHEET NO. SA-1 OF SA-16 SHEETS

F.A.P. RTE.	SECTION	COUNTY	TOTAL SHEETS	SHEET NO.
595	(142-1)R-1 AND 142-1HB	ROCK ISLAND	507	327
				CONTRACT NO. 64884

ILLINOIS FED. AID PROJECT