

Benchmark: Fire Hydrant, F.A.P. 595 Sta. 294+65.77, 108.75' Rt. Elev. 579.42

Existing Structure: No Structure.

25 Spaces of 8'-0" = 200'-0"

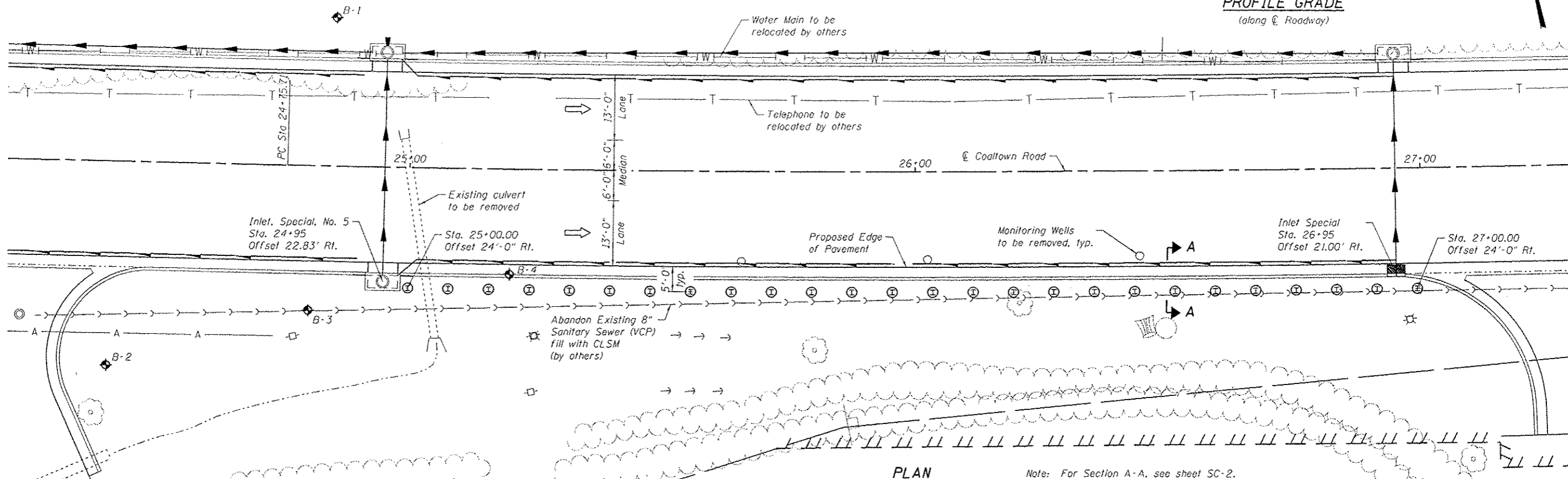
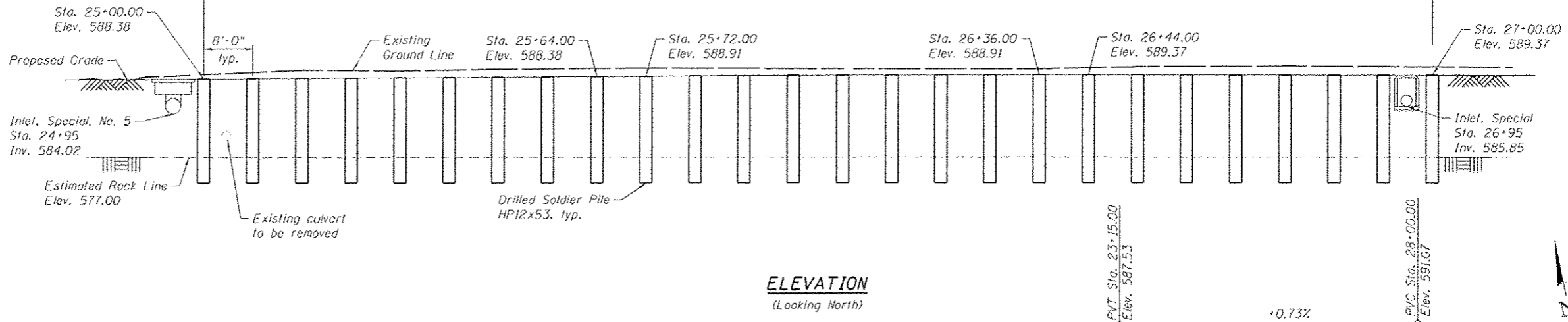

CURVE DATA
(Coaltown Road)
Δ = 7° 11' 46" (LT)
D = 1° 00' 00"
T = 360.27'
L = 719.60'
E = 11.32'
R = 5,729.58'
P.C. = Sta. 24+75.71
P.T. = Sta. 31+95.31
P.I. = Sta. 28+35.98

LEGEND:
--- Existing Underground Sanitary Sewer
--- A --- Existing Aerial Line
--- T --- Existing Underground Telephone Line
--- W --- Existing Underground Water Main
⊙ Proposed HP12x53 Soldier Pile

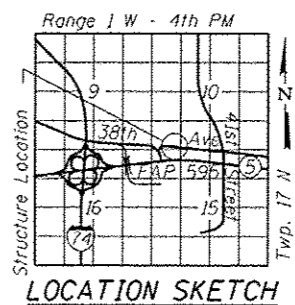

GENERAL PLAN & ELEVATION
COALTOWN ROAD
ILLINOIS F.A.P. RTE 595
SECTION (142-11R & 142-11B)
ROCK ISLAND COUNTY
STATION 25+00.00 TO 27+00.00
STRUCTURE NO. 081-P003

DESIGN SPECIFICATIONS
2012 AASHTO LRFD Bridge
Design Specifications, 6th Edition
with 2012 Interims

DESIGN STRESSES
FIELD UNITS
f'c = 4,000 psi
fy = 36,000 psi (M270 Grade 36)

K:\PROJ\02223131\02\CONTRACT\Design\Structure\CAD\Soldier-Pile_Wall_Pile-Plan.dwg



USER NAME: j-donley	DESIGNED: BWS	REVISED: Addendum 1 8/15/2013
PLOT SCALE: 1/8" = 1'-0"	CHECKED: JWH	REVISED:
PLOT DATE: 8/19/2013	DRAWN: RD	REVISED:
	CHECKED: JWH	REVISED:

STATE OF ILLINOIS
DEPARTMENT OF TRANSPORTATION

SHEET NO. SC-1 OF SC-4 SHEETS

F.A.P. RTE. 595	SECTION (142-11R & 142-11B)	COUNTY ROCK ISLAND	TOTAL SHEETS 507	SHEET NO. 363A
			CONTRACT NO. 64884	

ILLINOIS FED. AID PROJECT