

Bench Mark: Fire Hydrant on IL Rte. 5 at Sta. 294+65.77, 108.75' RT, Elev. 579.42.

Existing Structure: None

850'-0" Soldier Pile and Lagging Wall

28 spaces of 30'-0" = 840'-0"

Construction Joint Spacing

Expansion Joint Spacing

DESIGN SPECIFICATIONS

2012 AASHTO LRFD Bridge Design Specifications, 6th Edition

DESIGN STRESSES

FIELD UNITS
 f'c = 3,500 psi
 fy = 60,000 psi (Reinforcement)
 fy = 50,000 psi (M270 Grade 50)

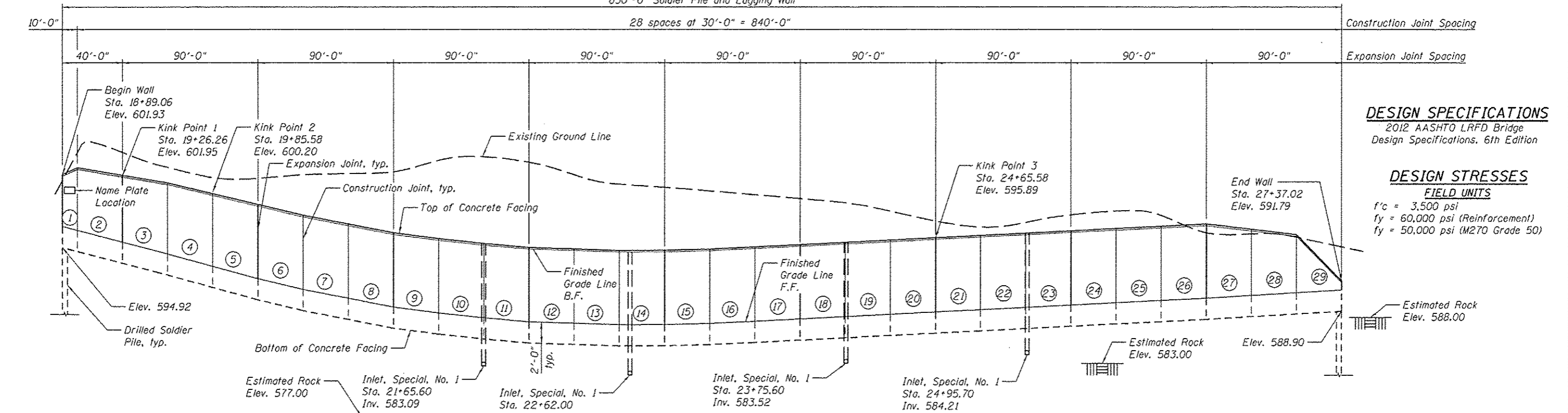

ELEVATION

(Looking North at Front Face of Wall)
 (Dimensions measured along front face of wall)

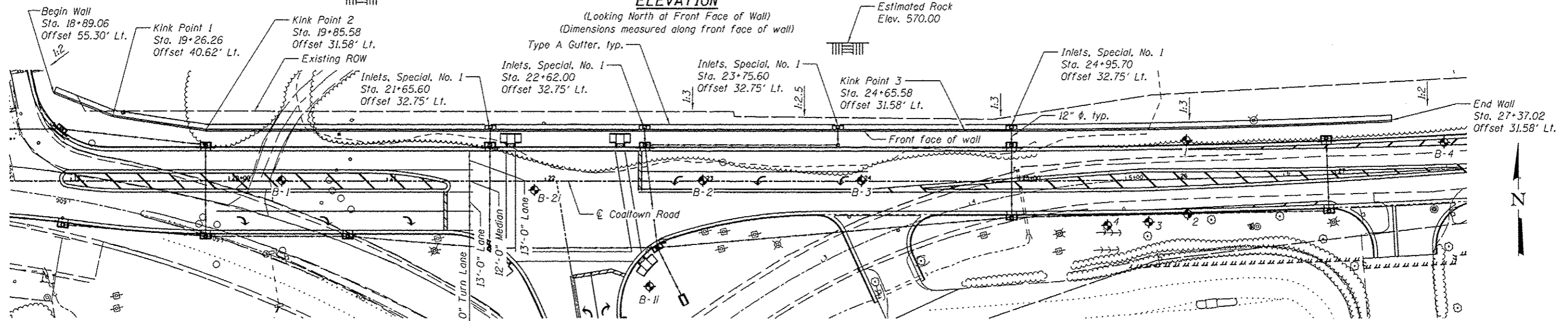

PLAN

INDEX OF SHEETS

- SD-1. General Plan and Elevation
- SD-2. General Data
- SD-3. Soldier Pile Details
- SD-4. Drainage Details
- SD-5 thru SD-14. Concrete Facing
- SD-15 thru SD-18. Soil Borings

Note:

Wall offsets are measured from the ϵ of proposed Coaltown Road to the front face of the wall. The installation of the proposed water main in front of the retaining wall and the temporary soil retention system required to brace the excavation and the retaining wall, will be performed in a separate contract and paid for by others.

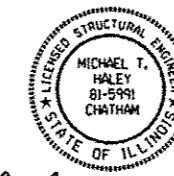

Michael T. Haley 8-14-13 Date

Michael T. Haley
 Licensed Structural Engineer
 State of Illinois No. 81-5991
 Expires 11/30/2014

GENERAL PLAN AND ELEVATION

COALTOWN ROAD

FAP 595 - SECTION (142-1JR & 142-1HB)

ROCK ISLAND COUNTY

STA. 18+89.06 TO STA. 27+37.02

S.N. 081-PO02

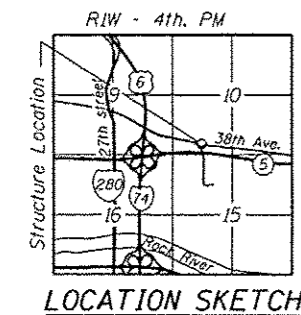

LEGEND

- ⊙ Panel Number
- ◆ Soil Boring Location
- Underground Water Line
- - - - - Underground Sanitary Sewer
- T - - - - - Underground Telephone Line



USER NAME :	DESIGNED - TBP	REVISED ADDENDUM 1	8/15/2013
FILE NAME :	CHECKED - VPT	REVISED	
PLOT SCALE :	DRAWN - A.J.F	REVISED	
PLOT DATE :	CHECKED - MTH	REVISED	

STATE OF ILLINOIS
 DEPARTMENT OF TRANSPORTATION

GENERAL PLAN AND ELEVATION
 RETAINING WALL - STA. 18+89.06 TO STA. 27+37.02

SD-1 OF SD-18

F.A.P. RTE.	SECTION	COUNTY	TOTAL SHEETS	SHEET NO.
595	(142-1JR & 142-1HB)	ROCK ISLAND	507	363E
CONTRACT NO. 64B84				
ILLINOIS FED. AID PROJECT				