

Notes:  
 See sheet 17 of 43 for Sections H-H & L-L and View J-J.  
 $a_6(E)$  and  $a_7(E)$  bar spacings measured along Local Tangent (W Appr.)  
 See sheet 15 of 43 for View G-G.

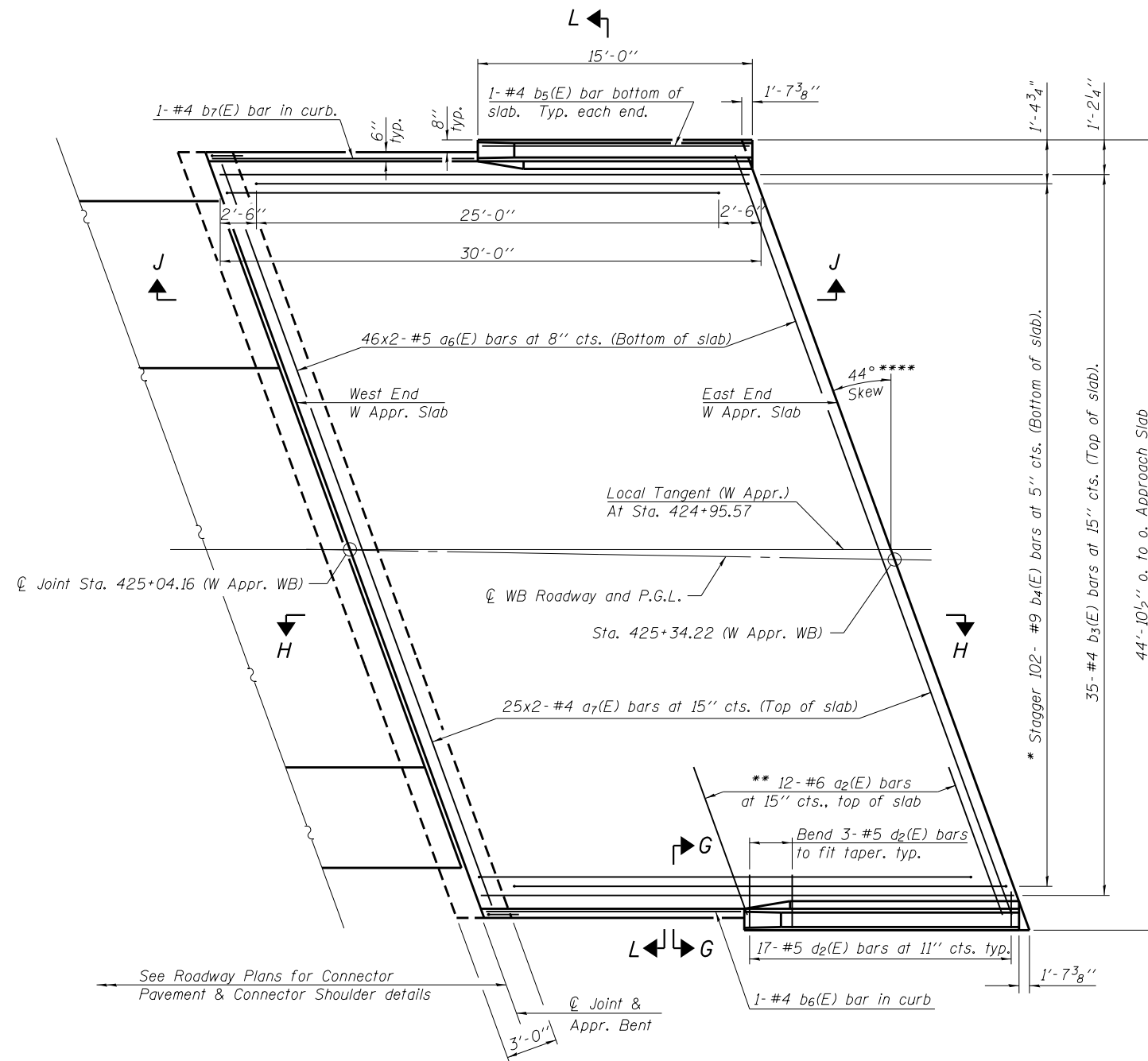

**PLAN**

\* Tilt #9  $b_4(E)$  bars as required to maintain clearance.  
 \*\* Space between  $a_7(E)$  bars, typ. each parapet.  
 \*\*\*\* With respect to Local Tangent (W Appr.) at Sta. 424+95.57

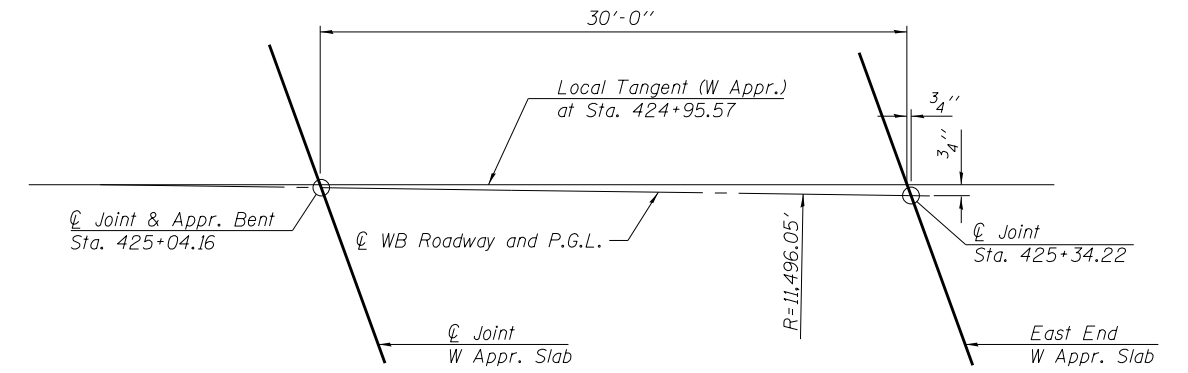
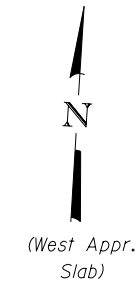

**OFFSET SKETCH**

(Sheet 2 of 3)

FILE NAME = 0060184\_0185\_66998-16-W\_Appr\_SlabWB.dgn  
 MODEL = Default  
 PLOT DRIVER = V8\_PDF\_1x17.pltcf9



USER NAME = tfray	DESIGNED - SCD	REVISED
FILE NAME =	CHECKED - DRB	REVISED
PLOT SCALE = 480:0.0000 ' / ft.	DRAWN - TKW	REVISED
PLOT DATE = 7/29/2013	CHECKED - SCD	REVISED

STATE OF ILLINOIS  
 DEPARTMENT OF TRANSPORTATION

WEST BRIDGE APPROACH SLAB DETAILS  
 STRUCTURE NO. 006-0185 (W.B.)

SHEET NO. 16 OF 43 SHEETS

F.A.I. RTE.	SECTION	COUNTY	TOTAL SHEETS	SHEET NO.
80	(06-2)BR-3,4	BUREAU	133	60
CONTRACT NO. 66998				

ILLINOIS FED. AID PROJECT