

Notes:
 See sheet 20 of 43 for Sections C-C & D-D and View E-E.
 $a_6(E)$ and $a_7(E)$ bar spacings measured along Local Tangent (E. Appr.).
 The joint opening shall be determined per Article 520.04 except that on jointless structures, the distance described as the bridge length between the nearest fixed bearings each way from the joint shall be taken as half the bridge length plus the approach slab length. The minimum dimension shall be $1\frac{1}{2}$ " for installation purposes.

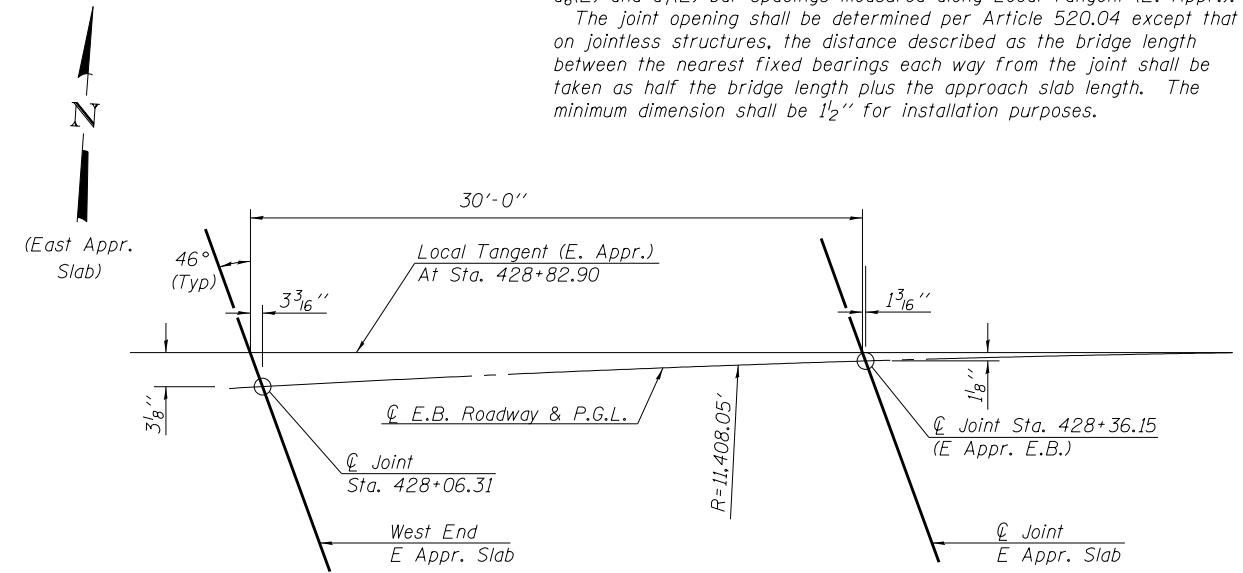

OFFSET SKETCH

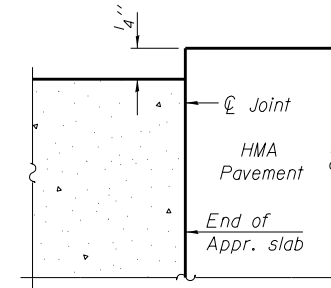

**FLEXIBLE PAVEMENT
 DETAIL A**

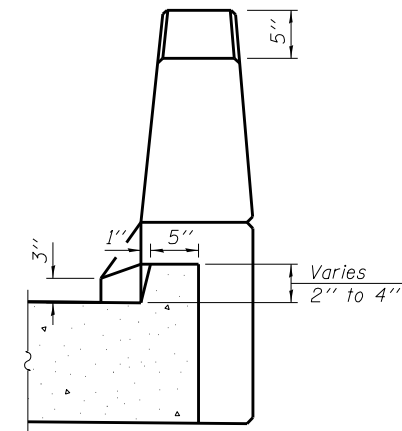

VIEW B-B

(Sheet 1 of 3)

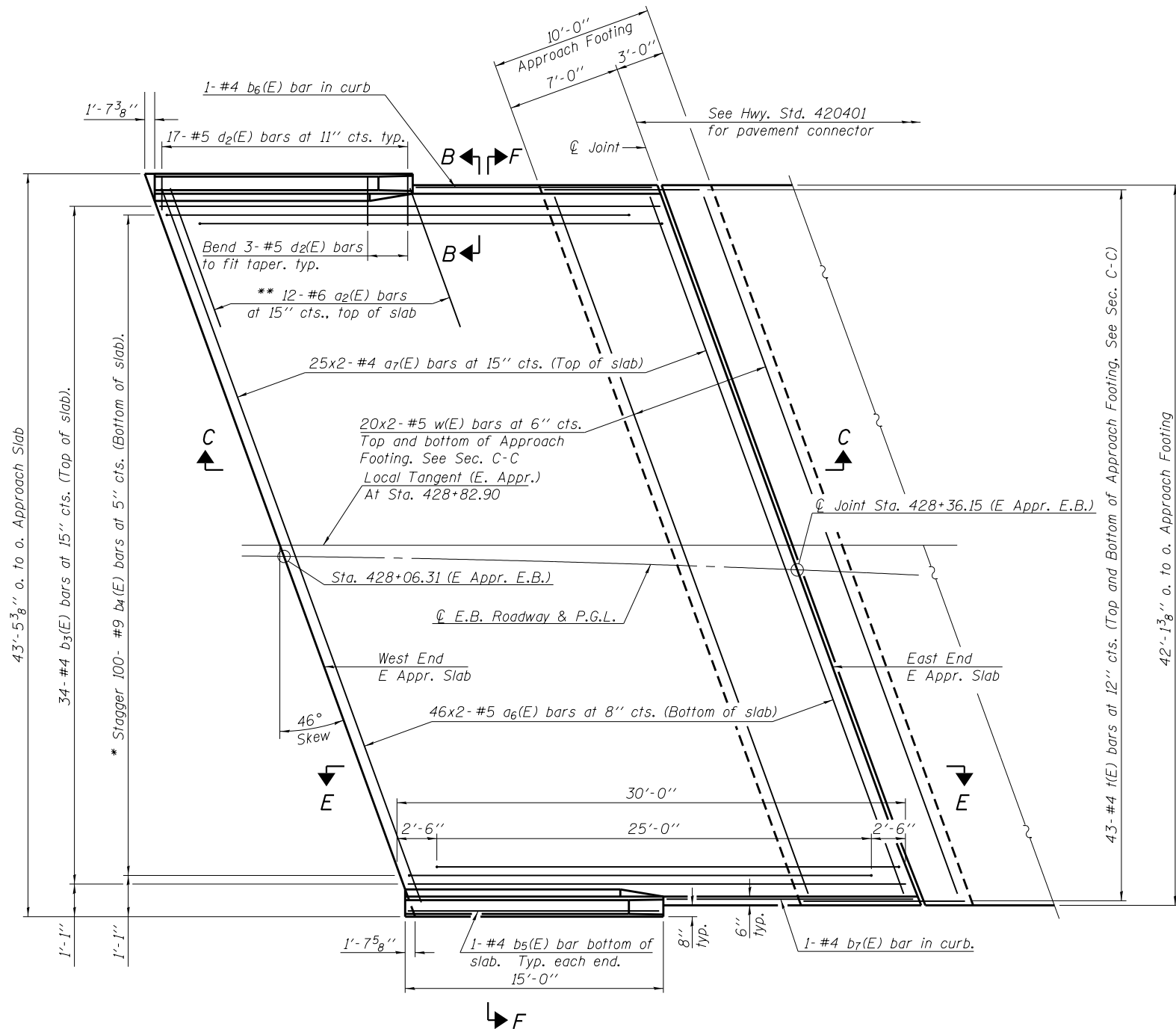

PLAN

* Tilt #9 b4(E) bars as required to maintain clearance.
 ** Space between $a_7(E)$ bars, typ. each parapet.

FILE NAME = 0060184_0185_66998-18-E_Appr-SlabEB.dgn
 MODEL = Default
 PLOT DRIVER = V8_PDF_11x17.pltcf9



USER NAME = tfray	DESIGNED - SCD	REVISED
FILE NAME =	CHECKED - DRB	REVISED
PLOT SCALE = 480:0.0000 ' / ft.	DRAWN - TKW	REVISED
PLOT DATE = 7/29/2013	CHECKED - SCD	REVISED

**STATE OF ILLINOIS
 DEPARTMENT OF TRANSPORTATION**

**EAST BRIDGE APPROACH SLAB DETAILS
 STRUCTURE NO. 006-0184 (E.B.)**

SHEET NO. 18 OF 43 SHEETS

F.A.I RTE.	SECTION	COUNTY	TOTAL SHEETS	SHEET NO.
80	(06-2)BR-3,4	BUREAU	133	62
CONTRACT NO. 66998				

ILLINOIS FED. AID PROJECT