

**LEGEND**

- DIRECTION INDICATOR BARRICADE WITH STEADY BURN MONDIRECTIONAL LIGHT
- TYPE II BARRICADE, DRUM OR VERTICAL BARRICADE WITH STEADY BURN BI-DIRECTIONAL LIGHT
- TYPE III BARRICADE WITH FLASHING LIGHT (2-EA.)
- DOUBLE VERTICAL PANEL
- WORK AREA
- ARROW BOARD
- CONSTRUCTION SIGN
- DIRECTION OF TRAFFIC
- TEMPORARY CONCRETE BARRIER
- IMPACT ATTENUATOR (TEMPORARY)
- FLASHING MONO-DIRECTIONAL LIGHT

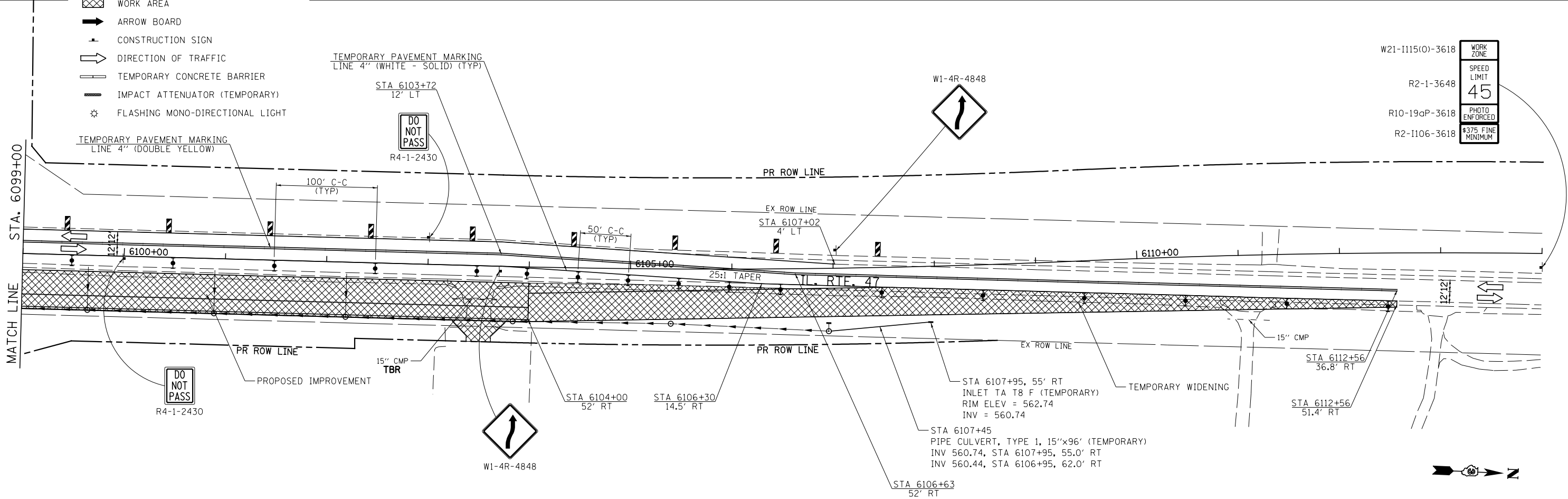

|   |                               |                  |           |   |   |                     |                             |                              |                    |                 |
|---|-------------------------------|------------------|-----------|---|---|---------------------|-----------------------------|------------------------------|--------------------|-----------------|
| FILE NAME =<br>V:\3195\66883 (South Section)\CADD Sheets\0366883-sh2-staging2-3.dgn | USER NAME = bdecreane         | DESIGNED - LDZ   | REVISED - | <b>STATE OF ILLINOIS<br/>DEPARTMENT OF TRANSPORTATION</b> | <b>IL. RTE. 47 STAGE 2 CONSTRUCTION &amp; TRAFFIC CONTROL</b> | F.A.P. R.T.E. = 326 | SECTION = (110)R, BR & BR-1 | COUNTY = GRUNDY              | TOTAL SHEETS = 644 | SHEET NO. = 156 |
|   | PLOT SCALE = 100.0000' / 1" = | CHECKED - DJD    | REVISED - |   |   | SCALE: 1"=50'       | SHEET 4 OF 4 SHEETS         | STA. 6084+00 TO STA. 6114+00 | CONTRACT NO. 66883 |                 |
| SHT_DOUBLE PLAN   | PLOT DATE = 8/6/2013          | DATE = 7/15/2013 | REVISED - | ILLINOIS FED. AID PROJECT                                 |   |                     |                             |                              |                    |                 |