

**LEGEND**

- DIRECTION INDICATOR BARRICADE WITH STEADY BURN MONODIRECTIONAL LIGHT
- TYPE II BARRICADE, DRUM OR VERTICAL BARRICADE WITH STEADY BURN BI-DIRECTIONAL LIGHT
- TYPE III BARRICADE WITH FLASHING LIGHT (2-EA.)
- DOUBLE VERTICAL PANEL
- WORK AREA
- ARROW BOARD
- CONSTRUCTION SIGN
- DIRECTION OF TRAFFIC
- TEMPORARY CONCRETE BARRIER
- IMPACT ATTENUATOR (TEMPORARY)
- FLASHING MONO-DIRECTIONAL LIGHT

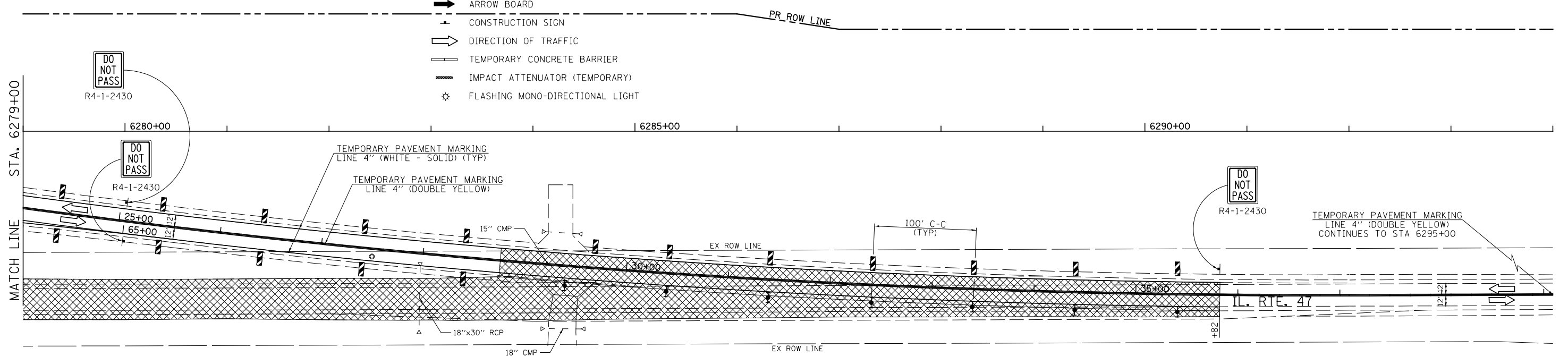

FILE NAME =	USER NAME = bdecreene	DESIGNED - LDZ	REVISED -
V:\3195\66883 (South Section)\CADD Sheets\0366883-sht-staging4-7.dgn		DRAWN - SRH/RMD	REVISED -
	PLOT SCALE = 100.0000' / 1in.	CHECKED - DJD	REVISED -
SHT.DOUBLE.PLAN	PLOT DATE = 8/6/2013	DATE - 7/15/2013	REVISED -

**STATE OF ILLINOIS  
DEPARTMENT OF TRANSPORTATION**

**IL. RTE. 47 STAGE 4 CONSTRUCTION & TRAFFIC CONTROL**

SCALE: 1"=50' SHEET 7 OF 7 SHEETS STA. 6264+00 TO STA. 6294+00

F.A.P. RTE.	SECTION	COUNTY	TOTAL SHEETS	SHEET NO.
326	(110)R, BR & BR-1	KENDALL	644	184
CONTRACT NO. 66883				
ILLINOIS FED. AID PROJECT				