

**NOTES**

- SEE TYPICAL LANDSCAPING DETAILS FOR LOCATIONS OF SEEDING, MULCH, EROSION CONTROL BLANKET, AND SODDING

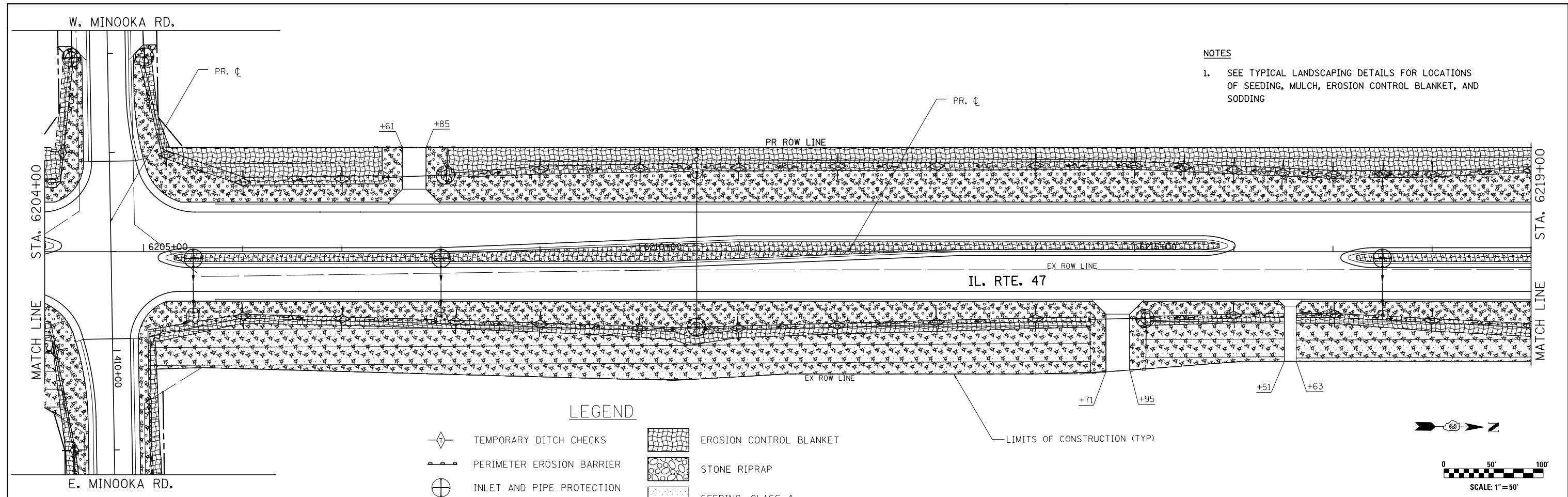

**LEGEND**

- TEMPORARY DITCH CHECKS
- PERIMETER EROSION BARRIER
- INLET AND PIPE PROTECTION
- SALT TOLERANT SODDING
- SEEDING, CLASS 2A
- EROSION CONTROL BLANKET
- STONE RIPRAP
- SEEDING, CLASS 4
- MULCH, METHOD 2

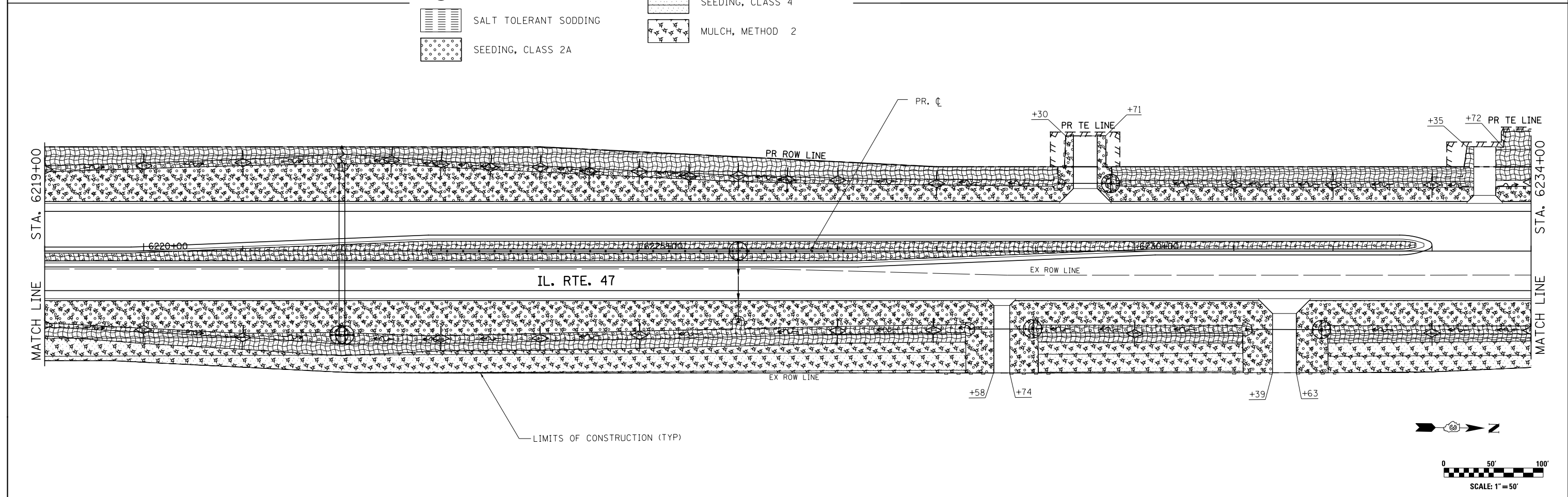

FILE NAME =	USER NAME = bdecreane	DESIGNED - BS	REVISED -
V:\3195\66883 (South Section)\CADD Sheets\0366883-sht-eros-07.dgn		DRAWN - BS	REVISED -
	PLOT SCALE = 100.0000' / in.	CHECKED - ST	REVISED -
SHT_DOUBLE_PLAN	PLOT DATE = 8/6/2013	DATE - 7/15/2013	REVISED -

**STATE OF ILLINOIS  
DEPARTMENT OF TRANSPORTATION**

<b>IL. RTE. 47 LANDSCAPING AND EROSION CONTROL PLANS</b>		
SCALE: 1"=50'	SHEET NO. 7 OF 13 SHEETS	STA. 6204+00 TO STA. 6234+00

F.A.P. RTE.	SECTION	COUNTY	TOTAL SHEETS	SHEET NO.
326	(110)R, BR & BR-1	GRUNDY	644	192
CONTRACT NO. 66B83				
ILLINOIS FED. AID PROJECT				