

DATE	
BY	
PLAN	SURVEYED
	PLOTTED
	NOTE BOOK
	NO.
	ALIGNED
	CHECKED
	CADD FILE NAME

DATE	
BY	
PROFILE	SURVEYED
	PLOTTED
	GRADES CHECKED
	NO.
	STRUCTURE
	NOTATIONS CHECKED

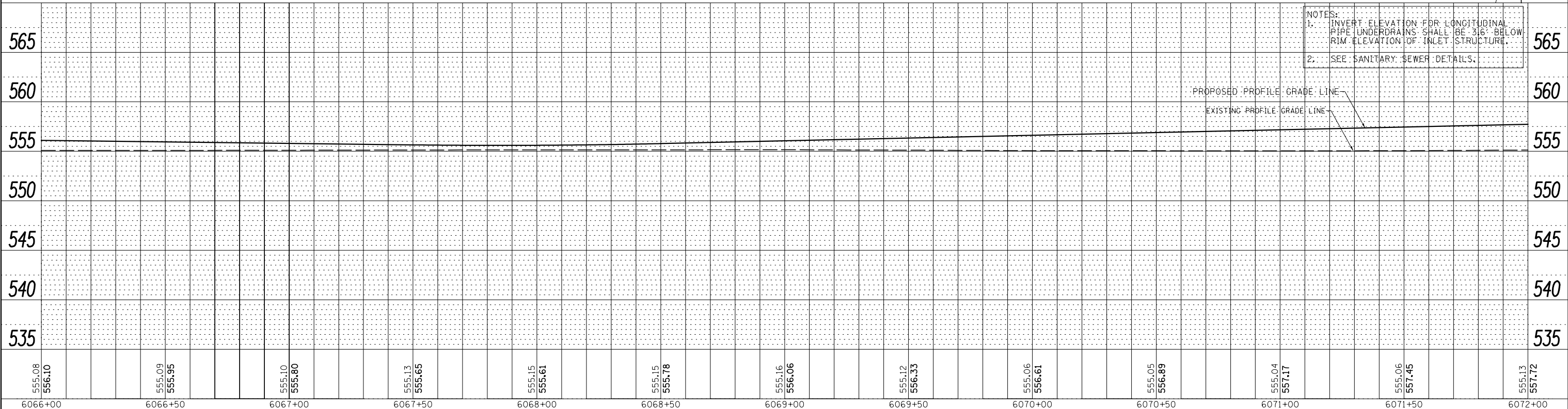
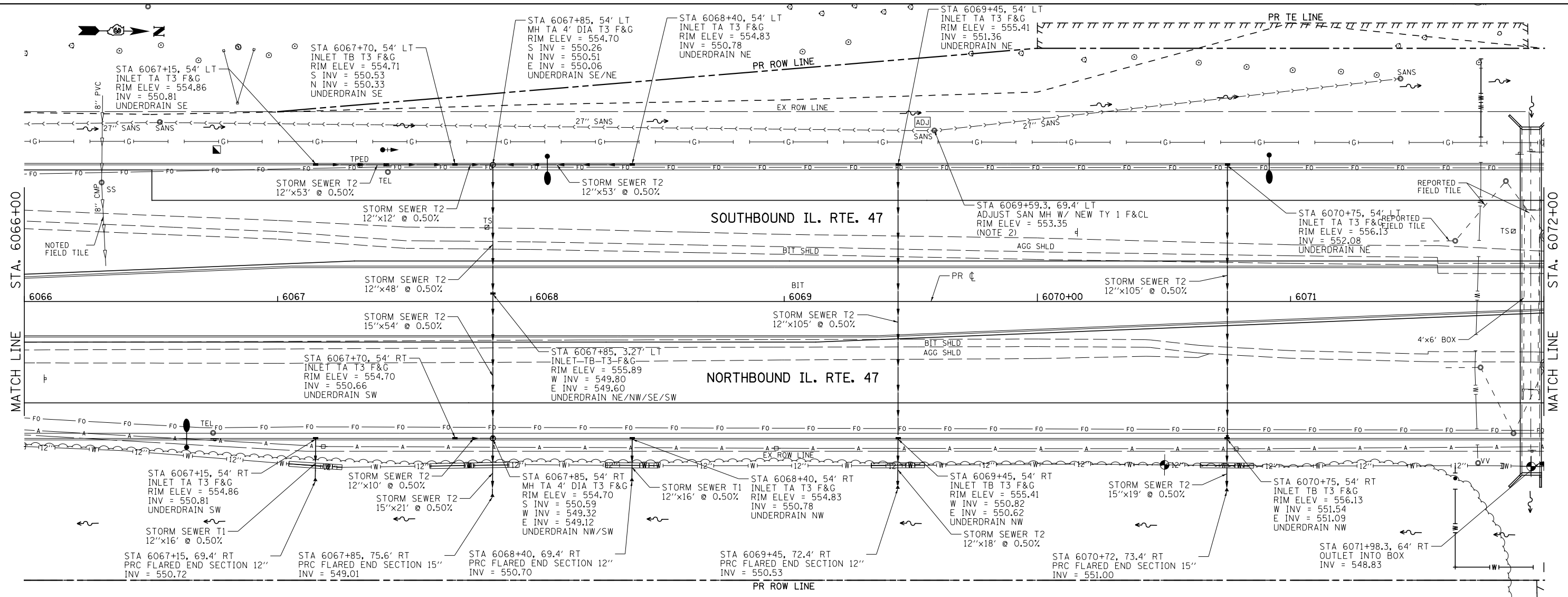

NOTES:  
 1. INVERT ELEVATION FOR LONGITUDINAL PIPE UNDERDRAINS SHALL BE 3/16" BELOW RIM ELEVATION OF INLET STRUCTURE.  
 2. SEE SANITARY SEWER DETAILS.

FILE NAME =	USER NAME = bdecreane	DESIGNED - LRS	REVISED -	<b>STATE OF ILLINOIS DEPARTMENT OF TRANSPORTATION</b>	<b>IL. RTE. 47 STORM SEWER AND UTILITIES PLAN &amp; PROFILE</b>	F.A.P. RTE.	SECTION	COUNTY	TOTAL SHEETS	SHEET NO.	
V:\3195\66883 (South Section)\CADD Sheets\3366883-sh-t-drain-8.dgn	DRAWN - SRH/RMD	REVISED -	326			(110)R, BR & BR-1	GRUNDY	644	206		
SHT_PLNPROF	PLOT SCALE = 40.0000' / in.	CHECKED - DJD	REVISED -			CONTRACT NO. 66883					
	PLOT DATE = 8/6/2013	DATE - 7/15/2013	REVISED -			ILLINOIS FED. AID PROJECT					

SCALE: H=20 V=5 SHEET 8 OF 35 SHEETS STA. 6066+00 TO STA. 6072+00