

GENERAL NOTES

Fasteners shall be ASTM A325 Type 1, mechanically galvanized bolts. Bolts 7/8 in. ϕ , holes 15/16 in. ϕ , unless otherwise noted.

Calculated weight of Structural Steel = 213,620 lbs. (Grade 50)
18,760 lbs. (Grade 36)

No field welding is permitted except as specified in the contract documents.

Reinforcement bars designated (E) shall be epoxy coated.

Bearing seat surfaces shall be constructed or adjusted to the designated elevations within a tolerance of 1/8 inch (0.01 ft.). Adjustment shall be made either by grinding the surface or by shimming the bearings.

Concrete Sealer shall be applied to the exposed surfaces of both piers.

The existing structural steel coating contains lead. The Contractor shall take appropriate precautions to deal with the presence of lead on this project.

The Organic Zinc Rich Primer / Epoxy / Urethane Paint System shall be used for painting of new structural steel except where otherwise noted. The entire system shall be shop applied, with the exception that the exterior surfaces and bottom of the bottom flange of the fascia beams, masked off connection surfaces, and field installed fasteners, all of which shall be touched up and finish coated in the field. The color of the final finish coat for all interior steel surfaces shall be Gray, Munsell No. 5B 7/1. The color of the final finish coat for the exterior and bottom flange of the fascia beams shall be Reddish Brown, Munsell No. 2.5YR 3/4.

The embankment configuration shown shall be the minimum that must be placed and compacted prior to construction of the abutments.

Slipforming of the parapets is not allowed.

The removal of existing concrete slope wall shall be paid for as Slope Wall Removal. The quantity shown extends midway between the adjacent structures. The Engineer may adjust the limits of removal in the field as needed to accommodate excavation of the proposed embankment between the bridges.

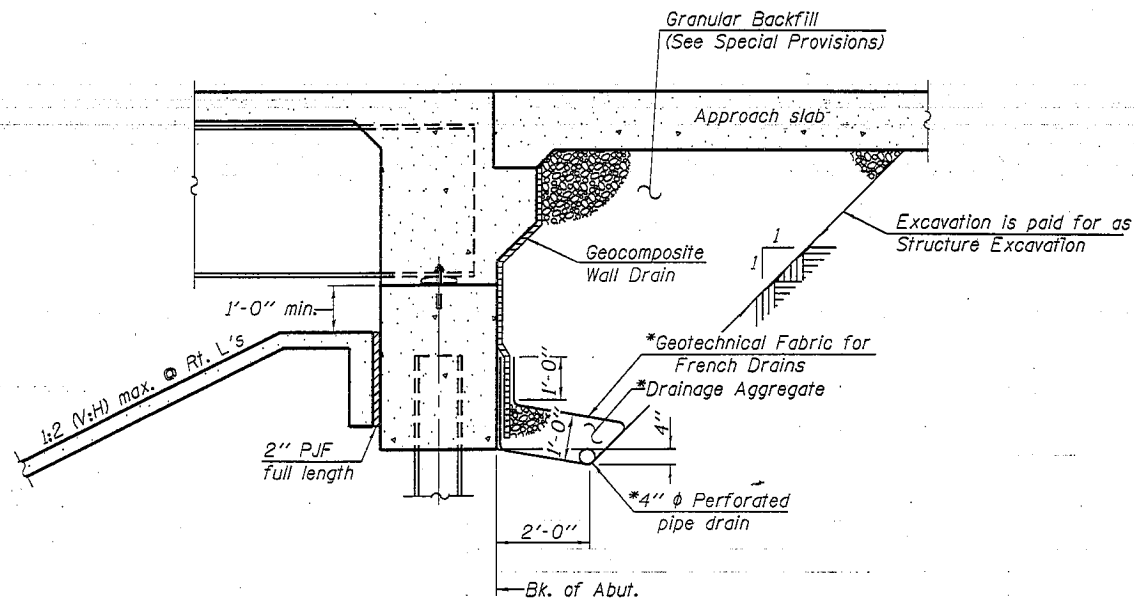

SECTION THRU INTEGRAL ABUTMENT
(Horiz. dim. @ Rt. L's)

*Included in the cost of Pipe Underdrains for Structures 4".

Note:
All drainage system components shall extend to 2'-0" from the end of each wingwall except an outlet pipe shall extend until intersecting with the side slopes. The pipes shall drain into concrete headwalls. (See Article 601.05 of the Standard Specifications and Highway Standard 601101).

TOTAL BILL OF MATERIAL

ITEM	UNIT	SUPER	SUB	TOTAL
Removal of Existing Structures No. 1	Each			1
Slope Wall Removal	Sq. Yd.			702
Protective Shield	Sq. Yd.	363		363
Structure Excavation	Cu. Yd.		726	726
Concrete Structures	Cu. Yd.		375.1	375.1
Concrete Superstructure	Cu. Yd.	551.6		551.6
Bridge Deck Grooving	Sq. Yd.	1544		1544
Protective Coat	Sq. Yd.	1762		1762
Stud Shear Connectors	Each	7452		7452
Reinforcement Bars, Epoxy Coated	Pound	129070	48220	177290
Bar Splicers	Each	870	218	1088
Slope Wall 4 Inch	Sq. Yd.		793	793
Furnishing Metal Shell Piles 14"x0.250"	Foot		1217	1217
Driving Piles	Foot		1217	1217
Test Pile Metal Shells	Each		4	4
Pile Shoes	Each		58	58
Name Plates	Each			1
Elastomeric Bearing Assembly, Type I	Each	18		18
Anchor Bolts, 1"	Each		36	36
Anchor Bolts, 1 1/4"	Each		36	36
Concrete Sealer	Sq. Ft.		3977	3977
Geocomposite Wall Drain	Sq. Yd.		99	99
Granular Backfill for Structures	Cu. Yd.		161	161
Furnishing and Erecting Structural Steel	L. Sum	0.25		0.25
Drainage Scuppers, DS-11	Each	2		2
Diamond Grinding (Bridge Section)	Sq. Yd.	1490		1490
Pipe Underdrains for Structures 4"	Foot		188	188
Temporary Soil Retention System	Sq. Ft.		324	324

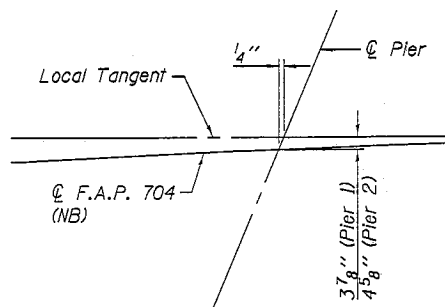
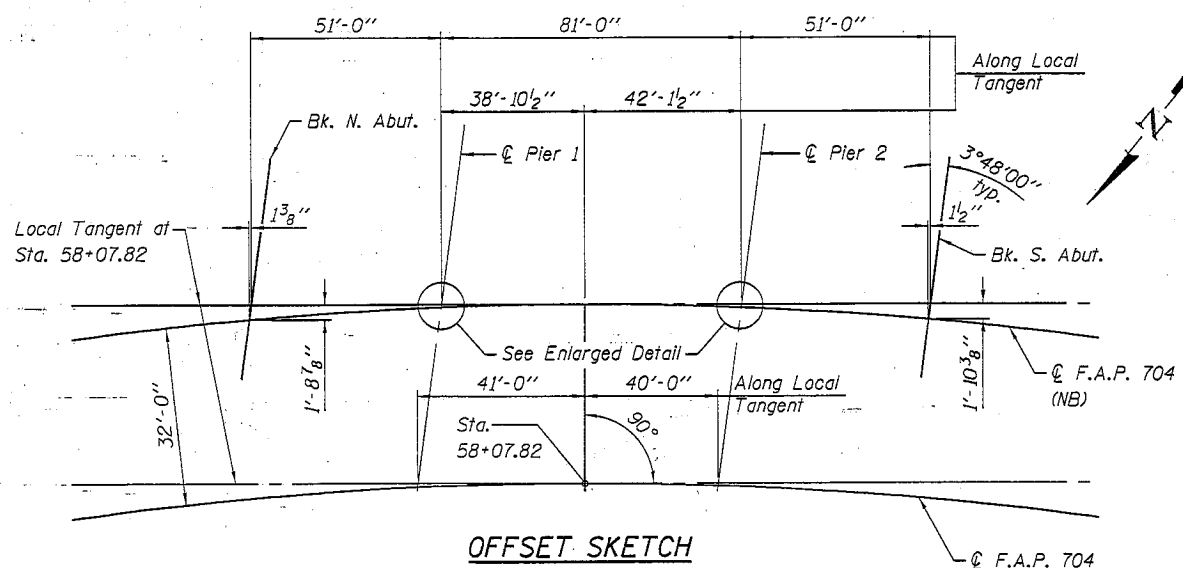

FILE NAME = 0578251-70578-021-GPE.dgn

USER NAME = boswanson
 CHECKED - RJP
 DRAWN - BAS
 PLOT DATE = 10/2/2013 4:53:39 PM

DESIGNED - MJT
 CHECKED - RJP
 DRAWN - BAS
 CHECKED - MJT

REVISED -
 REVISED -
 REVISED -
 REVISED -

STATE OF ILLINOIS
 DEPARTMENT OF TRANSPORTATION

GENERAL DATA
 STRUCTURE NO. 057-0251

SHEET NO. 2 OF 28 SHEETS

F.A.I. RTE.	SECTION	COUNTY	TOTAL SHEETS	SHEET NO.
74	(57-20)B-11B	MCLEAN	440	155
				CONTRACT NO. 70570
ILLINOIS FED. AID PROJECT				