

SECTION THRU CONCRETE SLOPEWALL
 Dimensions at right angles to substructures.

Notes:
 Slopewall shall be reinforced with welded wire fabric, 6" x 6" - W4.0 x W4.0, weighing 58 lbs. per 100 sq. ft.
 Stations and offsets to slopewall are given relative to $\text{C.L. F.A.I. 74 (EB)}$.
 For slopewall details and quantities between the adjacent bridges, see plans for Str. No. 057-0252.

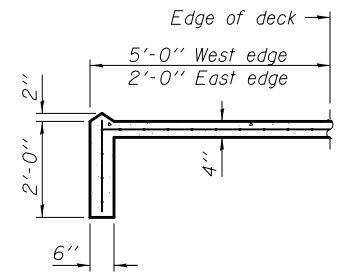

SLOPE WALL PLAN

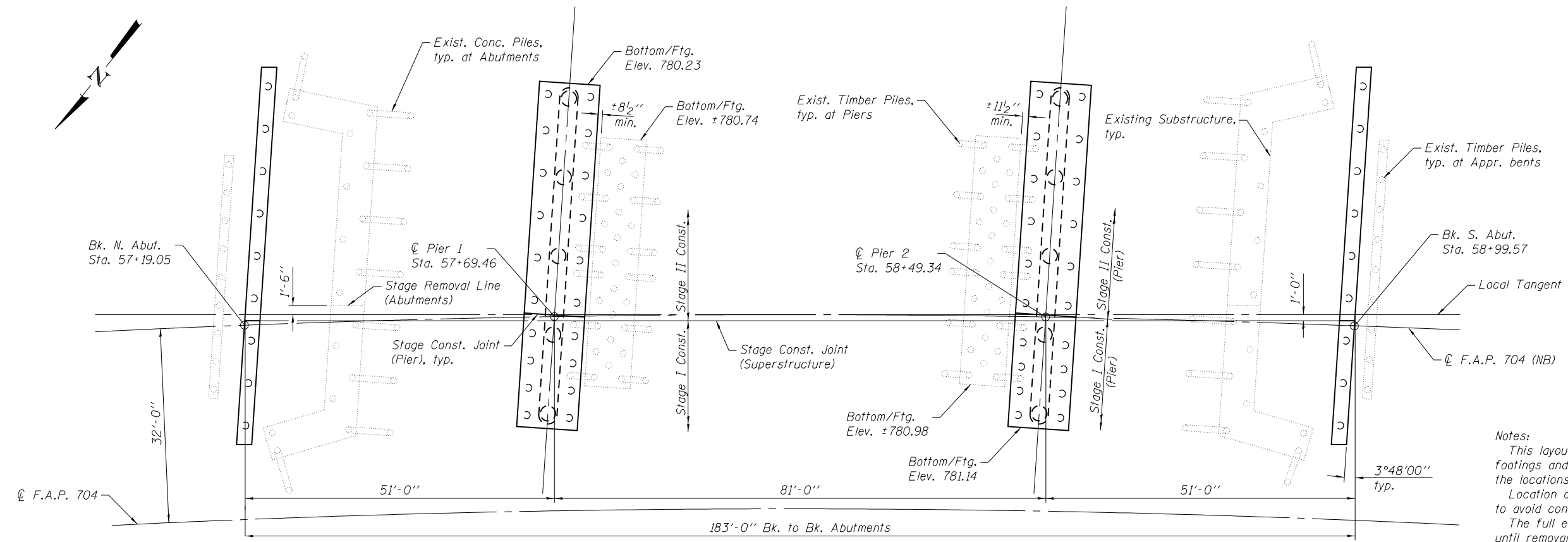

Notes:
 This layout shows relative position of existing and proposed footings and piles. Existing foundations may vary slightly from the locations shown here and on the existing structure plans. Location of proposed piles may be adjusted (up to ± 1 foot) to avoid conflict with existing piles.
 The full existing piers, including cap beams, shall remain intact until removal of the entire superstructure in Stage II. Limited removal of the edge of the footing may be necessary if it conflicts with the proposed footing.

FOUNDATION LAYOUT