

FOR INDEX OF SHEETS, SEE SHEET NO. 2  
FOR SUMMARY OF QUANTITIES SEE SHEET NO. 6 THROUGH 18

STATE OF ILLINOIS  
DEPARTMENT OF TRANSPORTATION  
DIVISION OF HIGHWAYS

**PROPOSED  
HIGHWAY PLANS**

F.A.I. ROUTE 74 (I-74)

SECTION 57-20(HB,HB-1)BR-1  
PROJECT ACNHPP-000S(945)  
BRIDGE REPLACEMENT AND  
VERTICAL REALIGNMENT  
MCLEAN COUNTY

C-95-032-07

I-55 BUSN OVER I-74 SW OF BLOOMINGTON

|                    |          |                    |           |
|--------------------|----------|--------------------|-----------|
| SECTION            | COUNTY   | TOTAL SHEETS       | SHEET NO. |
| 57-20(HB,HB-1)BR-1 | MCLEAN   | 440                | 1         |
| F.A.I. 74          | ILLINOIS | CONTRACT NO. 70570 |           |

\*440+1=441

D-95-032-07

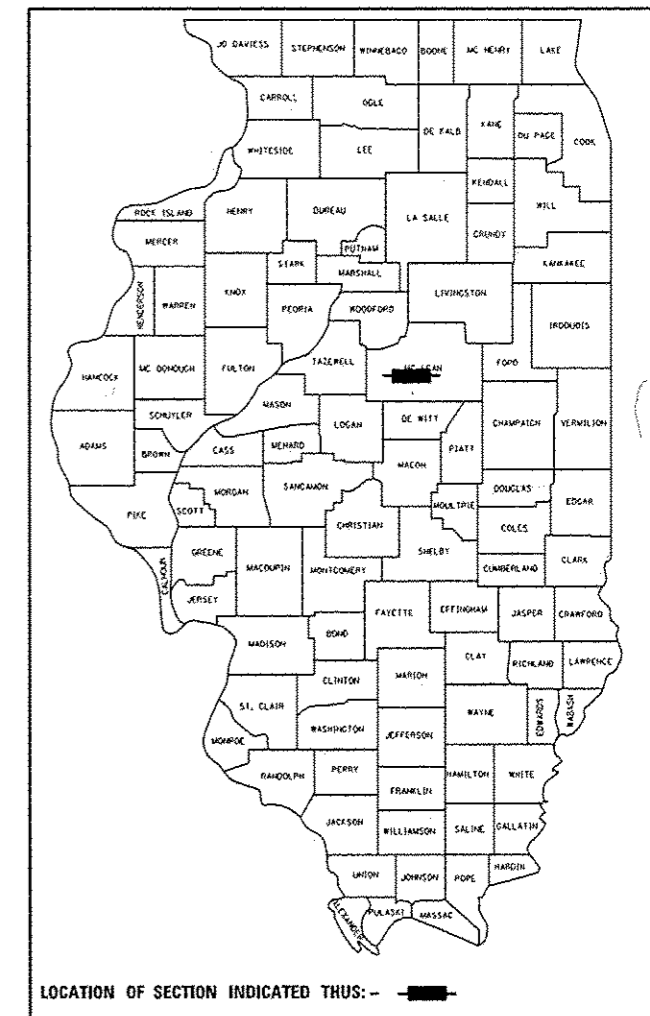

NOTE: THE ROUTE FOR THESE PLANS IS FAI 74. ON SHEET TITLE BLOCKS WHERE FAP 704 IS SHOWN IT SHALL MEAN FAI 74.

| CURRENT TRAFFIC DATA |         |         |         |         |
|----------------------|---------|---------|---------|---------|
|                      | LEG "A" | LEG "B" | LEG "C" | LEG "D" |
| 2011 ADT             | 5,200   | 7,600   | 9,400   | 20,700  |
| 2031 ADT             | 6,000   | 9,700   | 12,900  | 28,200  |
| P.U. %               | 93.4    | 90.6    | 91.9    | 60.9    |
| S.U. %               | 2.4     | 5.5     | 3.8     | 5.0     |
| M.U. %               | 4.2     | 3.9     | 4.3     | 34.1    |

LEG "A" IS VETERAN'S PARKWAY FROM I-55 TO RAMPS F & J.  
LEG "B" IS VETERAN'S PARKWAY FROM RAMPS F & J TO RAMP M.  
LEG "C" IS VETERAN'S PARKWAY FROM RAMP M TO HAMILTON ROAD.  
LEG "D" IS I-74 UNDER VETERAN'S PARKWAY.

| DESIGN DESIGNATION |  |
|--------------------|--|
| LEG A:             | 640(31) OTHER PRINCIPAL ARTERIAL 7.11 (FD-20)  |
| LEG B:             | 1080(31) OTHER PRINCIPAL ARTERIAL 7.11 (FD-20) |
| LEG C:             | 1410(31) OTHER PRINCIPAL ARTERIAL 7.11 (FD-20) |

EXISTING SN 057-0062 AT STA. 635+75.15  
CARRYING SB I-55 BUSN OVER WB I-74  
TO BE REMOVED AND REPLACED.  
PROPOSED SN 057-0254 AT STA. 635+73.19  
3 SPAN STEEL BEAM BRIDGE 204'-6" BK-BK.  
SKEW 30°-00'-00" LEFT FORWARD

EXISTING SN 057-0061 AT STA. 635+75.15  
CARRYING NB I-55 BUSN OVER WB I-74  
TO BE REMOVED AND REPLACED.  
PROPOSED SN 057-0253 AT STA. 635+73.19  
3 SPAN STEEL BEAM BRIDGE 204'-6" BK-BK.  
SKEW 30°-00'-00" LEFT FORWARD

EXISTING SN 057-0060 AT STA. 638+50.46  
CARRYING SB I-55 BUSN OVER EB I-74  
TO BE REMOVED AND REPLACED.  
PROPOSED SN 057-0252 AT STA. 638+48.84  
3 SPAN STEEL BEAM BRIDGE 183'-0" BK-BK.  
SKEW 3°-48'-00" LEFT FORWARD

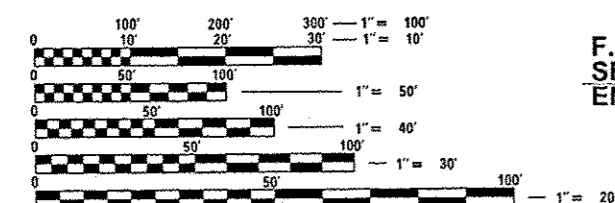

FULL SIZE PLANS HAVE BEEN PREPARED USING STANDARD ENGINEERING SCALES. REDUCED SIZED PLANS WILL NOT CONFORM TO STANDARD SCALES. IN MAKING MEASUREMENTS ON REDUCED PLANS, THE ABOVE SCALES MAY BE USED.

J.U.L.I.E.  
JOINT UTILITY LOCATION INFORMATION FOR EXCAVATION  
1-800-892-0123  
OR 811 BLOOMINGTON TOWNSHIP

PROJECT ENGINEER: NANCY FASIG  
SQUAD LEADER: BRIAN J. HOGAN  
(217)-465-4181  
CONTRACT NO. 70570

F.A.I. 74  
SECTION 57-20(HB,HB-1)BR-1  
ENDS: STA. 65+00.00

EXISTING SN 057-0059 AT STA. 638+50.46  
CARRYING NB I-55 BUSN OVER EB I-74  
TO BE REMOVED AND REPLACED.  
PROPOSED SN 057-0251 AT STA. 638+48.84  
3 SPAN STEEL BEAM BRIDGE 183'-0" BK-BK.  
SKEW 3°-48'-00" LEFT FORWARD

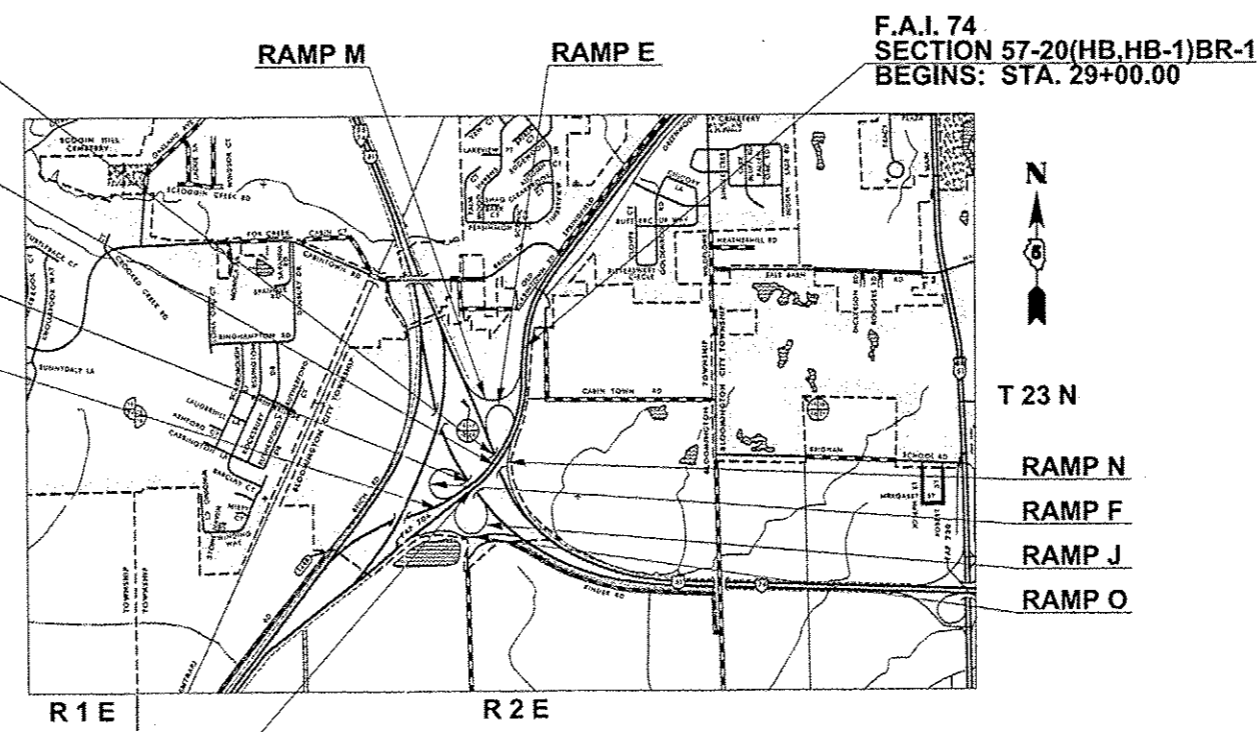

SCALE  
1200 2400 3600 4800 FEET  
GROSS LENGTH = 3,600.00 FT. = 0.682 MILE  
NET LENGTH = 3,600.00 FT. = 0.682 MILE

STATE OF ILLINOIS  
DEPARTMENT OF TRANSPORTATION  
DIVISION OF HIGHWAYS  
SUBMITTED 8/15/13  
DEPUTY DIRECTOR OF HIGHWAYS, REGION ENGINEER  
October 4, 2013  
John D. Baranowski, P.E.  
acting ENGINEER OF DESIGN AND ENVIRONMENT  
October 4, 2013  
Omer Osman, P.E.  
DIRECTOR OF HIGHWAYS, CHIEF ENGINEER

PRINTED BY THE AUTHORITY  
OF THE STATE OF ILLINOIS