

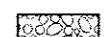
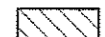

SEC. 20, T 23 N, R 2 E, 3RD PM

-  STONE RIPRAP, CLASS A4, 16" W/ 6" BEDDING STONE AND FILTER FABRIC
-  CLASS D PATCHES, 10" AND SUBBASE GRAN. MATERIAL, TYPE B 4" SHALL BE USED AS NEEDED FOR PIPE CULVERT REM AND REPL
-  PAVED SHOULDER REMOVAL
-  PAVEMENT REMOVAL

PROPOSED SIGN STRUCTURE 5 B 057 1074 R133.90  
 BRIDGE MOUNTED SIGN STRUCTURE (45.5 FT)  
 SIGN A (152.0 SQ FT), SIGN B (143.75 SQ FT),  
 SIGN C (200.0 SQ FT)

EXISTING S.N. 057-0059  
 3 SPAN STEEL BEAM BRIDGE @ STA. 638+50.46,  
 SKEWED 4°-1'-50" LEFT FORWARD, 150'-3/8" BK. TO BK.  
 REMOVAL OF EXISTING STRUCTURE NO. 1 1.0 EACH

PROPOSED S.N. 057-0251  
 3 SPAN W30 STEEL BEAMS  
 @ STA. 638+48.84, SKEWED 3°-48'-0" LEFT FORWARD  
 ON INTEGRAL ABUTMENTS  
 183'-0" BK. TO BK., 59'-0" HOR. CLEAR.

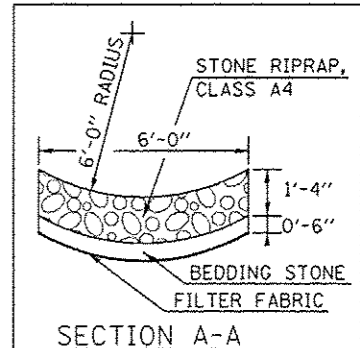
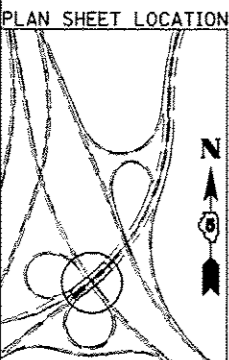
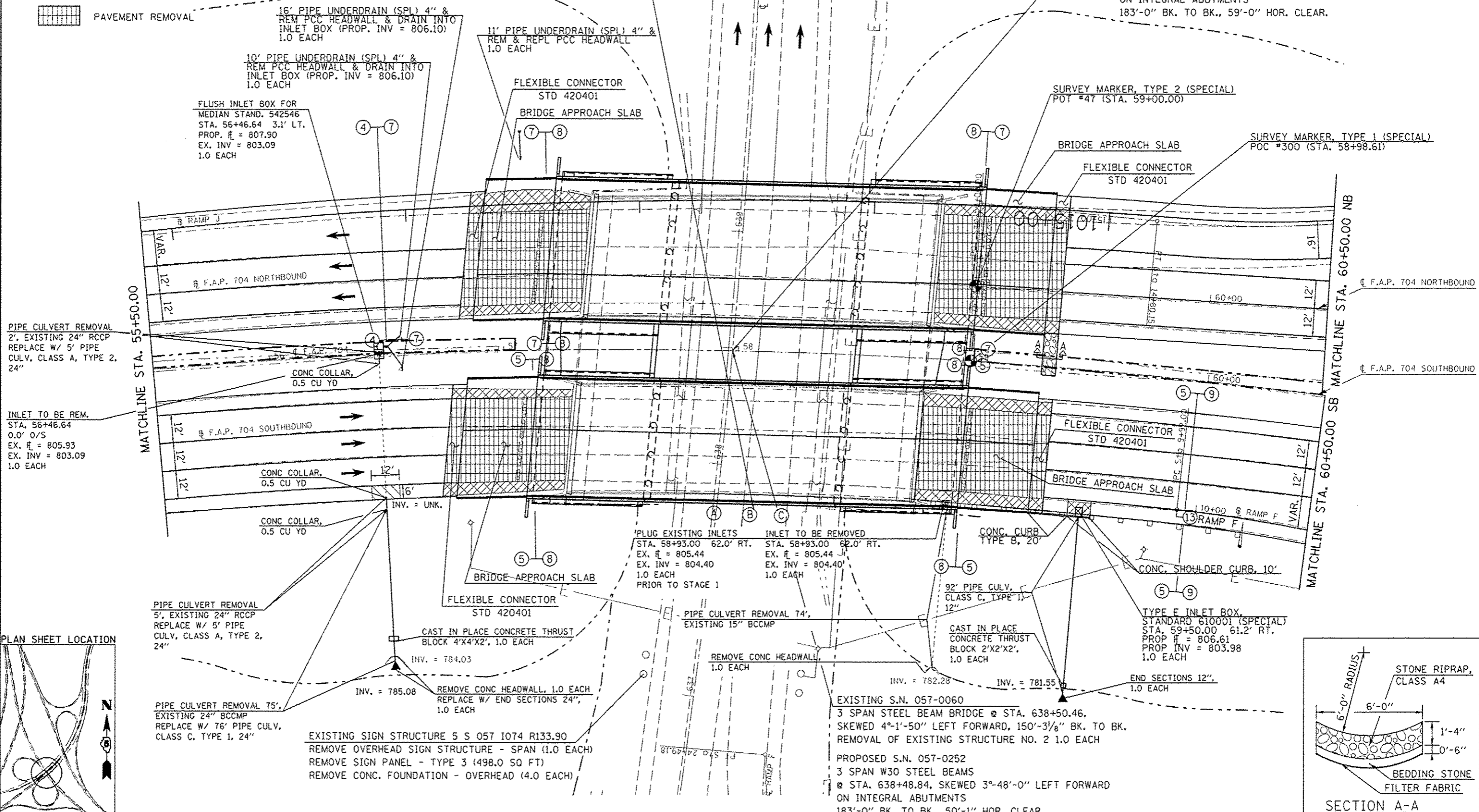

FILE NAME	USER NAME	DESIGNED	REVISED
PROJECT	DATE	CHECKED	REVISED
DATE	DATE	DATE	DATE

STATE OF ILLINOIS  
 DEPARTMENT OF TRANSPORTATION

PLAN SHEET  
 F.A.P. 704 (VETERAN'S PARKWAY)  
 SCALE: SHEET 6 OF 7 SHEETS STA. 55+50.00 TO STA. 60+50.00

F.A.P. RTE.	SECTION	COUNTY	TOTAL SHEETS	SHEET NO.
704	57-20(HB,HB-1)BR-1	MCLEAN	440	68
ILLINOIS FED. AID PROJECT				CONTRACT NO. T0570