





LEGEND

-  STONE RIPRAP, CLASS A5
-  STONE RIPRAP, CLASS A4
-  TREE REMOVAL, ACRES
-  TREE REMOVAL (OVER 15 UNITS DIAMETER)

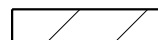

CONTROL POINT #3

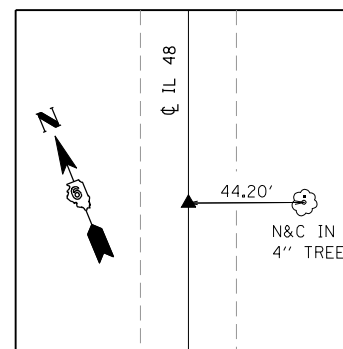
PK NAIL & CAP IN CHSLD "X"
 P.I. STA. 633+30.68, 1.52' LT.
 N 1,012,442.96
 E 2,506,327.66

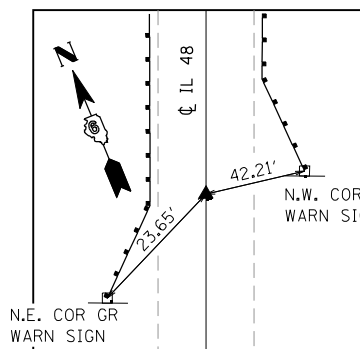

CONTROL POINT #4

PK NAIL & CAP IN CHSLD "X"
 P.T. STA. 637+55.67, 0.00' RT
 N 1,012,751.31
 E 2,506,620.13

PLAN	SURVEYED	DATE
NOTE BOOK	PLOTTED	BY
NO.	CHECKED	
	AT	
	FILE NAME	

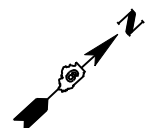
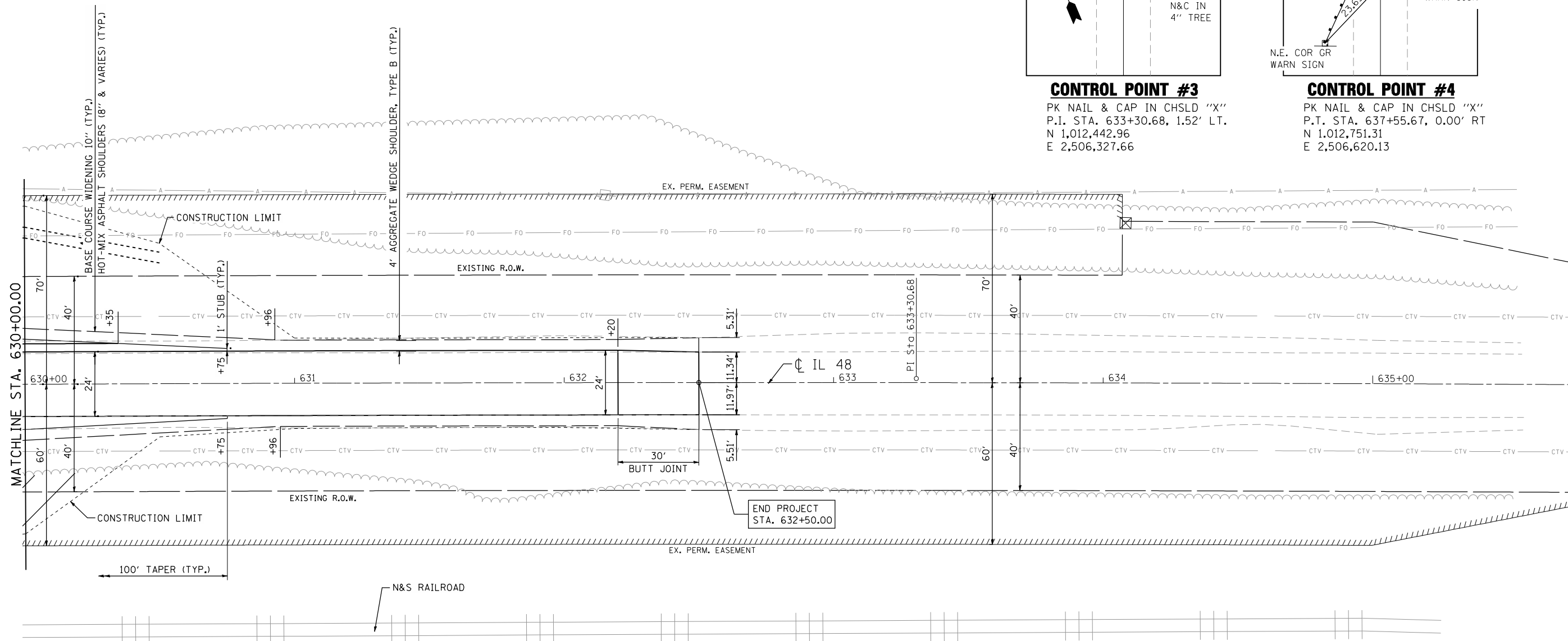

GRAPHIC SCALE

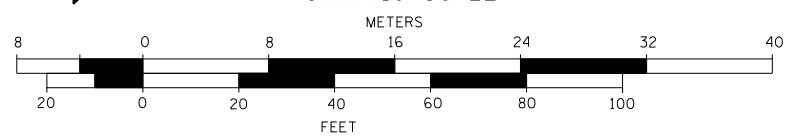

EXIST. CURVE 5
 PI STA. = 633+30.68
 $\Delta = 0^\circ 49' 15''$ (RT)
 $D = 0^\circ 05' 48''$
 $R = 59,327.82'$
 $T = 425.00'$
 $L = 849.99'$
 $E = 1.52'$
 P.C. STA. = 629+05.68
 P.T. STA. = 637+55.67

BM #JG#64
 STA. 635+64, 20.5' LT.
 CHISELED "□" IN CENTER OF CONC. H.W.
 ELEV. 609.29

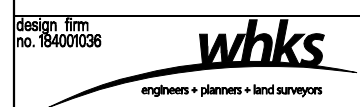

USER NAME = gjameson	DESIGNED -	REVISED
FILE NAME = D672A61-SHT-PLAN.dgn	CHECKED -	REVISED
PLOT SCALE = 40.0000' / IN.	DRAWN -	REVISED
PLOT DATE = 8/16/2013	CHECKED -	REVISED

**STATE OF ILLINOIS
 DEPARTMENT OF TRANSPORTATION**

PLAN SHEET
IL 48 OVER BEAR CREEK
 SCALE: 1" = 20' SHEET 3 OF 3 SHEETS STA. 630+00.00 TO STA. 635+00.00

F.A.P. RTE.	SECTION	COUNTY	TOTAL SHEETS	SHEET NO.
•	(4)I, 136B-1	CHRISTIAN	97	30
• 75(IL 29) & 714(IL 48)			CONTRACT NO. 72A61	
ILLINOIS FED. AID PROJECT				