

Bench Mark: Chiseled "□" SE corner of bridge. Sta. 626+30, 15.5' Rt., Elev. 607.04.

Existing Structure: S.N. 011-0018 originally built in 1930 as S.B.I. 48, Section 136B and rehabilitated in 1962 as S.B.I. 48, Section 136BR. The existing structure consists of a two span steel continuous multi-beam structure on open stub abutments on concrete piles and a solid wall pier on timber piles. 160'-0" bk. to bk. of abutments and 35'-8" out to out bridge width. The structure is to be removed and replaced. Traffic to be maintained utilizing stage construction.

No Salvage

INDEX OF SHEETS

1. General Plan and Elevation
2. General Data
3. Stage Construction Details
4. Temporary Concrete Barrier for Stage Construction
- 5.-6. Top of Slab Elevations
7. West Approach Top of Slab Elevations
8. East Approach Top of Slab Elevations
9. Superstructure
10. Superstructure Details
11. Diaphragm Details
- 12.-13. Bridge Approach Slab Details
14. Framing Plan
15. Structural Steel Details
16. West Abutment
17. East Abutment
18. Pier 1
19. Pier 2
20. Bar Splicer Assembly and Mechanical Splicer Details
21. HP Pile Details
- 22.-25. Boring Logs
- 26.-31. Existing Bridge Plans

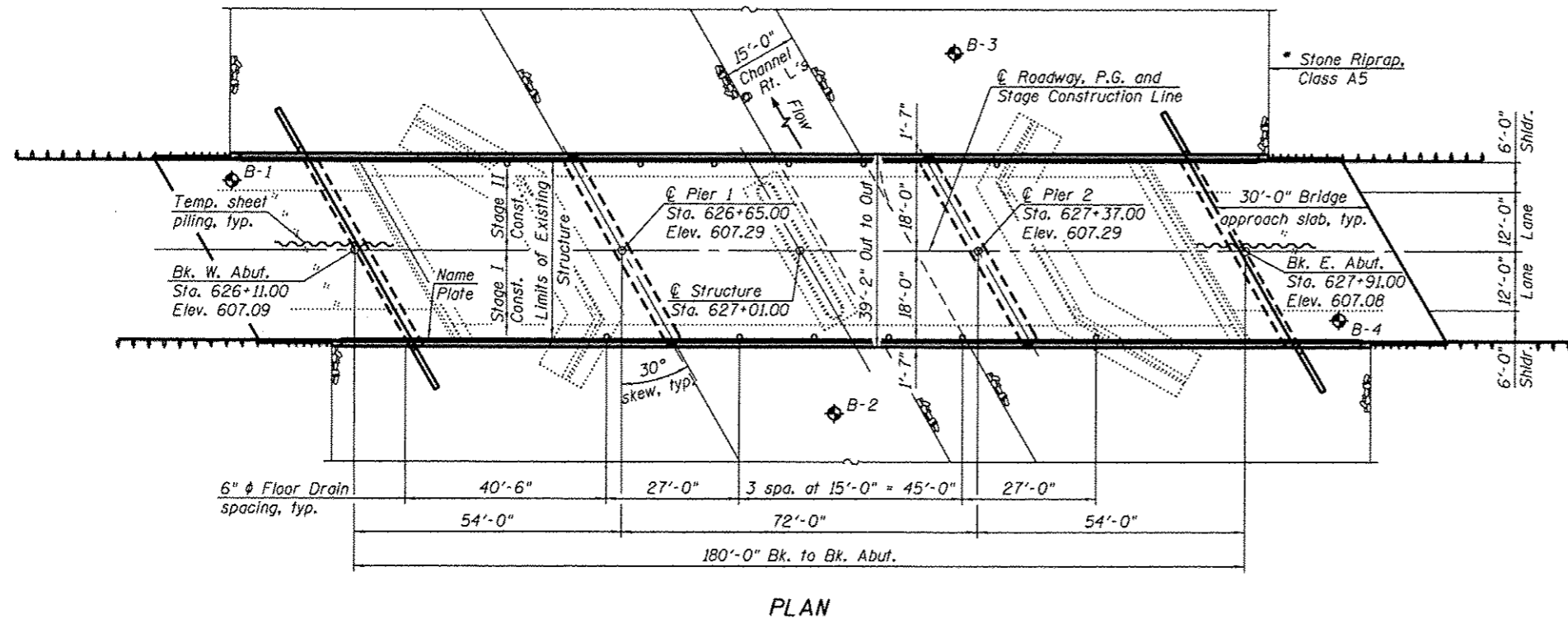
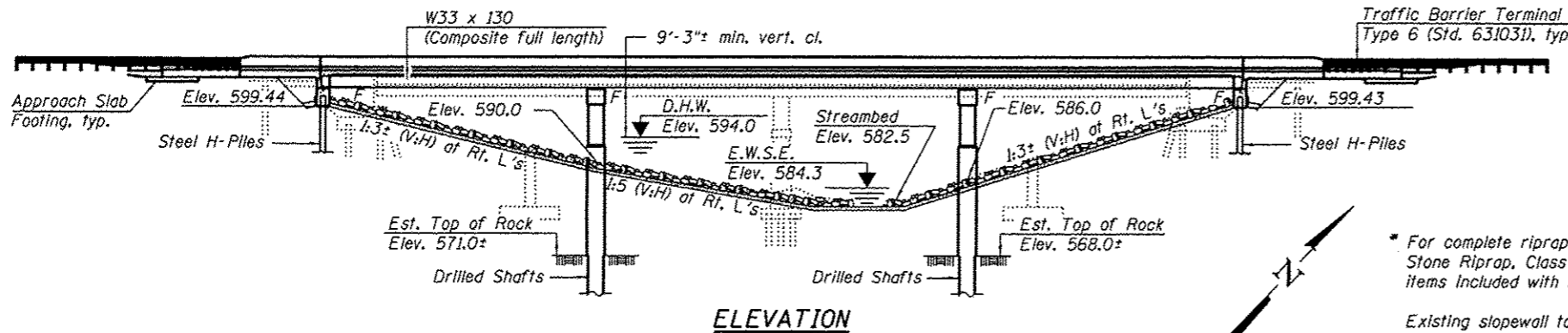

DESIGN SCOUR ELEVATION TABLE

W. Abut.	Pier 1	Pier 2	E. Abut.
599.44	575.9	575.2	599.43

WATERWAY INFORMATION

Flood	Freq. Yr.	C.F.S.	Opening Sq. Ft.		Nat. H.W.E.	Head - Ft.		Headwater El.	
			Exist.	Prop.		Exist.	Prop.	Exist.	Prop.
0			620	680	593.2	1.1	1.4	594.3	594.5
10	3,050		620	680	593.2	1.1	1.4	594.3	594.5
50	4,770		710	775	594.0	1.4	1.4	595.4	595.5
100	5,510		740	810	594.3	1.5	1.5	595.8	595.8
Base	7,290		810	875	594.9	1.6	1.6	596.6	596.6
Max. Calc.									

STATION 627+01.00
BUILT 20 BY
STATE OF ILLINOIS
F.A.P. RTE. 714 SEC. (4); 136B-1
LOADING HL-93
STRUCTURE NO. 011-0514

NAME PLATE
See Std. 515001

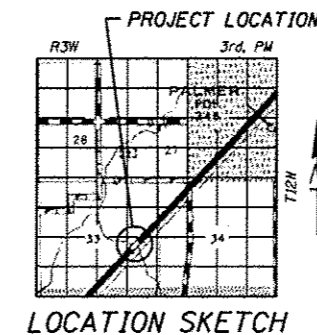
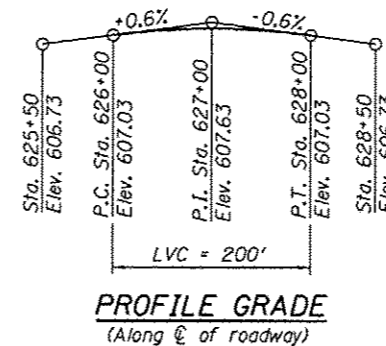

APPROVED
For Structural Adequacy Only
[Signature]
Engineer of Bridges & Structures

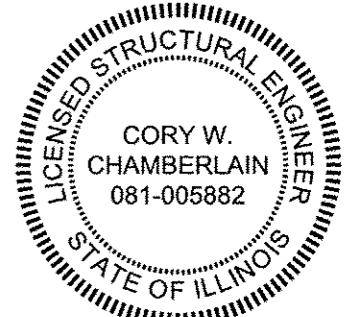

[Signature] 9-26-13
Expires: 11/30/2014
Applies to sheets 1 thru 17 and sheets 20 thru 31.

LOADING HL-93
Allow 50#/sq. ft. for future wearing surface.
DESIGN SPECIFICATIONS
2012 AASHTO LRFD Bridge Design Specifications, 6th Edition

DESIGN STRESSES
FIELD UNITS
f'c = 3,500 psi
fy = 60,000 psi (Reinforcement)
fy = 50,000 psi (M270 Grade 50W)

SEISMIC DATA
Seismic Performance Zone (SPZ) = 1
Design Spectral Acceleration at 1.0 sec. (S_{D1}) = 0.126 g
Design Spectral Acceleration at 0.2 sec. (S_{D5}) = 0.268 g
Soil Site Class = C

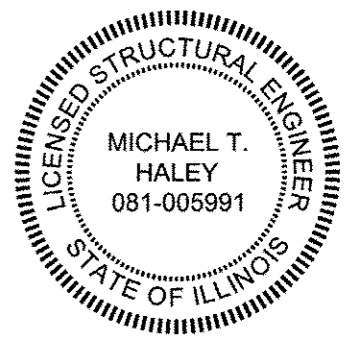

[Signature] 9-26-13
Expires: 11/30/2014
Applies to sheets 18 and 19.

GENERAL PLAN & ELEVATION
ILLINOIS ROUTE 48 OVER BEAR CREEK
F.A.P. RTE. 714 - SEC. (4); 136B-1
CHRISTIAN COUNTY
STATION 627+01.00
STRUCTURE NO. 011-0514