

11-08-13 LETTING ITEM 043

STATE OF ILLINOIS
DEPARTMENT OF TRANSPORTATION
DIVISION OF HIGHWAYS

**PROPOSED
CONTRACT MAINTENANCE**

FOR INDEX OF SHEETS, SEE SHEET NO. 2

FAI 55 (I-55)
SECTION D6 PATCHING LOGAN CO. 2014
PROJECT PAVEMENT PATCHING
TYPE of IMPROVEMENT
LOGAN COUNTY

C-96-065-13

F.A.I. RTE.	SECTION	COUNTY	TOTAL SHEETS	SHEET NO.
55	D6 PATCH LOGAN CO. 2014	LOGAN	6	1
ILLINOIS			CONTRACT: 72G29	

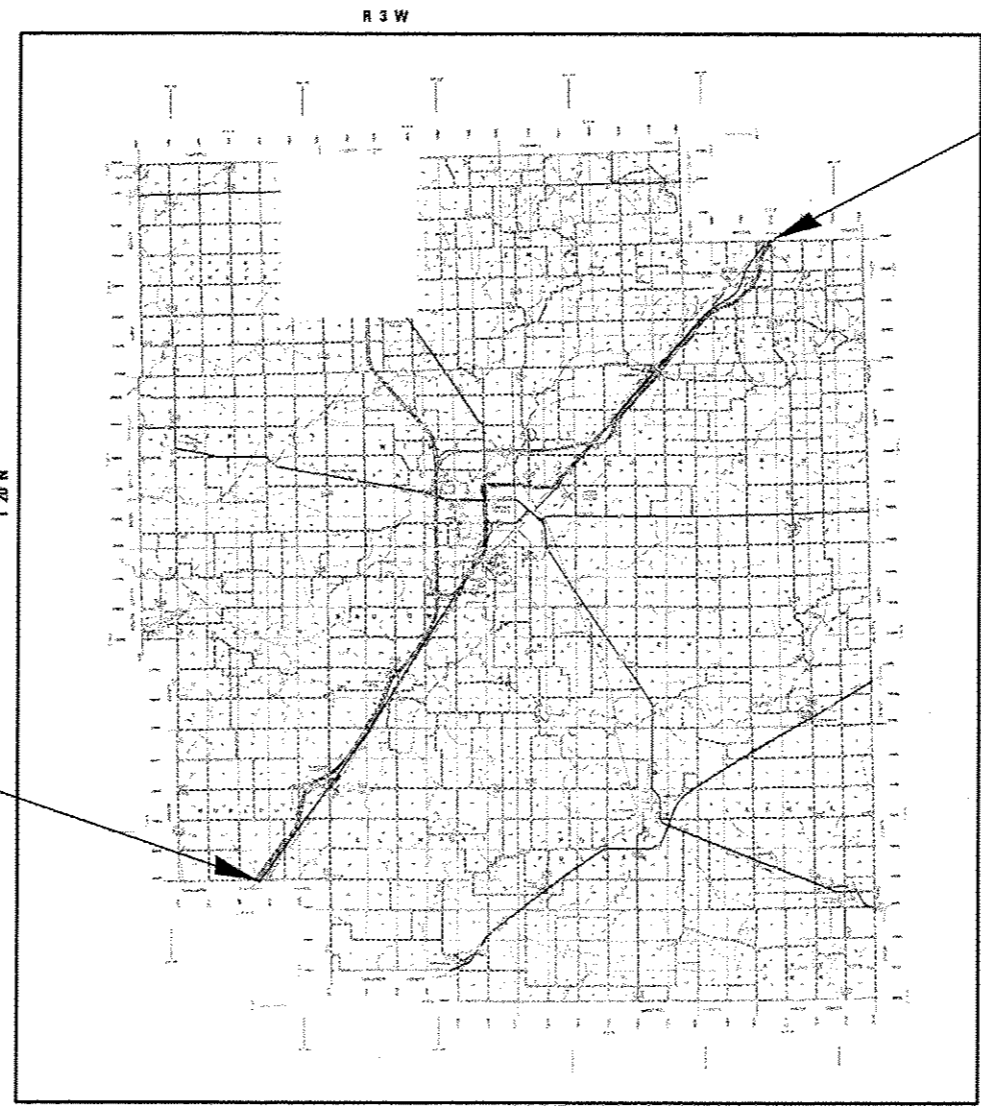

ADT: 15,700 (2011)
HCV: 3,950
SU: 460
MU: 3,500

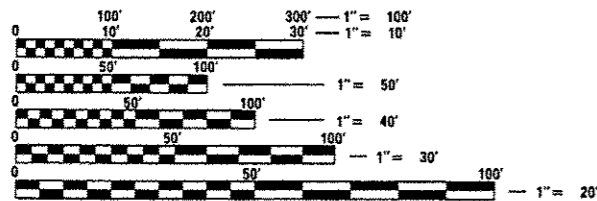

FULL SIZE PLANS HAVE BEEN PREPARED USING STANDARD ENGINEERING SCALES. REDUCED SIZED PLANS WILL NOT CONFORM TO STANDARD SCALES. IN MAKING MEASUREMENTS ON REDUCED PLANS, THE ABOVE SCALES MAY BE USED.

J.U.L.I.E.
JOINT UTILITY LOCATION INFORMATION FOR EXCAVATION
1-800-892-0123
OR 811

PLAN AND CONTRACT TECHNICIAN
TIMOTHY SHARP (217) 782-7743

CONTRACT NO. 72G29

STATE OF ILLINOIS
DEPARTMENT OF TRANSPORTATION
DIVISION OF HIGHWAYS

SUBMITTED August 23 20 13
Rep. Z. Smith
DEPUTY DIRECTOR OF HIGHWAYS, REGION ENGINEER

October 4 20 13
John D. Baranzello, P.E.
acting ENGINEER OF DESIGN AND ENVIRONMENT

October 4 20 13
Omec Osman, P.E.
DIRECTOR OF HIGHWAYS, CMEF ENGINEER

PRINTED BY THE AUTHORITY
OF THE STATE OF ILLINOIS

INDEX

SHEET NO.	DESCRIPTION
1.	COVER SHEET
2.	INDEX, STANDARDS, SIGNATURES
3.	SUMMARY OF QUANTITIES
4.	SCHEDULES
5.	LOCATION MAP
6.	TYPICAL SECTIONS

STANDARDS

STANDARD NO.	DESCRIPTION
442001-04	CLASS A PATCHES
701101-03	OFF-RD OPERATIONS, MULTILANE, 15' TO 24" FROM PAVEMENT EDGE
701106-02	OFF-RD OPERATIONS, MULTILANE, MORE THAN 15' AWAY
701400-06	APPROACH TO LANE CLOSURE, FREEWAY/EXPRESSWAY
701401-07	LANE CLOSURE, FREEWAY/EXPRESSWAY
701411-08	LANE CLOSURE, MULTILANE, AT ENTRANCE OR EXIP RAMP, FOR SPEEDS >45 MPH
701901-02	TRAFFIC CONTROL DEVICES

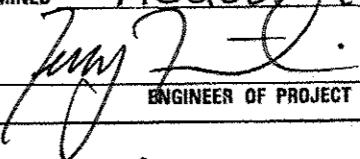
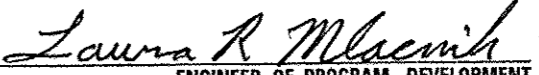
STATE OF ILLINOIS DEPARTMENT OF TRANSPORTATION DIVISION OF HIGHWAYS DISTRICT 6	
EXAMINED	8/28 20 13
 ENGINEER OF OPERATIONS	
EXAMINED	AUGUST 16 20 13
 ENGINEER OF PROJECT IMPLEMENTATION	
EXAMINED	AUGUST 16 20 13
 ENGINEER OF PROGRAM DEVELOPMENT	

CONSTR. CODE

100% STATE

ROADWAY

0005

S. N.

CODE NO.	ITEM	UNIT	TOTAL QUANTITY	
44200610	CLASS A PATCHES, TYPE II, 13 INCH	SQ YD	206.7	206.7
44200612	CLASS A PATCHES, TYPE III, 13 INCH	SQ YD	72	72
44200614	CLASS A PATCHES, TYPE IV, 13 INCH	SQ YD	46.7	46.7
44213000	PATCHING REINFORCEMENT	SQ YD	325.3	325.3
44213200	SAW CUTS	FOOT	1,780	1,780
44213204	TIE BARS 3/4"	EACH	18	18
67100100	MOBILIZATION	L SUM	1	1
70100420	TRAFFIC CONTROL AND PROTECTION, STANDARD 701411	EACH	10	10
70100800	TRAFFIC CONTROL AND PROTECTION, STANDARD 701401	L SUM	1	1
70106800	CHANGEABLE MESSAGE SIGN	CAL MO	2	2
70200100	NIGHTTIME WORK ZONE LIGHTING	L SUM	1	1
X4820110	HOT-MIX ASPHALT SHOULDER REMOVAL AND REPLACEMENT (SPECIAL)	SQ YD	150	150

FILE NAME *	USER NAME * aherptd	DESIGNED - DMS	REVISED -
S:\CONTRMANT_CAD\72629 - 1-55- logan-	atching 11-8-2013 leting*3 0672629-shi-500	DRAWN - DMS	REVISED -
Default	PLOT SCALE * 40.0000' / in.	CHECKED -	REVISED -
	PLOT DATE * Aug-26-2013 06:23:14AM	DATE - 5-13-2013	REVISED -

**STATE OF ILLINOIS
DEPARTMENT OF TRANSPORTATION**

SUMMARY OF QUANTITIES			
SCALE:	SHEET	OF	SHEETS

F.A.I. RTE.	SECTION	COUNTY	TOTAL SHEETS	SHEET NO.
55	D6 PATCH LOGAN CO. 2014	LOGAN	6	3
				CONTRACT NO. 72629
ILLINOIS FED. AID PROJECT				

PATCHING SCHEDULE

LOCATION	CLASS A PATCHES				CLASS A PATCHES			SAW CUTS FOOT	TIE BARS EACH	PATCH REINF. SQ YD
	LENGTH (FT)		WIDTH	SQ YD	13 IN	13 IN	13 IN			
	PASS.	DRIV.			TY II	TY III	TY IV			
NORTHBOUND I-55										
STA 606+00		6.0	12.0	8.0	8.0		60.0			8.0
STA 607+00		12.0	12.0	16.0		16.0	72.0			16.0
STA 74+00		10.0	12.0	13.3	13.3		68.0			13.3
STA 287+50		14.0	12.0	18.7		18.7	76.0			18.7
STA 289+00		6.0	12.0	8.0	8.0		60.0			8.0
STA 336+00		6.0	12.0	8.0	8.0		60.0			8.0
STA 347+00		6.0	12.0	8.0	8.0		60.0			8.0
STA 349+00		6.0	12.0	8.0	8.0		60.0			8.0
STA 349+50		6.0	12.0	8.0	8.0		60.0			8.0
STA 350+00		7.0	12.0	9.3	9.3		62.0			9.3
STA 350+50		8.0	12.0	10.7	10.7		64.0			10.7
STA 351+00		16.0	12.0	21.3		21.3	80.0			21.3
STA 399+00		6.0	12.0	8.0	8.0		60.0			8.0
STA 584+00		6.0	12.0	8.0	8.0		60.0			8.0
N.B. TOTALS				153.3	97.3	56.0	0.0	902.0	0.0	153.3
SOUTHBOUND I-55										
STA 278+00		8.0	12.0	10.7	10.7		64.0			10.7
STA 126+00		12.0	12.0	16.0		16.0	72.0			16.0
STA 846+00		7.0	12.0	9.3	9.3		62.0			9.3
STA 826+00		6.0	12.0	8.0	8.0		60.0			8.0
STA 687+50		35.0	12.0	46.7		46.7	118.0	18		46.7
STA 686+00		6.0	12.0	8.0	8.0		60.0			8.0
STA 678+00		8.0	12.0	10.7	10.7		64.0			10.7
STA 667+00		9.0	12.0	12.0	12.0		66.0			12.0
STA 655+00		6.0	12.0	8.0	8.0		60.0			8.0
STA 654+80	10.0		12.0	13.3	13.3		68.0			13.3
STA 470+75		6.0	12.0	8.0	8.0		60.0			8.0
STA 463+00		8.0	12.0	10.7	10.7		64.0			10.7
STA 431+50	8.0		12.0	10.7	10.7		64.0			10.7
N.B. TOTALS				172.0	109.4	16.0	46.7	882.0	18.0	172.0
TOTALS				325.3	206.7	72.0	46.7	1784.0	18.0	325.3

MIXTURE REQUIREMENTS

THE FOLLOWING MIXTURE REQUIREMENTS

ARE APPLICABLE FOR THIS PROJECT

MIXTURE USE(S)	H.M.A. SHOULDER REM & REPL SURF	H.M.A. SHOULDER REM & REPL LOWER LIFTS
AC/PG	PG 64-22	PG 64-22
DESIGN AIR VOIDS	4.0% @ N DESIGN = 50	4.0% @ N DESIGN = 50
MIXTURE COMP	IL 9.5	IL 19.0
FRICITION AGG	MIX "C"	N/A

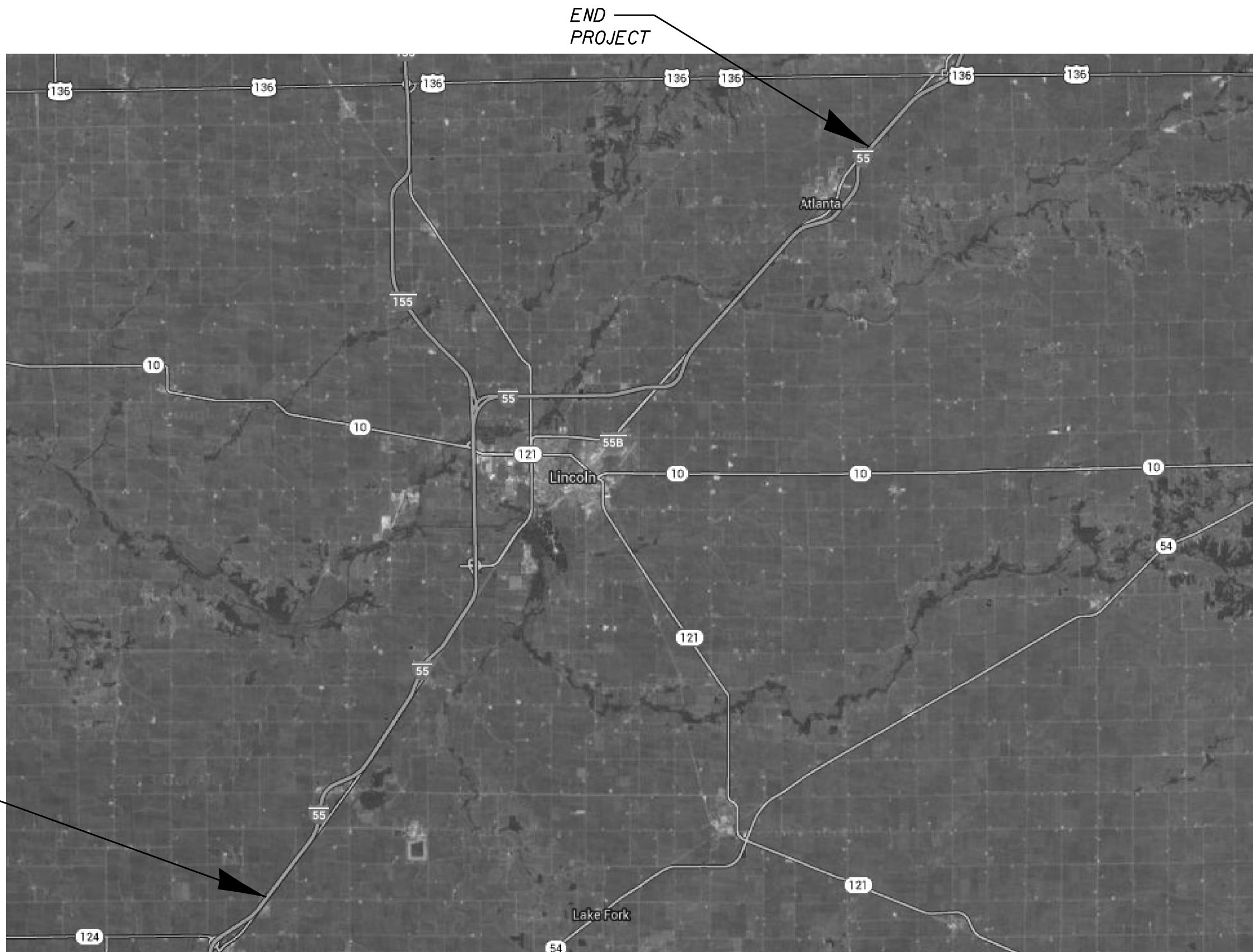

BEGIN PROJECT

END PROJECT

FILE NAME : *FILEL*	USER NAME : *USER*	DESIGNED - _____	REVISED - _____	STATE OF ILLINOIS DEPARTMENT OF TRANSPORTATION	PROJECT LOCATION				F.A.I. RTE.	SECTION	COUNTY	TOTAL SHEETS	SHEET NO.
		DRAWN - DMS	REVISED - _____		SCALE: _____	SHEET _____ OF _____ SHEETS	STA. _____ TO STA. _____	55	06 PATCH LOGAN CO. 2014	LOGAN	6	5	
		CHECKED - _____	REVISED - _____						CONTRACT NO. 72029				
MODELNAME		DATE - 5-21-2013	REVISED - _____						ILLINOIS FED. AID PROJECT				

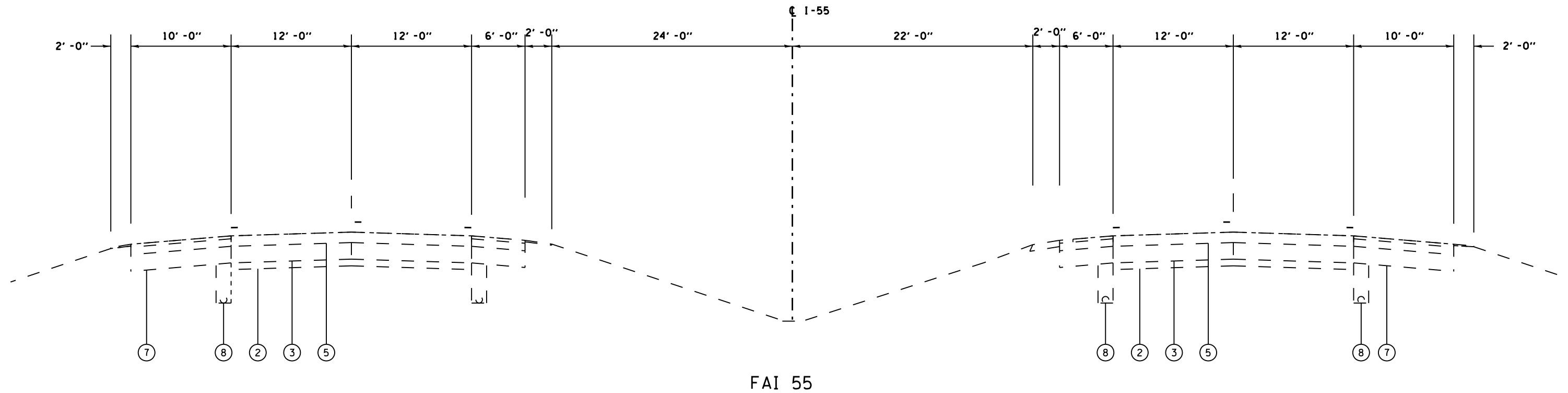

LEGEND

- ① EX STABILIZED SUB-BASE 4"
- ② EX AGGREGATE SUB-BASE 4"
- ③ EX PCC PAVEMENT 9"
- ④ EX SRPCC PAVEMENT 8"
- ⑤ EX HOT -MIX ASPHALT SURFACE COURSE (VARIABLE THICKNESS)
- ⑥ EX AGGREGAE SHOULDERS
- ⑦ EX HOT-MIX ASPHALT SHOULDERS
- ⑧ EX PIPE UNDERDRAIN

FILE NAME :	USER NAME : #USER#	DESIGNED - _____	REVISED - _____	STATE OF ILLINOIS DEPARTMENT OF TRANSPORTATION	TYPICALS		F.A.I. RTE.:	SECTION	COUNTY	TOTAL SHEETS	SHEET NO.
#FILE#	PLOT SCALE : #SCALE#	DRAWN - _____	REVISED - _____				55	D6 PATCH LOGAN CO. 2014	LOGAN	6	6
#MODELNAME#	PLOT DATE : #DATE#	CHECKED - _____	REVISED - _____		SCALE: _____ SHEET _____ OF _____ SHEETS STA. _____ TO STA. _____		CONTRACT NO. 72G29		ILLINOIS FED. AID PROJECT		
		DATE - _____	REVISED - _____								