

As shown on the plan view, the structure is to be constructed on a foundation of 30" diameter piles. The structure is to be constructed on a foundation of 30" diameter piles. The structure is to be constructed on a foundation of 30" diameter piles.

STATE OF ILLINOIS

PROJECT NO.	SECTION	COUNTY	TOTAL SHEETS	SHEET NO.
17	118-1	SHELBY	80	27

SHEETS

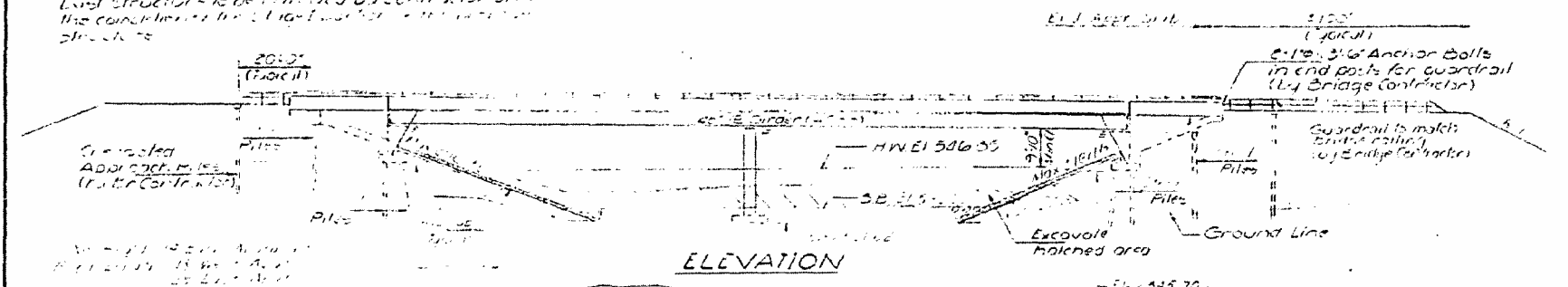

STATION 108+77.95
BUILT 197 BY
STATE OF ILLINOIS
F.A. RT 17 SEC 118-1
F.A. PROJ BR-F-58(17)
LOADING HS20
NAME PLATE
(See S1d 2113)

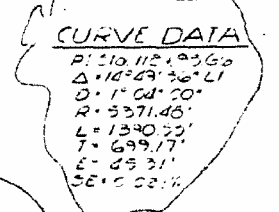

WATERWAY INFORMATION

Drainage Area	1330.57 Acre above Shelbyville Dam
Character	Rolling Cultivated
Present Opening	2120.5 ft
Required Opening	1250.5 ft
Proposed Opening	1500.5 ft
Max. Flood Control Release	4500 cfs
Created Head	0.0'

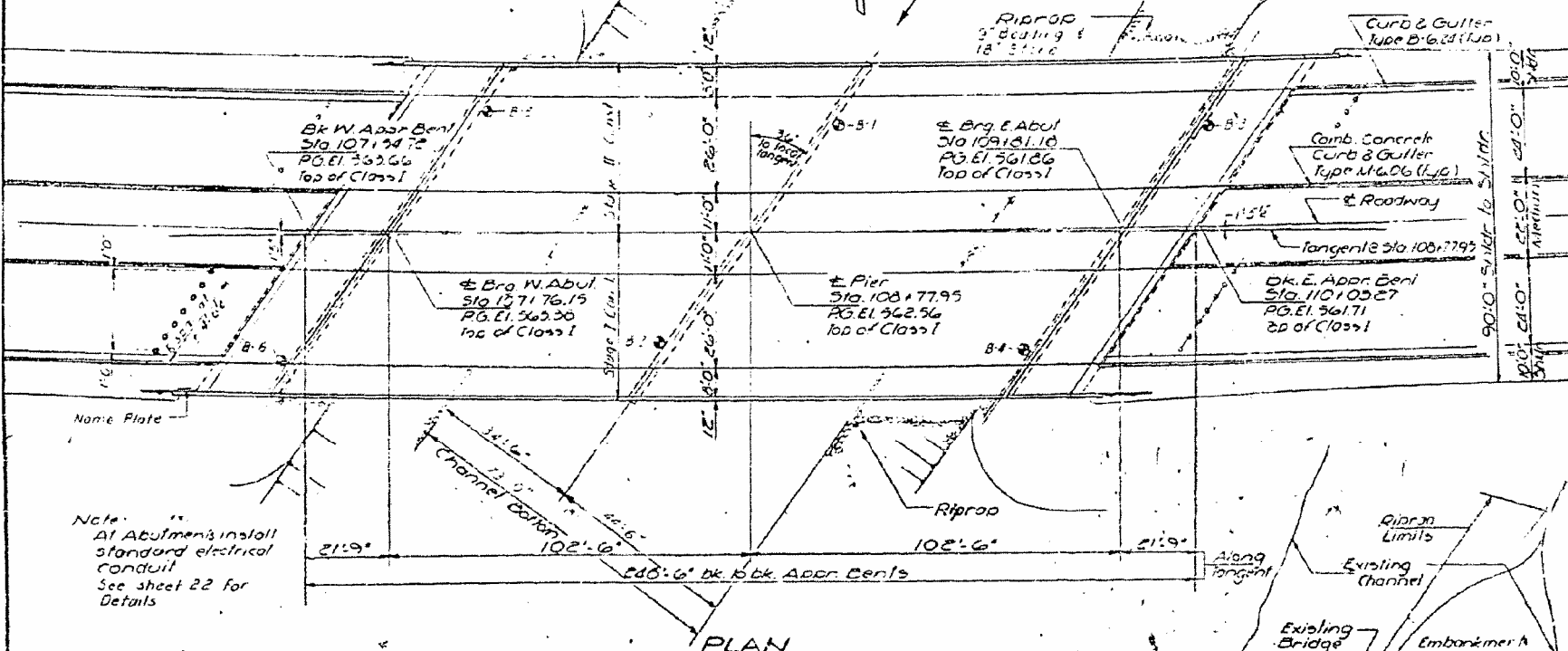

Note:
At Abutments install standard electrical conduit. See sheet 22 for details.

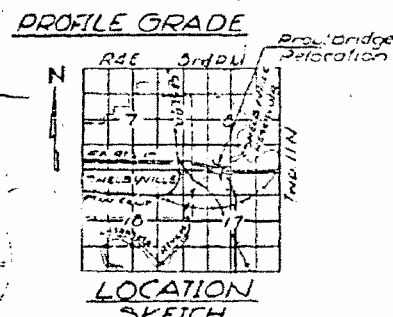
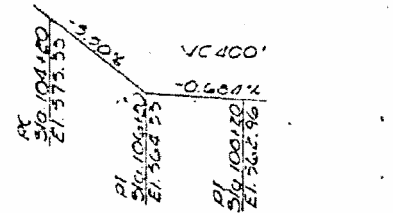

DESIGN STRESSES
 $f_c = 1200 \text{ psi}$ Deck, Slab
 $f_c = 1400 \text{ psi}$ Curb, Parapet, Sud.
 $f_s = 27,000 \text{ psi}$ Reinf.
 $f_s = 27,000 \text{ psi}$ Struct.
 $V_c = 75 \text{ psi}$ Footings
 $n = 10$
 Allow 25% for full W.D.
 Design Specifications
 AASHTO as applicable
 LOADING HS20-44

DESIGNED	S. Deane	11/16/13
CHECKED	S. Deane	11/16/13
DRAWN	JOS	
CHECKED	S.D.	

OCTOBER 18 1973
 EXAMINED
 PASSED
 APPROVED

STATE OF ILLINOIS
DEPARTMENT OF TRANSPORTATION

EXISTING BRIDGE PLANS
S.N. 087-0020

F.A.P. RTE.	SECTION	COUNTY	TOTAL SHEETS	SHEET NO.
325 774	.	SHELBY	18	4

CONTRACT NO. 74620

FILE NAME	USER NAME	DESIGNED	REVISED
et:\pw_work\p\midot\stef\enmk\d0344554\074620-sht\plan.dgn	stefennk	-	-
PLOT SCALE	CHECKED	REVISED	REVISED
100.0000' / 1"	-	-	-
PLOT DATE	DATE	REVISED	REVISED
8/6/2013	-	-	-

SCALE: N/A SHEET 1 OF 15 SHEETS STA. TO STA.

ILLINOIS FED. AID PROJECT