

STATE OF ILLINOIS
DEPARTMENT OF PUBLIC WORKS & BUILDINGS
DIVISION OF HIGHWAYS

PROJECT NO.	SHEET NO.	TOTAL SHEETS	DATE
FAZ 57	25-TNB	35	S.

B.M.R.R Spike in 36' Eln on North Side of
East & West Rt. 475 Lt. Sta 4780+40
Elev. 564.77

GENERAL NOTES

Class X concrete shall be used throughout.
The concrete floor slab shall be finished in accordance with Article 517 of the Standard Specifications. Slope wall shall be reinforced with welded wire fabric 6 x 6 mesh, 4 wires, weighing 50 per 100 sq ft. Rivets 3/8" open holes 3/8" unless noted.
Cover ribs and beams to which cover ribs are welded shall conform to A.I.T.M. specifications of Structural Steel for welding, Designation A-575.
All holes for splices shall be punched 1/8" and reamed to proper size (1/8" in web and 1/16" in flange) with all beams assembled in the shop in proper position. Leave assembled in shop for inspection.
Anchor bolts shall be set before riveting diaphragms over supports.
All bolsters, rockers, bearing plates, shim plates, lead plates, pintles and anchor bolts shall be fabricated and set in accordance with Article 515 of the Standard Specifications and are included in quantity of Structural Steel.
Except as otherwise provided all structural steel shall receive one shop coat of red lead paint and two field coats of aluminum paint. See Article 561 to 565 inclusive of the Standard Specifications. All paint shall be furnished and applied by the Contractor.
Concrete piles through embankment shall be driven in pre-cored holes in accordance with Article 609 (c) of the Standard Specifications.
The Contractor shall drive one concrete test pile at each abutment in permanent locations and one timber test pile in the vicinity of pier 1 as directed by the Engineer before ordering remainder of piles.
Coarse aggregate which is to be used in end posts must be absolutely free of chert, flint, lignite, and soft sandstone.

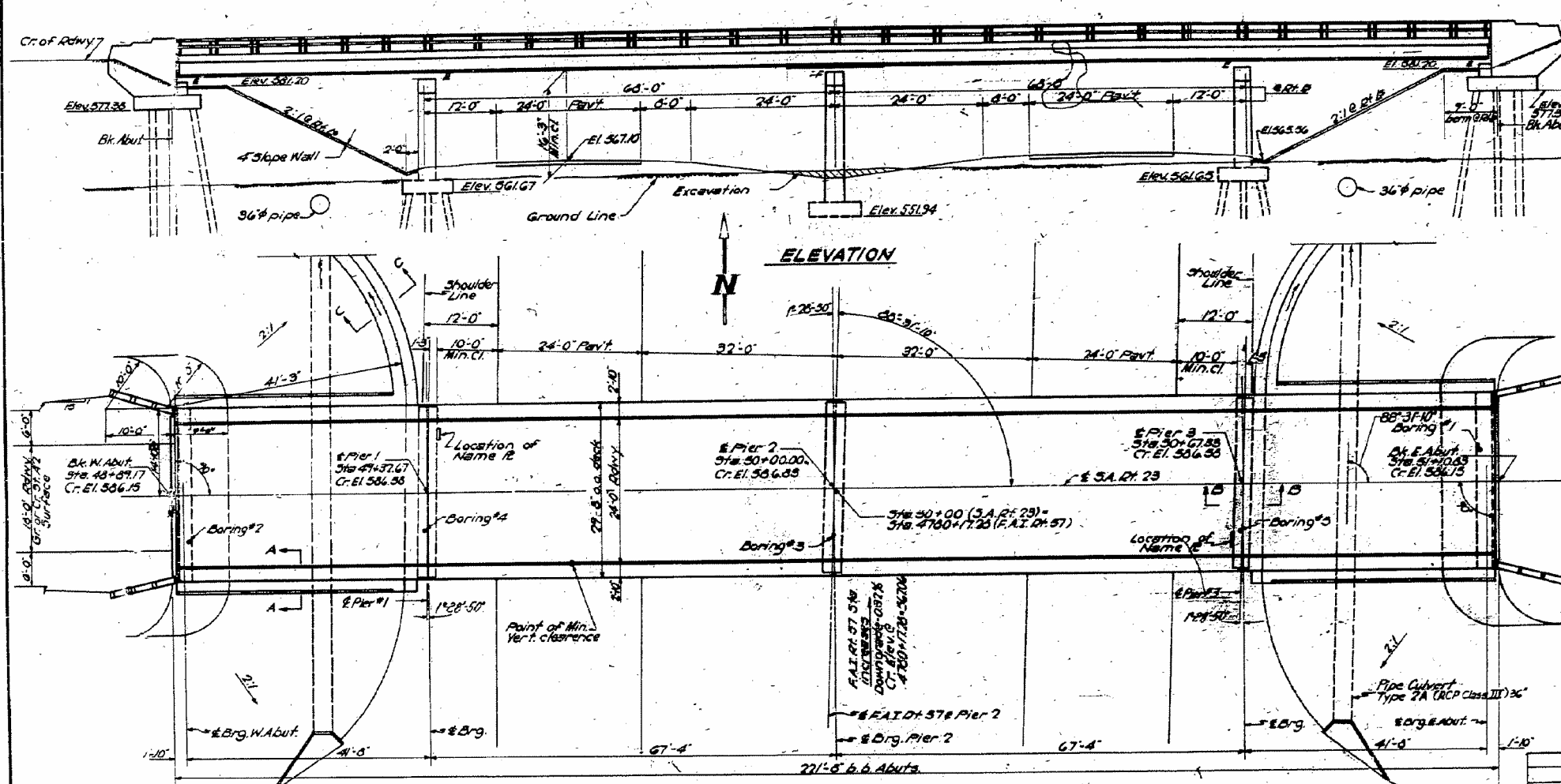

ELEVATION

PLAN

TOTAL BILL OF MATERIAL

ITEM	SUPER	SUB	TOTAL
Class X Excav. for Structures (Exc'd)		210.7	210.7
Class X Concrete	177.0	206.0	383.0
Furnishing & Erecting Struct. Steel Lbs.	155,870		155,870
Furnishing & Erecting Metal Handrail Lbs.	489.7		489.7
Reinforcement Bars Lbs.	29,150	14,740	43,890
Crescoted Piles up to 20' Lin. Ft.		350	350
Test Piles (Timber)	2		2
Concrete Piles Lin. Ft.		504	504
Test Piles (Concrete)	2		2
Name Plates	2		2
Slope Wall (4')	360		360

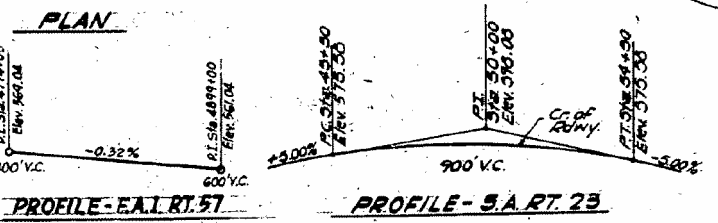
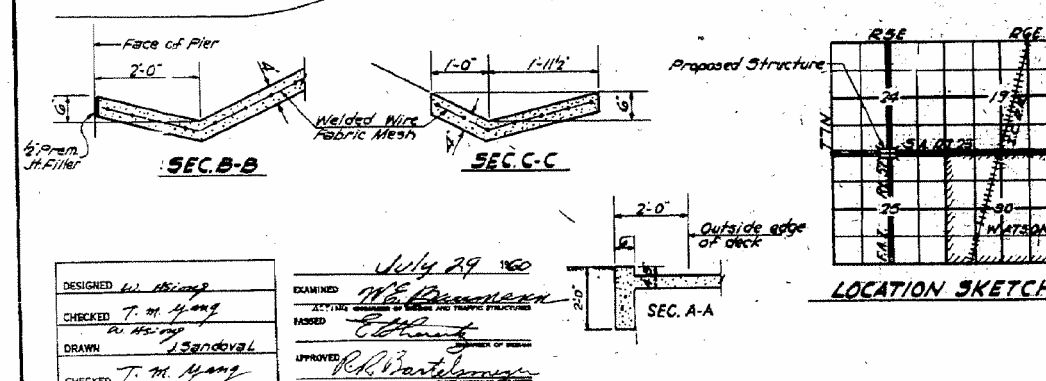

DESIGN STRESSES

Fc = 1400 psi. Super
Ft = 75 psi. Footings
Fs = 20,000 psi. Reinf.
Fp = 10,000 psi. Struct
n = 10
LOADING H15-312-44
Max. Soil Pressure = 8,000 psf

NAME PLATE LETTERING

See Sp. 215

PROJ. I-57-4 (L) 154
GENERAL PLAN & ELEVATION
S.A. RT. 23 OVER
F.A. RT. 57 SEC. 25-74B-1
EFFINGHAM COUNTY
STA. 4780+17.28

DESIGNED: W. H. Mason
CHECKED: T. M. Hagg
DRAWN: J. Sandoval
CHECKED: T. M. Hagg
EXAMINED: W. H. Mason
APPROVED: R. B. W. [Signature]
DATE: July 29 1960

STATION 4780+17.28
BUILT 1960 BY
STATE OF ILLINOIS
F.A. RT. 57 SEC. 25-74B-1
F.A. PROJ. I-57-4
LOADING H15-312