

NOTE: THIS SHEET REPRESENTS RAMP WORK ONLY.

HMA SURFACE REMOVAL  
(SEE SCHEDULES)

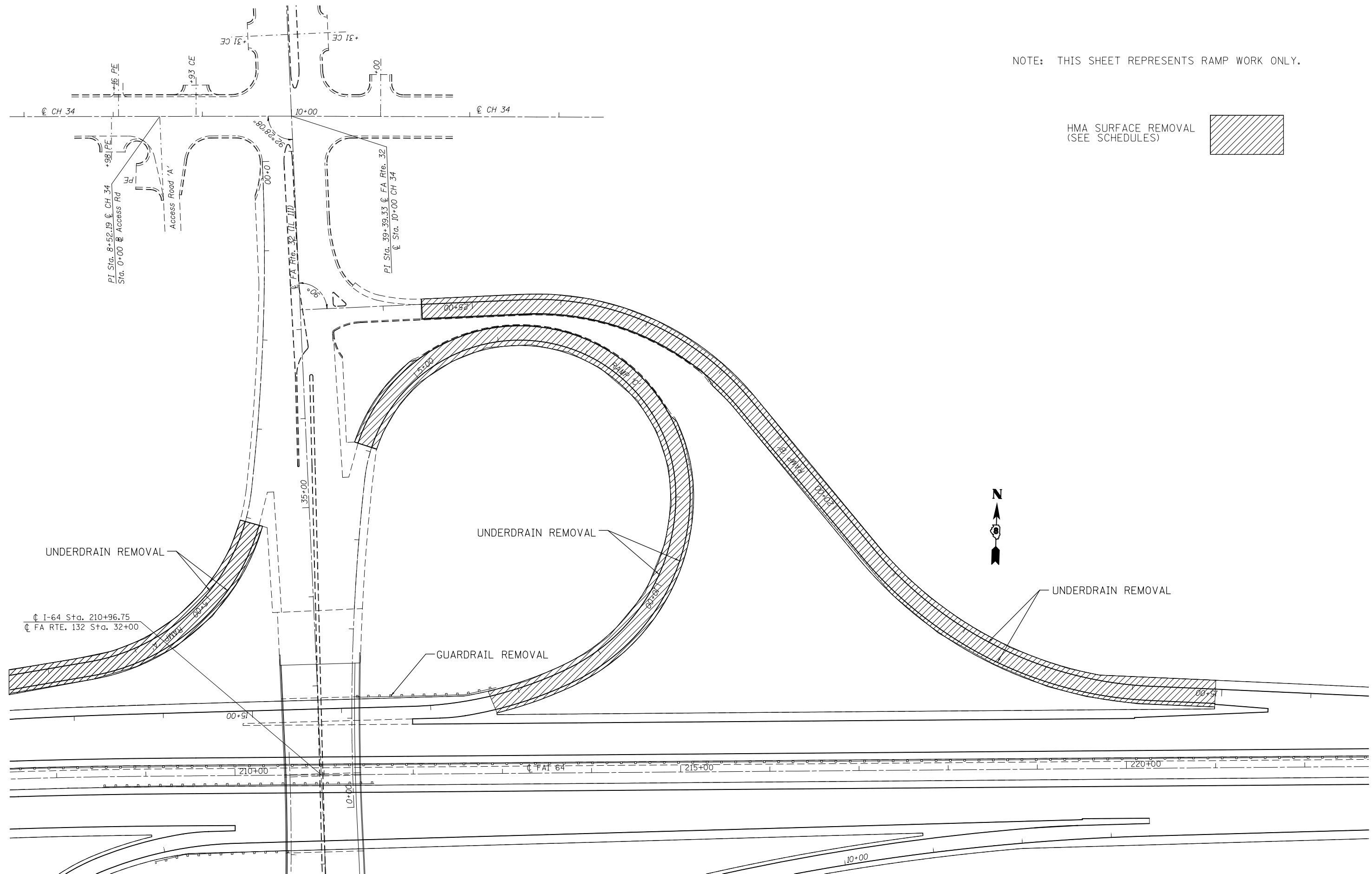
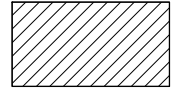

FILE NAME =	USER NAME = burnsideem	DESIGNED -	REVISED -
et:\pw_work\p\dot\burnsideem\d0146805\d876d22-sht-removal.dgn		DRAWN -	REVISED -
	PLOT SCALE = 100.0000' / in.	CHECKED -	REVISED -
	PLOT DATE = 8/16/2013	DATE -	REVISED -

**STATE OF ILLINOIS  
DEPARTMENT OF TRANSPORTATION**

**REMOVAL SHEET**

SCALE: 50'=1" SHEET NO. OF SHEETS STA. TO STA.

F.A.I. RTE.	SECTION	COUNTY	TOTAL SHEETS	SHEET NO.
64	82-(1,2,3,4)RS-1	ST. CLAIR	208	48
CONTRACT NO. 76D22				
FED. ROAD DIST. NO. ILLINOIS FED. AID PROJECT				