

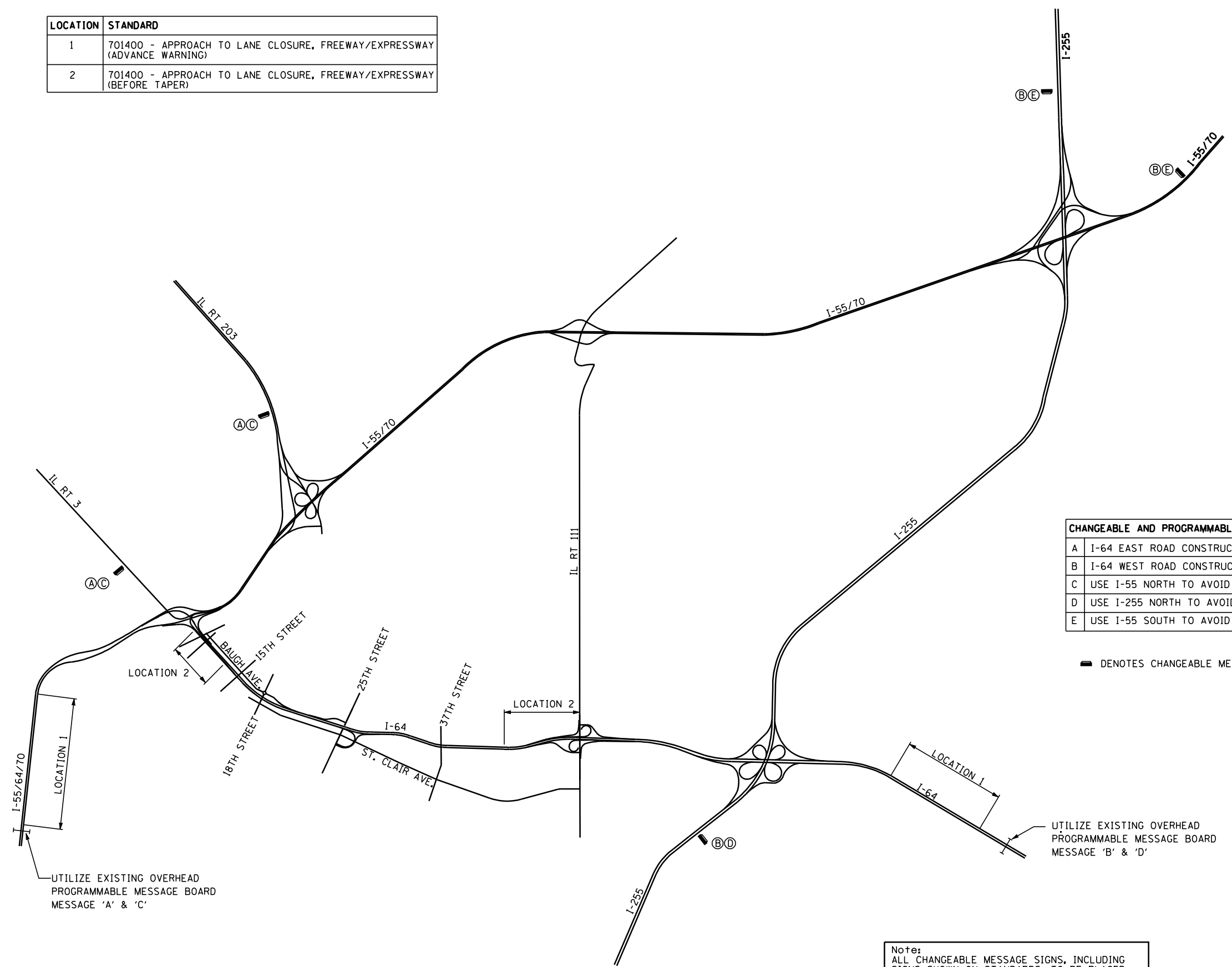

LOCATION	STANDARD
1	701400 - APPROACH TO LANE CLOSURE, FREEWAY/EXPRESSWAY (ADVANCE WARNING)
2	701400 - APPROACH TO LANE CLOSURE, FREEWAY/EXPRESSWAY (BEFORE TAPER)



CHANGEABLE AND PROGRAMMABLE SIGN "SUGGESTED TEXT"	
A	I-64 EAST ROAD CONSTRUCTION
B	I-64 WEST ROAD CONSTRUCTION
C	USE I-55 NORTH TO AVOID DELAYS
D	USE I-255 NORTH TO AVOID DELAYS
E	USE I-55 SOUTH TO AVOID DELAYS

— DENOTES CHANGEABLE MESSAGE SIGN

UTILIZE EXISTING OVERHEAD PROGRAMMABLE MESSAGE BOARD MESSAGE 'B' & 'D'

UTILIZE EXISTING OVERHEAD PROGRAMMABLE MESSAGE BOARD MESSAGE 'A' & 'C'

Note:
ALL CHANGEABLE MESSAGE SIGNS, INCLUDING SIGNS SHOWN ON STANDARDS, TO BE PLACED AS SHOWN ON THE PLANS OR AT THE DIRECTION OF THE ENGINEER.