

PLANS FOR PROPOSED ILLINOIS SAFE ROUTES TO SCHOOL SOUTH BROOKSIDE AVENUE SIDEWALK IMPROVEMENTS

FAU RTE.	SECTION	COUNTY	TOTAL SHEETS	SHEET NO.
8609	12-00102-00-SW	MARION	8	1
FEDERAL AID PROJECT			CONTRACT NO. 97538	

INDEX OF SHEETS

- 1 COVER SHEET
- 2 SUMMARY OF QUANTITIES, GENERAL NOTES AND UTILITIES
- 3 TYPICAL SECTIONS AND MISCELLANEOUS DETAILS
- 4 STORM SEWER STRUCTURES & SCHEDULES
- 5 GENERAL PLAN WEST SEVENTH STREET
- 6 PLAN & PROFILE - STA. 52+00 TO 58+00
- 7 PLAN & PROFILE - STA. 58+00 TO 64+00
- 8 PLAN & PROFILE - STA. 64+00 TO 67+00

FAU 8609 SECTION NO. 12-00102-00-SW PROJECT NO. SRTS-4009(140) JOB NO. C-98-339-12 CITY OF CENTRALIA, ILLINOIS



ILLINOIS DEPARTMENT OF TRANSPORTATION HIGHWAY STANDARDS	
000001-06	STANDARD SYMBOLS, ABBREVIATIONS AND PATTERNS
280001-07	TEMPORARY EROSION CONTROL SYSTEMS
424001-07	PERPENDICULAR CURB RAMPS FOR SIDEWALKS
442201-03	CLASS C AND D PATCHES
542301-03	PRECAST REINFORCED CONCRETE FLARED END SECTION
542606-02	REINFORCED CONCRETE PIPE TEE
602301-03	INLET - TYPE A
602401-03	MANHOLE TYPE A
602601-02	PRECAST REINFORCED CONCRETE FLAT SLAB TOP
602701-02	MANHOLE STEPS
604001-03	FRAME & LIDS TYPE 1
604006-04	FRAME AND GRATE TYPE 3
604036-02	GRATE TYPE B
606001-05	CONCRETE CURB TYPE B AND COMBINATION CONCRETE CURB & GUTTER
701301-04	LANE CLOSURE, 2L, 2W, SHORT TIME OPERATIONS
701501-06	URBAN LANE CLOSURE, 2L, 2W, UNDIVIDED
701801-05	SIDEWALK, CORNER OR CROSSWALK CLOSURE
701901-02	TRAFFIC CONTROL DEVICES
720001-01	SIGN PANEL MOUNTING DETAILS
720006-03	SIGN PANEL ERECTION DETAILS
720011-01	METAL POSTS FOR SIGNS, MARKERS & DELINEATORS
729001-01	APPLICATIONS OF TYPES A & B METAL POSTS
780001-03	TYPICAL PAVEMENT MARKINGS

J.U.L.I.E.
JOINT UTILITY LOCATION INFORMATION FOR EXCAVATION
1(800)992-0123 OR 811

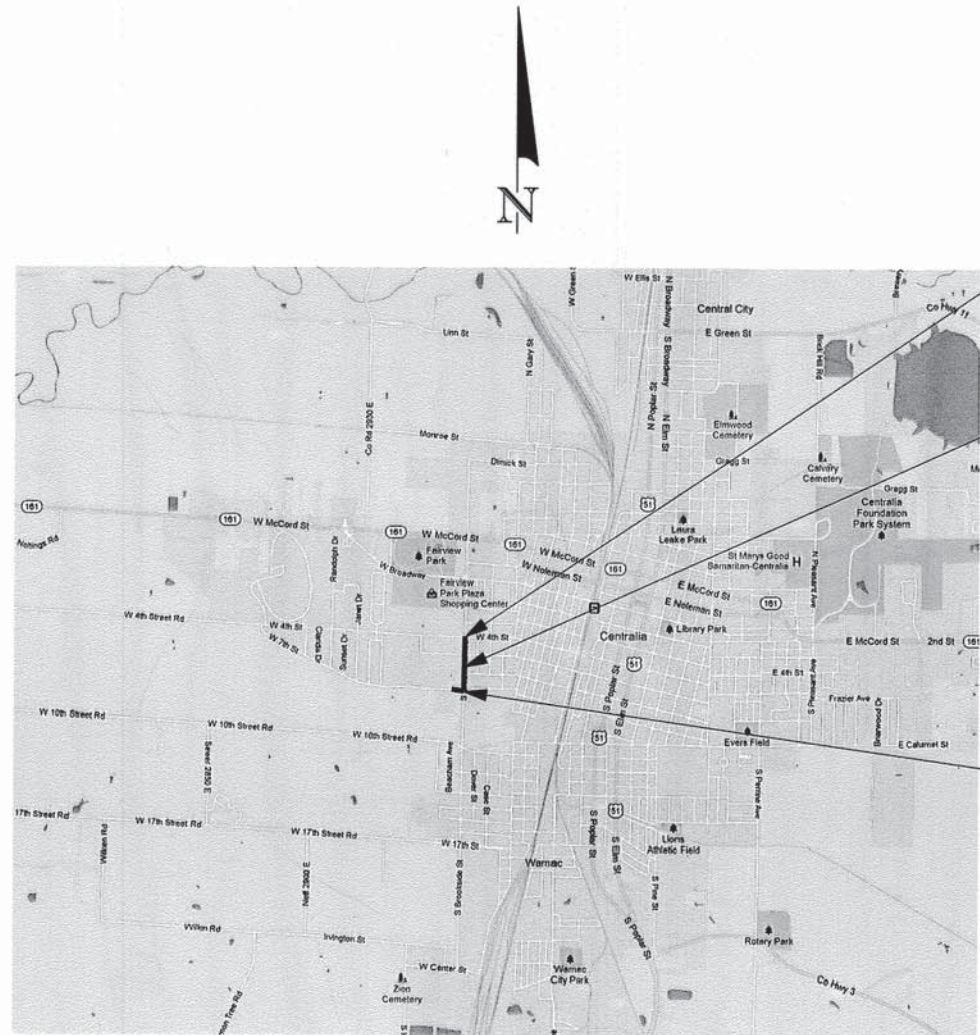

STA. 66+76.11
END SECTION
12-00102-00-SW
IMPROVEMENTS

PROJECT LOCATION

STA. 51+63
BEGIN SECTION
12-00102-00-SW
IMPROVEMENTS

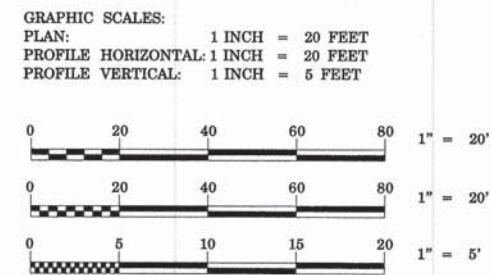

LOCATION MAP
NOT TO SCALE

TOTAL LENGTH OF PROJECT = 1513.11 FT. (0.287 MI.)
NET LENGTH OF PROJECT = 1513.11 FT. (0.287 MI.)

STATE OF ILLINOIS DEPARTMENT OF TRANSPORTATION	
APPROVED:	September 10 2013 <i>[Signature]</i> MAYOR
PASSED:	September 17 2013 <i>[Signature]</i> DISTRICT EIGHT ENGINEER OF LOCAL ROADS AND STREETS
RELEASING FOR BID BASED ON LIMITED REVIEW	September 17 2013 <i>[Signature]</i> DEPUTY DIRECTOR OF HIGHWAYS REGION FIVE ENGINEER
PRINTED BY AUTHORITY OF THE STATE OF ILLINOIS	

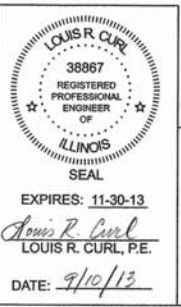

REVISIONS	DRAWN	DESIGNED
	IMC	LRC
	SURVEYED	CHK/APPRVD
	LGG	LRC

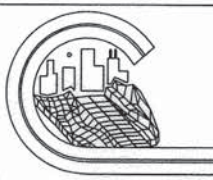

CURL & ASSOCIATES, INC.
CONSULTING ENGINEERS & LAND SURVEYORS
226 E. BROADWAY
P.O. BOX 1349
CENTRALIA, IL. 62801
PH. 618-533-4149
PROFESSIONAL DESIGN FIRM - 184-000877

COVER SHEET
ILLINOIS SAFE ROUTES TO SCHOOL
SOUTH BROOKSIDE AVENUE SIDEWALK IMPROVEMENTS
CENTRALIA, ILLINOIS

PROJ. NO.	C1026.1B
DATE	9/9/2013
SHEET NO.	1
OF 8 SHEETS	

GENERAL NOTES

- THIS SECTION SHALL BE CONSTRUCTED IN ACCORDANCE WITH THE "STANDARD SPECIFICATIONS FOR ROAD AND BRIDGE CONSTRUCTION" ADOPTED JANUARY 1, 2012.
- PLAN ELEVATIONS ARE BASED ON U.S.G.S. DATUM ELEVATIONS.
- THE WORK INCLUDED CONSISTS OF THE CONSTRUCTION OF PORTLAND CEMENT CONCRETE SIDEWALKS, AGGREGATE BASE, STORM SEWERS, PORTLAND CEMENT CONCRETE CURB AND GUTTER, AND OTHER ITEMS NECESSARY TO COMPLETE THE PROJECT.
- THE ROAD SHALL NOT CLOSED TO THRU TRAFFIC DURING CONSTRUCTION. SEE SPECIAL PROVISIONS FOR DETAILS.
- THE FOLLOWING IS A LIST OF THE UTILITIES:
 - ELECTRIC AND GAS**
AMEREN
1008 EAST FOURTEENTH
CENTRALIA, IL 62801
800-526-0844
 - TELEPHONE**
AT&T
800-222-0300
 - WATER & SEWER**
CITY OF CENTRALIA
114 E. 5TH ST.
CENTRALIA, IL 62801
618-533-7640
 - CABLE TELEVISION**
CHARTER COMMUNICATION
888-871-4485
- THE EXISTING SIGNS WHICH INTERFERE WITH THE CONSTRUCTION OPERATIONS SHALL BE REMOVED AND RESET AT DIRECTED BY THE ENGINEER. ANY DAMAGE TO EXISTING SIGNS SHALL BE THE RESPONSIBILITY OF THE CONTRACTOR AND SHALL BE REPAIRED OR REPLACED AT NO ADDITIONAL COST TO THE OWNER. THE COST FOR DOING THIS WORK WILL BE CONSIDERED INCIDENTAL TO THE CONTRACT AND NO ADDITIONAL COMPENSATION WILL BE ALLOWED.
- IF ASH TREES ARE REMOVED ON THE PROJECT, THE CONTRACTOR SHALL BECOME FAMILIAR WITH AND COMPLY WITH MEASURES SPECIFIED BY THE ILLINOIS DEPARTMENT OF AGRICULTURE (IDOA) TO PREVENT THE SPREAD OF THE EMERALD ASH BORE. THE IDOA INFORMATION FOR ASH TREE REMOVAL CAN BE FOUND ON THE IDOA WEBSITE AT WWW.AGR.STATE.IL.US/EAB.
- SEEDING IS REQUIRED AND WILL BE PAID AT ALL LOCATIONS WITHIN THE CONSTRUCTION LIMITS WHERE THE GROUND IS DISTURBED. AT ALL DISTURBED GROUND LOCATIONS OUTSIDE THE CONSTRUCTION LIMITS, THE CONTRACTOR SHALL SEED THOSE AREAS AT THE CONTRACTORS EXPENSE.
- THERE ARE NO PROJECT COMMITMENTS FOR THIS PROJECT.

DESIGN INFORMATION

1. SUMMARY OF EARTHWORK

BASED ON SHRINKAGE FACTOR OF 0.75 FOR ALL FILL AND ASSUMING ALL CUT IS AVAILABLE TO BE USED FOR EMBANKMENT FILL.

STA. TO STA.	EARTH EXCAVATION (CU. YD.)	EMBANKMENT (CU. YD.)	FURNISHED EXCAVATION (CU. YD.)
52+03 TO 61+02	60	320	280

A QUANTITY DEDUCTION HAS BEEN MADE FOR THE TRENCH BACKFILL REQUIRED BETWEEN STORM SEWER STRUCTURES 3 & 4
NO PAYMENT WILL BE ALLOWED FOR OVERHAUL OF EARTH TO OR FROM ANY SOURCE. NET WASTE EARTHEN MATERIAL = 0 CU. YD.

2. SEEDING

THE FOLLOWING ESTIMATED QUANTITIES ARE BASED ON SEEDING FROM R.O.W. TO EDGE OF PAVEMENT WITH APPROPRIATE DEDUCTION FOR SIDEWALKS, PAVEMENT, SHOULDERS, AND DRIVEWAYS, FROM STA. 50+31.65 TO STA. 66+76.11.

APPLICATION RATES:

60 LBS./ACRE	NITROGEN FERTILIZER NUTRIENT	= 0.2 ACRES
200 LBS./ACRE	PHOSPHORUS FERTILIZER NUTRIENT	= 12 LBS.
60 LBS./ACRE	POTASSIUM FERTILIZER NUTRIENT	= 40 LBS.
2 TON/ACRE	MULCH (METHOD 1)	= 12 LBS.
		= 0.4 TONS

SUMMARY OF SEEDING

SEEDING, CLASS 1 (SPECIAL)	= 0.2 ACRES
NITROGEN FERTILIZER NUTRIENT	= 12 LBS.
PHOSPHORUS FERTILIZER NUTRIENT	= 40 LBS.
POTASSIUM FERTILIZER NUTRIENT	= 12 LBS.
MULCH (METHOD 1)	= 0.4 TONS

3. AGGREGATE BASE COURSE, TYPE B

PLAN QUANTITY INCLUDES ALLOWANCE FOR THE ADDITIONAL EXCAVATION NECESSARY TO REMOVE TREE ROOTS TO A DEPTH OF 6 INCHES BELOW SIDEWALK SUBGRADE.

4. AGGREGATE FOR TEMPORARY ACCESS

PLAN QUANTITY INCLUDES ALLOWANCE FOR USE TO MAINTAIN ENTRANCE ACCESS TO THE EXISTING RESIDENCES.

SUMMARY OF QUANTITIES			
CODE NUMBER	ITEM	UNIT	TOTAL QUANTITY
20100110	TREE REMOVAL (6 TO 15 UNITS DIAMETER)	UNIT	58
20100210	TREE REMOVAL (OVER 15 UNITS DIAMETER)	UNIT	96
20200100	EARTH EXCAVATION	CU YD	60
20400800	FURNISHED EXCAVATION	CU YD	280
20800150	TRENCH BACKFILL	CU YD	112
35101400	AGGREGATE BASE COURSE, TYPE B	TON	16
40201000	AGGREGATE FOR TEMPORARY ACCESS	TON	40
42300200	PORTLAND CEMENT CONCRETE DRIVEWAY PAVEMENT, 6 INCH	SQ YD	44.6
42400100	PORTLAND CEMENT CONCRETE SIDEWALK 4 INCH	SQ FT	7426
42400300	PORTLAND CEMENT CONCRETE SIDEWALK 6 INCH	SQ FT	529
42400800	DETECTABLE WARNINGS	SQ FT	171
44000200	DRIVEWAY PAVEMENT REMOVAL	SQ YD	73.4
44000500	COMBINATION CURB AND GUTTER REMOVAL	FOOT	72
44000600	SIDEWALK REMOVAL	SQ FT	689
44201321	CLASS C PATCHES, TYPE III, 7 INCH	SQ YD	15.0
50105220	PIPE CULVERT REMOVAL	FOOT	109
54213657	PRECAST REINFORCED CONCRETE FLARED END SECTIONS 12"	EACH	3
54216180	REINFORCED CONCRETE PIPE TEE, 12" PIPE WITH 12" RISER	EACH	2
550A0050	STORM SEWERS, CLASS A, TYPE 1 12"	FOOT	526
56500600	DOMESTIC WATER SERVICE BOXES TO BE ADJUSTED	EACH	6
60218300	MANHOLES, TYPE A, 4'-DIAMETER, TYPE 1 FRAME, OPEN LID	EACH	1
60218400	MANHOLES, TYPE A, 4'-DIAMETER, TYPE 1 FRAME, CLOSED LID	EACH	1
60235700	INLETS, TYPE A, TYPE 3 FRAME AND GRATE	EACH	5
60236200	INLETS, TYPE A, TYPE 8 GRATE	EACH	1
60255500	MANHOLES TO BE ADJUSTED	EACH	1
60260300	INLETS TO BE ADJUSTED WITH NEW TYPE 1 FRAME, OPEN LID	EACH	1
60500060	REMOVING INLETS	EACH	2
60603800	COMBINATION CONCRETE CURB AND GUTTER, TYPE B-6.12	FOOT	46
60605000	COMBINATION CONCRETE CURB AND GUTTER, TYPE B-6.24	FOOT	927
67100100	MOBILIZATION	L SUM	1
70102620	TRAFFIC CONTROL AND PROTECTION, STANDARD 701501	L SUM	1
70102640	TRAFFIC CONTROL AND PROTECTION, STANDARD 701801	L SUM	1
72900200	METAL POST - TYPE B	FOOT	217
* 78001130	PAINT PAVEMENT MARKING - LINE 6"	FOOT	599
* X0326899	SOLAR POWERED FLASHING BEACON ASSEMBLY (COMPLETE)	EACH	2
X2500900	SEEDING, CLASS 1 (SPECIAL)	ACRE	0.2
X7200105	SIGN PANEL - TYPE 1 (SPECIAL)	SQ FT	93
* XX008710	PAVEMENT MARKING (SPECIAL)	SQ FT	1777

* DENOTES SPECIALTY ITEMS

REVISIONS	DRAWN IMC	DESIGNED LRC

SURVEYED LGG	CHK/APPRVD LRC



CURL & ASSOCIATES, INC.

CONSULTING ENGINEERS & LAND SURVEYORS

226 E. BROADWAY
P.O. BOX 1349
CENTRALIA, IL 62801
PH. 618-533-4149

PROFESSIONAL DESIGN FIRM - 184-000877

SUMMARY OF QUANTITIES, GENERAL NOTES AND UTILITIES
ILLINOIS SAFE ROUTES TO SCHOOL
SOUTH BROOKSIDE AVENUE SIDEWALK IMPROVEMENTS
CENTRALIA, ILLINOIS

PROJ. NO. C1026.1B

DATE 9/9/2013

SHEET NO.

2

OF 8 SHEETS

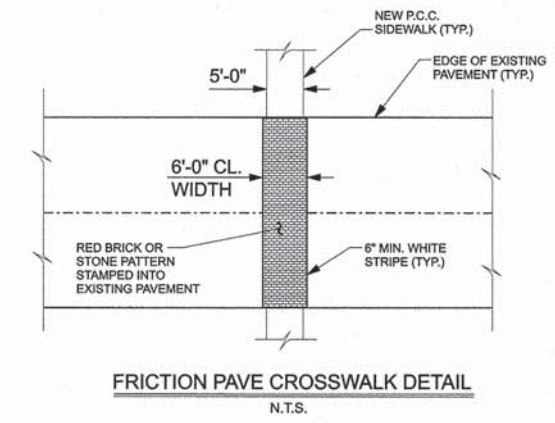
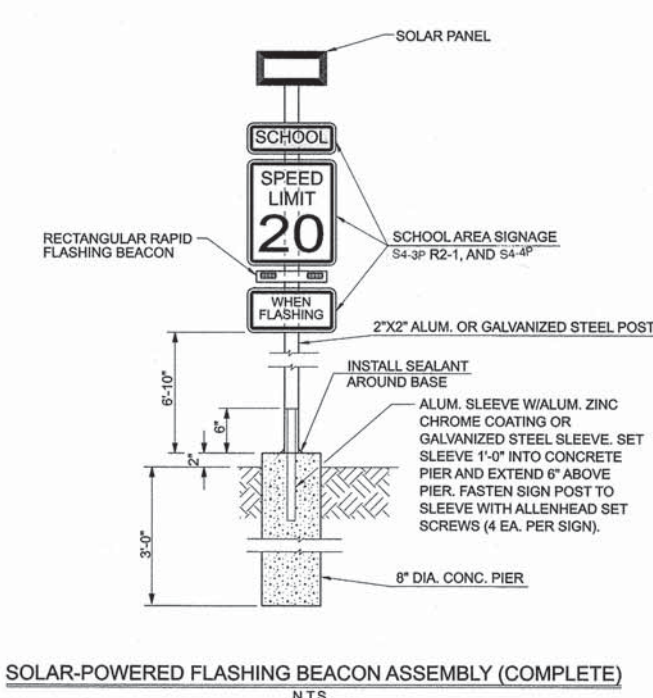
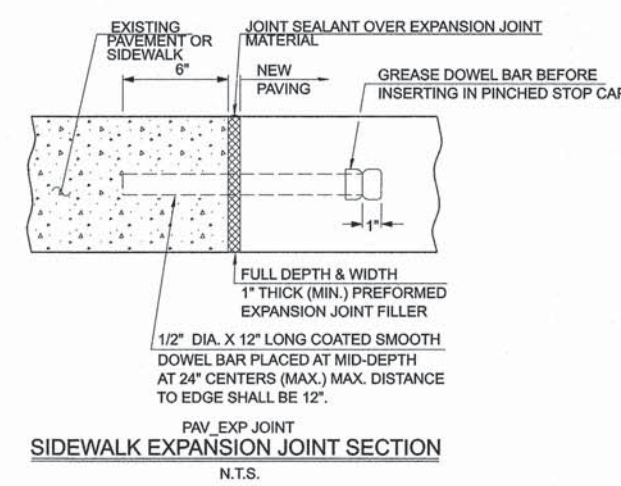
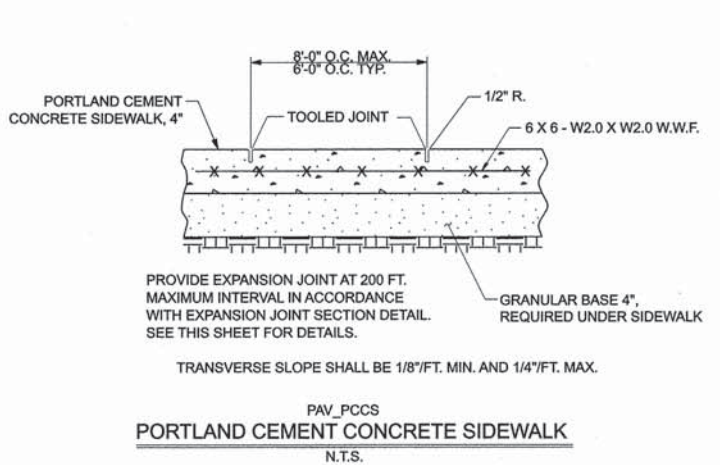
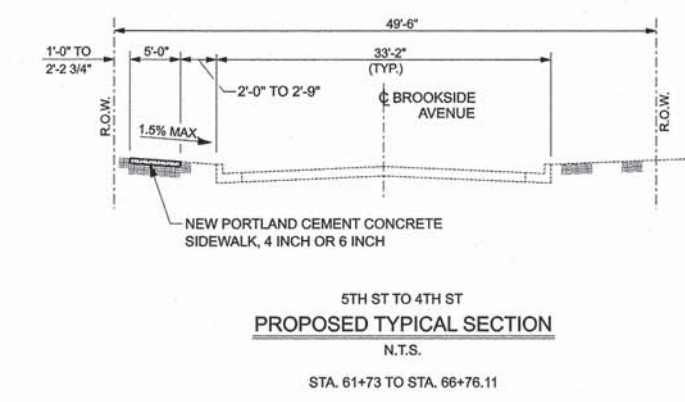
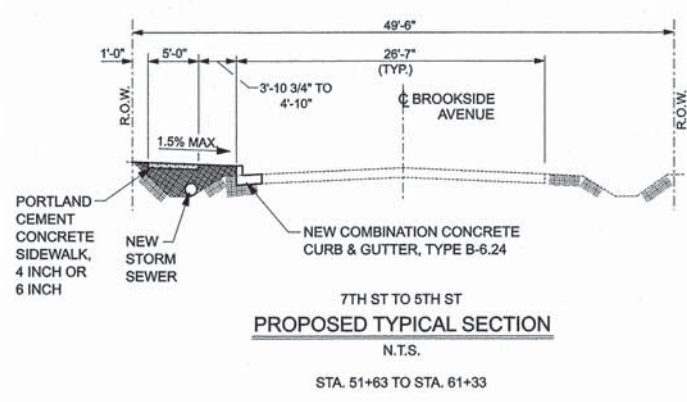
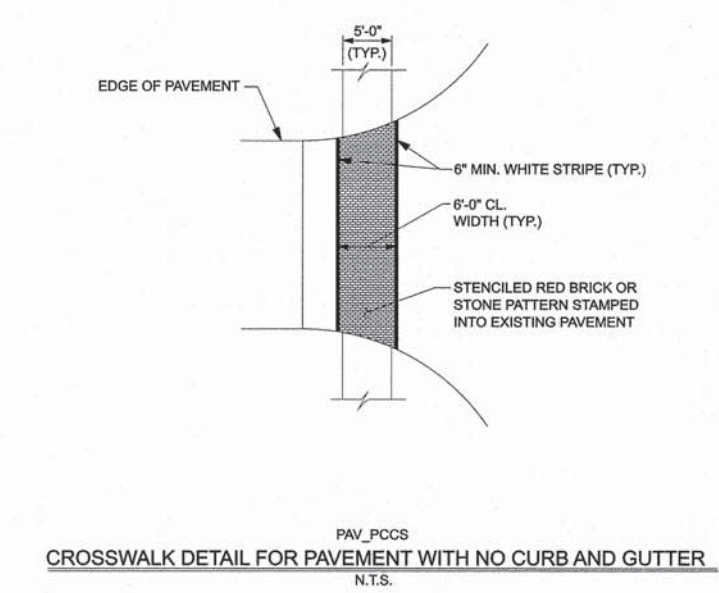
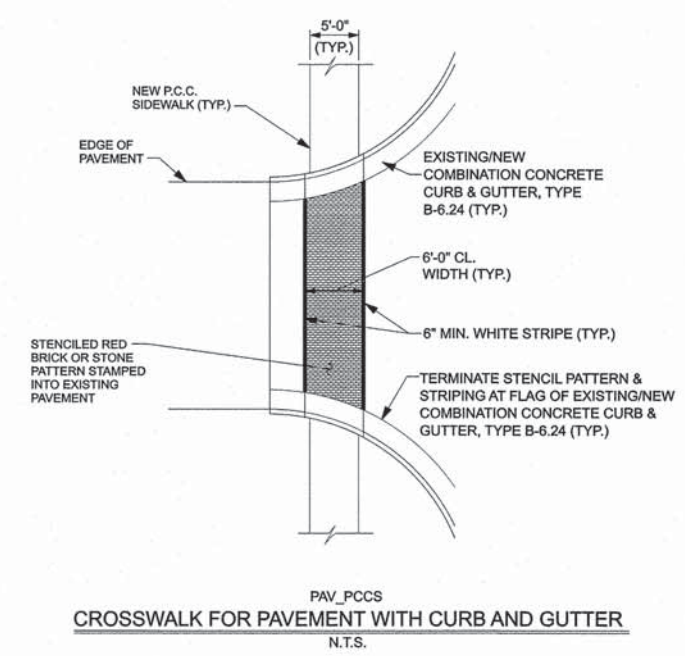
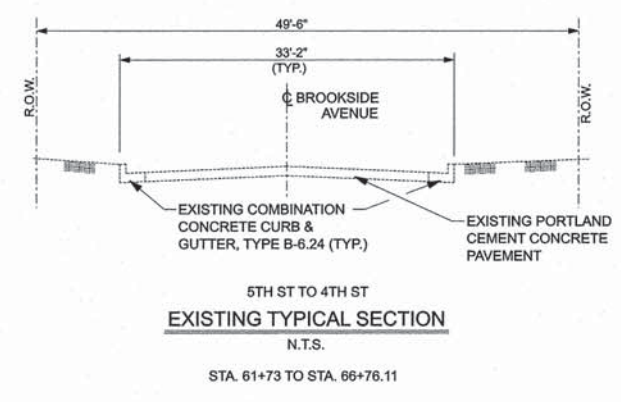
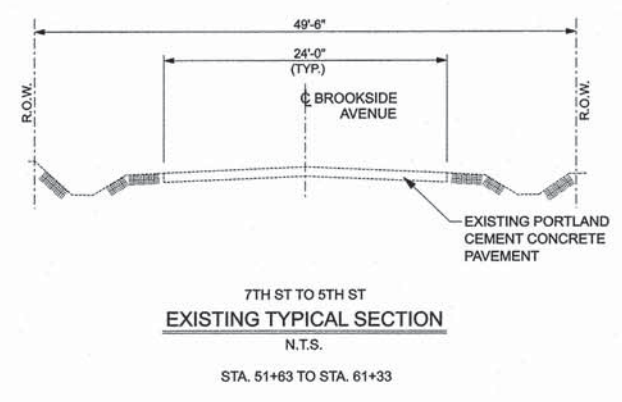

REVISIONS	DRAWN	DESIGNED
	IMC	LRG
	SURVEYED	CHK/APPRVD
	LGG	LRG

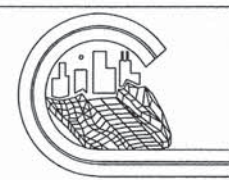

CURL & ASSOCIATES, INC.
CONSULTING ENGINEERS & LAND SURVEYORS
226 E. BROADWAY
P.O. BOX 1349
CENTRALIA, IL. 62801
PH. 618-533-4149
PROFESSIONAL DESIGN FIRM - 184-000877

TYPICAL SECTIONS AND MISCELLANEOUS DETAILS
ILLINOIS SAFE ROUTES TO SCHOOL
SOUTH BROOKSIDE AVENUE SIDEWALK IMPROVEMENTS
CENTRALIA, ILLINOIS

PROJ. NO.	C1026.1B
DATE	9/9/2013
SHEET NO.	3
OF 8 SHEETS	

J:\C\U\101026 IL Safe Route\1026.1B\working

STORM SEWER STRUCTURES										
PT.	OFFSET	STATION	STRUCTURE TYPE	*TOP OF STRUCTURE OR FLAT SLAB ELEV.	*TOP OF LID OR FLOWLINE OF GRATE ELEV.	INV. ELEV.	INV. ELEV.	INV. ELEV.	INV. ELEV.	
1	99.0' RT	100+33.2	PRECAST REINFORCED CONCRETE FLARED END SECTION 12"	---	---	475.90				▽
2	91.3' RT	100+33.4	PRECAST REINFORCED CONCRETE FLARED END SECTION 12"	---	---	475.78				▽
3	20.0' LT.	56+50	MANHOLE, TYPE A, 4' DIA., TYPE 1 FRAME, CLOSED LID	486.25	487.00	483.25	482.85			⊙
						(E)	(S)			
4	20.0' LT.	52+50	MANHOLE, TYPE A, 4' DIA., TYPE 1 FRAME, OPEN LID	478.95	479.70	476.00	476.14	475.80		⊙
						(N)	(E)	(S)		
5	20.0' LT.	51+63.2	PRECAST REINFORCED CONCRETE FLARED END SECTION 12"	---	---	474.86				▽
6	48.1' LT.	52+90.8	INLET, TYPE A, TYPE 8 GRATE	477.27	477.35	475.77				□
7	20.0' LT.	52.90.8	REINFORCED CONCRETE PIPE TEE, 12" PIPE WITH 12" RISER	---	---	475.55				⊥
						(N,S,W)				
8	13.7' LT.	52+50	INLET, TYPE A, TYPE 3 FRAME AND GRATE (DELTA (TYP.) = 0.04')	477.68	478.37	476.18				□
9	13.7' LT.	54.5	INLET, TYPE A, TYPE 3 FRAME AND GRATE	480.78	481.47	479.28				□
10	20.0' LT	54+50	REINFORCED CONCRETE PIPE TEE, 12" PIPE WITH 12" RISER	---	---	479.65				⊥
						(N,S,E)				
11	13.7' LT.	56+50	INLET, TYPE A, TYPE 3 FRAME AND GRATE	485.17	485.86	483.17				□
12	14.5' LT.	58+99.5	INLET, TYPE A, TYPE 3 FRAME AND GRATE (CONNECT TO EX. 12")	490.24	490.93	488.22 +/-				□
						(EX.)				
13	14.4' LT.	59+99.1	INLET, TYPE A, TYPE 3 FRAME AND GRATE (CONNECT TO EX. 12")	490.68	491.37	488.41 +/-				□
						(EX.)				

* => ALL TOP OF FLAT SLAB OR CONE ELEVATIONS AND LID/FLOWLINE ELEVATIONS SHALL BE CONFIRMED IN THE FIELD PRIOR TO INSTALLATION.

STORM SEWER SCHEDULE						
PT.	PT.	SLOPE (%)	CLASS A, TYPE 1 12" DIA. (FOOT)	TRENCH BACKFILL (CU. YD.)	NOTES	
1-	2	0.52	11	1.2	ALLOWS 2' SHOULDER	
3-	4	1.60	397	95.8		
4-	5	1.10	79	12.0		
6-	7	0.85	26	1.3		
8-	4	1.00	4	0.5		
9-	10	2.60	5	0.7		
11-	3	10.50	4	0.7		
TOTALS				526	0	0
**LENGTHS SHOWN DO NOT INCLUDE END SECTION LENGTHS						

QUANTITIES COMPILED PER SHEET									
CODE NUMBER	ITEM	UNIT	TOTAL QUANTITY	SHEET #5	SHEET #6	SHEET #7	SHEET #8	ALLOWANCE	
20100110	TREE REMOVAL (6 TO 15 UNITS DIAMETER)	UNIT	58		24.0	34.0			
20100210	TREE REMOVAL (OVER 15 UNITS DIAMETER)	UNIT	96			96.0			
20200100	EARTH EXCAVATION	CU YD	60						
20400800	FURNISHED EXCAVATION	CU YD	280						
20800150	TRENCH BACKFILL	CU YD	112						
35101400	AGGREGATE BASE COURSE, TYPE B	TON	16					16.0	
40201000	AGGREGATE FOR TEMPORARY ACCESS	TON	40					40.0	
42300200	PORTLAND CEMENT CONCRETE DRIVEWAY PAVEMENT, 6 INCH	SQ YD	44.6			44.6			
42400100	PORTLAND CEMENT CONCRETE SIDEWALK 4 INCH	SQ FT	7426	422.6	3274.0	2537.0	1192.6		
42400300	PORTLAND CEMENT CONCRETE SIDEWALK 6 INCH	SQ FT	529			401.6	127.7		
42400800	DETECTABLE WARNINGS	SQ FT	171		84.8	42.8	43.6		
44000200	DRIVEWAY PAVEMENT REMOVAL	SQ YD	73.4			73.4			
44000400	COMBINATION CURB AND GUTTER REMOVAL	FOOT	72			38.1	33.7		
44000600	SIDEWALK REMOVAL	SQ FT	689		282.1	134.3	272.1		
44201821	CLASS C PATCHES, TYPE III, 7 INCH	SQ YD	15.0		15.0				
50102200	PIPE CULVERT REMOVAL	FOOT	109		60.7	48.0			
54213657	PRECAST REINFORCED CONCRETE FLARED END SECTIONS 12"	EACH	3						
54216180	REINFORCED CONCRETE PIPE TEE, 12" PIPE WITH 12" RISER	EACH	2						
550A0050	STORM SEWERS, CLASS A, TYPE 1 12"	FOOT	526						
56500600	DOMESTIC WATER SERVICE BOXES TO BE ADJUSTED	EACH	6		1.0	4.0	1.0		
60213300	MANHOLES, TYPE A, 4'-DIAMETER, TYPE 1 FRAME, OPEN LID	EACH	1						
60213400	MANHOLES, TYPE A, 4'-DIAMETER, TYPE 1 FRAME, CLOSED LID	EACH	1						
60235700	INLETS, TYPE A, TYPE 3 FRAME AND GRATE	EACH	5						
60236200	INLETS, TYPE A, TYPE 8 GRATE	EACH	1						
60255400	MANHOLES TO BE ADJUSTED	EACH	1					1.0	
60260300	INLETS TO BE ADJUSTED WITH NEW TYPE 1 FRAME, OPEN LID	EACH	1			1.0			
60500060	REMOVING INLETS	EACH	2			2.0			
60603800	COMBINATION CONCRETE CURB AND GUTTER, TYPE B-6.12	FOOT	46		45.6				
60605000	COMBINATION CONCRETE CURB AND GUTTER, TYPE B-6.24	FOOT	927		553.0	340.1	33.7		
67100100	MOBILIZATION	L SUM	1						
70102620	TRAFFIC CONTROL AND PROTECTION, STANDARD 701501	L SUM	1						
70102640	TRAFFIC CONTROL AND PROTECTION, STANDARD 701801	L SUM	1						
72900200	METAL POST - TYPE B	FOOT	217		155.0	62.0			
78001130	PAINT PAVEMENT MARKING - LINE 6"	FOOT	599		302.1	139.8	157.5		
X0326899	SOLAR POWERED FLASHING BEACON ASSEMBLY (COMPLETE)	EACH	2		2.0				
X2500900	SEEDING, CLASS 1 (SPECIAL)	ACRE	0.2						
X7200105	SIGN PANEL - TYPE 1 (SPECIAL)	SQ FT	93		71.0	22.0			
	FRICIONPAVE STAMPED/STENCILED PAVEMENT MARKING	SQ FT	1777		899.0	410.0	468.0		

REVISIONS	DRAWN IMC	DESIGNED LRC
	SURVEYED LGG	CHK/APPRVD LRC



CURL & ASSOCIATES, INC.
CONSULTING ENGINEERS & LAND SURVEYORS
226 E. BROADWAY
P.O. BOX 1349
CENTRALIA, IL. 62801
PH. 618-533-4149
PROFESSIONAL DESIGN FIRM - 184-000877

STORM SEWER STRUCTURES & SCHEDULES
ILLINOIS SAFE ROUTES TO SCHOOL
SOUTH BROOKSIDE AVENUE SIDEWALK IMPROVEMENTS
CENTRALIA, ILLINOIS

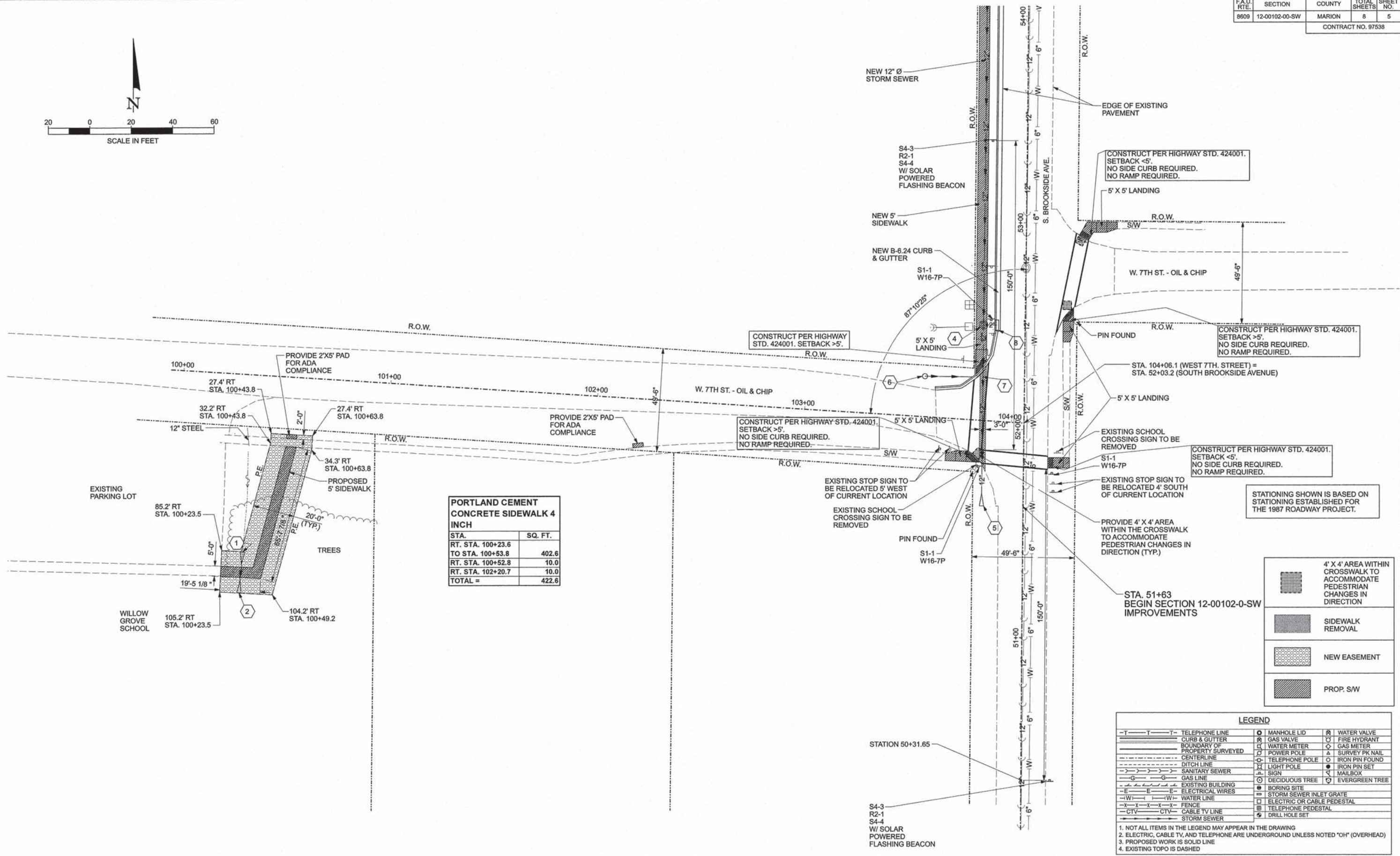
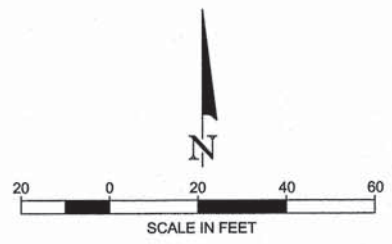

STA.	SQ. FT.
RT. STA. 100+23.6 TO STA. 100+53.8	402.6
RT. STA. 100+52.8	10.0
RT. STA. 102+20.7	10.0
TOTAL =	422.6

	4' X 4' AREA WITHIN CROSSWALK TO ACCOMMODATE PEDESTRIAN CHANGES IN DIRECTION
	SIDEWALK REMOVAL
	NEW EASEMENT
	PROP. SW

LEGEND			
	TELEPHONE LINE		MANHOLE LID
	CURB & GUTTER		GAS VALVE
	BOUNDARY OF PROPERTY SURVEYED		FIRE HYDRANT
	CENTERLINE		WATER METER
	DITCH LINE		GAS METER
	SANITARY SEWER		POWER POLE
	GAS LINE		SURVEY PK NAIL
	EXISTING BUILDING		TELEPHONE POLE
	ELECTRICAL WIRES		LIGHT POLE
	WATER LINE		SIGN
	FENCE		IRON PIN FOUND
	CABLE TV LINE		IRON PIN SET
	STORM SEWER		MAILBOX
			DECIDUOUS TREE
			EVERGREEN TREE
			BORING SITE
			STORM SEWER INLET GRATE
			ELECTRIC OR CABLE PEDESTAL
			TELEPHONE PEDESTAL
			DRILL HOLE SET

1. NOT ALL ITEMS IN THE LEGEND MAY APPEAR IN THE DRAWING
 2. ELECTRIC, CABLE TV, AND TELEPHONE ARE UNDERGROUND UNLESS NOTED "OH" (OVERHEAD)
 3. PROPOSED WORK IS SOLID LINE
 4. EXISTING TOPO IS DASHED

REVISIONS	DRAWN	DESIGNED
	IMC	LRG
	SURVEYED	CHK/APPRVD
	LGG	LRG

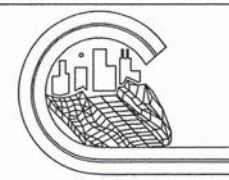

CURL & ASSOCIATES, INC.
 CONSULTING ENGINEERS & LAND SURVEYORS
 226 E. BROADWAY
 P.O. BOX 1349
 CENTRALIA, IL. 62801
 PH. 618-533-4149
 PROFESSIONAL DESIGN FIRM - 184-000877

**GENERAL PLAN - WEST SEVENTH STREET
 ILLINOIS SAFE ROUTES TO SCHOOL
 SOUTH BROOKSIDE AVENUE SIDEWALK IMPROVEMENTS
 CENTRALIA, ILLINOIS**

PROJ. NO.	C1026.1B
DATE	9/9/2013
SHEET NO.	5
OF 8 SHEETS	

J:\C\J\101026 IL Safe Routes\1026.1B\working\

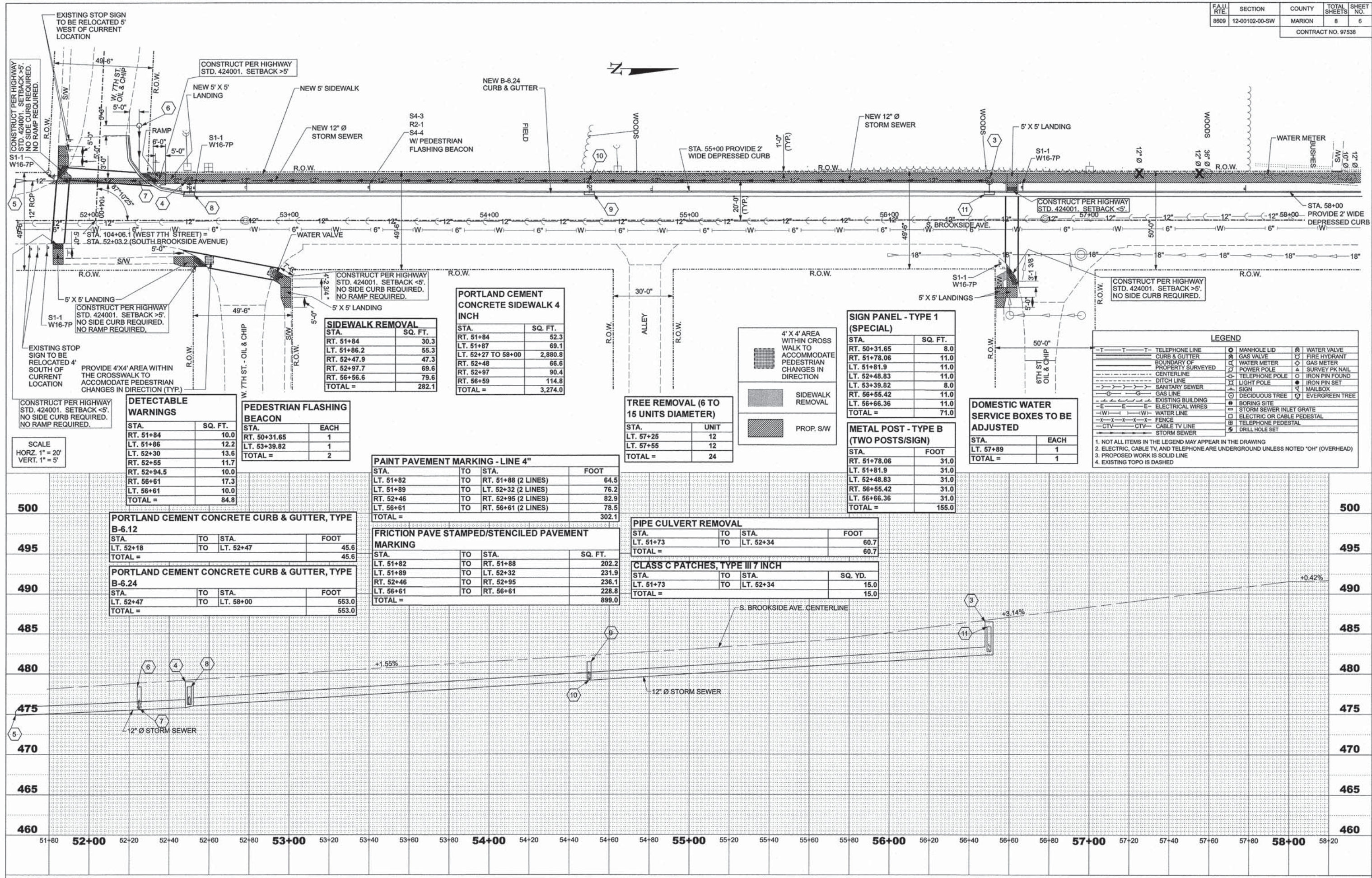

SCALE
HORZ. 1" = 20'
VERT. 1" = 5'

STA.	SQ. FT.
RT. 51+84	10.0
LT. 51+86	12.2
LT. 52+30	13.6
RT. 52+55	11.7
RT. 52+94.5	10.0
RT. 56+61	17.3
LT. 56+61	10.0
TOTAL =	84.8

STA.	EACH
RT. 50+31.65	1
LT. 53+39.82	1
TOTAL =	2

STA.	SQ. FT.
RT. 51+84	30.3
LT. 51+86.2	55.3
RT. 52+47.9	47.3
RT. 52+97.7	69.6
RT. 56+59.6	79.6
TOTAL =	282.1

STA.	SQ. FT.
RT. 51+84	52.3
LT. 51+87	69.1
LT. 52+27 TO 58+00	2,880.8
RT. 52+48	66.6
RT. 52+97	90.4
RT. 56+59	114.8
TOTAL =	3,274.0

STA.	TO	STA.	FOOT
LT. 51+82	TO	RT. 51+88 (2 LINES)	64.5
LT. 51+89	TO	LT. 52+32 (2 LINES)	76.2
RT. 52+46	TO	RT. 52+95 (2 LINES)	82.9
LT. 56+61	TO	RT. 56+61 (2 LINES)	78.5
TOTAL =			302.1

STA.	TO	STA.	SQ. FT.
LT. 51+82	TO	RT. 51+88	202.2
LT. 51+89	TO	LT. 52+32	231.9
RT. 52+46	TO	RT. 52+95	236.1
LT. 56+61	TO	RT. 56+61	228.8
TOTAL =			899.0

STA.	TO	STA.	FOOT
LT. 51+73	TO	LT. 52+34	60.7
TOTAL =			60.7

STA.	TO	STA.	SQ. YD.
LT. 51+73	TO	LT. 52+34	15.0
TOTAL =			15.0

STA.	SQ. FT.
RT. 50+31.65	8.0
RT. 51+78.06	11.0
LT. 51+81.9	11.0
LT. 52+48.83	11.0
LT. 53+39.82	8.0
RT. 56+55.42	11.0
LT. 56+66.36	11.0
TOTAL =	71.0

STA.	FOOT
RT. 51+78.06	31.0
LT. 51+81.9	31.0
LT. 52+48.83	31.0
RT. 56+55.42	31.0
LT. 56+66.36	31.0
TOTAL =	155.0

STA.	EACH
LT. 57+89	1
TOTAL =	1

LEGEND			
— T — T — T —	TELEPHONE LINE	○	MANHOLE LID
— C — C — C —	CURB & GUTTER	⊗	GAS VALVE
— B — B — B —	BOUNDARY OF PROPERTY SURVEYED	⊕	WATER METER
— C — C — C —	CENTERLINE	⊕	GAS METER
— D — D — D —	DITCH LINE	⊕	SURVEY PK NAIL
— S — S — S —	SANITARY SEWER	⊕	TELEPHONE POLE
— G — G — G —	GAS LINE	⊕	LIGHT POLE
— E — E — E —	EXISTING BUILDING	⊕	SIGN
— W — W — W —	ELECTRICAL WIRES	⊕	DECIDUOUS TREE
— W — W — W —	WATER LINE	⊕	EVERGREEN TREE
— X — X — X —	FENCE	⊕	BORING SITE
— CTV — CTV —	CABLE TV LINE	⊕	STORM SEWER INLET GRATE
— S — S — S —	STORM SEWER	⊕	ELECTRIC OR CABLE PEDESTAL
		⊕	TELEPHONE PEDESTAL
		⊕	DRILL HOLE SET
		⊕	WATER VALVE
		⊕	FIRE HYDRANT
		⊕	GAS METER
		⊕	SURVEY PK NAIL
		⊕	IRON PIN FOUND
		⊕	IRON PIN SET
		⊕	MAILBOX

- NOT ALL ITEMS IN THE LEGEND MAY APPEAR IN THE DRAWING
- ELECTRIC, CABLE TV, AND TELEPHONE ARE UNDERGROUND UNLESS NOTED "OH" (OVERHEAD)
- PROPOSED WORK IS SOLID LINE
- EXISTING TOPO IS DASHED

ILLINOIS SAFE ROUTES TO SCHOOL - PLAN & PROFILE - STA. 52+00 TO 58+00

J:\C\C\101026 IL Safe Routes\1026.tb\WORKING\

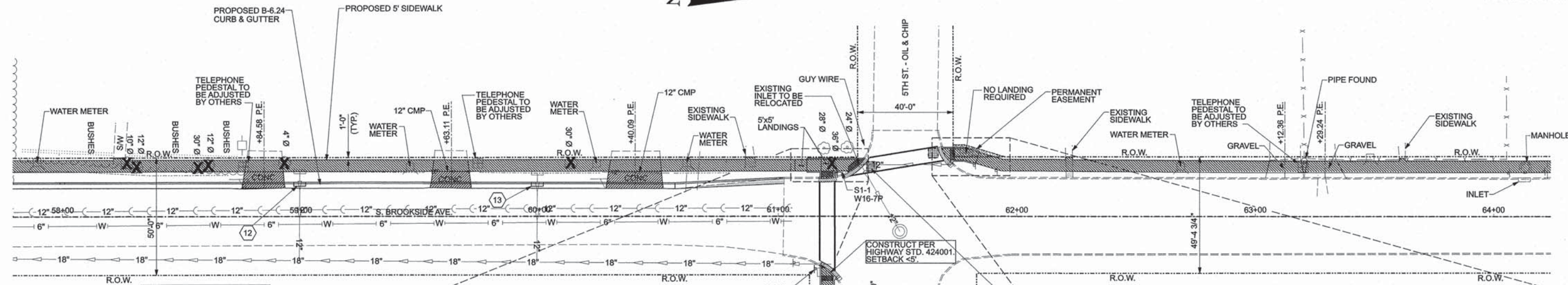

DOMESTIC WATER SERVICE BOXES TO BE ADJUSTED

STA.	EACH
LT. 59+46	1
LT. 60+24	1
LT. 60+62	1
LT. 62+69	1
TOTAL =	4

PAINT PAVEMENT MARKING - LINE 4"

STA.	TO STA.	FOOT
LT. 61+17	TO RT. 61+24 (2 LINES)	71.2
LT. 61+30	TO LT. 61+70 (2 LINES)	68.6
TOTAL =		139.8

REMOVING INLETS

STA.	EACH
LT. 58+99	1
LT. 59+99	1
TOTAL =	2

SIGN PANEL - TYPE 1 (SPECIAL)

STA.	SQ. FT.
RT. 61+15.53	11.0
LT. 61+24.35	11.0
TOTAL =	22.0

METAL POST - TYPE B (TWO POSTS/SIGN)

STA.	FOOT
RT. 61+15.53	31.0
LT. 61+24.35	31.0
TOTAL =	62.0

COMBINATION CURB AND GUTTER REMOVAL

STA.	FOOT
RT. 61+21	9.5
LT. 61+20.7	7.2
RT. 61+31.4	12.5
LT. 61+70.6	8.9
TOTAL =	38.1

DETECTABLE WARNINGS

STA.	SQ. FT.
LT. 61+20.7	10.0
RT. 61+21	10.0
LT. 61+31.4	12.8
LT. 61+73	10.0
TOTAL =	42.8

PIPE CULVERT REMOVAL

STA.	FOOT
LT. 59+63	20.0
LT. 60+40	28.0
TOTAL =	48.0

PORTLAND CEMENT CONCRETE SIDEWALK 6 INCH

STA.	SQ. FT.
LT. 58+76 TO 58+93	78.0
LT. 59+55 TO 59+71	73.9
LT. 60+29 TO 60+51	107.5
LT. 63+05 TO 63+20	71.3
LT. 63+21 TO 63+37	70.9
TOTAL =	401.6

INLETS TO BE ADJUSTED WITH NEW TYPE 1 FRAME, OPEN LID

STA.	EACH
LT. 61+35	1
TOTAL =	1

PORTLAND CEMENT CONCRETE CURB & GUTTER, TYPE B-6.24

STA.	TO STA.	FOOT
LT. 58+00	TO LT. 61+02	302.6
RT. 61+21		9.5
LT. 61+20.7		7.2
LT. 61+31.4		12.2
LT. 61+70.6		8.6
TOTAL =		340.1

SCALE
HORZ. 1" = 20'
VERT. 1" = 5'

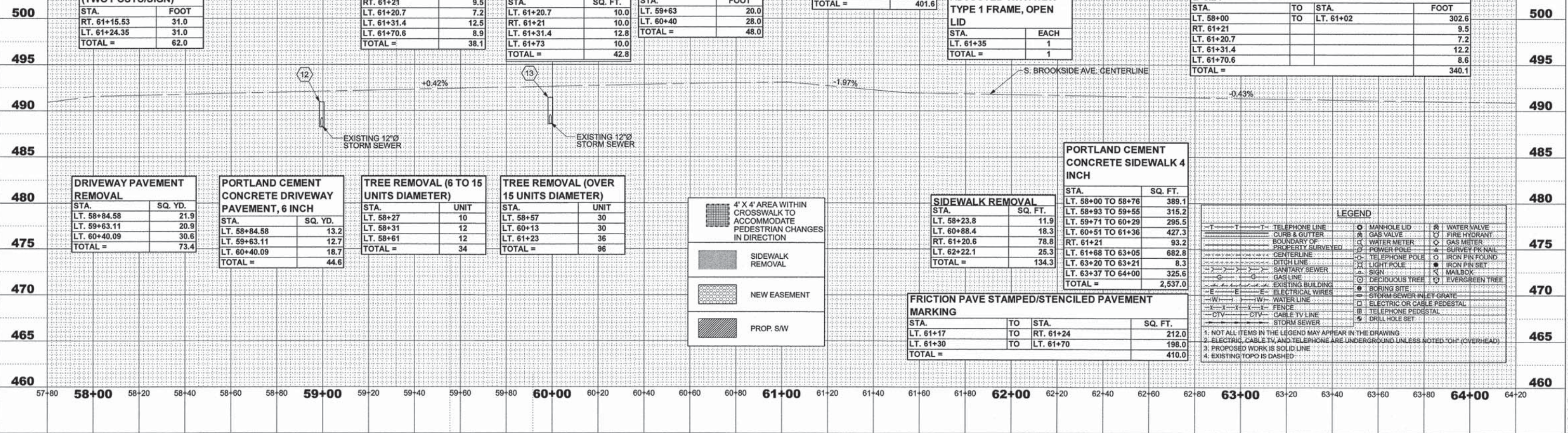

DRIVEWAY PAVEMENT REMOVAL

STA.	SQ. YD.
LT. 58+84.58	21.9
LT. 59+63.11	20.9
LT. 60+40.09	30.6
TOTAL =	73.4

PORTLAND CEMENT CONCRETE DRIVEWAY PAVEMENT, 6 INCH

STA.	SQ. YD.
LT. 58+84.58	13.2
LT. 59+63.11	12.7
LT. 60+40.09	18.7
TOTAL =	44.6

TREE REMOVAL (6 TO 15 UNITS DIAMETER)

STA.	UNIT
LT. 58+27	10
LT. 58+31	12
LT. 58+61	12
TOTAL =	34

TREE REMOVAL (OVER 15 UNITS DIAMETER)

STA.	UNIT
LT. 58+57	30
LT. 60+13	30
LT. 61+23	36
TOTAL =	96

- 4' X 4' AREA WITHIN CROSSWALK TO ACCOMMODATE PEDESTRIAN CHANGES IN DIRECTION
- SIDEWALK REMOVAL
- NEW EASEMENT
- PROP. SW

SIDEWALK REMOVAL

STA.	SQ. FT.
LT. 58+23.8	11.9
LT. 60+88.4	18.3
RT. 61+20.6	78.8
LT. 62+22.1	25.3
TOTAL =	134.3

PORTLAND CEMENT CONCRETE SIDEWALK 4 INCH

STA.	SQ. FT.
LT. 58+00 TO 58+76	389.1
LT. 58+93 TO 59+55	315.2
LT. 59+71 TO 60+29	295.5
LT. 60+51 TO 61+36	427.3
RT. 61+21	93.2
LT. 61+68 TO 63+05	682.8
LT. 63+20 TO 63+21	8.3
LT. 63+37 TO 64+00	325.6
TOTAL =	2,537.0

FRICTION PAVE STAMPED/STENCILED PAVEMENT MARKING

STA.	TO STA.	SQ. FT.
LT. 61+17	TO RT. 61+24	212.0
LT. 61+30	TO LT. 61+70	198.0
TOTAL =		410.0

LEGEND

—T—T—	TELEPHONE LINE	○	MANHOLE LID	⊗	WATER VALVE
—C—C—	CURB & GUTTER	⊗	GAS VALVE	⊗	FIRE HYDRANT
—B—B—	BOUNDARY OF PROPERTY SURVEYED	⊗	WATER METER	⊗	GAS METER
—C—C—	CENTERLINE	⊗	POWER POLE	⊗	SURVEY PIN NAIL
—D—D—	DITCH LINE	⊗	TELEPHONE POLE	⊗	IRON PIN FOUND
—S—S—	SANITARY SEWER	⊗	LIGHT POLE	⊗	IRON PIN SET
—G—G—	GAS LINE	⊗	SIGN	⊗	MAIL BOX
—E—E—	EXISTING BUILDING	⊗	DECIDUOUS TREE	⊗	EVERGREEN TREE
—E—E—	ELECTRICAL WIRES	⊗	BORING SITE	⊗	STORM SEWER INLET GRATE
—W—W—	WATER LINE	⊗	ELECTRIC OR CABLE PEDESTAL	⊗	TELEPHONE PEDESTAL
—C—C—	CABLE TV LINE	⊗	DRILL HOLE SET		
—S—S—	STORM SEWER				

1. NOT ALL ITEMS IN THE LEGEND MAY APPEAR IN THE DRAWING
2. ELECTRIC, CABLE TV, AND TELEPHONE ARE UNDERGROUND UNLESS NOTED "OH" (OVERHEAD)
3. PROPOSED WORK IS SOLID LINE
4. EXISTING TOPO IS DASHED

ILLINOIS SAFE ROUTES TO SCHOOL - PLAN & PROFILE - STA. 58+00 TO 64+00

J/C/C/J/10/1026 IL Safe Routes/1026.1b/WORKING/

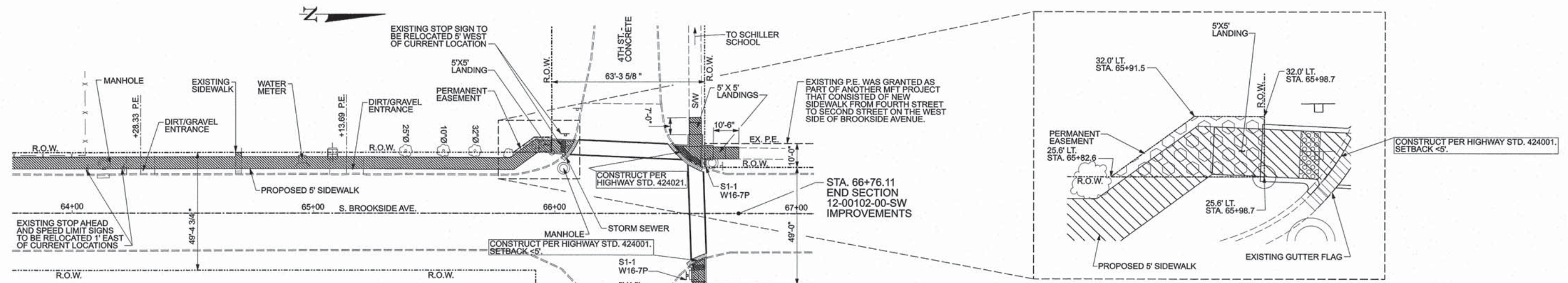

DOMESTIC WATER SERVICE BOXES TO BE ADJUSTED	
STA.	EACH
LT. 64+95	1
TOTAL =	1

MANHOLE TO BE ADJUSTED	
STA.	EACH
LT. 64+13	1
TOTAL =	1

PORTLAND CEMENT CONCRETE SIDEWALK 4 INCH	
STA.	SQ. FT.
LT. 64+00 TO 64+22	112.5
LT. 64+34 TO 65+07	367.5
LT. 65+21 TO 66+08	437.5
LT. 66+50 TO 66+76	189.0
RT. 66+58	86.1
TOTAL =	1,192.6

SIDEWALK REMOVAL	
STA.	SQ. FT.
LT. 64+68.9	21.6
LT. 66+58.4	176.8
RT. 66+59.5	73.7
TOTAL =	272.1

DETECTABLE WARNINGS	
STA.	SQ. FT.
LT. 66+05	10.0
LT. 66+55.6	23.6
RT. 66+60	10.0
TOTAL =	43.6

COMBINATION CURB AND GUTTER REMOVAL	
STA.	FOOT
LT. 66+06	8.6
LT. 66+55.1	16.6
RT. 66+59.5	8.5
TOTAL =	33.7

PAINT PAVEMENT MARKING - LINE 4"			
STA.	TO STA.	FOOT	
LT. 66+06	TO LT. 66+52.6 (2 LINES)	83.4	
LT. 66+55	TO RT. 66+63 (2 LINES)	74.1	
TOTAL =		157.5	

FRICTION PAVE STAMPED/STENCILED PAVEMENT MARKING			
STA.	TO STA.	SQ. FT.	
LT. 66+06	TO LT. 66+52.6 (2 LINES)	247.6	
LT. 66+55	TO RT. 66+63 (2 LINES)	220.4	
TOTAL =		468.0	

PORTLAND CEMENT CONCRETE CURB & GUTTER, TYPE B-6.24	
STA.	FOOT
LT. 66+06	8.6
LT. 66+55.1	16.6
RT. 66+59.5	8.5
TOTAL =	33.7

LEGEND			
-T-T-T-	TELEPHONE LINE	○	MANHOLE LID
-C-C-C-	CURB & GUTTER	○	GAS VALVE
---	BOUNDARY OF PROPERTY SURVEYED	○	FIRE HYDRANT
---	CENTERLINE	○	WATER METER
---	DITCH LINE	○	GAS METER
---	SANITARY SEWER	○	POWER POLE
---	GAS LINE	○	TELEPHONE POLE
---	EXISTING BUILDING	○	LIGHT POLE
---	ELECTRICAL WIRES	○	EXISTING SIGN
---	WATER LINE	○	MAILBOX
---	FENCE	○	DECIDUOUS TREE
---	CABLE TV LINE	○	EVERGREEN TREE
---	STORM SEWER	○	BORING SITE
		○	STORM SEWER INLET GRATE
		○	ELECTRIC OR CABLE PEDESTAL
		○	TELEPHONE PEDESTAL
		○	DRILL HOLE SET

- NOT ALL ITEMS IN THE LEGEND MAY APPEAR IN THE DRAWING
- ELECTRIC, CABLE TV, AND TELEPHONE ARE UNDERGROUND UNLESS NOTED "OH" (OVERHEAD)
- PROPOSED WORK IS SOLID LINE
- EXISTING TOPO IS DASHED

HORZ. 1" = 20'
VERT. 1" = 5'

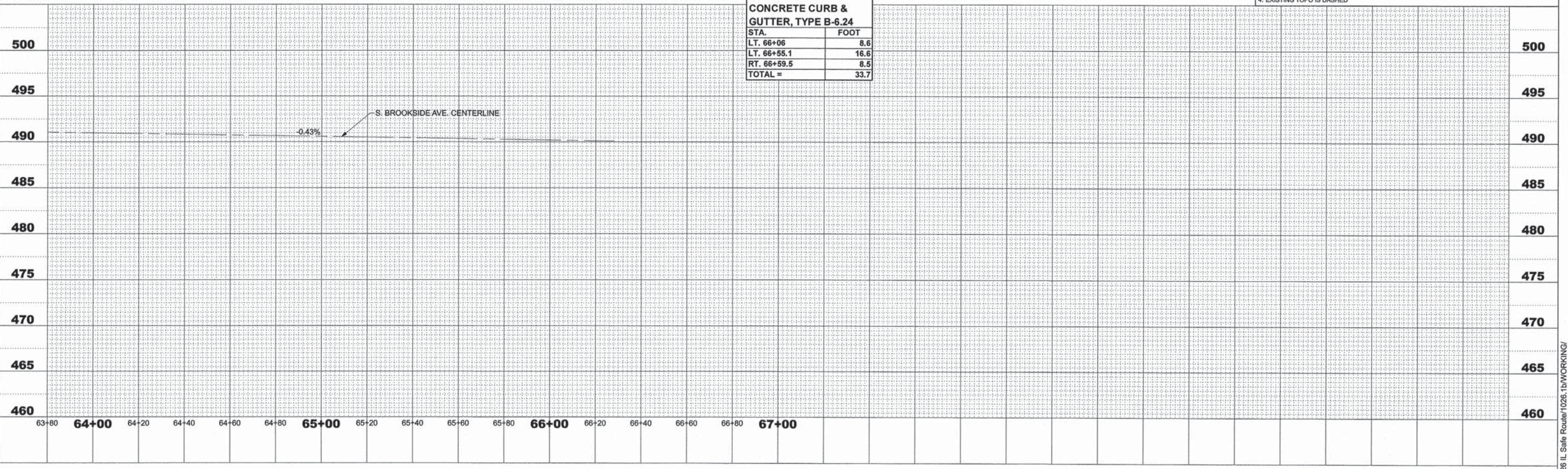

ILLINOIS SAFE ROUTES TO SCHOOL - PLAN & PROFILE - STA. 64+00 TO 67+00

J:\C\C\101026 IL Safe Routes\1026.1b\WORKING\