

**Designer NOTES:**

1. Designer to modify this Special Detail sheet, as needed, for inclusion in plans.
2. This treatment is recommended for large waterways;  $\geq 30'$  (9.0 m) in width.
3. Include District CADD Detail for RIPRAP Ditch for Erosion Protection.
4. Designer to add Drainage Structure Details as needed. The CULVERT flowline should be located such that CULVERT siltation is minimized.

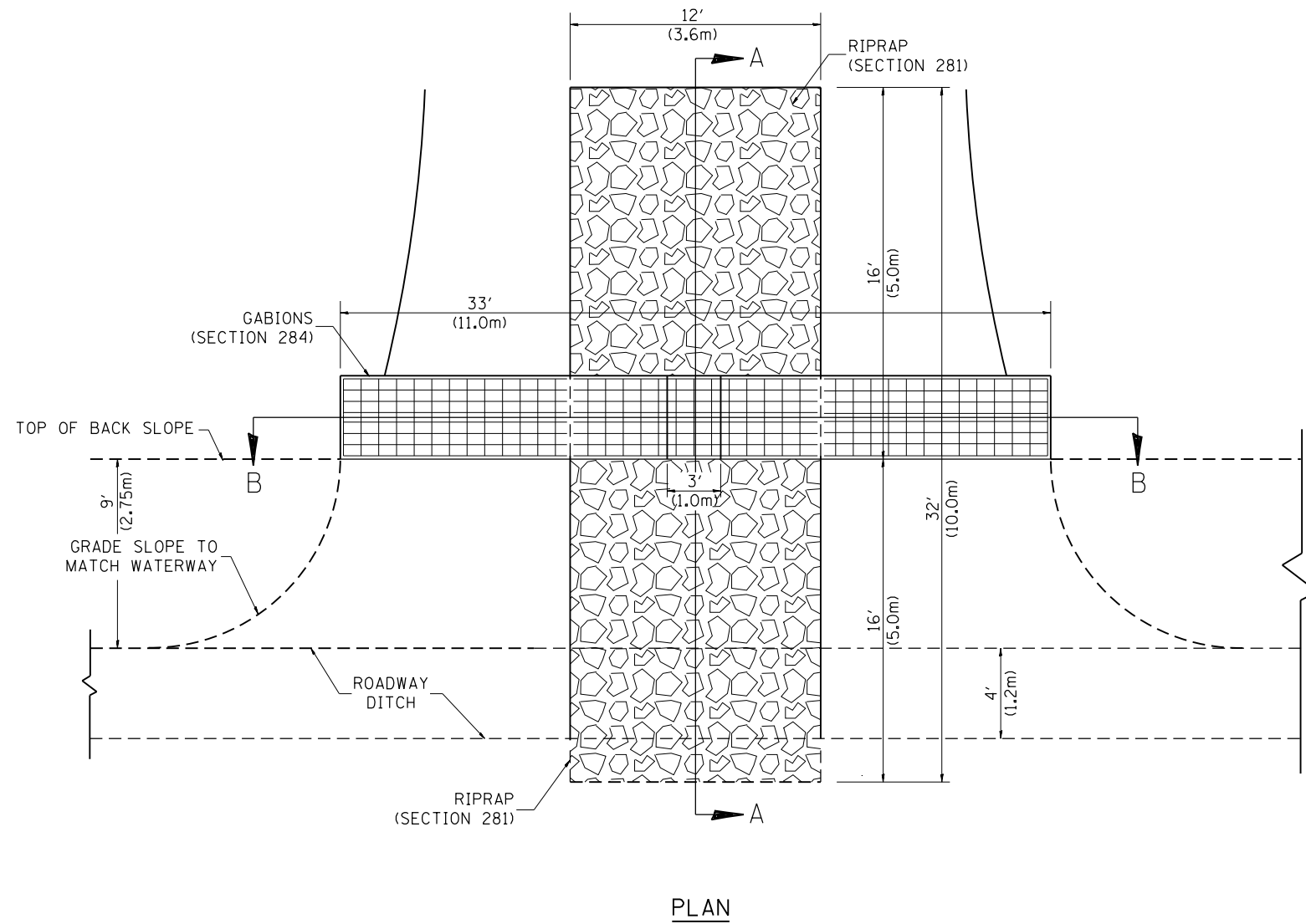

**PLAN**

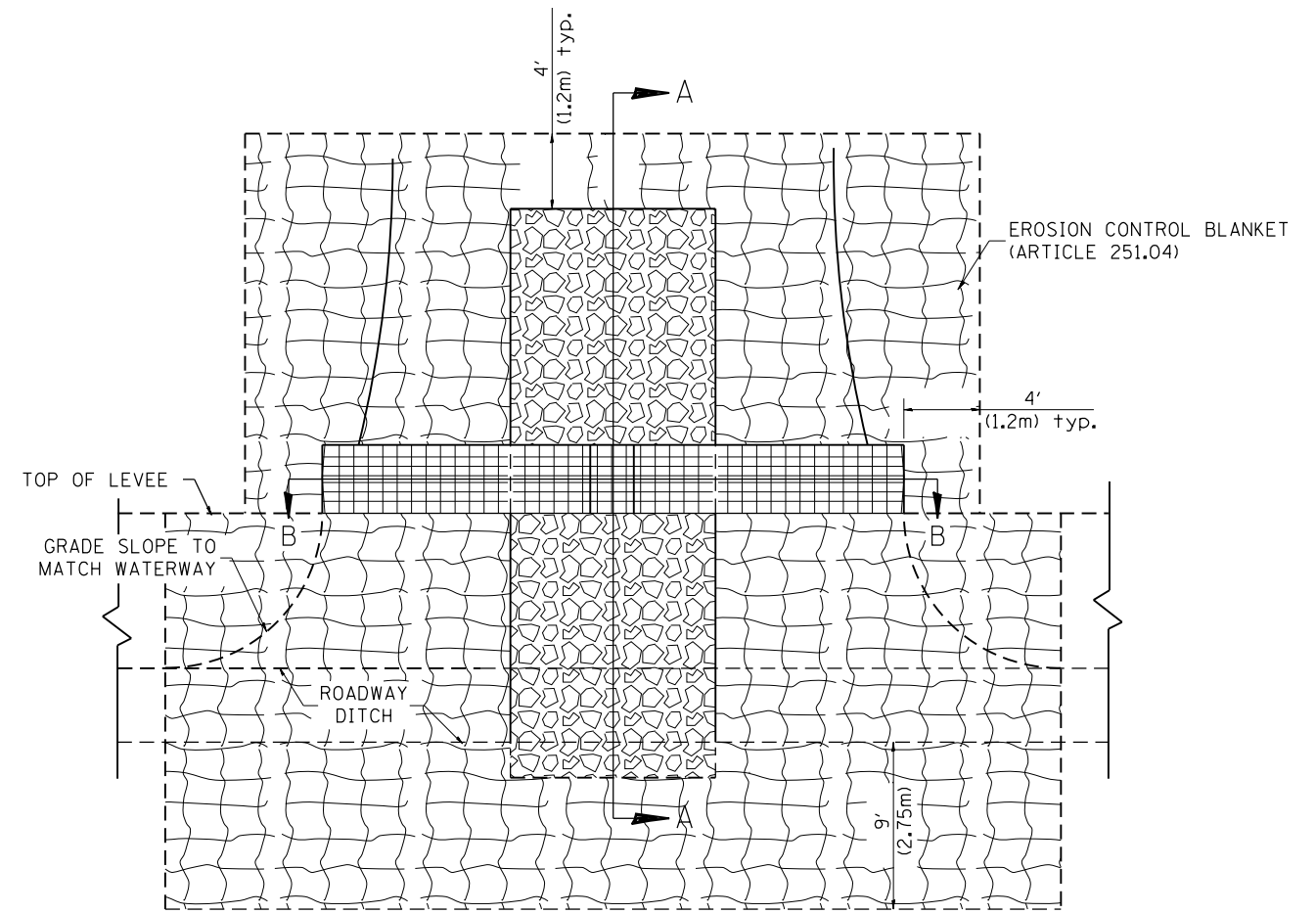

**EROSION CONTROL BLANKET DETAILS**

**GENERAL NOTES**

1. GABIONS SHALL CONFORM TO SECTION 284. MANUFACTURERS NOMINAL SIZES SHALL BE USED.
2. RIPRAP SHALL CONFORM TO SECTION 281.
3. EROSION CONTROL BLANKET SHALL CONFORM TO SECTION 281.
4. FILTER FABRIC USED WITH RIPRAP SHALL CONFORM TO SECTION 282 AND ARTICLE 1080.03.

All dimensions are in inches (millimeters) unless otherwise noted.

1-1-97	RENUM. A-12.09, NEW REVISION BOX	T.P.
10-16-06	REVISED TO 2007 SPEC.	M.A.

**STATE OF ILLINOIS  
DEPARTMENT OF TRANSPORTATION**

NOT TO SCALE

**WATERWAY EROSION CONTROL,  
DOWNSTREAM TREATMENT, GABION WEIR**

SHT. 1 OF 2  
CADD STD. 284001-D4

F.A. RTE.	SECTION	COUNTY	TOTAL SHEETS	SHEET NO.
CONTRACT NO.				
FED. ROAD DIST. NO. ILLINOIS FED. AID PROJECT				

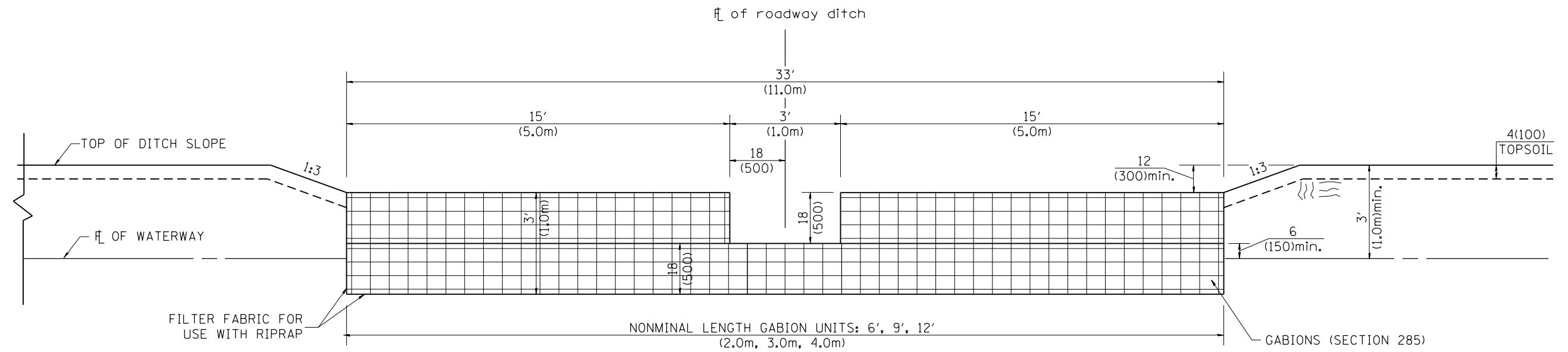
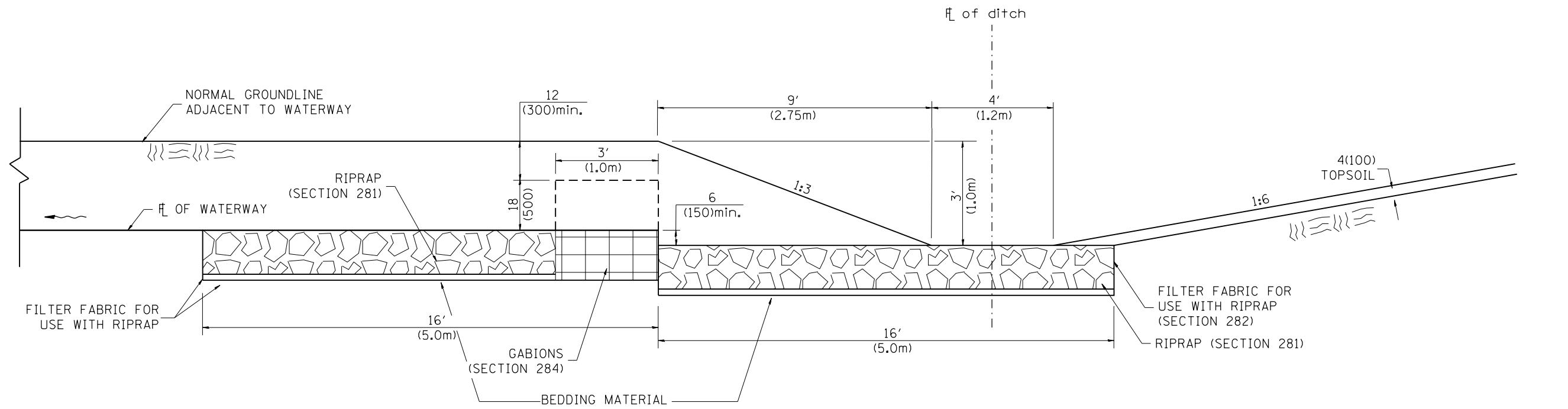

All slope ratios are expressed as units of vertical displacement to units of horizontal displacement (V:H).

All dimensions are in inches (millimeters) unless otherwise noted.