

STATE OF ILLINOIS
DEPARTMENT OF TRANSPORTATION

**PROPOSED
HIGHWAY PLANS**

FAP ROUTE 412 (ALPINE RD)
SECTION 148TS
PROJECT STP-1J87(513)
TYPE of IMPROVEMENT
WINNEBAGO COUNTY
C-92-059-17

F A I R T E	SECTION	COUNTY	TOTAL SHEETS	SHEET NO
89	137-21M-1	HENRY	15	1
		ILLINOIS	CONTRACT NO. 64M32	

- INDEX OF SHEETS**
- 1 COVER SHEET
 - 2-3 SUMMARY OF QUANTITIES
 - 4 UTILITIES
 - 5 LOUISIANA REMOVAL
 - 6 FLORIDA/CLEVELAND REMOVAL
 - 7 SIGNAL PLANS
 - 8 CABLE PLANS
 - 9 LIGHTING PLANS
 - 10-11 SIDEWALK ADA RAMP DETAILS
 - 12 SIGN DETAILS
 - 13-14 TYPICAL PAVEMENT MARKING 41.1
 - 15 BORING LOGS

HIGHWAY STANDARDS

- 424001-11 701006-05
- 701101-05 701201-05
- 701601-09 701701-10
- 701801-06 701901-08
- 720016-04 805001-01
- 814001-03 814006-02
- 857001-01 873001-02
- 876001-04 877001-07
- 877011-10 878001-10
- 880006-01

ALPINE AT
LOUISIANA
ALPINE AT
FLORIDA/CLEVELAND

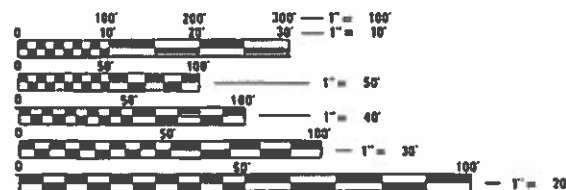
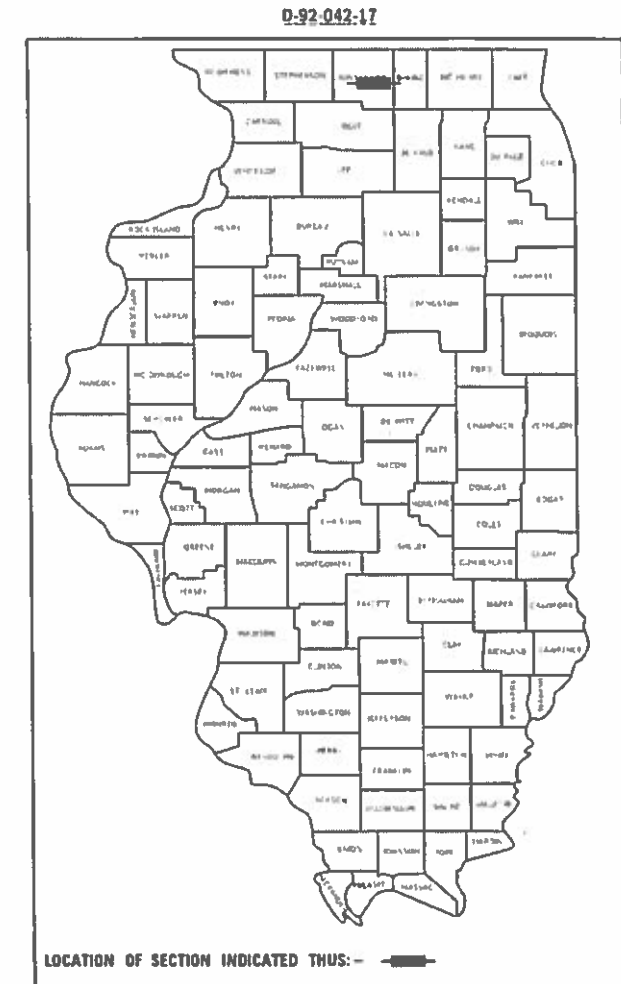

FULL SIZE PLANS HAVE BEEN PREPARED USING STANDARD ENGINEERING SCALES. REDUCED SIZED PLANS WILL NOT CONFORM TO STANDARD SCALES. IN MAKING MEASUREMENTS ON REDUCED PLANS, THE ABOVE SCALES MAY BE USED.

J.U.L.I.E.
JOINT UTILITY LOCATION INFORMATION FOR EXCAVATION
1-800-892-0123
OR 811

PROJECT ENGINEER SCOTT KULLERSTRAND 815-284-5476
PROJECT MANAGER KRISTINE HILL 815-284-5476

CONTRACT NO. 64M32

R 2 E
T 43 N

STATE OF ILLINOIS
DEPARTMENT OF TRANSPORTATION

SUBMITTED Aug 07, 20 19

[Signature]
REGIONAL ENGINEER

Oct 4 20 19

[Signature]
ENGINEER OF DESIGN AND ENVIRONMENT

Oct 4 20 19

[Signature]
DIRECTOR OF HIGHWAYS PROJECT IMPLEMENTATION

PRINTED BY THE AUTHORITY
OF THE STATE OF ILLINOIS

TRAFFIC SIGNAL TABULATION OF QUANTITIES ON ALPINE AT FLORIDA/CLEVELAND

TRAFFIC SIGNALS
80% FED
20% STATE
STATE
0021
URBAN

PAY CODE	ITEM	UNIT	Florida	Louisiana	TOTAL
42400200	PORTLAND CEMENT CONCRETE SIDEWALK 5 INCH	SQ FT	1065	0	1065
* 42400800	DETECTABLE WARNINGS	SQ FT	62	0	62
44000500	COMBINATION CURB AND GUTTER REMOVAL	FOOT	109	0	109
44000600	SIDEWALK REMOVAL	SQ FT	555	0	555
60605000	COMBINATION COCRETE CURB AND GUTTER, TYPE B-6.24	FOOT	118	0	118
67100100	MOBILIZATION	EACH	0.8	0.2	1
70100450	TRAFFIC CONTROL AND PROTECTION, STANDARD 701201	L SUM	0.8	0.2	1
70102630	TRAFFIC CONTROL AND PROTECTION, STANDARD 701601	L SUM	0.8	0.2	1
70102635	TRAFFIC CONTROL AND PROTECTION, STANDARD 701701	L SUM	0.8	0.2	1
* 72000100	SIGN PANEL - TYPE 1	SQ FT	28	0	27.5
* 72000200	SIGN PANEL - TYPE 2	SQ FT	30	0	30
* 72400310	REMOVE SIGN PANEL - TYPE 1	SQ FT	15	15	30.25
* 72400320	REMOVE SIGN PANEL - TYPE 2	SQ FT	30	0	30
* 78000400	THERMOPLASTIC PAVEMNET MARKING LINE 6"	FOOT	272	0	272
* 78000650	THERMOPLASTIC PAVEMENT MARKING LINE 24"	FOOT	126	0	126
* 80500100	SERVICE INSTALLATION, TYPE A	EACH	1	0	1
* 81028740	UNDERGROUND CONDUIT, COILABLE NONMETALLIC CONDUIT 1 1/2" DIA.	FOOT	14	0	14
* 81028760	UNDERGROUND CONDUIT, COILABLE NONMETALLIC CONDUIT 2 1/2" DIA.	FOOT	54	0	54

*= SPECIALTY ITEM

PAY CODE	ITEM	UNIT	Florida	Louisiana	TOTAL
81028790	UNDERGROUND COUNDUIT, COILABLE NONMETALLIC CONDUIT 4" DIA.	FOOT	249	0	249
* 81400700	HANDHOLE, PORTLAND CEMENT CONCRETE	EACH	3	0	3
* 81400720	DOUBLE HANDHOLE, PORTLAND CEMENT CONCRETE	EACH	1	0	1
* 81702110	ELECTRIC CABLE IN CONDUIT, 600V (XLP TYPE USE) 1/C NO. 10	FOOT	600	0	600
* 82110007	LUMNAIRE, LED ROADWAY, OUTPUT DESIGNATION G	EACH	3	0	3
* 84500120	REMOVAL OF ELECTRIC SERVICE INSTALLATION	EACH	1	1	2
* 85700200	FULL ACUATED CONTROLLER AND TYPE IV CABINET	EACH	1	0	1
* 87301215	ELECTRIC CABLE IN CONDUIT, SIGNAL, NO. 14 2C	FOOT	165	0	165
* 87301225	ELECTRIC CABLE IN CONDUIT, SIGNAL, NO. 14 3C	FOOT	177	0	177
* 87301245	ELECTRIC CABLE IN CONDUIT, SIGNAL, NO. 14 5C	FOOT	1170	0	1170
* 87301255	ELECTRIC CABLE IN CONDUIT, SIGNAL, NO. 14 7C	FOOT	594	0	594
* 87301815	ELECTRIC CABLE IN CONDUIT, SERVICE, NO 6 3C	FOOT	30	0	30
87502430	TRAFFIC SIGNAL POST, GALVANIZED STEEL 9 FT.	EACH	1	0	1
87700160	STEEL MAST ARM ASSEMBLY AND POLE 24 FT	EACH	2	0	2
87702910	STEEL COMBINATION MAST ARM ASSEMBLY AND POLE 36 FT	EACH	1	0	1
87702930	STEEL COMBINATION MAST ARM ASSEMBLY AND POLE 40 FT	EACH	1	0	1
87800100	CONCRETE FOUNDATION, TYPE A	FOOT	3	0	3
87800200	CONCRETE FOUNDATION, TYPE D	FOOT	3	0	3
87800400	CONCRETE FOUNDATION, TYPE E, 30-INCH DIAMETER	FOOT	20	0	20

MODEL: Default
FILE NAME: C:\Users\jguy\OneDrive\Documents\TrafficSignal_Sheets\012_64432-ah-15.dgn
PLOT DATE: 11/19/2019 09:44:56 AM

USER NAME = jguy	DESIGNED	REVISED
	DRAWN	REVISED
PLOT SCALE = 1:1.6710	CHECKED	REVISED
PLOT DATE = 11/19/2019 09:44:56 AM	DATE	REVISED

STATE OF ILLINOIS
DEPARTMENT OF TRANSPORTATION

ALPINE AT FLORIDA/CLEVELAND & AT LOUISIANA
SUMMARY OF QUANTITIES

F.A.P. RTE	SECTION	COUNTY	TOTAL SHEETS	SHEET NO
412	148TS	WINNEBAGO	15	2
CONTRACT NO. 64M32				
ILLINOIS FED. AID PROJECT				

PAY CODE	ITEM	UNIT	TRAFFIC SIGNALS		TOTAL
			Florida	Louisiana	
87800415	CONCRETE FOUNDATION, TYPE E, 36-INCH DIAMETER	FOOT	24	0	24
* 88040090	SIGNAL HEAD, POLYCARBONATE, LED, 1-FACE, 3-SECTION, MASTARM MOUNTED	EACH	8	0	8
* 88040110	SIGNAL HEAD, POLYCARBONATE, LED, 1-FACE, 4-SECTION, BRACKET MOUNTED	EACH	2	0	2
* 88040120	SIGNAL HEAD, POLYCARBONATE, LED, 1-FACE, 4-SECTION, MAST ARM MOUNTED	EACH	2	0	2
* 88102825	PEDESTRIAN SIGNAL HEAD, LED, 1-FACE BRACKET MOUNTED WITH COUNT DOWN TIMER	EACH	2	0	2
* 88200100	TRAFFIC SIGNAL BACKPLATE	EACH	10	0	10
* 87301900	ELECTRIC CABLE IN CONDUIT, EQUIPMENT GROUNDING CONDUCTOR, NO. 6 1C	FOOT	358	0	358
* 89501420	RELOCATE EXISTING EMERGENCY VEHICLE PRIORITY SYSTEM, COMPLETE	EACH	1	0	1
89502375	REMOVE EXISTING TRAFFIC SIGNAL EQUIPMENT	EACH	1	1	2
89502380	REMOVE EXISTING HANDHOLE	EACH	6	3	9
89502385	REMOVE EXISTING CONCRETE FOUNDATION	EACH	7	5	12
* X0327425	RELOCATE WIRELESS INTERCONNECT COMPLETE	L SUM	1	0	1
X0327979	PAVEMENT MARKING REMOVAL - GRINDING	SQ FT	376	0	376
X4402810	ISLAND SUR FACE REMOVAL AND REPLACEMENT	SQ FT	304	0	304
* X8950105	REMOVE EXISTING TRAFFIC CONTROLLER AND CABINET	EACH	1	1	2
* Z0033072	VIDEO VEHICLE DETECTOR SYSTEM	EACH	1	0	1

*= SPECIALTY ITEM

MODEL: Default
 FILE NAME: p:\16161616\16161616\DOT - Office\District - 2\Projects\64M32\Operations\Traffic\Signal\Sheets\02_64M32_01_15.dgn

USER NAME = hiki	DESIGNED =	REVISED =
DRAWN =	REVISIONS =	
PLOT SCALE = 41 6710 1/2 in	CHECKED =	REVISED =
PLOT DATE = Mar 19 2019 09:15:06 AM	DATE =	REVISED =

**STATE OF ILLINOIS
DEPARTMENT OF TRANSPORTATION**

**ALPINE AT FLORIDA/CLEVELAND & AT LOUISIANA
SUMMARY OF QUANTITIES**

F.A.P. RTE. = 412	SECTION = 148TS	COUNTY = WINNEBAGO	TOTAL SHEETS = 15	SHEET NO. = 3
SCALE: _____ SHEET _____ OF _____ SHEETS STA. _____ TO STA. _____			CONTRACT NO. 64M32	
ILLINOIS FED AID PROJECT				

UTILITIES			
NAME AND ADDRESS	TYPE	TELEPHONE	
MR BRUCE KOPPANG NICOR GAS CO. 1844 FERRY ROAD NAPERVILLE, IL 60563-9600	GAS	630-388-3046	JULIE MEMBER? YES CALL 800-892-0123
MS JAMIE ROTT ROCKFORD WATER DEPARTMENT 425 E STATE STREET ROCKFORD, IL 61104	WATER	815-967-7060	JULIE MEMBER? NO CALL 815-218-2954 CELL
MR DANA CARROLL ROCK RIVER WATER RECLAMATION DISTRICT 3501 KISHWAUKEE STREET ROCKFORD, IL 61126-7480	SEWER	815-387-7400	JULIE MEMBER? YES CALL 800-892-0123
MR KEITH KOSHINSKI COMCAST CABLE 4450 KISHWAUKEE STREET ROCKFORD, IL 61109	CATV	224-229-5432	JULIE MEMBER? YES CALL 800-892-0123
MR LANCE SANDY IFIBER 3100 SYCAMORE ROAD DEKALB, IL 60115	COMMUNICATIONS	815-753-6075	JULIE MEMBER? CALL
MR HECTOR GARCIA ATT&T 100 COMMERCE DRIVE OAK BROOK, IL 60523	TELEPHONE	630-573-5465	JULIE MEMBER? YES CALL 800-892-0123
MR ADAM SADKOWSKI COMMONWEALTH EDISON COMPANY 123 ENERGY AVENUE ROCKFORD, IL 61109	ELECTRIC	630-985-4043	JULIE MEMBER? YES CALL 800-892-0123

MODEL: D:\proj\...
 FILE NAME: ...
 PLOT DATE: ...

USER NAME = hiki	DESIGNED -	REVISED -
	DRAWN -	REVISED -
PLOT SCALE = 41 8630' / in	CHECKED -	REVISED -
PLOT DATE = Mar-14-2019 02:30:33 PM	DATE -	REVISED -

STATE OF ILLINOIS
DEPARTMENT OF TRANSPORTATION

ALPINE AT FLORIDA/CLEVELAND AND AT LOUISIANA
UTILITIES

SCALE: SHEET OF SHEETS STA TO STA

F.A.P. RTE.	SECTION	COUNTY	TOTAL SHEETS	SHEET NO.
412	148TS	WINNEBAGO	16	4
CONTRACT NO. 64M32			ILLINOIS FED. AID PROJECT	

LOUISIANA SIGNAL REMOVAL

- 72400310 REMOVE SIGN PANEL - TYPE 1 SQ FT 15.25
- 84500120 REMOVAL OF ELECTRIC SERVICE INSTALLATION - EACH 1
- 89502375 REMOVE EXISTING TRAFFIC SIGNAL EQUIPMENT - L SUM 1

- 2 - MAST ARM ASSEMBLIES
- 2 - SIGNAL POSTS
- 5 - 3 SECTION BRACKET MOUNTED SIGNAL HEADS
- 2 - 3 SECTION MAST ARM MOUNT SIGNAL HEADS
- 1 - 5 SECTION BRACKET MOUNTED SIGNAL HEAD
- 1 - 5 SECTION MAST ARM MOUNTED SIGNAL HEAD
- 2 - PEDESTRIAN HEADS
- 1 - EVP SYSTEM

REMOVE WIRE FROM CONDUIT, ABANDON CONDUIT

- 89502380 REMOVE EXISTING HANDHOLE - EACH 3
- 89502385 REMOVE EXISTING CONCRETE FOUNDATION - EACH 5
(2 - MAST ARM, 2 - SIGNAL POSTS, 1 - CONTROLLER)

ALL TRAFFIC SIGNAL EQUIPMENT SHALL REMAIN THE PROPERTY OF THE CITY OF ROCKFORD FOR SALVAGE. THE CONTRACTOR SHALL CONTACT CALVIN KINARD, SIGNAL AND LIGHTING SUPERVISOR WITH THE CITY OF ROCKFORD, AT 815-209-7528 TO ARRANGE FOR PICK -UP OF SALVAGEABLE EQUIPMENT.

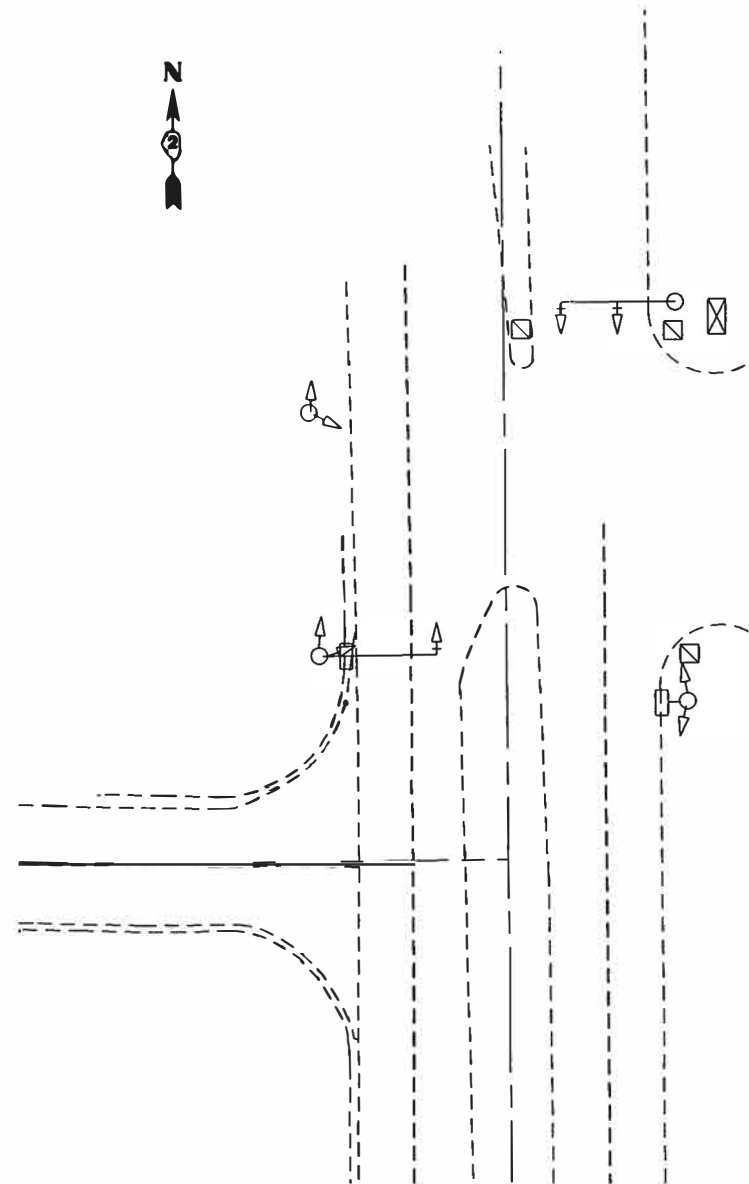

MODEL: D:\work\...
 FILE NAME: ...

USER NAME = niki	DESIGNED -	REVISED -	STATE OF ILLINOIS DEPARTMENT OF TRANSPORTATION	ALPINE AT LOUISIANA REMOVAL PLANS		F.A.P. RTE. = 412	SECTION = 1481S	COUNTY = WINNEBAGO	TOTAL SHEETS = 15	SHEET NO = 5	
PLOT SCALE = 41.5096' / in	DRAWN -	REVISED -		SCALE =	SHEET OF SHEETS	STA. TO STA.	ILLINOIS FED. AID PROJECT				
PLOT DATE = Mar-19-2019 07:58:02 AM	CHECKED -	REVISED -		CONTRACT NO. 64M32							
DATE -	DATE -	REVISED -									

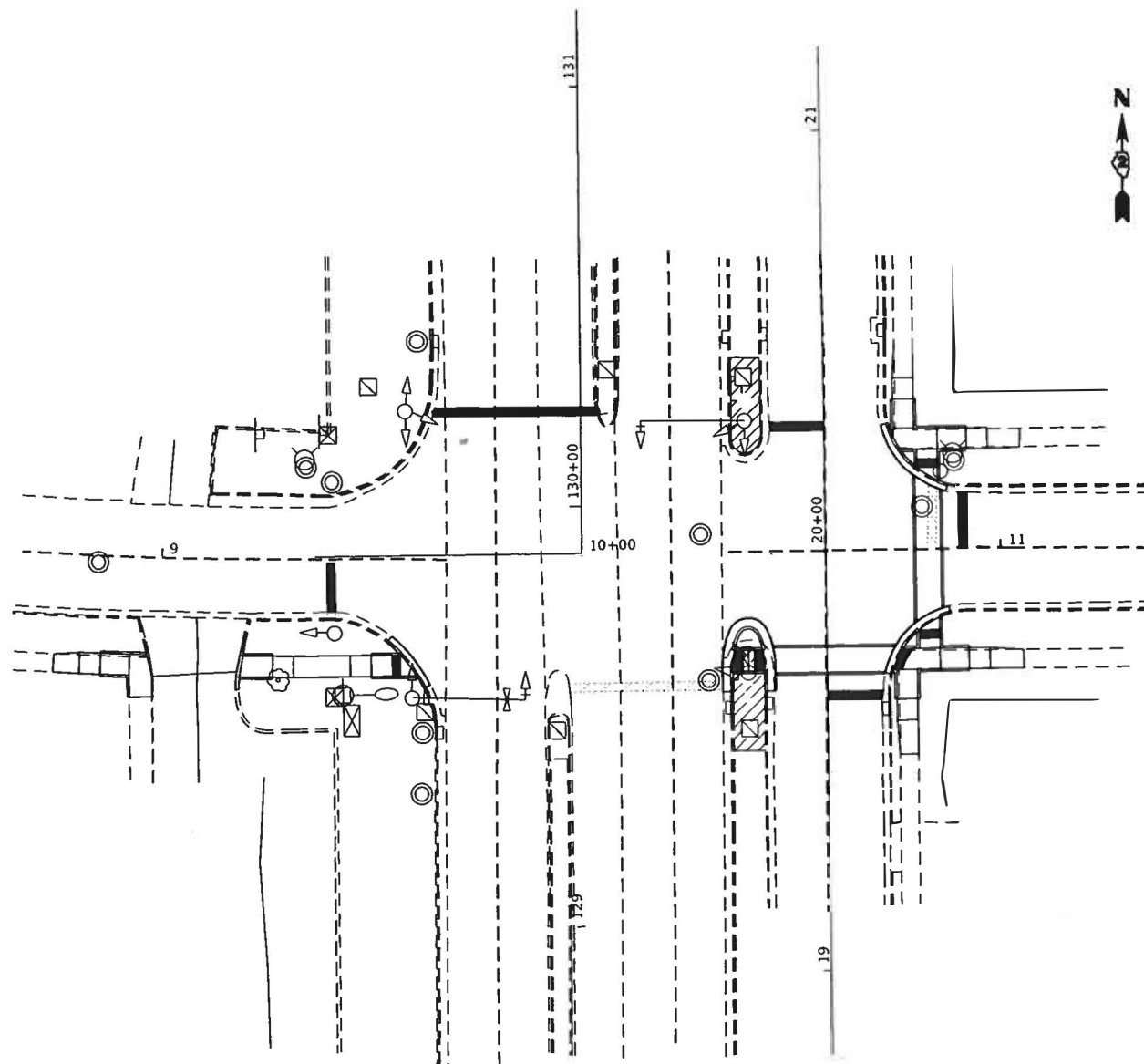

ALPINE @ FLORIDA/CLEVELAND SIGNAL REMOVAL

- 72400310 REMOVE SIGN PANEL - TYPE 1 SQ FT 15
- 72400320 REMOVE SIGN PANEL - TYPE 2 SQ FT 30
- 84500120 REMOVAL OF ELECTRIC SERVICE INSTALLATION - EACH 1
- 89502375 REMOVE EXISTING TRAFFIC SIGNAL EQUIPMENT - L SUM 1
 - 2 - 32' MAST ARM ASSEMBLIES (ONE IS A COMBINATION)
 - 4 - SIGNAL POSTS
 - 2 - 1 SECTION BRACKET MOUNTED SIGNAL HEAD
 - 12 - 3 SECTION BRACKET MOUNTED SIGNAL HEADS
 - 2 - 3 SECTION MAST ARM MOUNT SIGNAL HEADS
 - 2 - 5 SECTION MAST ARM MOUNTED SIGNAL HEAD
 - 2 - PEDESTRIAN HEADS
 - 1 - EVP SYSTEM
- REMOVE WIRE FROM CONDUIT, ABANDON CONDUIT
- 89502380 REMOVE EXISTING HANDHOLE - EACH 6
- 89502385 REMOVE EXISTING CONCRETE FOUNDATION - EACH 7
 - (2 - MAST ARM, 4 - SIGNAL POSTS, 1 - CONTROLLER)

ALL TRAFFIC SIGNAL EQUIPMENT SHALL REMAIN THE PROPERTY OF THE CITY OF ROCKFORD FOR SALVAGE. THE CONTRACTOR SHALL CONTACT CALVIN KINARD, SIGNAL AND LIGHTING SUPERVISOR WITH THE CITY OF ROCKFORD, AT 815-209-7528 TO ARRANGE FOR PICK-UP OF SALVAGEABLE EQUIPMENT.

MODEL: D:\pwork\14-0001\Documents\DOT_Office\Auto\Drawn - 2\Projects\14-0001\Drawings\Traffic\Signal_Sheet1502_64M32.dwg, FILE NAME:

USER NAME = nllst	DESIGNED - _____	REVISED - _____
PLOT SCALE = 11.8630' / in.	DRAWN - _____	REVISED - _____
PLOT DATE = Mar-14-2019 02:31:06 PM	CHECKED - _____	REVISED - _____
	DATE - _____	REVISED - _____

**STATE OF ILLINOIS
DEPARTMENT OF TRANSPORTATION**

ALPINE AT FLORIDA/CLEVELAND
Signal REMOVAL PLANS

SCALE: _____ SHEET _____ OF _____ SHEETS STA. _____ TO STA. _____

F.A.P. RTE.	SECTION	COUNTY	TOTAL SHEETS	SHEET NO.
412	148TS	WINNEBAGO	15	6
CONTRACT NO. 64M32				
ILLINOIS FED AID PROJECT				

LUMINAIRES SHALL BE MOUNTED AT 35'
WITH 12' ARMS.

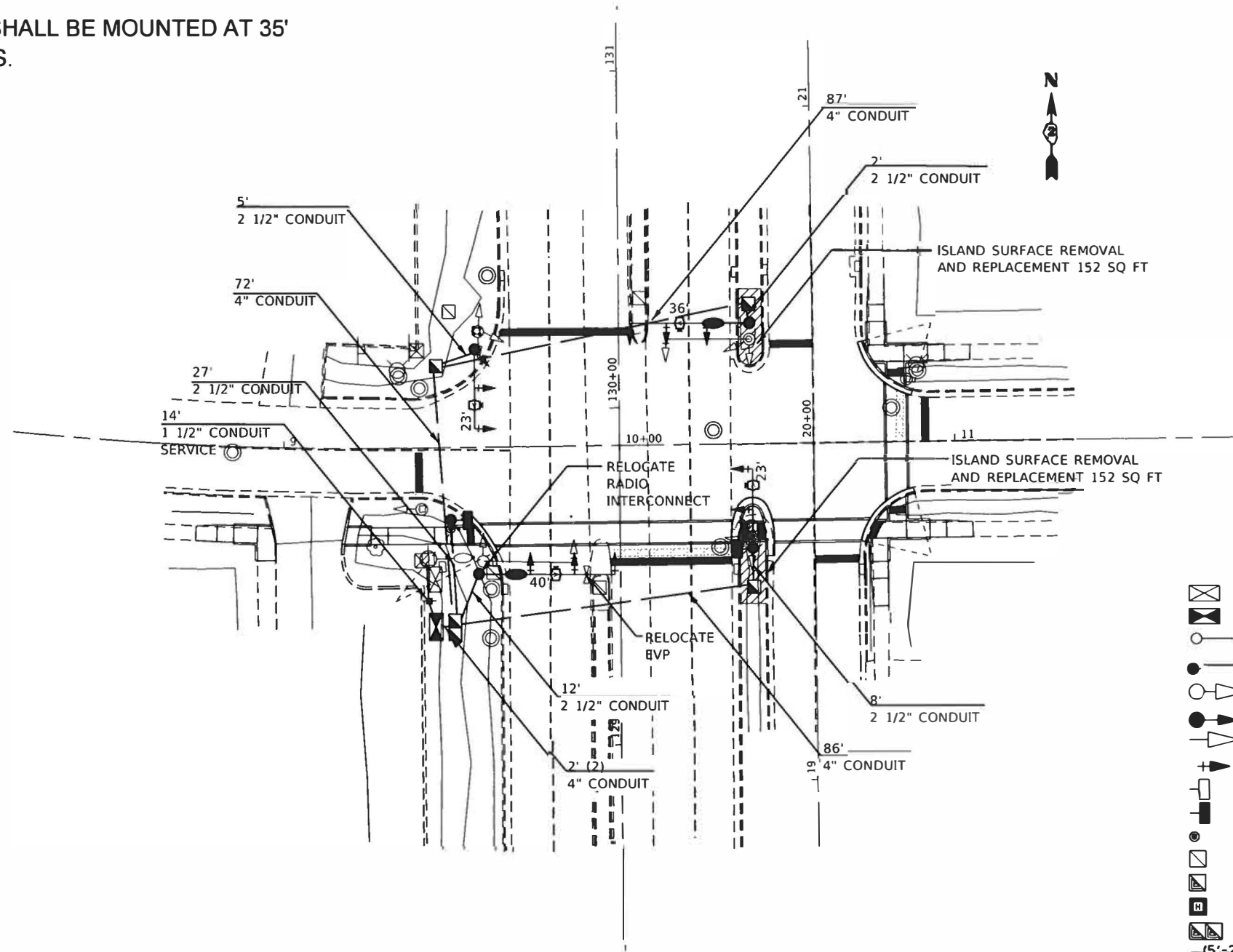

LEGEND

- EXISTING CONTROLLER
 - NEW CONTROLLER
 - EXISTING STEEL MAST ARM ASSEMBLY AND POLE
 - NEW STEEL MAST ARM ASSEMBLY AND POLE
 - EXISTING SIGNAL HEAD AND POST
 - NEW SIGNAL HEAD AND POST
 - EXISTING SIGNAL HEAD
 - NEW SIGNAL HEAD WITH BACKPLATE
 - EXISTING PEDESTRIAN HEAD
 - NEW PEDESTRIAN HEAD
 - PEDESTRIAN PUSHBUTTON
 - EXISTING HANDHOLE
 - NEW HANDHOLE
 - NEW HEAVY-DUTY HANDHOLE
 - NEW DOUBLE HANDHOLE
 - EXISTING CONDUIT (LENGTH AND SIZE)
 - NEW LUMINAIRE
 - UNDERGROUND CONDUIT, COILABLE NONMETALLIC CONDUIT
- UPPER NUMERAL INDICATES LENGTH
LOWER NUMERAL INDICATES CONDUIT SIZE

H:\WORK\2019\19-035\19-035-50\19-035-50-16.dwg
 FILE NAME: 19-035-50-16.dwg
 USER: hiki
 PLOT DATE: 3/19/2019 09:35:50 AM
 PLOT SCALE: 1/8" = 1'-0"

USER NAME = hiki	DESIGNED =	REVISED =
DRAWN =	REVISIONS =	
CHECKED =	DATE =	
PLOT DATE = Mar-19-2019 09:35:50 AM		

**STATE OF ILLINOIS
DEPARTMENT OF TRANSPORTATION**

**ALPINE AT FLORIDACLEVELAND
SIGNAL PLANS**

SCALE: _____ SHEET _____ OF _____ SHEETS STA _____ TO STA _____

F A P	SECTION	COUNTY	TOTAL SHEETS	SHEET NO
412	148TS	WINNEBAGO	7	16
CONTRACT NO. 64M32				
ILLINOIS FED. AID PROJECT				

MODEL: D:\pavt FILE NAME: \illinois\dot\illinois\dot\Operations\Traffic\Signal\Signal Sheets\U2_44432.dwg 11.dgn

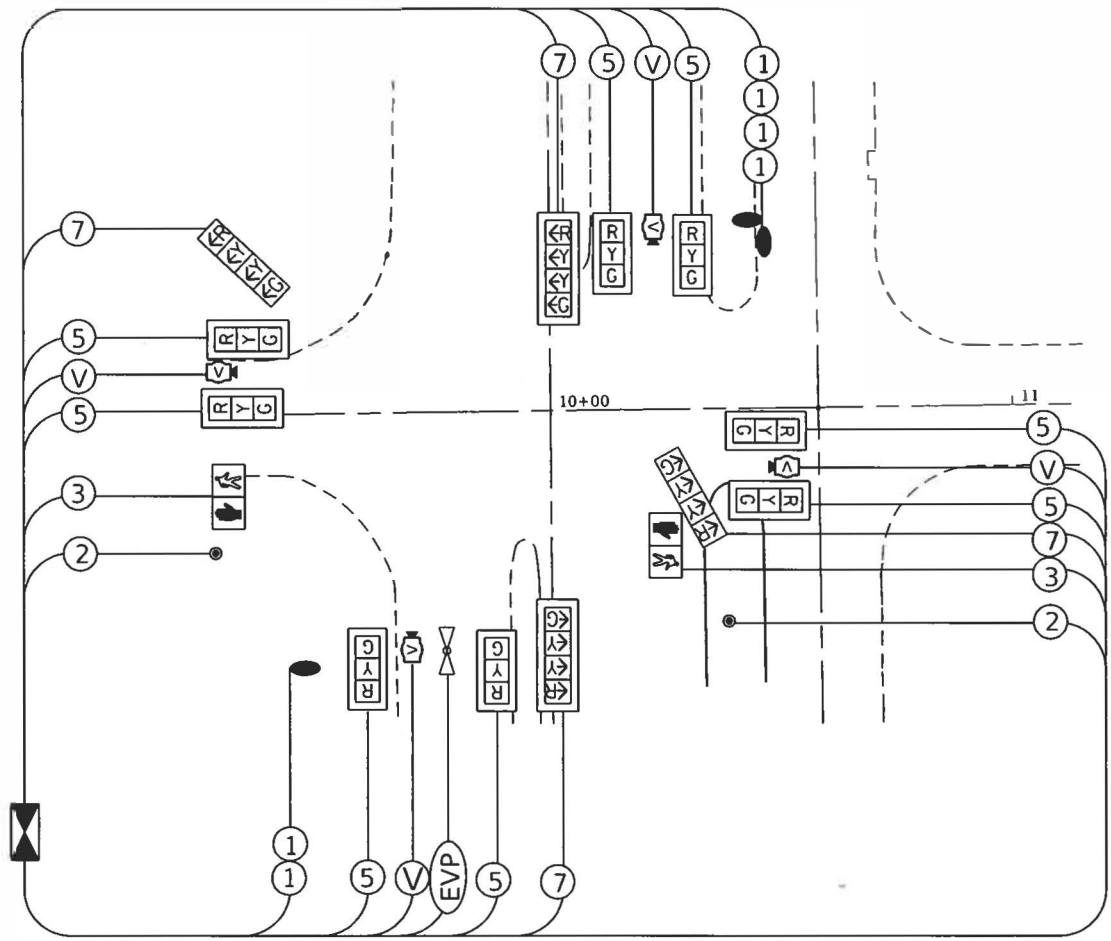

PHASE DESIGNATION DIAGRAM

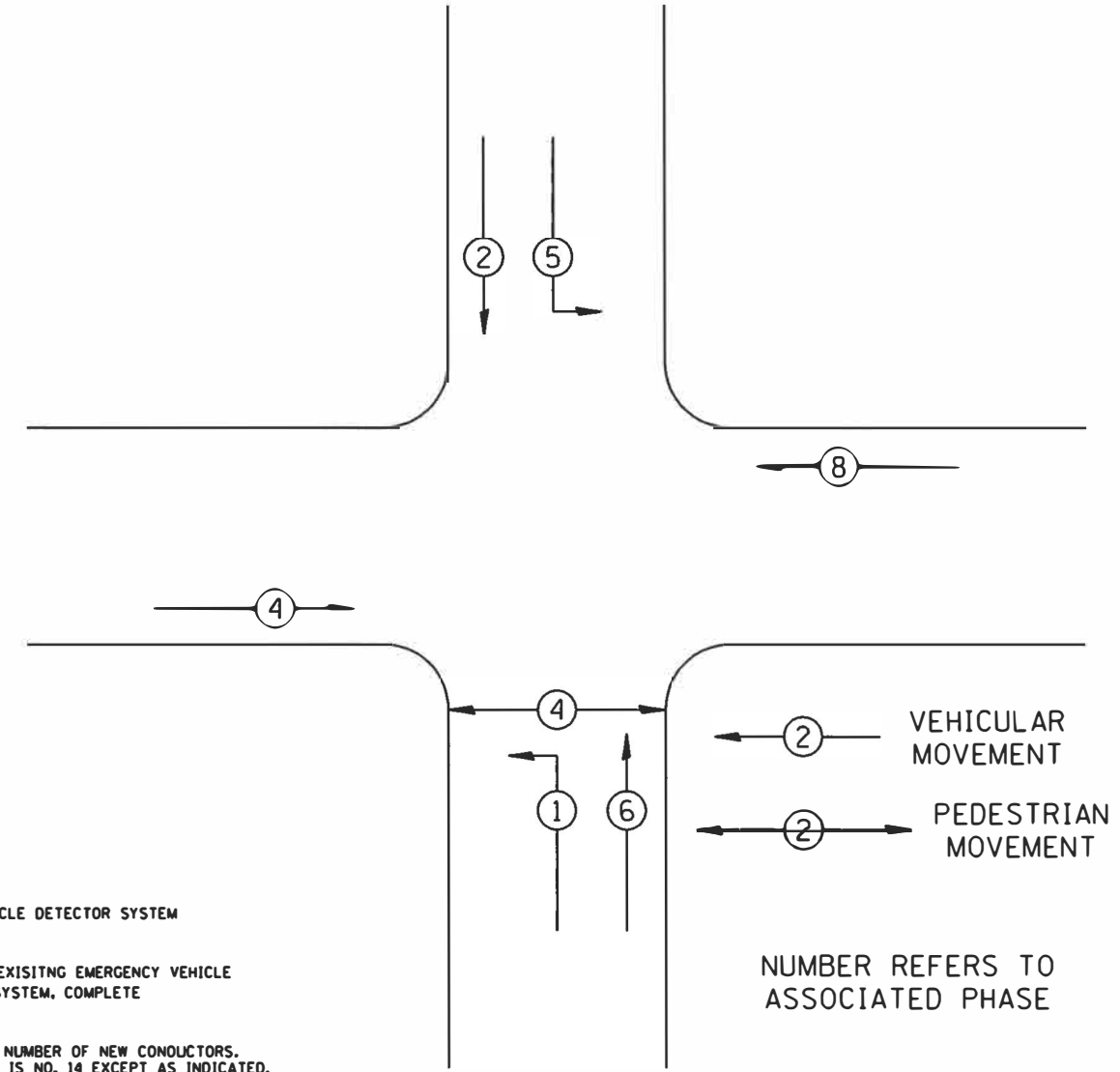

- LEGEND**
- V VIDEO VEHICLE DETECTOR SYSTEM
 - EVP RELOCATE EXISTING EMERGENCY VEHICLE PRIORITY SYSTEM, COMPLETE
 - 2 INDICATES NUMBER OF NEW CONDUCTORS. ALL CABLE IS NO. 14 EXCEPT AS INDICATED. "P" INDICATES PAIR CABLE
 - R
Y
G NEW SIGNAL HEAD WITH OR WITHOUT BACKPLATE
 - P NEW PEDESTRIAN HEAD - LED
 - PEDESTRIAN PUSHBUTTON
 - LEO SEE LIGHTING WIRING DETAILS

2 VEHICULAR MOVEMENT
2 PEDESTRIAN MOVEMENT

NUMBER REFERS TO ASSOCIATED PHASE

REFER TO STANDARD 857001





USER NAME = hubli	DESIGNED -	REVISED -
PLOT SCALE = 1/16" = 1' / in	DRAWN -	REVISED -
PLOT DATE = Mar-19-2019 09:46:01 AM	CHECKED -	REVISED -
	DATE -	REVISED -

**STATE OF ILLINOIS
DEPARTMENT OF TRANSPORTATION**

ALPINE AT FLORIDA/CLEVELAND CABLE PLANS		F.A.P. RTE	SECTION	COUNTY	TOTAL SHEETS	SHEET NO
SCALE: _____		412	14815	WINNEBAGO	15	8
SHEET _____ OF _____ SHEETS		ILLINOIS FED. AID PROJECT		CONTRACT NO. 64M32		

LEGEND



-  EXISTING LIGHTING UNIT TO BE REMOVED.
-  PROPOSED COMBINATION LIGHTING UNIT, LED, MEDIUM WATTAGE, 35' MH, 12' ARM.
-  ECC 2-1C NO. 10, 1/C NO. 10 GND (XLP-TYPE, USE 2).
-  LIGHTING/TRAFFIC SIGNAL HAND HOLE.

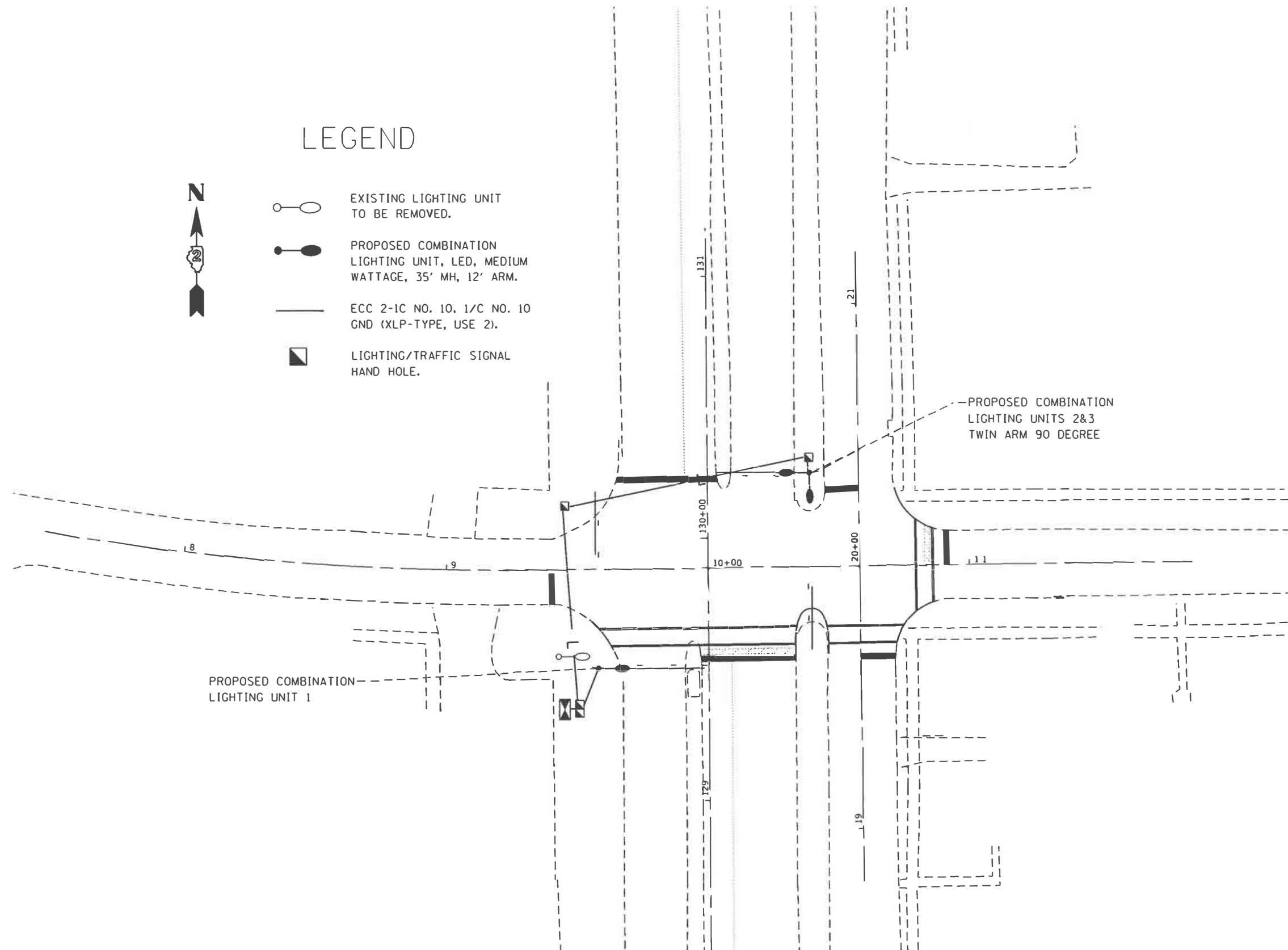

PROPOSED COMBINATION LIGHTING UNIT 1

PROPOSED COMBINATION LIGHTING UNITS 2&3 TWIN ARM 90 DEGREE

MODEL: Def-hut
 FILE NAME: s:\subsystem\del_illinois\pwwork\Documents\1501_01\cctd\street_2\project\64432\Operations\1\lighting\64432_sht.n.dgn

USER NAME = hiltl	DESIGNED -	REVISED -
	DRAWN -	REVISED -
PLOT SCALE = 41.6710 / in	CHECKED -	REVISED -
PLOT DATE = Mar-19-2019 09:46:16 AM	DATE -	REVISED -

**STATE OF ILLINOIS
DEPARTMENT OF TRANSPORTATION**

**ALINE AT FLORIDA/CLEVELAND
LIGHTING PLANS**

SCALE: _____ SHEET OF _____ SHEETS STA _____ TO STA _____

F.A.P. RTE.	SECTION	COUNTY	TOTAL SHEETS	SHEET NO.
412	148IS	WINNEBAGO	15	9
CONTRACT NO. 64M32			ILLINOIS FED. AID PROJECT	

REV. 9/16/19

MODEL: D:\work\11\110000\110000.dwg
 FILE: 110000.dwg
 USER: jh
 PLOT DATE: 3/21/2019 01:59:11 PM
 PLOT SCALE: 1/4" = 1'

POT Sta 100+00.00

ALPINE RD.

FRONTAGE RD.

11
CLEVELAND AVE.

10+00

20+00

POT Sta 20+00.00

Median Pedestrian Crossing

POINT	STATION	OFFSET	SIDE	ELEVATION
A	10+32.97	28.53	RT	850.56
B	10+35.54	28.53	RT	850.60
C	10+33.32	23.50	RT	850.58
D	10+35.93	23.53	RT	850.62
E	10+42.75	23.53	RT	850.67
F	10+42.75	28.53	RT	850.66
G	10+45.73	28.53	RT	850.62
H	10+45.38	23.53	RT	850.63

Description Cleveland Ave. & Frontage Rd. N

POINT	STATION	OFFSET	SIDE	ELEVATION
EE	10+85.10	14.36	LT	850.01
FF	10+85.10	16.39	LT	850.05
GG	10+80.10	19.47	LT	850.09
HH	10+80.10	17.09	LT	850.05
II	10+74.26	23.15	LT	850.19
JJ	10+76.22	23.81	LT	850.44
KK	10+80.11	23.81	LT	850.41
LL	10+85.11	23.81	LT	850.35
MM	10+92.11	23.80	LT	850.38
NN	10+99.75	24.12	LT	850.49
OO	10+99.75	28.56	LT	850.52
PP	10+92.11	28.80	LT	850.41
QQ	10+85.11	28.80	LT	850.38
RR	10+79.53	28.81	LT	850.45
SS	10+74.53	28.81	LT	850.50
TT	10+75.02	25.84	LT	850.46
UU	10+73.32	24.86	LT	850.21
VV	10+79.54	35.81	LT	850.51
WW	10+74.53	35.81	LT	850.47
XX	10+79.54	43.36	LT	850.62
YY	10+75.12	43.53	LT	850.59
ZZ	10+85.10	19.46	LT	850.08

Cleveland Ave. & Frontage Rd. S

POINT	STATION	OFFSET	SIDE	ELEVATION
I	10+85.05	14.31	RT	850.20
J	10+85.07	16.24	RT	850.24
K	10+79.70	18.78	RT	850.32
L	10+78.92	17.75	RT	850.30
M	10+75.72	23.21	RT	850.40
N	10+74.64	22.54	RT	850.38
O	10+71.99	28.53	RT	850.47
P	10+73.25	28.53	RT	850.49
Q	10+80.06	23.53	RT	850.46
R	10+74.56	28.53	RT	850.44
S	10+79.56	28.53	RT	850.49
T	10+85.06	28.53	RT	850.55
U	10+92.06	28.53	RT	850.63
V	10+97.06	28.53	RT	850.67
W	10+97.06	24.12	RT	850.70
X	10+92.06	23.54	RT	850.67
Y	10+85.06	23.53	RT	850.48
Z	10+74.55	35.53	RT	850.74
AA	10+79.55	35.53	RT	850.81
BB	10+75.15	40.53	RT	850.81
CC	10+79.55	40.53	RT	850.87
DD	10+85.07	19.24	RT	850.25

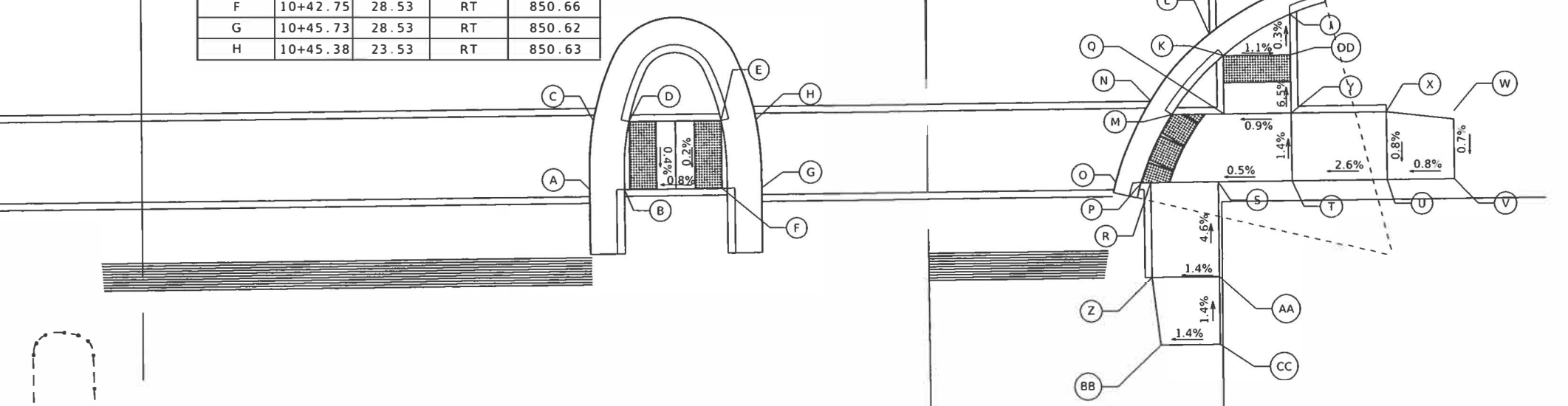

USER: jh	DESIGNED -	REVISED -
PLOT SCALE = 1/4" = 1'	DRAWN -	REVISED -
PLOT DATE = Mar-21-2019 01:59:11 PM	CHECKED -	REVISED -
	DATE -	REVISED -

STATE OF ILLINOIS
DEPARTMENT OF TRANSPORTATION

ALPINE AT CLEVELAND FLORIDA
ADA RAMP

F.A.P. RTE 412	SECTION 148TS	COUNTY Winnebago	TOTAL SHEETS 2	SHEET NO. 10
CONTRACT NO. 64M32				
ILLINOIS FED. AID PROJECT				



DOT CASE 100.00

HMA Entr.

PT Sta 9+36.20

HMA

9

FLORIDA DR.

HMA

Florida Dr & Alpine Rd

POINT	STATION	OFFSET	SIDE	ELEVATION
AA	9+62.12	28.53	RT	851.71
BB	9+60.15	28.53	RT	851.67
CC	9+58.74	23.53	RT	851.73
DD	9+56.36	23.53	RT	851.69
EE	9+56.36	28.53	RT	851.63
FF	9+49.36	28.53	RT	851.36
GG	9+49.36	23.53	RT	851.42
HH	9+25.86	28.43	RT	850.58
II	9+25.86	23.43	RT	850.54
JJ	9+19.05	23.40	RT	850.28
KK	9+18.24	28.40	RT	850.34
LL	9+18.33	23.56	RT	850.24
MM	9+17.43	28.40	RT	850.30

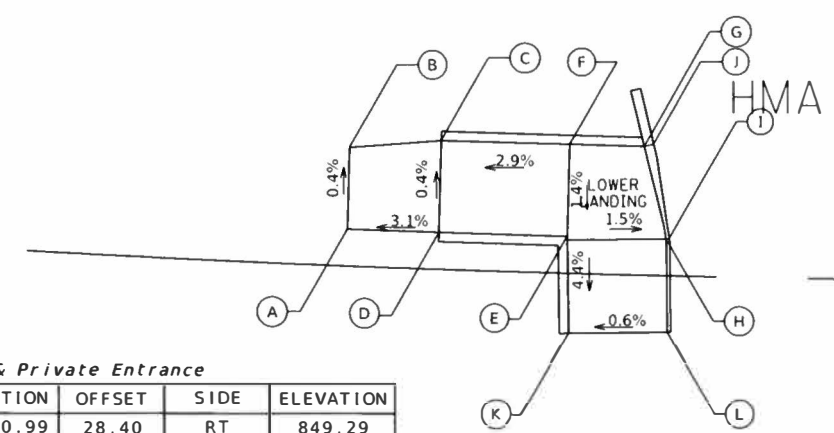

Florida Dr. & Private Entrance

POINT	STATION	OFFSET	SIDE	ELEVATION
A	8+80.99	28.40	RT	849.29
B	8+80.93	23.40	RT	849.27
C	8+85.83	23.42	RT	849.42
D	8+85.86	28.40	RT	849.44
E	8+92.67	28.40	RT	849.55
F	8+92.67	23.40	RT	849.62
G	8+96.68	23.40	RT	849.57
H	8+97.95	28.40	RT	849.57
I	8+98.11	28.40	RT	849.57
J	8+97.17	23.27	RT	849.57
K	8+92.87	33.67	RT	849.32
L	8+98.12	33.47	RT	849.36

HMA Entr.

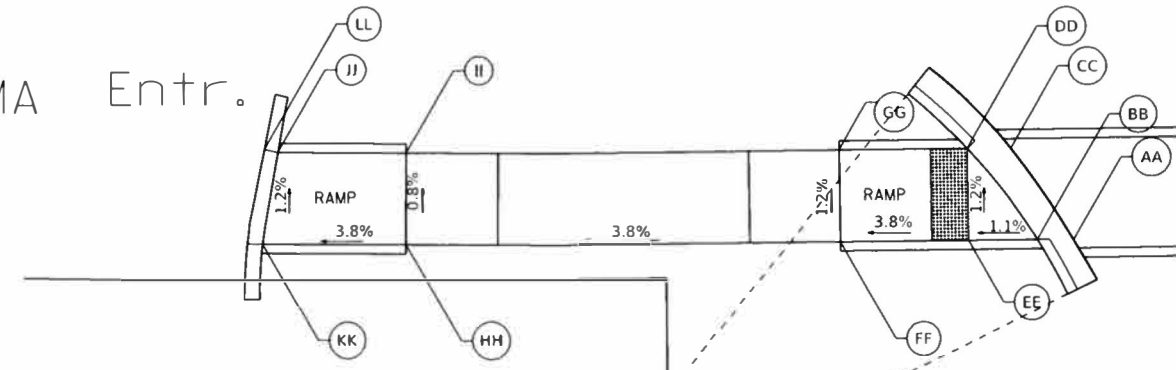

ALPINE RD.

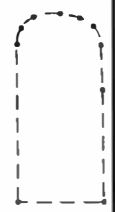

MODEL: D:\ra\ra\... H:\E:\RA\RA... ILLINOIS DOT PROJECTS\... 20190321\... 84412_2019.dwg

USER NAME = hnlkt	DESIGNED =	REVISED =
PLOT SCALE = 1/2" = 125.3' / in	DRAWN =	REVISED =
PLOT DATE = Mar-21-2019 01:59:22 PM	CHECKED =	REVISED =
	DATE =	REVISED =

**STATE OF ILLINOIS
DEPARTMENT OF TRANSPORTATION**

**ALPINE AT CLEVELAND/FLORIDA
ADA RAMPS**

SCALE: _____ SHEET _____ OF _____ SHEETS STA _____ TO STA _____

F.A.P. RTE. 412	SECTION 1487S	COUNTY Winnebago	TOTAL SHEETS 15	SHEET NO. 11
ILLINOIS FED AID PROJECT				
CONTRACT NO. 64M32				

TYPICAL PAVEMENT MARKINGS

TYPICAL PAVEMENT MARKING FOR FLUSH MEDIAN AT LEFT TURN LANE

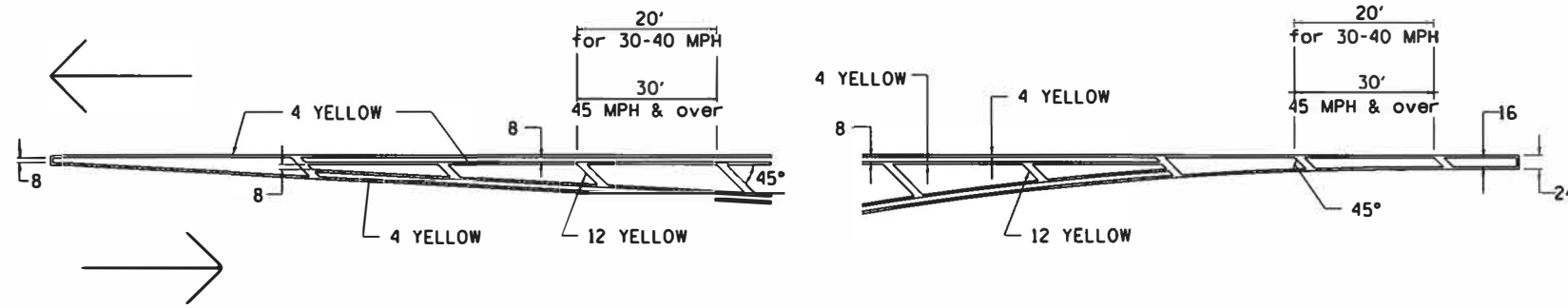

MEDIAN PAVEMENT MARKING

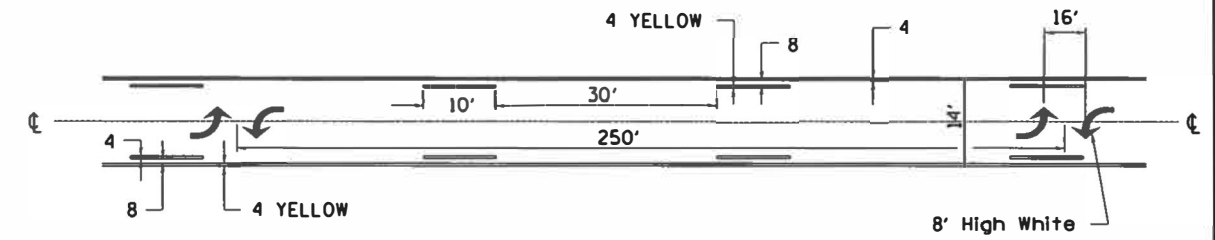

•• ALL DIMENSIONS ARE IN INCHES UNLESS OTHERWISE NOTED.

TYPICAL ISLAND OFFSET SHOULDER WIDTH

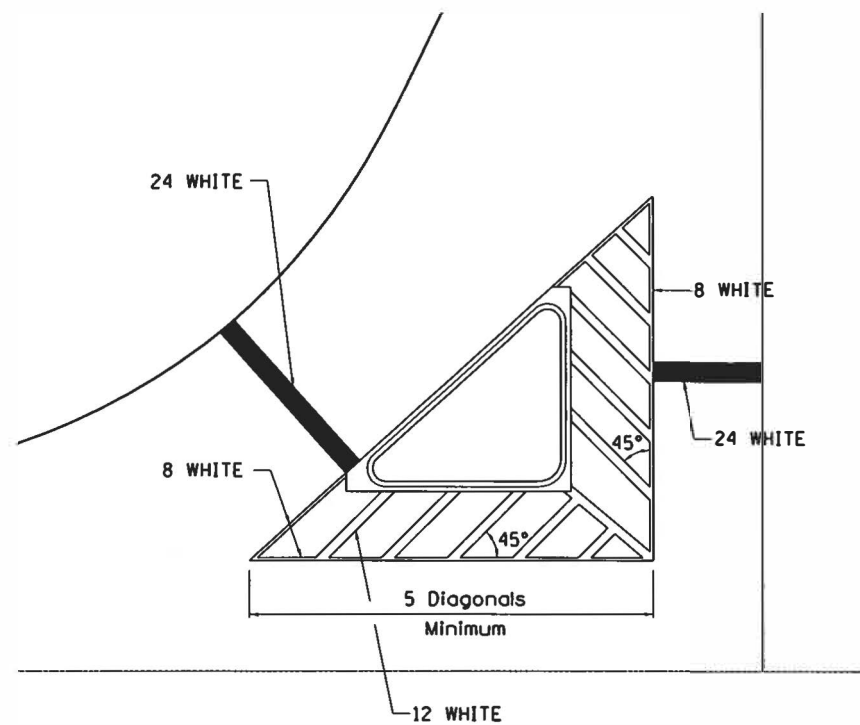

TYPICAL MARKING FOR PAINTED ISLANDS

NOTE:
* 45° TO LOCAL TAN.

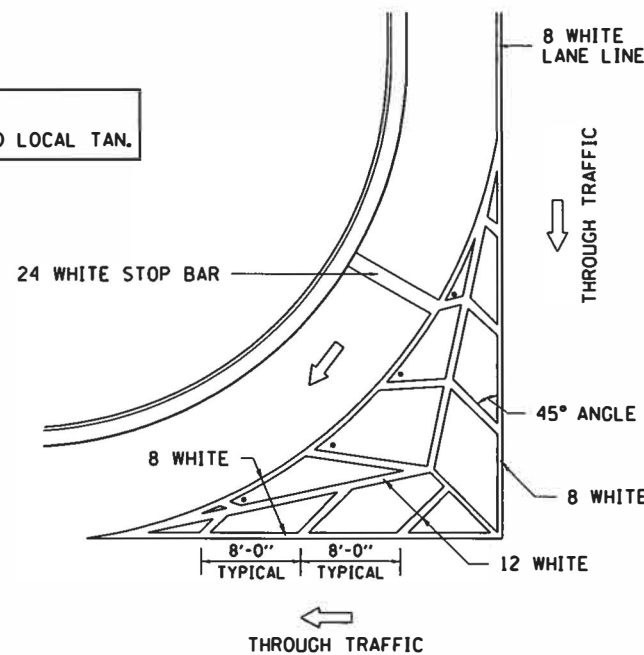

STANDARD CROSSWALK MARKING

See Schedules for Locations

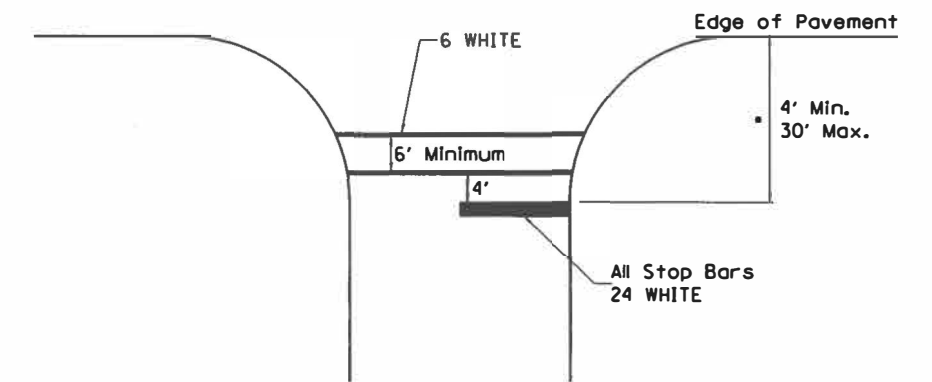

• Distance to the nearest edge of the intersecting roadway in the absence of a marked crosswalk.

FILE NAME -	USER NAME - hiki	DESIGNED -	REVISED - 6-27-14	STATE OF ILLINOIS DEPARTMENT OF TRANSPORTATION	REGION 2 / DISTRICT 2 STANDARD		F.A. RTE.	SECTION	COUNTY	TOTAL SHEETS	SHEET NO.	
p:\planroom.doc\illinois.gov\PI\DOT\Documents\1007 Offices\District 2\Projects\64M32\Drawings\Traffic\Signal Sheets\02.64M32		CHECKED -	REVISED - 3-05-12		SCALE:	SHEET NO. OF SHEETS	STA. TO STA.				13	16
		PLLOT SCALE - 41.8638' / in.	CHECKED -								CONTRACT NO.	
		PLLOT DATE - Mar-14-2019 02:32:42 PM	DATE -					FED. ROAD DIST. NO. ILLINOIS FED. AID PROJECT				

TYPICAL PAVEMENT MARKINGS

ARROW LAYOUT

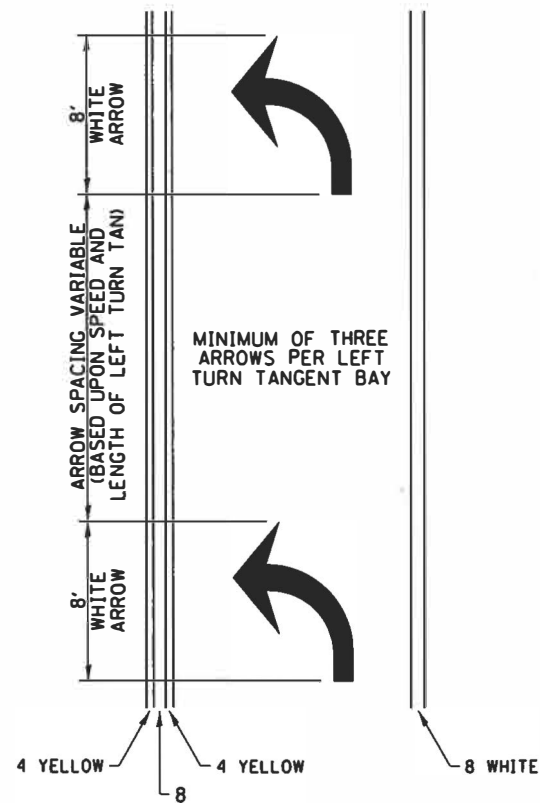

- ◀ ONE-WAY AMBER MARKER
- ◁ ONE-WAY CRYSTAL MARKER
- ◆ TWO-WAY AMBER MARKER

ALL DIMENSIONS ARE IN INCHES UNLESS OTHERWISE NOTED.

TYPICAL PAVEMENT MARKING FOR FLUSH MEDIAN

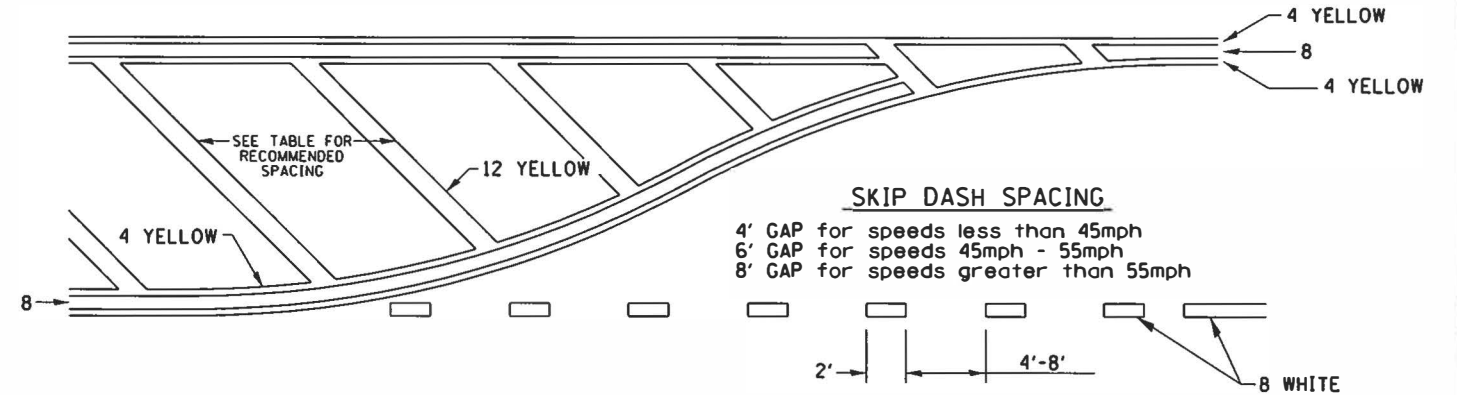

RECOMMENDED SPACING BETWEEN DIAGONALS (IN FEET)

Speed Limit Range	Continuous Median Area	Intersection Channelization	Objects (Islands)
less than 30MPH	50'	15'	10'
30-40MPH	75'	20'	15'
45MPH & over	75'	30'	20'

NOTE: if the spacing recommended in the Table does not permit at least five diagonal lines in the area being marked, the spacing from the next lowest speed range should be used. The recommended spacing is measured parallel to the pavement center line.

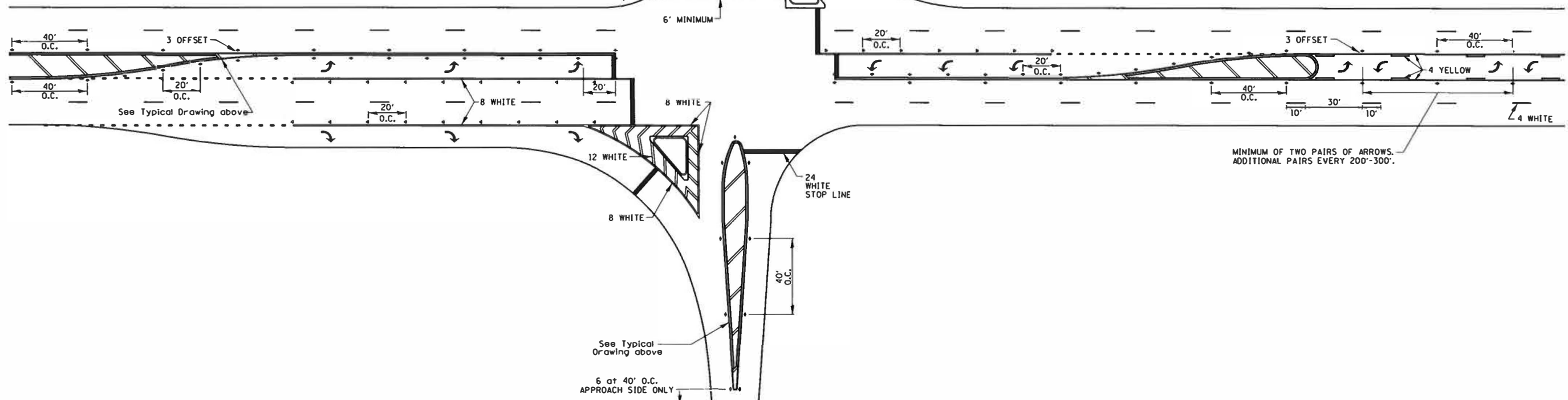

FILE NAME :	USER NAME = h11k1	DESIGNED -	REVISED - 6-27-14	STATE OF ILLINOIS DEPARTMENT OF TRANSPORTATION	REGION 2 / DISTRICT 2 STANDARD			F.A. RTE.	SECTION	COUNTY	TOTAL SHEETS	SHEET NO.
pl:\planroom.dot.illinois.gov\PWID01\Docu	ents\1007 Offices\District 2\Projects\64M3	DRAWN=ns\Traffic\Signal Sheets\02.64M3	REVISED - 3-05-12		SCALE:	SHEET NO. OF SHEETS	STA. TO STA.	FED. ROAD DIST. NO.	ILLINOIS FED. AID PROJECT	CONTRACT NO.	15	16
		CHECKED -	REVISED -									
		DATE -	REVISED -									

TYPICAL PAVEMENT MARKINGS

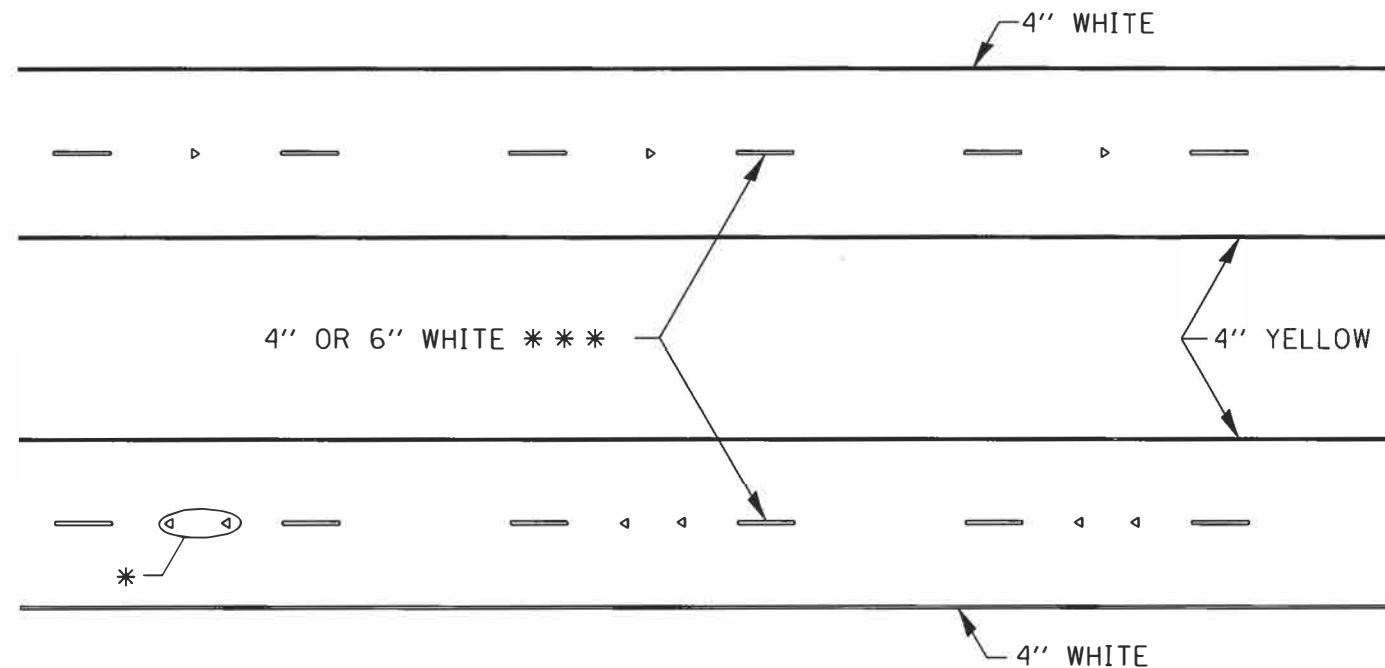

* SEE HIGHWAY STANDARD 781001 FOR SPACING DETAILS.
USE DOUBLE MARKERS WHEN ADT > 20,000.

MULTI-LANE / DIVIDED

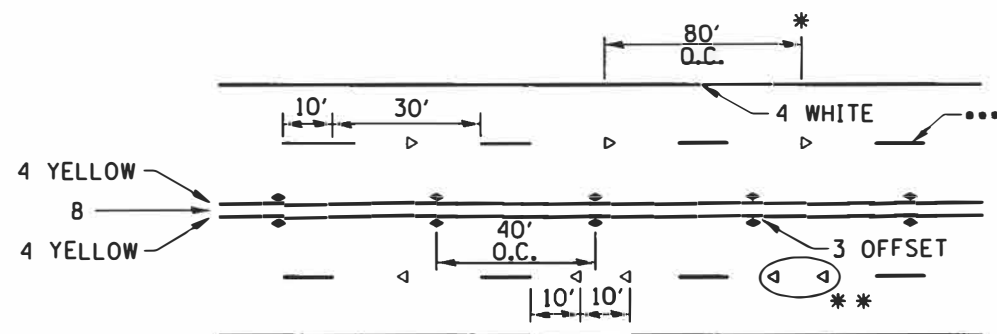

• REDUCE TO 40' O.C. ON CURVES WHERE ADVISORY SPEEDS ARE 10 MPH LOWER THAN POSTED SPEEDS.

•• USE DOUBLE MARKERS WHEN ADT ≥ 20,000

••• CENTERLINE SKIP DASH PAVEMENT MARKING SPEED LIMIT LESS THAN 40 MPH USE 4" LINE. SPEED LIMIT 40 MPH AND OVER USE 6" LINE.

MULTI-LANE / UNDIVIDED & ONE WAY

(FOR MULTI-LANE UNDIVIDED HIGHWAYS USE THIS DETAIL NOT HIGHWAY STANDARD 781001)

TYPICAL PARKING SPACING

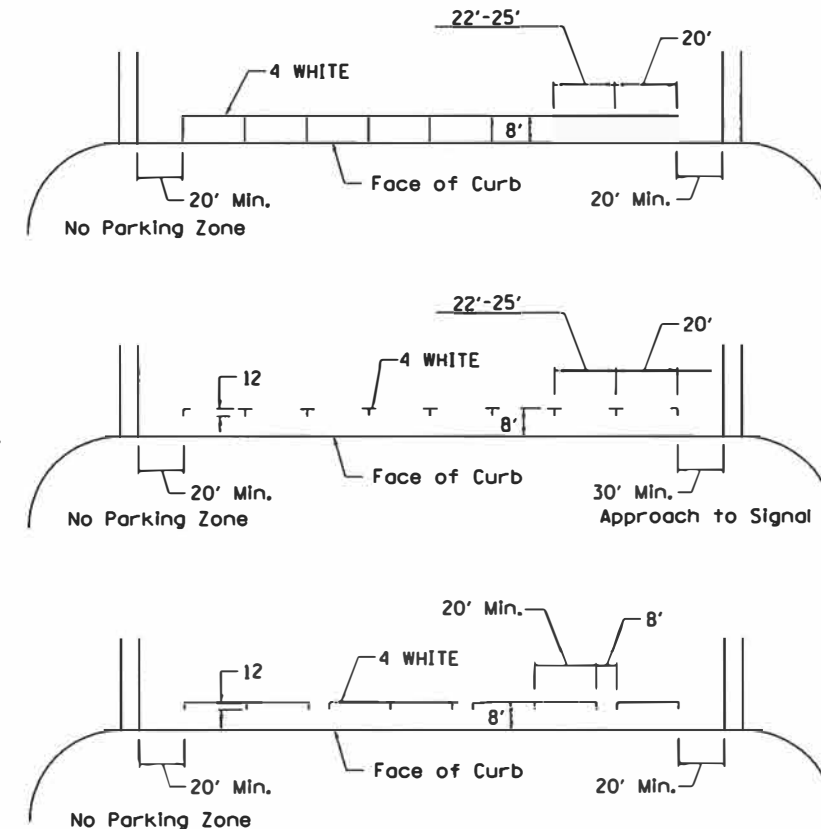

TYPICAL PAVEMENT MARKING FOR TWO LANE SECTION - NO PASSING ZONES

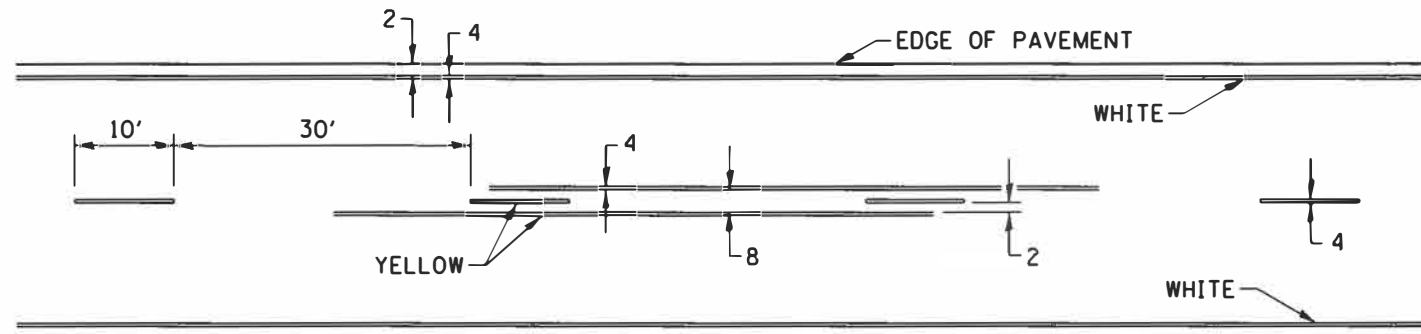

SYMBOLS

FILE NAME :	USER NAME : hllkl	DESIGNED -	REVISED - 6-27-14	STATE OF ILLINOIS DEPARTMENT OF TRANSPORTATION	REGION 2 / DISTRICT 2 STANDARD	F.A. RTE.	SECTION	COUNTY	TOTAL SHEETS	SHEET NO.		
pr\planroom\dct.illinois.gov\PW1001\Documents\DOT Offices\District 2\Projects\6432\DRAWINGS\Traffic\Signal Sheets\02.6432	DRAWN	REVISOR	REVISED - 8-27-13			SCALE: _____	SHEET NO. ___ OF ___ SHEETS	STA. _____ TO STA. _____	FED. ROAD DIST. NO. _____	ILLINOIS FED. AID PROJECT	CONTRACT NO.	15-14
PLOT SCALE = 42.0558' / in.	CHECKED -	REVISOR	REVISED - 11-28-12									
PLOT DATE = Mar-14-2019 02:33:06 PM	DATE -	REVISOR	REVISED -									



SOIL BORING LOG

Date 3/27/18

ROUTE FAP 412 DESCRIPTION Traffic Signal Upgrades on Alpine Road at Florida Drive/Cleveland Avenue LOGGED BY N. White

SECTION 148TS LOCATION Rockford - N32, SEC. , TWP. 44N, RNG. 2E

COUNTY Winnebago DRILLING METHOD Hollow Stem Auger HAMMER TYPE CME-45

STRUCT. NO. SE Quadrant Latitude Longitude Northing Easting Station

BORING NO. B-1a Station 45' S. of Center of Int. Offset 27.00ft E of CL NB lanes Ground Surface Elev. 98.80 ft

Description	Elev. (ft)	B	U	M	S	T	H	Soil Properties											
								D	E	L	C								
4" Asphalt; 6.5" Aggregate Subbase																			
STIFF block SILTY CLAY LOAM	96.80	1																	
		2	1.2	24.0															
	95.30	4	P																
STIFF brown SANDY LOAM		2																	
		2	1.0	18.0															
	92.80	3	P																
MEDIUM brown SANDY LOAM TILL		2																	
		6	0.5	10.0															
	90.30	6	S																
MEDIUM brown SANDY LOAM TILL		3																	
		6	B	11.0															
	87.80																		
VERY STIFF brown SANDY LOAM TILL		10																	
		12	2.2	8.0															
	85.30	22	S																
HARD brown SANDY LOAM TILL		17																	
		27	4.1	8.0															
	82.80	32	S																
HARD brown SANDY LOAM TILL		19																	
		30	4.2	7.0															
	80.30	35	P																
		18																	
	-20																		

The Unconfined Compressive Strength (UCS) Failure Mode is indicated by (B-Bulge, S-Shear, P-Penetrometer) The SPT (N value) is the sum of the last two blow values in each sampling zone (AASHTO T206)

BBS, from 137 (Rev. 8-99)



SOIL BORING LOG

Date 3/28/18

ROUTE FAP 412 DESCRIPTION Traffic Signal Upgrades on Alpine Road at Louisiana Road LOGGED BY N. White

SECTION 148TS LOCATION Rockford - NW 32, SEC. , TWP. 44N, RNG. 2E

COUNTY Winnebago DRILLING METHOD Hollow Stem Auger HAMMER TYPE CME-45

STRUCT. NO. S. Center Raised Median Latitude Longitude Northing Easting Station

BORING NO. B-1b Station 43' S. of Center of Int. Offset 22.00ft E of CL SB lanes Ground Surface Elev. 101.50 ft

Description	Elev. (ft)	B	U	M	S	T	H	Soil Properties											
								D	E	L	C								
4" Concrete																			
STIFF brown SANDY LOAM			2.0	12.0															
			P																
STIFF brown SANDY LOAM	99.50	8																	
		5	2.0	11.0															
	98.00	6	P																
No Recovery.		3																	
		4																	
	95.50	6																	
STIFF brown SANDY LOAM TILL		4																	
		9	1.6	8.0															
	93.00	11	S																
VERY STIFF brown SANDY LOAM TILL		22																	
		36	2.9	7.0															
	90.50	77	S																
HARD brown SANDY LOAM TILL		40																	
		100/10	2.7	7.0															
	88.00		P																
HARD brown SANDY LOAM TILL		44																	
		46	4.2	7.0															
	85.50	46	P																
HARD brown SANDY LOAM TILL		35																	
		45	2.5	7.0															
	83.00	55	P																
		46																	
	-20																		

The Unconfined Compressive Strength (UCS) Failure Mode is indicated by (B-Bulge, S-Shear, P-Penetrometer) The SPT (N value) is the sum of the last two blow values in each sampling zone (AASHTO T206)

BBS, from 137 (Rev. 8-99)

MODEL: D:\proj\180418\180418.dwg USER: nwhite DATE: 3/27/18

USER NAME = nwhite	DESIGNED =	REVISED =
PLOT SCALE = 1:200	CHECKED =	REVISED =
PLOT DATE = Mar.14.2019 02:33:16 PM	DATE =	REVISED =

STATE OF ILLINOIS DEPARTMENT OF TRANSPORTATION

ALPINE AT PROJECT INTERSECTS BORING LOGS			
SCALE	SHEET	OF SHEETS	STA TO STA

F.A.P. RTE 412	SECTION 148TS	COUNTY Winnebago	TOTAL SHEETS 5	SHEET NO 5
ILLINOIS FED. AID PROJECT			CONTRACT NO. 165	