

036

11-08-2019 LETTING ITEM 036

STATE OF ILLINOIS  
DEPARTMENT OF TRANSPORTATION

F.A.P. SITE	SECTION	COUNTY	TOTAL SHEETS	SHEET NO.
757	(20) BDR, BJR	SCOTT	19	1
ILLINOIS CONTRACT NO 72K44				

FOR INDEX OF SHEETS AND HIGHWAY STANDARDS, SEE SHEET NO. 2

# PROPOSED HIGHWAY PLANS

FAP ROUTE 757 (ILLINOIS ROUTE 100/106)  
SECTION (20) BDR, BJR  
PROJECT STP-5554(706)  
FLORENCE BRIDGE REPAIR  
SCOTT COUNTY

C-96-052-18



FUNCTIONAL CLASSIFICATION  
RURAL MINOR ARTERIAL  
2017 ADT = 1,500  
P.V.=90.57% S.U.=3.10% M.U.=6.33%

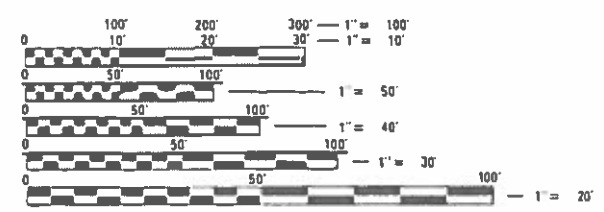

FULL SIZE PLANS HAVE BEEN PREPARED USING STANDARD ENGINEERING SCALES. REDUCED SIZED PLANS WILL NOT CONFORM TO STANDARD SCALES. IN MAKING MEASUREMENTS ON REDUCED PLANS, THE ABOVE SCALES MAY BE USED.

J.U.L.I.E.  
JOINT UTILITY LOCATION INFORMATION FOR EXCAVATORS  
1-800-892-0123  
OR 811

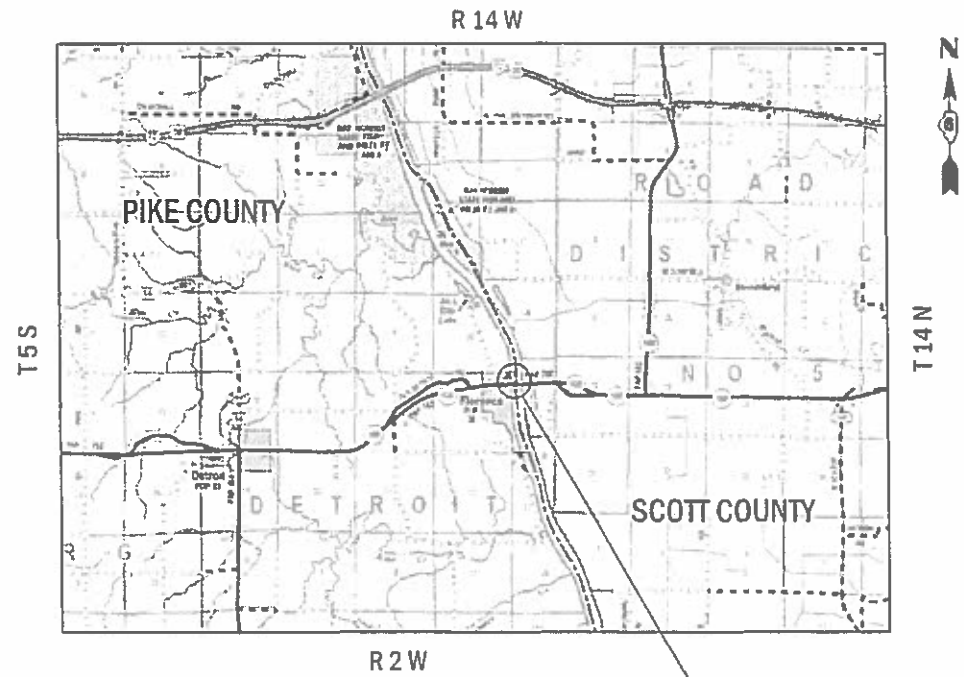

BRIDGE REPAIR  
STA. 586+81.50  
SN 086-0001

PROJECT ENGINEER: JAY WAVERING 217-785-9046  
PROJECT MANAGER: JON KELLEY 217-785-2739

GROSS LENGTH = 3178.95 FT. = 0.602 MILE  
NET LENGTH = 3178.95 FT. = 0.602 MILE

STATE OF ILLINOIS  
DEPARTMENT OF TRANSPORTATION

SUBMITTED Aug 15 2019

[Signature] REGIONAL ENGINEER

Oct 4 2019  
[Signature] ENGINEER OF DESIGN AND ENVIRONMENT

Oct 4 2019  
[Signature] DIRECTOR, COUNTY PROJECT IMPLEMENTATION

PRINTED BY THE AUTHORITY  
OF THE STATE OF ILLINOIS

CONTRACT NO. 72K44

REV. - MS

**GENERAL NOTES**

1. THE PERMANENT PAVEMENT MARKINGS FOR THIS STRUCTURE SHALL BE COMPLETED BY DISTRICT 6, BUREAU OF OPERATIONS. THE CONTRACTOR SHALL CONTACT DISTRICT 6, OPERATIONS AT (217) 785-5312 TO PROVIDE A TWO WEEK NOTICE FOR INSTALLING THE PERMANENT PAVEMENT STRIPING.

**COMMITMENTS**

NONE

**INDEX OF SHEETS**

- 1 COVER SHEET
- 2 GENERAL NOTES
- 3 SUMMARY OF QUANTITIES
- 4 SCHEDULES OF QUANTITIES
- 5-6 DETOUR SHEETS
- 7-18 BRIDGE REPAIR PLANS

**HIGHWAY STANDARDS**

- 000001-07 STANDARD SYMBOLS, ABBREVIATIONS, AND PATTERNS
- 001006 DECIMAL OF AN INCH AND OF A FOOT
- 701001-02 OFF-RD OPERATIONS, 2L, 2W, MORE THAN 15' AWAY
- 701006-05 OFF-RD OPERATIONS, 2L, 2W, 15' TO 24" FROM PAVEMENT EDGE
- 701201-05 LANE CLOSURE, 2L, 2W, DAY ONLY, FOR SPEEDS ≥ 45 MPH
- 701301-04 LANE CLOSURE, 2L, 2W SHORT TIME OPERATIONS
- 701901-08 TRAFFIC CONTROL DEVICES
- B.L.R. 21-9 TYPICAL APPLICATION OF TRAFFIC CONTROL DEVICES FOR CONSTRUCTION ON RURAL LOCAL HIGHWAYS

Route \_\_\_\_\_  
 Section \_\_\_\_\_  
 County \_\_\_\_\_

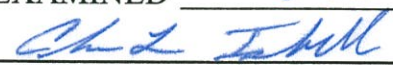
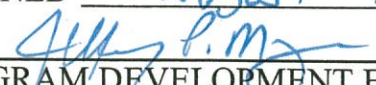
<b>DISTRICT SIX</b>	
EXAMINED 	20 _____
8/12/19	
OPERATIONS ENGINEER	
EXAMINED <u>8-12</u>	20 <u>19</u>
	
PROJECT IMPLEMENTATION ENGINEER	
EXAMINED <u>August 1</u>	20 <u>19</u>
	
PROGRAM DEVELOPMENT ENGINEER	

MODEL Default  
 FILE NAME: \\p:\planning\room\dot\illinois.gov\p\DOT\Documents\DOT - Offices\District 6\Projects\B72\scat\CAD\Bual\Cr\Briest\B72\scat.dwg

USER NAME = kcl/cyb	DESIGNED -	REVISED -
	DRAWN -	REVISED -
PLOT SCALE = 100.0000' / in	CHECKED -	REVISED -
PLOT DATE = 8/14/2019	DATE -	REVISED -

**STATE OF ILLINOIS  
 DEPARTMENT OF TRANSPORTATION**

<b>GENERAL NOTES INDEX OF SHEETS</b>	
SCALE:	SHEET OF SHEETS STA. TO STA.

F.A.P. RTE.	SECTION	COUNTY	TOTAL SHEETS	SHEET NO.
757	(20) BDR, B/R	SCOTT	18	2
CONTRACT NO. 72K44				
ILLINOIS FED. AID PROJECT				



SHORT TERM PAVEMENT MARKING		
	70300100	70300150
BRIDGE LENGTH	CENTERLINE WHITE - 4"	CENTERLINE
(FOOT)	4' DASH - 40' SKIP (FOOT)	REMOVAL (SQ FT)
3179	320	106.7

MODEL: Default  
FILE: \\nlsdot\p\pub\p\room\dat\illinois.gov\PW\DOT\Documents\DOT\_Offices\District\_6\Projects\72K44\CAD\Drawings\72K44-SP-Schedule.dgn

USER NAME = coxte	DESIGNED -	REVISED -
	DRAWN -	REVISED -
PLOT SCALE = 100.0000 ' / in.	CHECKED -	REVISED -
PLOT DATE = 8/15/2019	DATE -	REVISED -

**STATE OF ILLINOIS  
DEPARTMENT OF TRANSPORTATION**

**SCHEDULE OF QUANTITIES**

SCALE: SHEET OF SHEETS STA. TO STA.

F.A.P. RTE.	SECTION	COUNTY	TOTAL SHEETS	SHEET NO.
757	(20) BDR, BJR	SCOTT	18	4
			CONTRACT NO. 72K44	
			ILLINOIS FED. AID PROJECT	







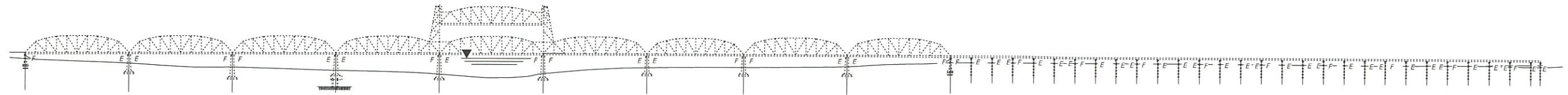

ELEVATION

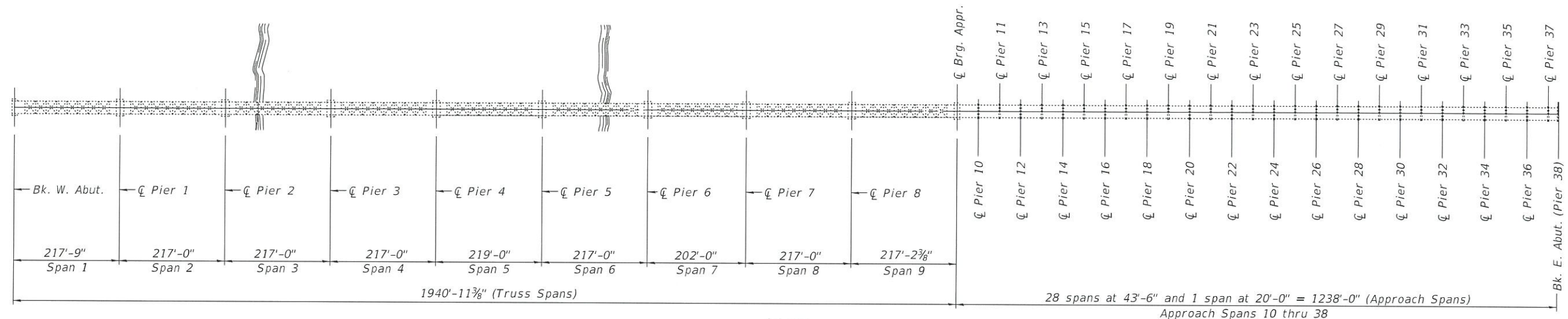

PLAN

SCOPE OF WORK

Replace existing silicone & repair existing polymer as needed on both abutments & piers 2, 7, 9, 12, 15, 18, 21, 24, 27, 30, 33 & 36.  
 \*\*\*\* Scarify and place microsilica overlay on spans 10-38. See sheet 11 of 12 for limits.  
 Remove & replace existing drains on spans 10-38.  
 Deck patching on spans 1-4 & 6-9.

GENERAL NOTES

Plan dimensions and details relative to existing structure have been taken from existing plans and are subject to nominal construction variations. It shall be the Contractor's responsibility to verify such dimensions and details in the field and make necessary approved adjustments prior to construction or ordering of materials. Such variations shall not be cause for additional compensation for a change in the scope of the work, however, the Contractor will be paid for the quantity actually furnished at the unit price bid for the work.  
 Plans of the original construction and prior rehabilitation contracts are available for review at the IDOT District 6 office in Springfield, Illinois.  
 Reinforcement bars designated (E) shall be epoxy coated.  
 Existing reinforcement bars extending into the removal area shall be cleaned, straightened and incorporated into the new construction. Any reinforcement bars that are damaged during concrete removal shall be replaced with an approved bar splicer or anchorage system. Cost included with Concrete Removal.  
 Areas of deck repairs shown are estimated. The Engineer shall show actual locations of deck repairs on As-built Plans.  
 Synthetic fibers shall be added to the Bridge Deck Concrete Overlay, see Special Provisions.

TOTAL BILL OF MATERIAL

ITEM	UNIT	TOTAL
Silicone Joint Sealer	Foot	322
Polymer Concrete	Cu. Ft.	1.2
Floor Drains	Each	58
*** Bridge Deck Scarification (2 1/4")	Sq. Yd.	2830
** Bridge Deck Microsilica Overlay, 2 1/4"	Sq. Yd.	2830
Deck Slab Repair (Full Depth Type II)	Sq. Yd.	219
* Deck Slab Repair (Partial Depth)	Sq. Yd.	369
Bridge Deck Grooving	Sq. Yd.	2590

\* Spans 1 thru 9 only. For estimated quantities in spans 10 thru 38, see sheets 6 thru 10 of 12.  
 \*\* For limits see sheet 11 of 12.  
 \*\*\* Cost includes concrete removal required for placement of Polymer Concrete.

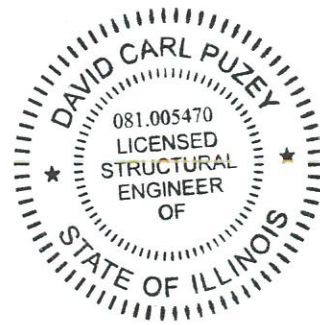

\*\*\*\*Due to the reduced bridge deck thickness after bridge deck scarification, equipment used during bridge deck cleanup (including the hydroscarification process) and placement of the microsilica overlay shall be approved by the Engineer. Concrete ready-mix trucks, pump trucks, tandem trucks and other heavy equipment will not be allowed on the scarified deck. The contractor shall be responsible for ensuring the well-being of the scarified deck surface. Any damage to the scarified deck due to overloading shall be repaired at the Contractor's expense.

In order to safely facilitate construction vehicles and equipment loads on the bridge deck during scarification and placement of the microsilica overlay, multiple stages may be required. An optional staging sequence is shown on sheet 11 of 12. Prior to beginning construction on the bridge deck scarification and microsilica overlay, the contractor shall submit a Staging Plan for the review and approval of the Engineer. No work on bridge deck scarification and microsilica overlay will be allowed to begin until the Staging Plan has been approved.

No loads will be allowed on the microsilica overlay until 72 hours have elapsed from the time of the pour and the overlay have attained a minimum modulus of rupture of 650 psi or a minimum compressive strength of 3500 psi.

EXPIRES 11-30-2020

DESIGNED	<i>Victor H. Kelz</i>	EXAMINED	<i>Tony A. Adair</i>	DATE	OCTOBER 1, 2019
CHECKED	<i>Dominic Baliva</i>	PASSED	<i>David Carl Puzey</i>	REVISED	-
DRAWN	baliva			REVISED	-
CHECKED	VHV		DAB		

STATE OF ILLINOIS  
 DEPARTMENT OF TRANSPORTATION

PLAN AND ELEVATION  
 IL RT. 100 & IL RT. 106 OVER THE ILLINOIS RIVER  
 SN 086-0001

F.A.P. RTE.	SECTION	COUNTY	TOTAL SHEETS	SHEET NO.
757	(20)BDR, BJR	SCOTT-PIKE	18	7
			CONTRACT NO. 72K44	
ILLINOIS FED. AID PROJECT				

SHEET NO. 1 OF 12 SHEETS

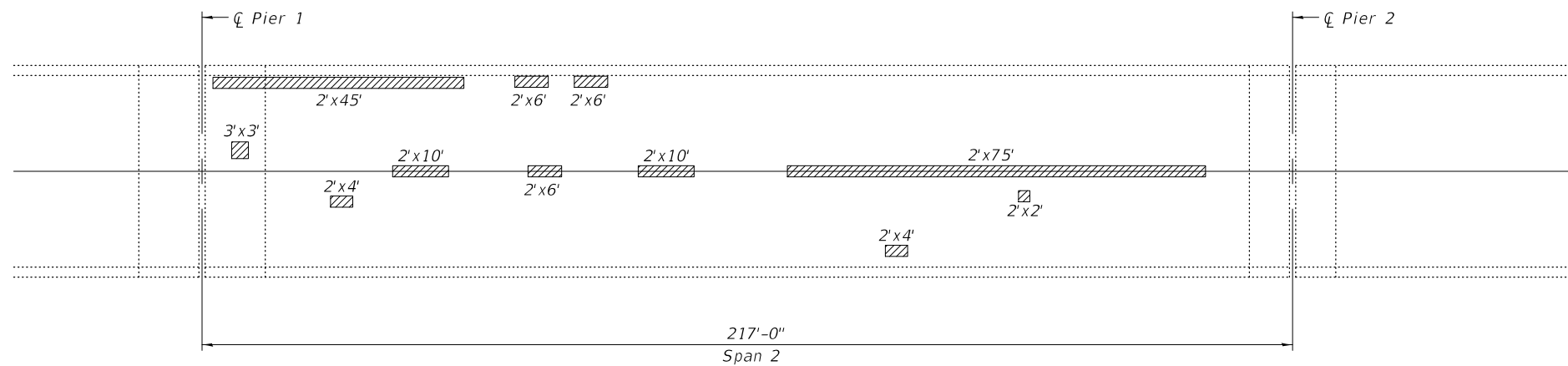
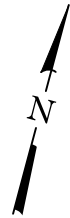
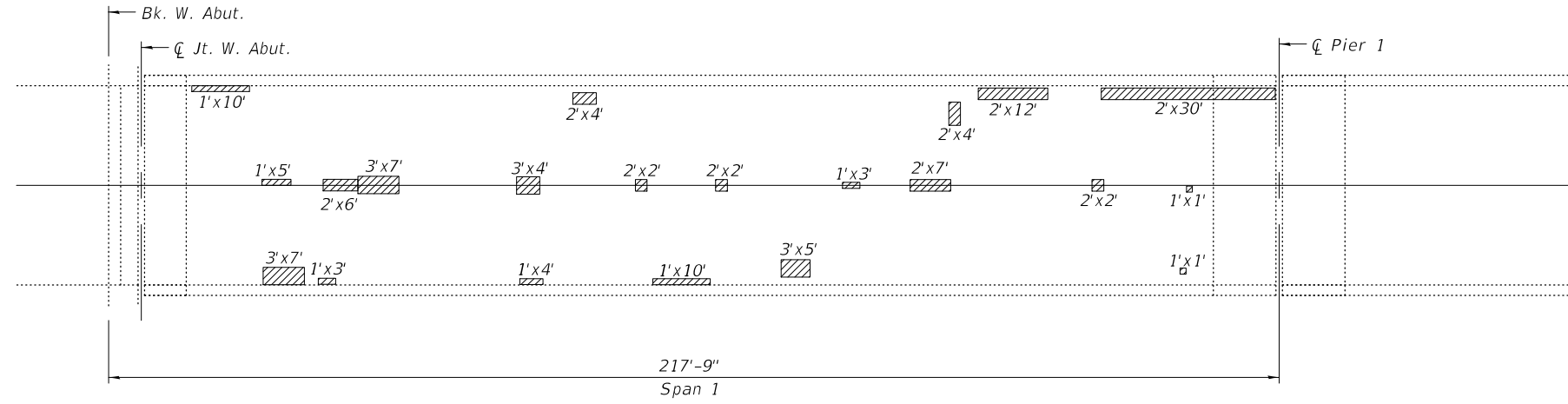

Hatched areas indicate  
Deck Slab Repair (Partial Depth)

**TOTAL BILL OF MATERIAL**

ITEM	UNIT	Span 1	Span 2
Deck Slab Repair (Partial Depth)	Sq. Yd.	27	37

DESIGNED VHV  
 CHECKED DAB  
 DRAWN baliva  
 CHECKED VHV DAB

EXAMINED  
 PASSED  
*Timothy A. Daulton*  
 ENGINEER OF STRUCTURAL SERVICES  
*Carl R. Meyer*  
 ENGINEER OF BRIDGES AND STRUCTURES

DATE - OCTOBER 1, 2019  
 REVISED -  
 REVISED -

**STATE OF ILLINOIS  
 DEPARTMENT OF TRANSPORTATION**

**SPANS 1 & 2 DECK PATCHING DETAILS  
 SN 086-0001**

SHEET NO. 2 OF 12 SHEETS

F.A.P. RTE.	SECTION	COUNTY	TOTAL SHEETS	SHEET NO.
757	(20)BDR, BJR	SCOTT-PIKE	18	8
ILLINOIS			FED. AID PROJECT	



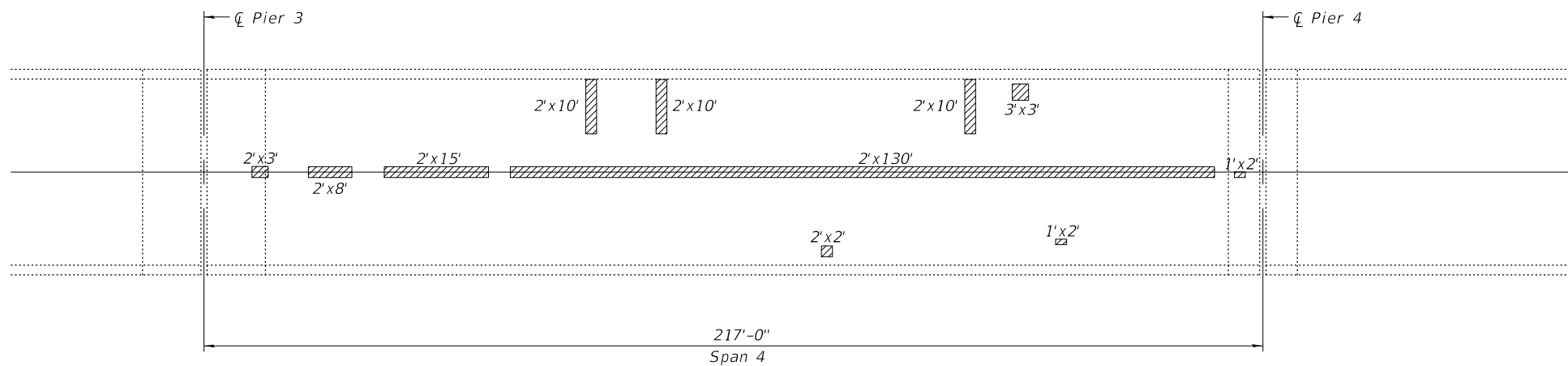
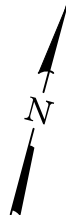
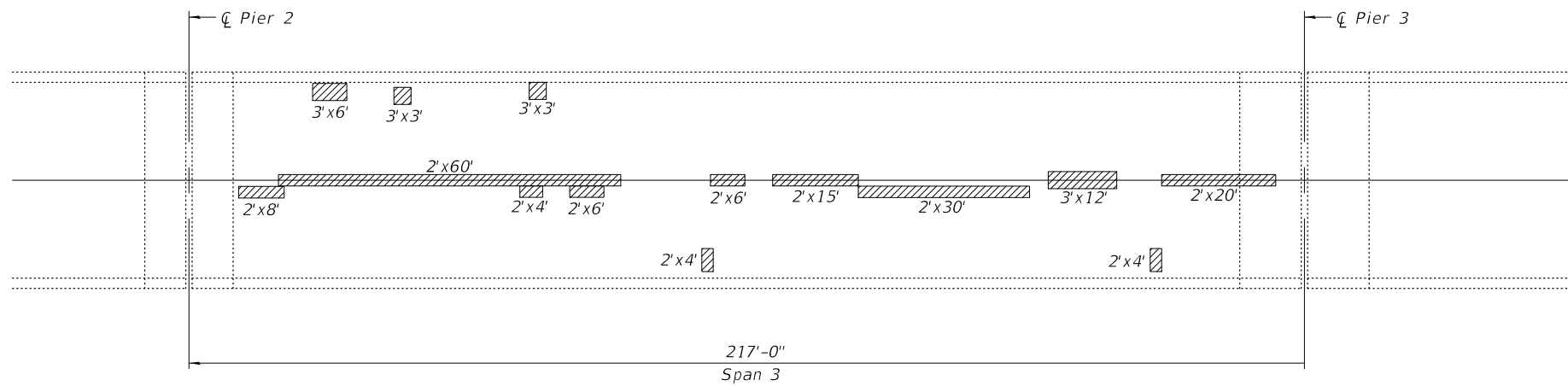

Hatched areas indicate  
Deck Slab Repair (Partial Depth)

**TOTAL BILL OF MATERIAL**

ITEM	UNIT	Span 3	Span 4
Deck Slab Repair (Partial Depth)	Sq. Yd.	44	43

DESIGNED VHV	EXAMINED	DATE - OCTOBER 1, 2019
CHECKED DAB	<i>Timothy A. Daulton</i> ENGINEER OF STRUCTURAL SERVICES	REVISED -
DRAWN baliva	PASSED	REVISED -
CHECKED VHV DAB	<i>Carl Ringer</i> ENGINEER OF BRIDGES AND STRUCTURES	

**STATE OF ILLINOIS  
DEPARTMENT OF TRANSPORTATION**

**SPANS 3 & 4 DECK PATCHING DETAILS  
SN 086-0001**

SHEET NO. 3 OF 12 SHEETS

F.A.P. RTE.	SECTION	COUNTY	TOTAL SHEETS	SHEET NO.
757	(20)BDR, BJR	SCOTT-PIKE	18	9
ILLINOIS FED. AID PROJECT			CONTRACT NO. 72K44	

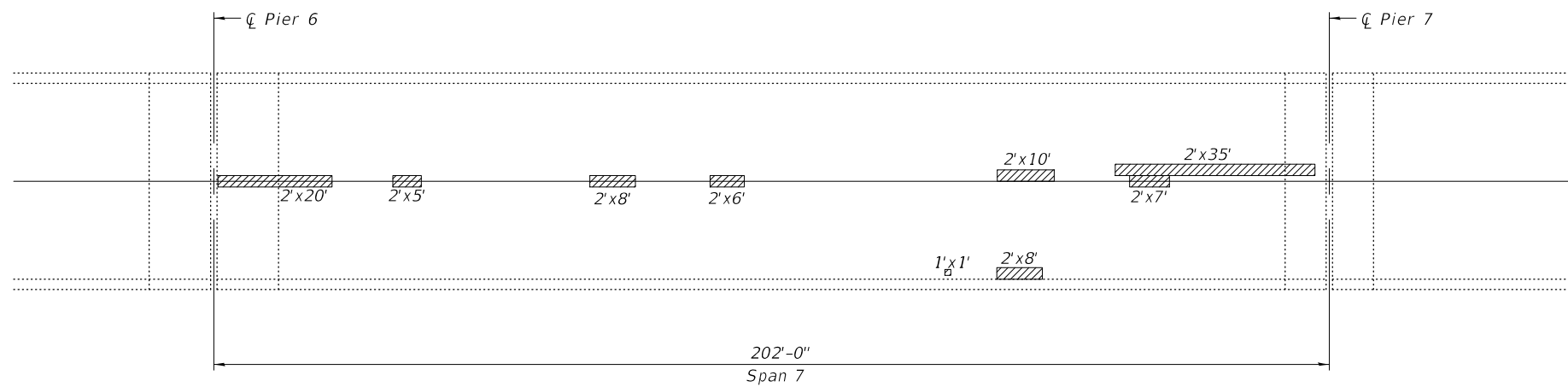
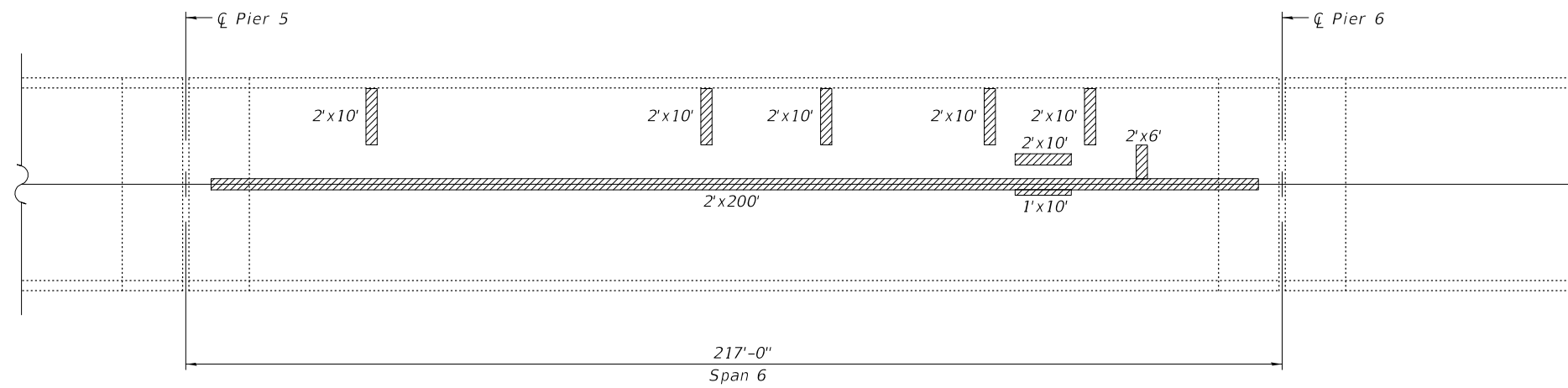

Hatched areas indicate  
Deck Slab Repair (Partial Depth)

**TOTAL BILL OF MATERIAL**

ITEM	UNIT	Span 6	Span 7
Deck Slab Repair (Partial Depth)	Sq. Yd.	60	22

DESIGNED VHV	EXAMINED	DATE - OCTOBER 1, 2019
CHECKED DAB	<i>Timothy A. Daulton</i> ENGINEER OF STRUCTURAL SERVICES	REVISED -
DRAWN baliva	PASSED	REVISED -
CHECKED VHV DAB	<i>Carl R. Meyer</i> ENGINEER OF BRIDGES AND STRUCTURES	

**STATE OF ILLINOIS  
DEPARTMENT OF TRANSPORTATION**

**SPANS 6 & 7 DECK PATCHING DETAILS  
SN 086-0001**

SHEET NO. 4 OF 12 SHEETS

F.A.P. RTE.	SECTION	COUNTY	TOTAL SHEETS	SHEET NO.
757	(20)BDR, BJR	SCOTT-PIKE	18	10
CONTRACT NO. 72K44			ILLINOIS FED. AID PROJECT	

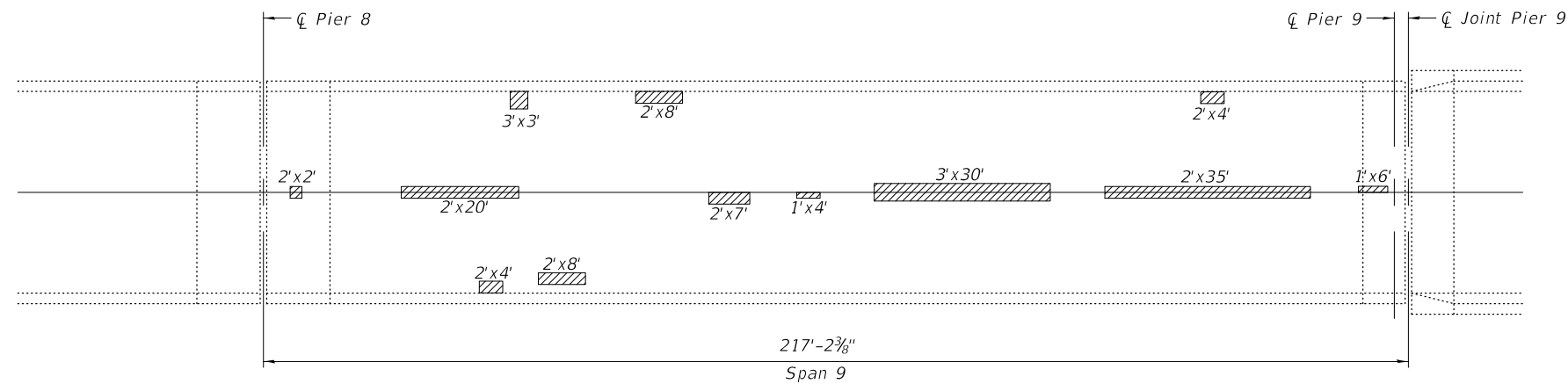
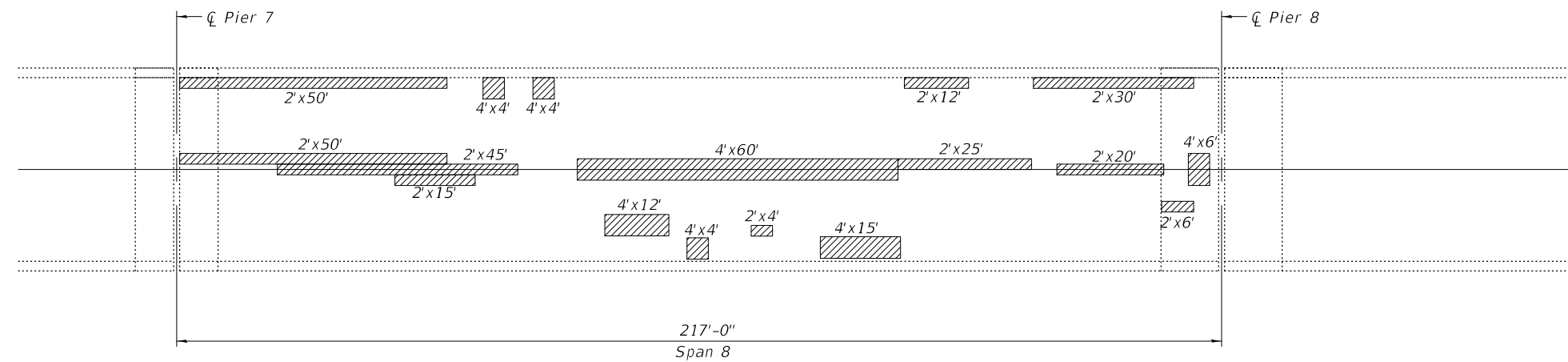

Hatched areas indicate  
Deck Slab Repair (Partial Depth)

**TOTAL BILL OF MATERIAL**

ITEM	UNIT	Span 8	Span 9
Deck Slab Repair (Partial Depth)	Sq. Yd.	104	32

DESIGNED VHV	EXAMINED	DATE - OCTOBER 1, 2019
CHECKED DAB	<i>Timothy A. Daulton</i> ENGINEER OF STRUCTURAL SERVICES	REVISED -
DRAWN baliva	PASSED	REVISED -
CHECKED VHV DAB	<i>Carl R. Meyer</i> ENGINEER OF BRIDGES AND STRUCTURES	

**STATE OF ILLINOIS  
DEPARTMENT OF TRANSPORTATION**

**SPANS 8 & 9 DECK PATCHING DETAILS  
SN 086-0001**

SHEET NO. 5 OF 12 SHEETS

F.A.P. RTE.	SECTION	COUNTY	TOTAL SHEETS	SHEET NO.
757	(20)BDR, BJR	SCOTT-PIKE	18	11
ILLINOIS FED. AID PROJECT			CONTRACT NO. 72K44	



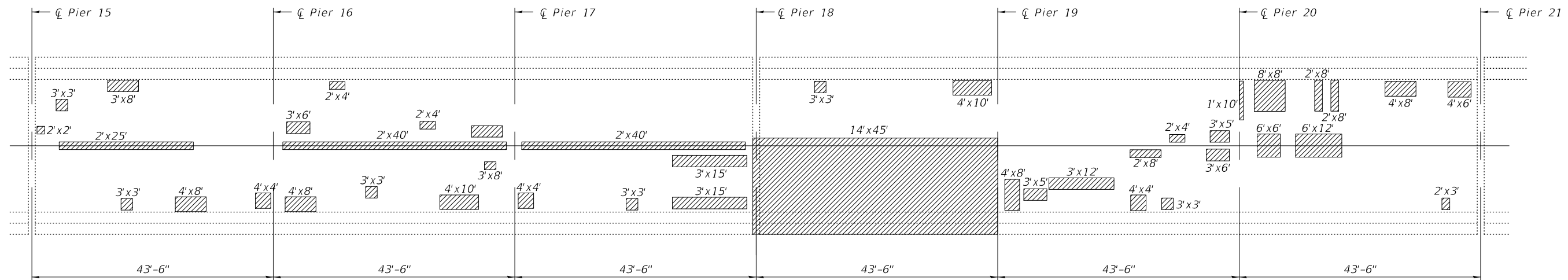

PARTIAL DEPTH PATCHING

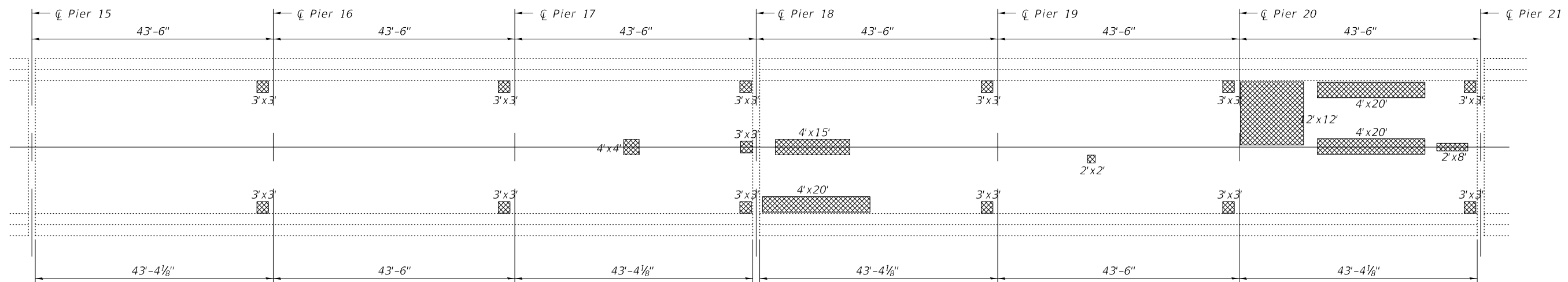

FULL DEPTH PATCHING



BILL OF MATERIAL

ITEM	UNIT	Span 16	Span 17	Span 18	Span 19	Span 20	Span 21
* Deck Slab Repair (Partial Depth)	Sq. Yd.	16	25	22	76	19	36
Deck Slab Repair (Full Depth Type II)	Sq. Yd.	2	2	5	18	3	38

\* Quantities shown are for information only

Hatched areas indicate Deck Slab Repair (Partial Depth).  
 Cross hatched areas indicate Deck Slab Repair (Full Depth Type II).  
 Size of full depth patches is estimated. Actual size and location to be determined by the Engineer in the field

DESIGNED VHV  
 CHECKED DAB  
 DRAWN baliva  
 CHECKED VHV DAB

EXAMINED  
 PASSED  
  
 ENGINEER OF STRUCTURAL SERVICES  
  
 ENGINEER OF BRIDGES AND STRUCTURES

DATE - OCTOBER 1, 2019  
 REVISED -  
 REVISED -

STATE OF ILLINOIS  
 DEPARTMENT OF TRANSPORTATION

SPANS 16 THRU 21 DECK PATCHING DETAILS  
 SN 086-0001

SHEET NO. 7 OF 12 SHEETS

F.A.P. RTE.	SECTION	COUNTY	TOTAL SHEETS	SHEET NO.
757	(20)BDR, BJR	SCOTT-PIKE	18	13
ILLINOIS FED. AID PROJECT			CONTRACT NO. 72K44	



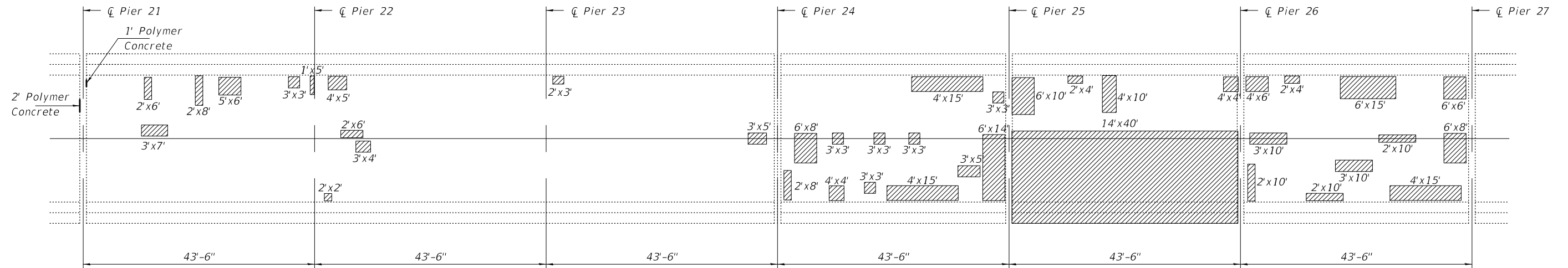

PARTIAL DEPTH PATCHING

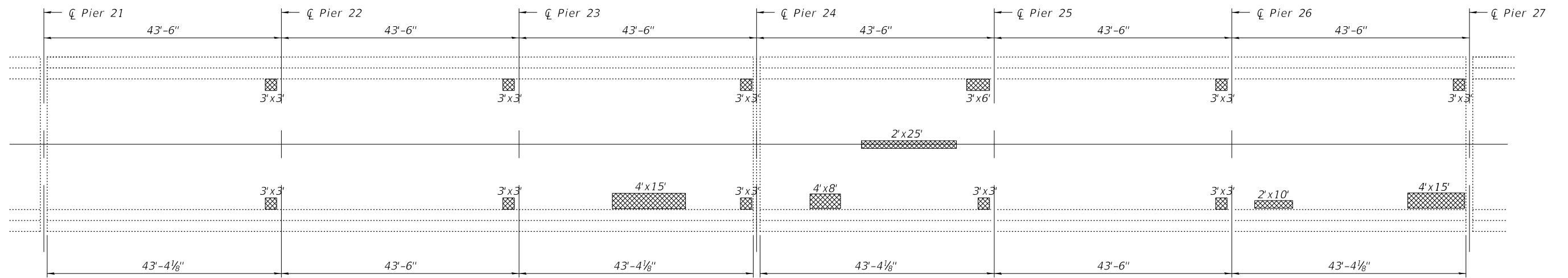

FULL DEPTH PATCHING

BILL OF MATERIAL

ITEM	UNIT	Span 22	Span 23	Span 24	Span 25	Span 26	Span 27
* Deck Slab Repair (Partial Depth)	Sq. Yd.	11	6	3	38	76	43
Deck Slab Repair (Full Depth Type II)	Sq. Yd.	2	2	2	10	11	10

\* Quantities shown are for information only

Hatched areas indicate Deck Slab Repair (Partial Depth).  
 Cross hatched areas indicate Deck Slab Repair (Full Depth Type II).  
 Size of full depth patches is estimated. Actual size and location to be determined by the Engineer in the field

DESIGNED VHV	EXAMINED	DATE - OCTOBER 1, 2019
CHECKED DAB	<i>Timothy A. Doolittle</i> ENGINEER OF STRUCTURAL SERVICES	REVISED -
DRAWN baliva	PASSED	REVISED -
CHECKED VHV DAB	<i>Carl Ringer</i> ENGINEER OF BRIDGES AND STRUCTURES	

STATE OF ILLINOIS  
 DEPARTMENT OF TRANSPORTATION

SPANS 22 THRU 27 DECK PATCHING DETAILS  
 SN 086-0001

SHEET NO. 8 OF 12 SHEETS

F.A.P. RTE.	SECTION	COUNTY	TOTAL SHEETS	SHEET NO.
757	(20)BDR, BJR	SCOTT-PIKE	18	14
CONTRACT NO. 72K44			ILLINOIS FED. AID PROJECT	

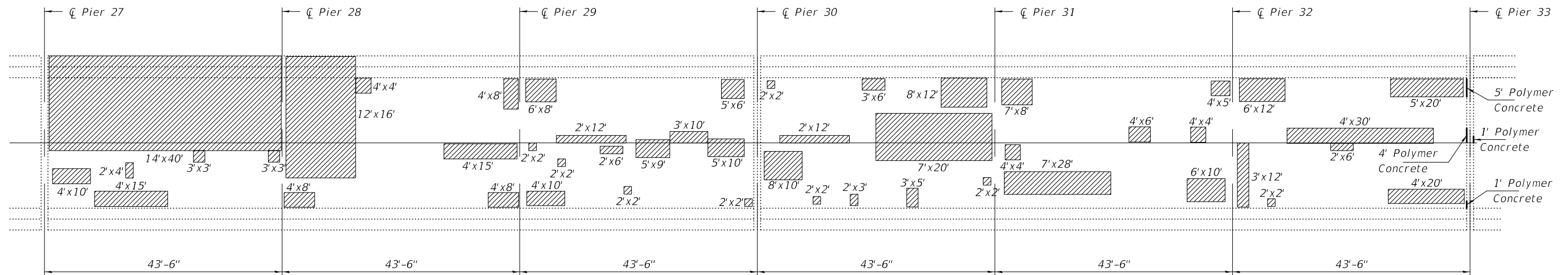

PARTIAL DEPTH PATCHING

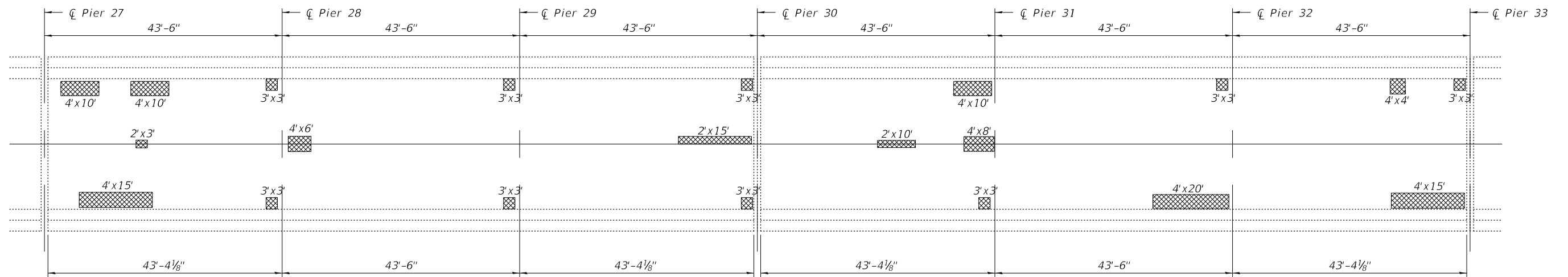
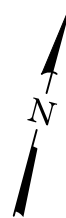

FULL DEPTH PATCHING

BILL OF MATERIAL

ITEM	UNIT	Span 28	Span 29	Span 30	Span 31	Span 32	Span 33
* Deck Slab Repair (Partial Depth)	Sq. Yd.	76	41	33	44	40	47
Deck Slab Repair (Full Depth Type II)	Sq. Yd.	18	5	6	13	10	10

\* Quantities shown are for information only

Hatched areas indicate Deck Slab Repair (Partial Depth).  
 Cross hatched areas indicate Deck Slab Repair (Full Depth Type II).  
 Size of full depth patches is estimated. Actual size and location to be determined by the Engineer in the field

DESIGNED VHV	EXAMINED	DATE - OCTOBER 1, 2019
CHECKED DAB	<i>Timothy A. Daulton</i> ENGINEER OF STRUCTURAL SERVICES	REVISED -
DRAWN baliva	PASSED	REVISED -
CHECKED VHV DAB	<i>Carl R. Meyer</i> ENGINEER OF BRIDGES AND STRUCTURES	

STATE OF ILLINOIS  
 DEPARTMENT OF TRANSPORTATION

SPANS 28 THRU 33 DECK PATCHING DETAILS  
 SN 086-0001

SHEET NO. 9 OF 12 SHEETS

F.A.P. RTE.	SECTION	COUNTY	TOTAL SHEETS	SHEET NO.
757	(20)BDR, BJR	SCOTT-PIKE	18	15
CONTRACT NO. 72K44			ILLINOIS FED. AID PROJECT	



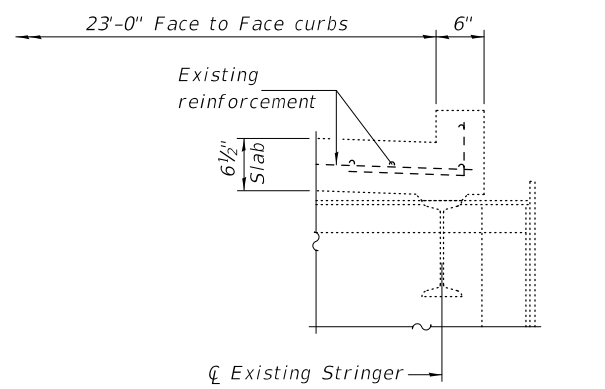

**SECTION THRU DECK**  
(Typical at Spans 1, 2 & 7 thru 9)

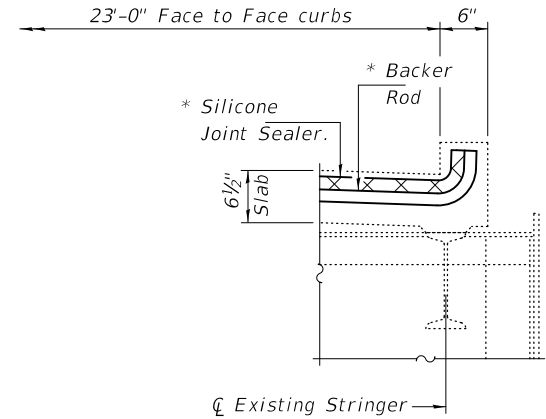

**END OF SEAL TREATMENT**  
(Typical at Spans 1, 2 & 7 thru 9)

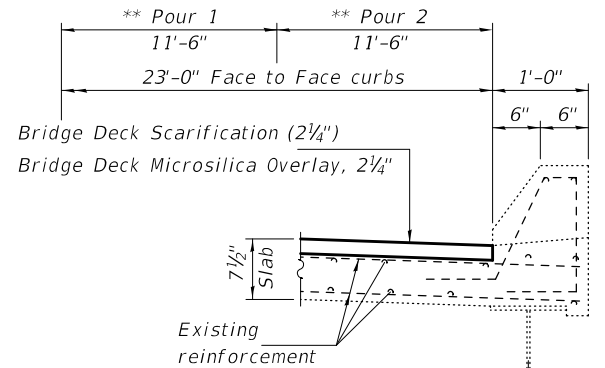

**SECTION THRU DECK**  
(Typical at Spans 10 thru 38)

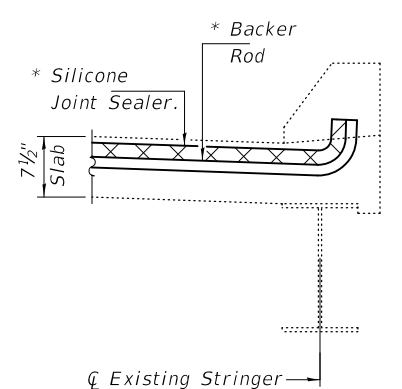

**END OF SEAL TREATMENT**  
(Typical at Spans 10 thru 38)

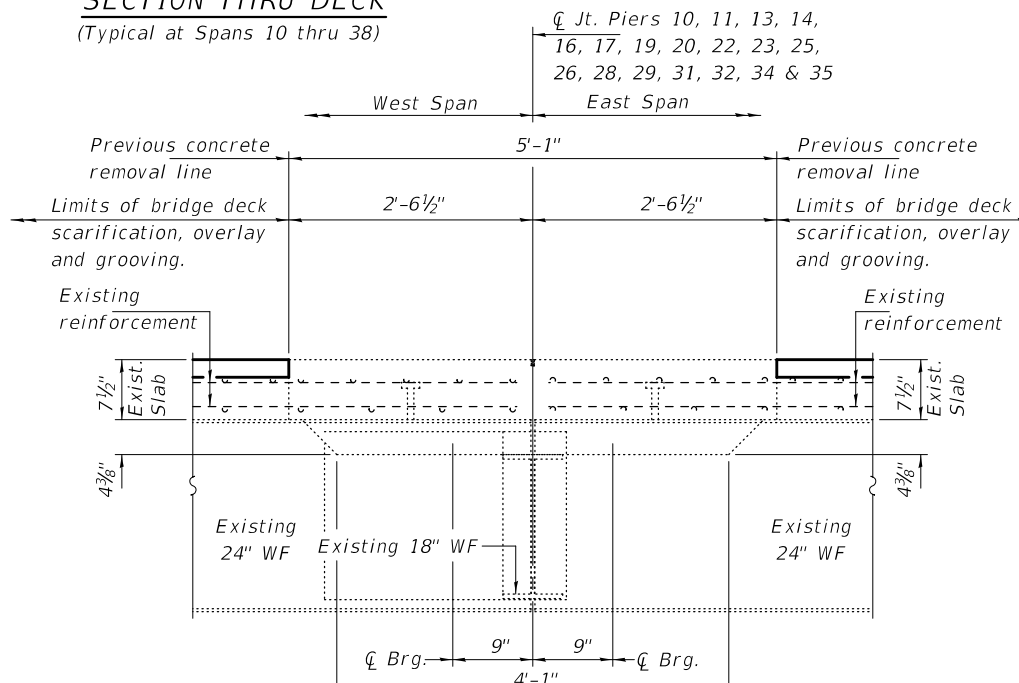

**SECTION THRU PIERS**  
10, 11, 13, 14, 16, 17, 19, 20, 22,  
23, 25, 26, 28, 29, 31, 32, 34 & 35

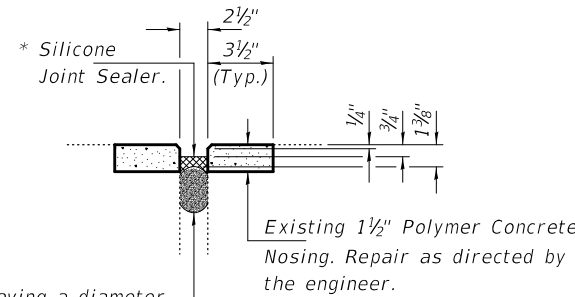

**SECTION AT SEALER**

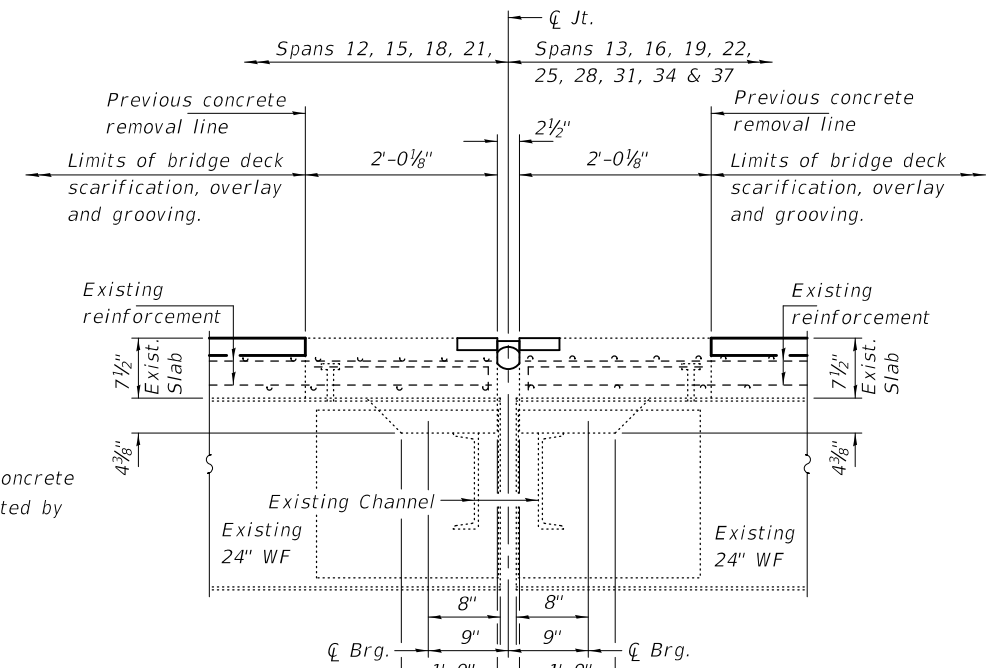

**SECTION THRU PIERS**  
12, 15, 18, 21,  
24, 27, 30, 33 & 36

Backer rod having a diameter 25% greater than joint opening at the time of installation.

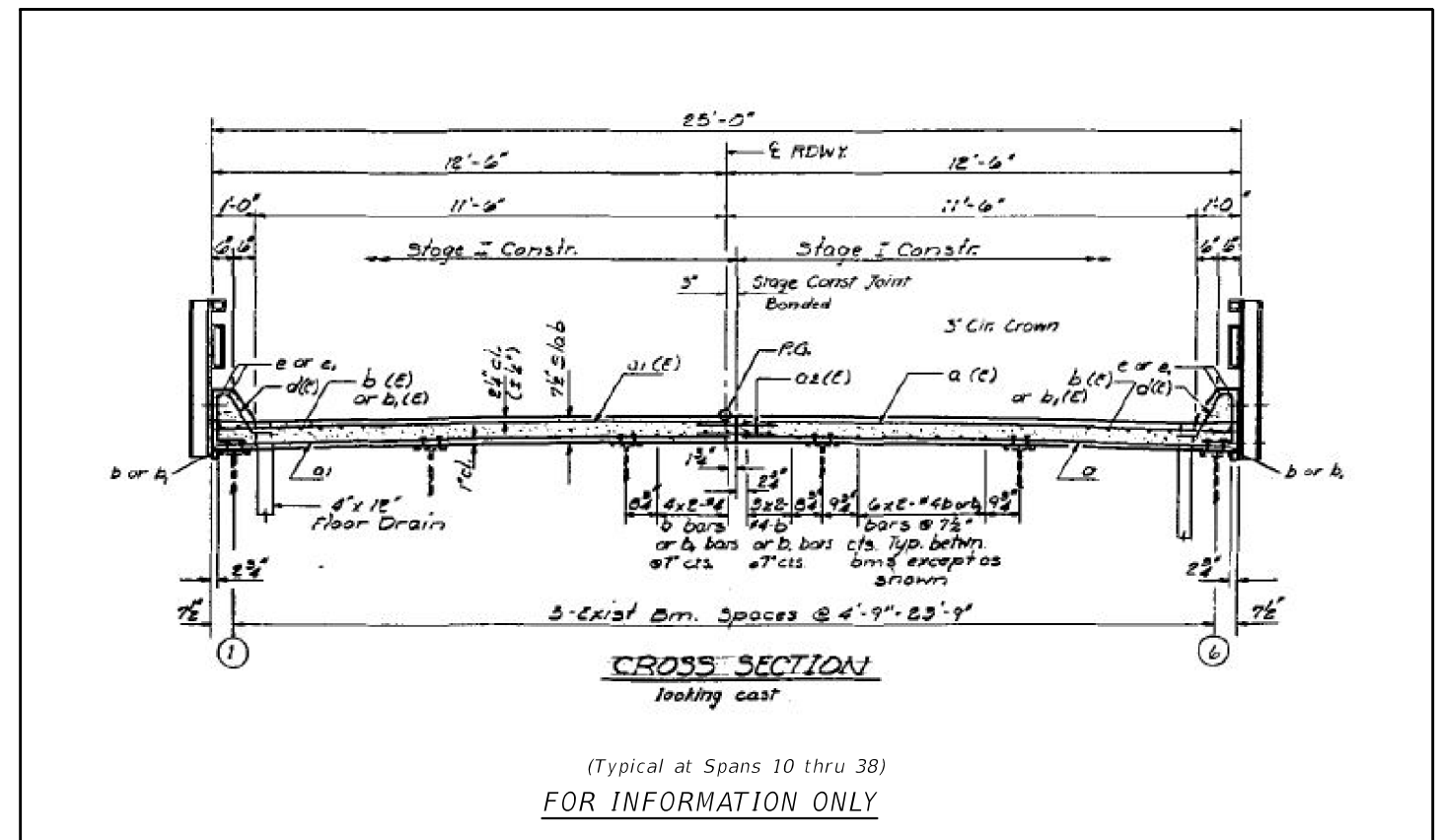

**CROSS SECTION**  
looking east

(Typical at Spans 10 thru 38)  
**FOR INFORMATION ONLY**

**BILL OF MATERIAL**

ITEM	UNIT	TOTAL
Silicone Joint Sealer	Foot	322
Polymer Concrete	Cu. Ft.	1.2
Bridge Deck Scarification (2 1/4")	Sq. Yd.	2830
Bridge Deck Microsilica Overlay, 2 1/4"	Sq. Yd.	2830
Bridge Deck Grooving	Sq. Yd.	2590

DESIGNED VHV  
CHECKED DAB  
DRAWN baliva  
CHECKED VHV DAB

EXAMINED  
PASSED  
Timothy A. Daulton  
ENGINEER OF STRUCTURAL SERVICES  
Carl R. Ringer  
ENGINEER OF BRIDGES AND STRUCTURES

DATE - OCTOBER 1, 2019  
REVISED -  
REVISED -

**STATE OF ILLINOIS**  
**DEPARTMENT OF TRANSPORTATION**

**REPAIR DETAILS**  
**SN 086-0001**

SHEET NO. 11 OF 12 SHEETS

F.A.P. RTE.	SECTION	COUNTY	TOTAL SHEETS	SHEET NO.
757	(20)BDR, BJR	SCOTT-PIKE	18	17
CONTRACT NO. 72K44				

ILLINOIS FED. AID PROJECT

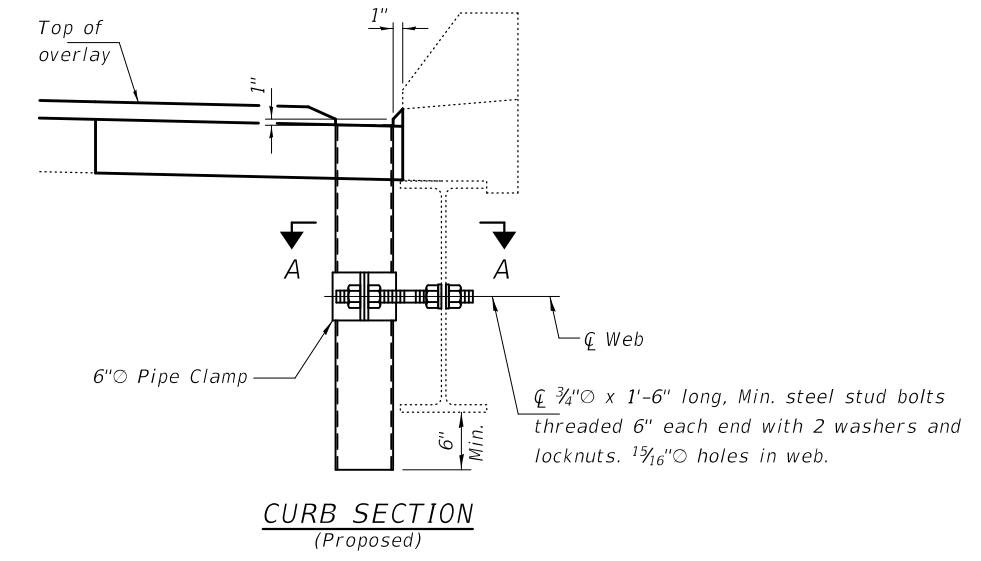
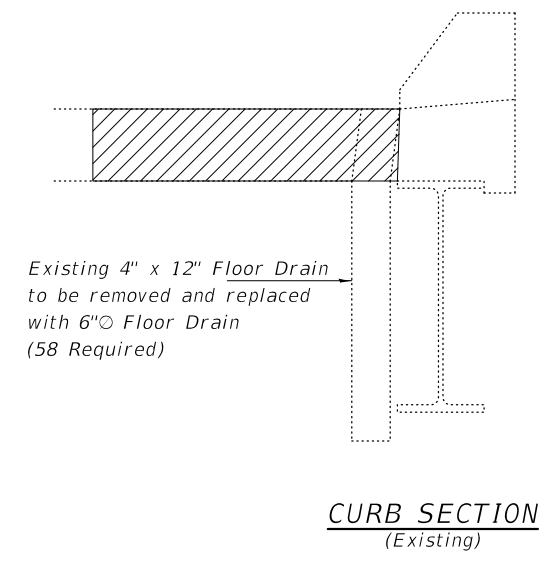
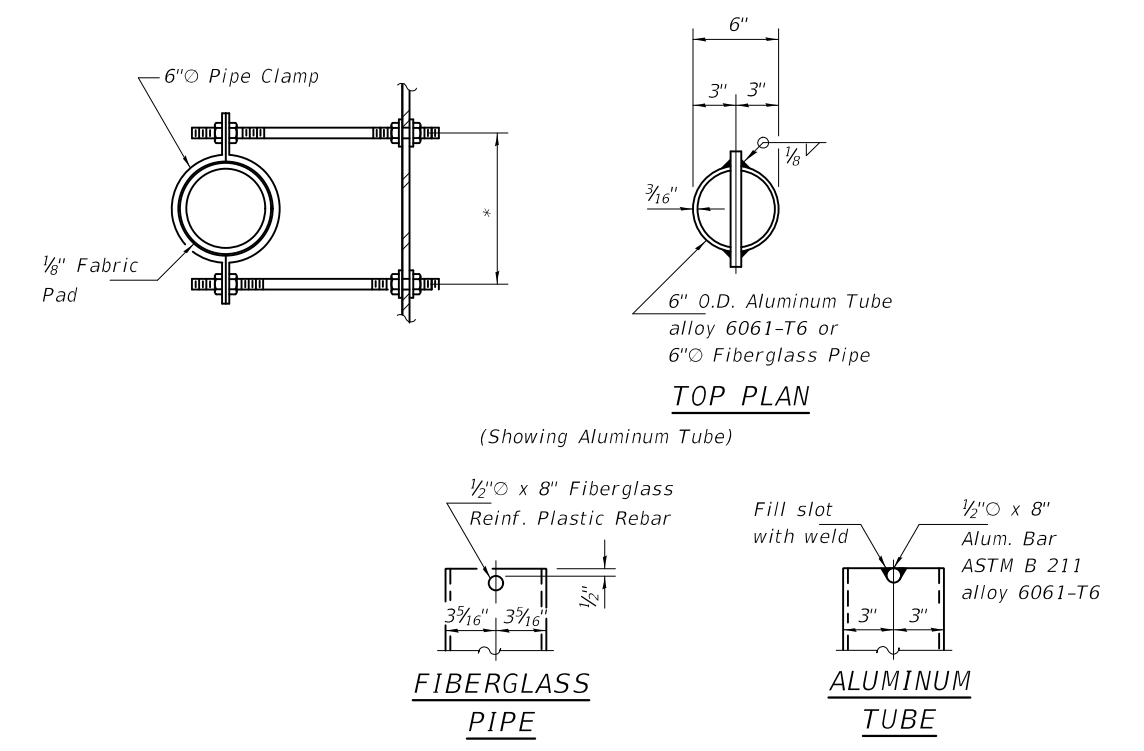
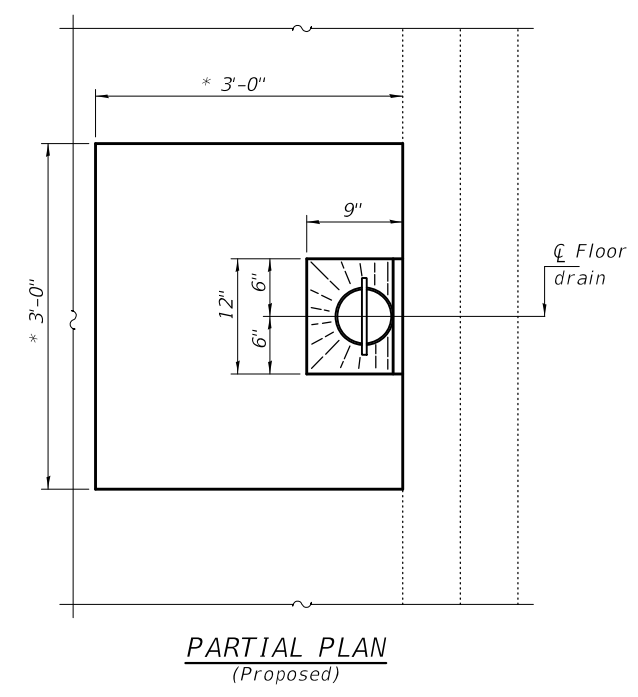
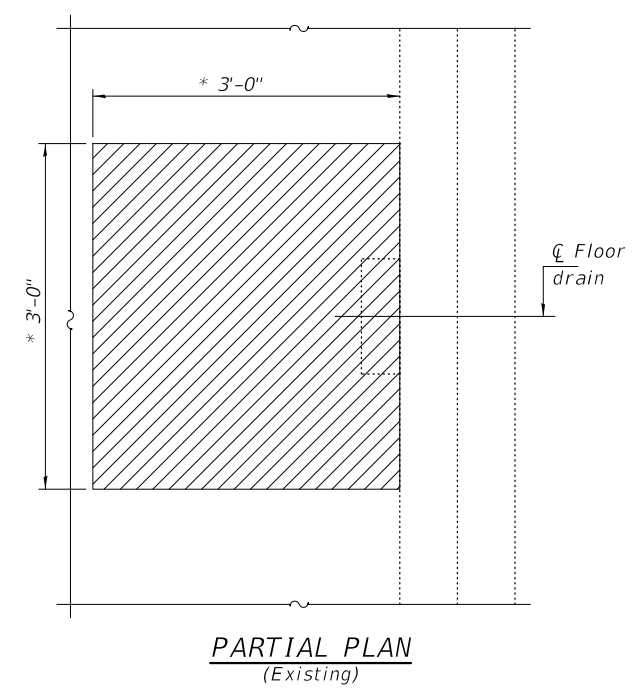
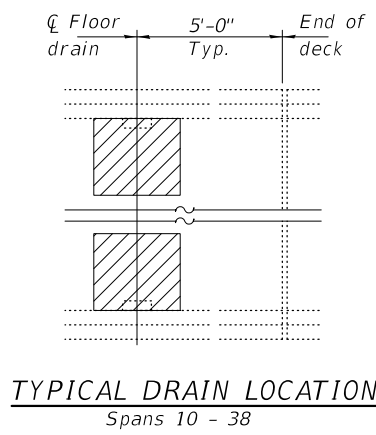

Hatched areas indicate Deck Slab Repair (Full Depth, Type II).  
Cost of removal and replacement of concrete included with Deck Slab Repair (Full Depth, Type II).

\* Size of full depth patches is estimated.  
Actual size and location to be determined by the Engineer in the field.

Drains shall be located clear of all diaphragms.  
The exterior surfaces of the floor drains shall be painted with the finish coat as specified in the special provisions for Cleaning and Painting New Metal Structures. The exterior surfaces of the drains shall be cleaned according to the Society of Protective Coatings Spec. SSPC-SP1 prior to painting.  
Fiberglass pipe shall conform to ASTM D 2996, with short-time rupture strength hoop tensile stress of 30,000 p.s.i. minimum.  
Galvanize clamping device according to AASHTO M232. Cost of clamping device and inserts is included with Floor Drains.

**BILL OF MATERIAL**

ITEM	UNIT	TOTAL
Floor Drains	Each	58

DESIGNED VHV	EXAMINED	DATE - OCTOBER 1, 2019
CHECKED DAB	<i>Timothy A. Daulton</i> ENGINEER OF STRUCTURAL SERVICES	REVISED -
DRAWN baliva	PASSED <i>Carl Rieger</i> ENGINEER OF BRIDGES AND STRUCTURES	REVISED -
CHECKED VHV DAB		

**STATE OF ILLINOIS**  
**DEPARTMENT OF TRANSPORTATION**

**DRAIN REPLACEMENT DETAILS**  
**SN 086-0001**  
SHEET NO. 12 OF 12 SHEETS

F.A.P. RTE. 757	SECTION (20)BDR, BJR	COUNTY SCOTT-PIKE	TOTAL SHEETS 18	SHEET NO. 18
CONTRACT NO. 72K44			ILLINOIS FED. AID PROJECT	