

**STATE OF ILLINOIS**  
**DEPARTMENT OF TRANSPORTATION**

F.A.S. RTE.	SECTION	COUNTY	TOTAL SHEETS	SHEET NO.
819	(41-4,41-4-1)RS-2	JEFFERSON	27	1
(41-4,41-4-1)RS-2		ILLINOIS	CONTRACT NO. 78A40	

D-99-019-24

FOR INDEX OF SHEETS, SEE SHEET NO. 3

**TRAFFIC DATA**  
**ADT: 3100**  
**% TRUCKS: 1.6**

**TOWNSHIPS**  
**DIX**

# PROPOSED HIGHWAY PLANS

**FAS ROUTE 819 (W SOUTH ST)**  
**SECTION (41-4,41-4-1)RS-2**  
**PROJECT STP-4K0G(534)**  
**RESURFACING / ADA RAMPS**  
**JEFFERSON COUNTY**

C-99-047-24

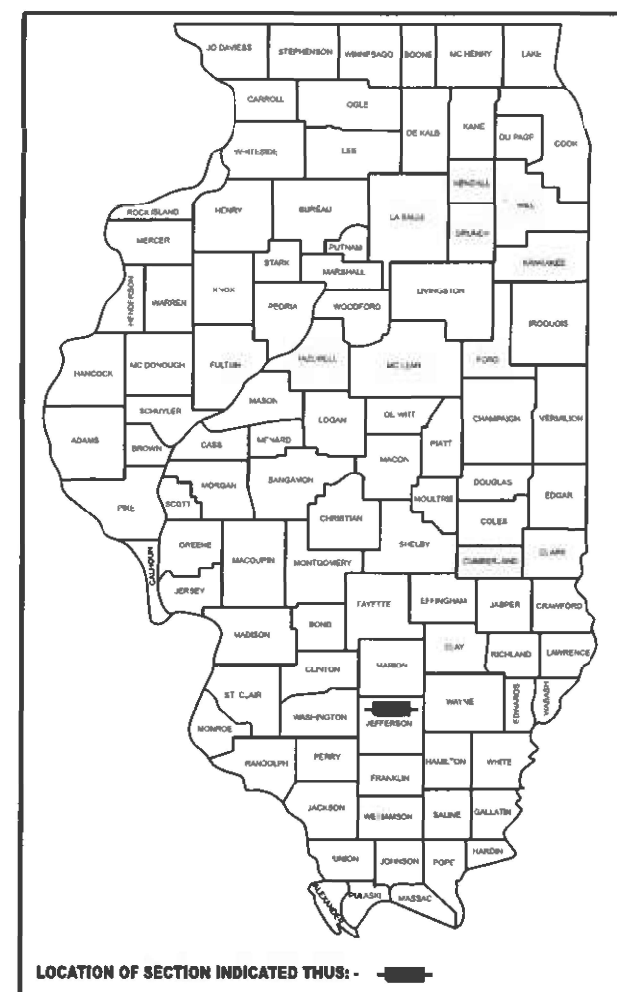

**COORDINATE SYSTEM : EPSG: 102671**  
**NAD 1983 STATEPLANE**  
**ILLINOIS EAST FIPS 1201**

**POSTED SPEED : 40 MPH**  
**45 MPH**

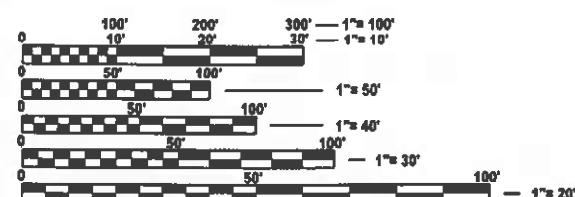

FULL SIZE PLANS HAVE BEEN PREPARED USING STANDARD ENGINEERING SCALES. REDUCED SIZED PLANS WILL NOT CONFORM TO STANDARD SCALES. IN MAKING MEASUREMENTS ON REDUCED PLANS, THE ABOVE SCALES MAY BE USED.

**J.U.L.I.E.**  
**JOINT UTILITY LOCATION INFORMATION FOR EXCAVATION**  
**1-800-892-0123**  
**OR 811**

**PROJECT ENGINEER MARCO ANDRESEN**  
**PROJECT MANAGER SEAN GREENLEE**

CONTRACT NO. 78A40

**PROJECT STARTS:**  
**STA 46+02**

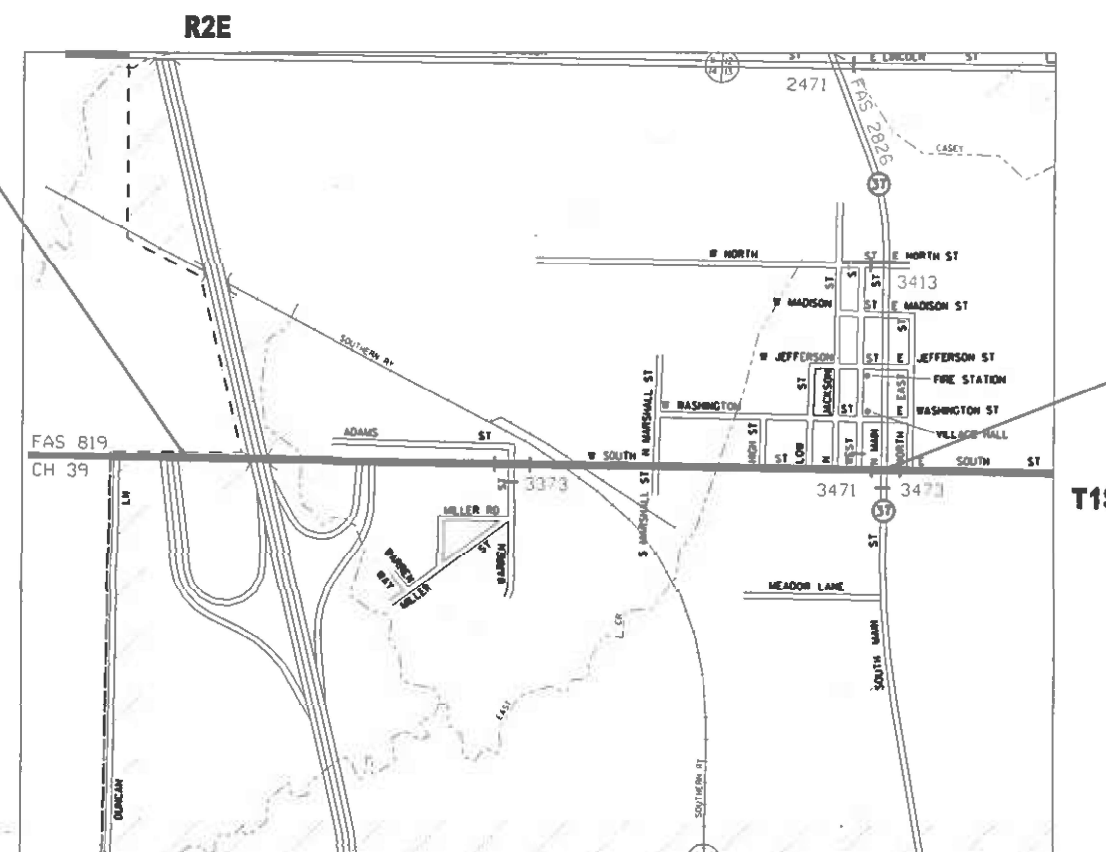

**PROJECT ENDS:**  
**STA 92+53**

GROSS LENGTH = 4651 FT. = 0.88 MILE  
NET LENGTH = 4286 FT. = 0.81 MILE

**OMISSIONS:**  
**STA 56+20 to 59+50 (PCC)**  
**STA 71+15 to 71+50 (RAILROAD)**

**STATE OF ILLINOIS**  
**DEPARTMENT OF TRANSPORTATION**

SUBMITTED August 9, 2024  
Kirk H. Brown  
REGIONAL ENGINEER

October 4, 2024  
[Signature]  
ENGINEER OF DESIGN AND ENVIRONMENT

October 4, 2024  
[Signature]  
DIRECTOR OF HIGHWAYS PROJECT IMPLEMENTATION

**PRINTED BY THE AUTHORITY**  
**OF THE STATE OF ILLINOIS**

MODEL: 02-Signature [Sheet]  
FILE NAME: c:\pwworkspace\illinois.gov\marco.andresen\gll\081409110578410-ShA-Cover-Sig.dgn

USER NAME	= marco.andresen	DESIGNED	-	REVISED	-
		DRAWN	-	REVISED	-
		CHECKED	-	REVISED	-
PLOT DATE	= 7/26/2024	DATE	-	REVISED	-

STATE OF ILLINOIS  
DEPARTMENT OF TRANSPORTATION

SIGNATURE SHEET

SCALE: SHEET 2 OF 27 SHEETS STA. TO STA.

F.A.S. RTE.	SECTION	COUNTY	TOTAL SHEETS	SHEET NO.
819	(41-4,41-4-1)RS-2	JEFFERSON	27	2
CONTRACT NO. 78A40				
ILLINOIS FED. AID PROJECT				

(41-4,41-4-1)RS-2

Prepared By: Susan Fu  
DISTRICT STUDIES & PLANS ENGINEER

Examined By: Nancy Hee  
DISTRICT LAND ACQUISITION ENGINEER

Examined By: Car Mh  
DISTRICT PROGRAM DEVELOPMENT ENGINEER

Examined By: R C  
DISTRICT OPERATIONS ENGINEER

Examined By: Daryl T. Welch  
DISTRICT PROJECT IMPLEMENTATION ENGINEER

Examined By: Brian Will  
DISTRICT CONSTRUCTION ENGINEER

Examined By: Aan Hany  
DISTRICT MATERIALS ENGINEER

INDEX OF SHEETS

SHEET NO	DESCRIPTION
1	COVER SHEET
2	SIGNATURE SHEET
3	INDEX OF SHEETS, HIGHWAY STANDARDS, GENERAL NOTES, COMMITMENTS
4	MIX DESIGN
5-8	SUMMARY OF QUANTITIES
9-11	TYPICAL SECTIONS: W SOUTH ST
12-17	SCHEDULES
18-19	GEOPAK ELEMENTS
20	TIE POINTS
21-24	ADA Ramps
25	DETAILS:SIDEROAD
26	DETAILS: HMA TRANSITIONS
27	DETAILS:UNEVEN LANES, ROUGH GROOVED SURFACE, TEMP. HMA TRANSITIONS, PEDESTRIAN CROSSING PAVEMENT MARKING

GENERAL NOTES

FACTORS USED FOR ESTIMATING PLAN QUANTITIES ARE AS FOLLOWS AND SHALL NOT BE USED FOR THE BASIS OF FINAL QUANTITIES:

ALL HOT MIX ASPHALT 2.016 TONS/CU. YD.

ALL AGGREGATE 2.05 TONS/CU. YD.

THE QUANTITY OF SHORT TERM PAVEMENT MARKING SHOWN IN THE PLANS IS BASED ON ONE APPLICATION EACH FOR THE HMA SURFACE REMOVAL, BINDER COURSE, AND SURFACE COURSE

HMA RESURFACING SHALL BE PLACED IN A SEQUENCE THAT WILL MINIMIZE THE TIME THE CENTERLINE EDGE IS EXPOSED TO TRAFFIC. WHEN AT THE END OF A DAY'S OPERATION THE EXPOSED CENTERLINE EDGE IS GREATER THAN 2,000 FT, THE CONTRACTOR SHALL BE REQUIRED TO PAVE IN THE ADJACENT LANE ON THE FOLLOWING WORK DAY. PRIOR TO WINTER SHUTDOWN, RESURFACING ON ADJACENT LANES IS TO BE BROUGHT UP TO THE SAME ELEVATION.

LONGITUDINAL JOINT SEALANT SHALL BE PLACED UNDER THE HMA SURFACE COURSE

VIBRATORY ROLLERS WILL NOT BE ALLOWED WITHIN THE CORPORATE LIMITS OF DIX BETWEEN IL37 AND NSRR RAILROAD CROSSING BUT ARE ALLOWED BETWEEN NSRR RAILROAD CROSSING AND I-57.

INCIDENTAL HOT-MIX ASPHALT SURFACING SHALL BE PAVED IN A SEPARATE OPERATION FROM THE MAINLINE PAVEMENT

COMMITMENTS: NONE

HIGHWAY STANDARDS

000001-08 STANDARD SYMBOLS, ABBREVIATIONS AND PATTERNS

001006 DECIMAL OF AN INCH AND OF A FOOT

424001-11 PERPENDICULAR CURB RAMPS FOR SIDEWALKS

424011-04 CORNER PARALLEL CURB RAMPS FOR SIDEWALKS

424021-06 DEPRESSED CORNER FOR SIDEWALKS

442201-03 CLASS C & D PATCHES

606001-08 CONCRETE CURB TYPE B & COMBINATION CONCRETE CURB & GUTTER

701001-02 OFF-ROAD OPERATIONS, 2L, 2W, MORE THAN 15 FT AWAY

701006-05 OFF-ROADOPERATIONS, 2L, 2W, 15 FT TO 24 IN FROM PAVEMENT EDGE

701011-04 OFF-ROAD MOVING OPERATIONS, 2L, 2W, DAY ONLY

701201-05 LANE CLOSURE, 2L, 2W, DAY ONLY, FOR SPEEDS 45 MPH OR MORE

701301-04 LANE CLOSURE, 2L, 2W, SHORT TIME OPERATIONS

701306-04 LANE CLOSURE, 2L, 2W, SLOW MOVING OPERATIONS DAY ONLY, FOR SPEEDS 45 MPH OR MORE

701311-03 LANE CLOSURE, 2L, 2W, MOVING OPERATIONS - DAY ONLY

701336-07 LANE CLOSURE, 2L, 2W, WORK AREAS IN SERIES, FOR SPEEDS 45MPH OR MORE

701501-06 URBAN LANE CLOSURE, 2L, 2W, UNDIVIDED

701801-06 SIDEWALK, CORNER OR CROSSWALK CLOSURE

701901-09 TRAFFIC CONTROL DEVICES

780001-05 TYPICAL PAVEMENT MARKINGS

781001-04 TYPICAL APPLICATIONS RAISED REFLECTIVE PAVEMENT MARKERS

420001-10 PAVEMENT JOINTS

REV - MS

MODEL: Gen Note [Sheet]  
FILE NAME: c:\paw\work\paw\illinois\gov\40574091\0878A40-SHB-Index\_GenNotes.dgn

	USER NAME = marco.andresen	DESIGNED -	REVISED -	STATE OF ILLINOIS DEPARTMENT OF TRANSPORTATION	INDEX OF SHEETS GENERAL NOTES AND HIGHWAY STANDARDS		F.A.S RTE.	SECTION	COUNTY	TOTAL SHEETS	SHEET NO.
		DRAWN -	REVISED -				819	(41-4,41-4-1)RS-2	JEFFERSON	27	3
		CHECKED -	REVISED -				CONTRACT NO. 78A40				
	PLOT DATE = 8/6/2024	DATE -	REVISED -		SCALE:	SHEET 3 OF 27 SHEETS	STA.	TO STA.	ILLINOIS   FED. AID PROJECT		

(41-4,41-4-1)RS-2

# HMA MIXTURE REQUIREMENTS TABLES

The following HMA mixture requirements are applicable for this project

Locations	Hot-Mix Asphalt Surface Course, and Incidental HMA Surfacing
Mixture Use(s):	Hot-Mix Asphalt Surface Course, Mix D, N70
AB/PG:	PG64-22
ABR % (Max):	See Special Provision
Design Air Voids:	4.0%, 70 Gyraton Design
Mixture Composition: (Gradation Mixture)	IL-9.5mm
Friction Aggregate:	MIX D
Mixture Weight:	112 lbs/Sq Yd/in
Quality Management Program:	QCP
Sublot Size:	1000 tons
Material Transfer Device (Required?)	Yes

Locations	Hot-Mix Asphalt Binder Course, and Class D Patching
Mixture Use(s):	Hot-Mix Asphalt Binder Course, IL-19.0, N70
AB/PG:	PG64-22
ABR % (Max):	See Special Provision
Design Air Voids:	4.0 %, 70 Gyraton Design
Mixture Composition: (Gradation Mixture)	IL-19.0
Friction Aggregate:	None
Mixture Weight:	112 lbs/Sq Yd/in
Quality Management Program:	QCP
Sublot Size:	3000 tons
Material Transfer Device (Required?)	Yes

Locations	Hot-Mix Asphalt Shoulders
Mixture Use(s):	Hot-Mix Asphalt Surface Course, Mix C, N30
AB/PG:	PG64-22
ABR % (Max):	See Special Provision
Design Air Voids:	4.0 %, 30 Gyraton Design
Mixture Composition: (Gradation Mixture)	IL-9.5L
Friction Aggregate:	None
Mixture Weight:	112 lbs/Sq Yd/in
Quality Management Program:	QC/QA
Sublot Size:	3000 tons
Material Transfer Device (Required?)	No

MODEL: Mix design [Sheet]  
FILE NAME: c:\pwworking\illinois.gov\marco.andresen\0074091\0978440-SHB-Index\_GenNotes.dgn

	USER NAME = marco.andresen	DESIGNED -	REVISED -	STATE OF ILLINOIS DEPARTMENT OF TRANSPORTATION	MIX DESIGN			F.A.S RTE.	SECTION	COUNTY	TOTAL SHEETS	SHEET NO.
		DRAWN -	REVISED -					819	(41-4,41-4-1)RS-2	JEFFERSON	27	4
		CHECKED -	REVISED -					CONTRACT NO. 78A40				
	PLOT DATE = 7/26/2024	DATE -	REVISED -		SCALE:	SHEET 4	OF 27	SHEETS	STA	TO STA.	ILLINOIS   FED. AID PROJECT	



SUMMARY OF QUANTITIES

COUNTY:	JEFFERSON CO
ROUTE:	FAS819(W SOUTH ST)
FUNDING:	80% FEDERAL 20% STATE
LOCATION:	RURAL
TOTAL QUANTITY	ROADWAY
	0005

CODE NUMBER	ITEM DESCRIPTION	UNIT	TOTAL QUANTITY	
40600290	BITUMINOUS MATERIALS (TACK COAT)	POUND	10,454	10,454
40600370	LONGITUDINAL JOINT SEALANT	FOOT	3,245	3,245
40600982	HOT-MIX ASPHALT SURFACE REMOVAL - BUTT JOINT	SQ YD	342	342
40600990	TEMPORARY RAMP	SQ YD	790	790
40603085	HOT-MIX ASPHALT BINDER COURSE, IL-19.0, N70	TON	1,557	1,557
40604062	HOT-MIX ASPHALT SURFACE COURSE, IL-9.5, MIX "D", N70	TON	1,038	1,038
40800050	INCIDENTAL HOT-MIX ASPHALT SURFACING	TON	76	76
42001300	PROTECTIVE COAT	SQ YD	60	60
42400800	DETECTABLE WARNINGS	SQ FT	66	66
44000155	HOT-MIX ASPHALT SURFACE REMOVAL, 1 1/2"	SQ YD	8,810	8,810
44000164	HOT-MIX ASPHALT SURFACE REMOVAL, 3 3/4"	SQ YD	7,208	7,208
44000500	COMBINATION CURB AND GUTTER REMOVAL	FOOT	257	257
44000600	SIDEWALK REMOVAL	SQ FT	546	546

MODEL: SoQ [Sheet]  
FILE NAME: c:\p\work\pwr\illinois.gov\_marco.andresen@illinois.gov\097409\1D978A40-SHC-SoQ.dgn

USER NAME = marco.andresen	DESIGNED -	REVISED -	STATE OF ILLINOIS DEPARTMENT OF TRANSPORTATION	SUMMARY OF QUANTITIES			F.A.S RTE.	SECTION	COUNTY	TOTAL SHEETS	SHEET NO.
	DRAWN -	REVISED -					819	(41-4,41-4-1)RS-2	JEFFERSON	27	5
	CHECKED -	REVISED -					CONTRACT NO. 78A40				
	DATE -	REVISED -					ILLINOIS FED. AID PROJECT				
PLOT DATE = 8/14/2024				SCALE:	SHEET 5	OF 27 SHEETS	STA.	TO STA.	(41-4,41-4-1)RS-2		

SUMMARY OF QUANTITIES - CONT

CODE NUMBER	ITEM DESCRIPTION	UNIT	COUNTY:	JEFFERSON CO
			ROUTE:	FAS819(W SOUTH ST)
			FUNDING:	80% FEDERAL 20% STATE
			LOCATION:	RURAL
			TOTAL QUANTITY	ROADWAY
				0005
44201353	CLASS C PATCHES, TYPE II, 10 INCH	SQ YD	10	10
44201357	CLASS C PATCHES, TYPE III, 10 INCH	SQ YD	63	63
44201359	CLASS C PATCHES, TYPE IV, 10 INCH	SQ YD	30	30
44201815	CLASS D PATCHES, TYPE II, 14 INCH	SQ YD	6	6
44201847	CLASS D PATCHES, TYPE I, 17 INCH	SQ YD	7	7
44201851	CLASS D PATCHES, TYPE II, 17 INCH	SQ YD	15	15
48102100	AGGREGATE WEDGE SHOULDER, TYPE B	TON	53	53
48203100	HOT-MIX ASPHALT SHOULDERS	TON	345	345
60255500	MANHOLES TO BE ADJUSTED	EACH	5	5
60603500	COMBINATION CONCRETE CURB AND GUTTER, TYPE B-6.06	FOOT	257	257
67100100	MOBILIZATION	L SUM	1	1
70100450	TRAFFIC CONTROL AND PROTECTION, STANDARD 701201	L SUM	1	1
70100460	TRAFFIC CONTROL AND PROTECTION, STANDARD 701306	L SUM	1	1

MODEL: SoQ-1 [Sheet]  
FILE NAME: c:\p\work\illinois\gov\_marco.andresen@illinois.gov\097409\10978440-SUM-SoQ.dgn

USER NAME = marco.andresen	DESIGNED -	REVISED -
	DRAWN -	REVISED -
	CHECKED -	REVISED -
PLOT DATE = 8/14/2024	DATE -	REVISED -

STATE OF ILLINOIS  
DEPARTMENT OF TRANSPORTATION

SUMMARY OF  
QUANTITIES

SCALE: SHEET 6 OF 27 SHEETS STA. TO STA.

F.A.S RTE.	SECTION	COUNTY	TOTAL SHEETS	SHEET NO.
819	(41-4,41-4-1)RS-2	JEFFERSON	27	6
CONTRACT NO. 78A40				
ILLINOIS FED. AID PROJECT				

(41-4,41-4-1)RS-2

SUMMARY OF QUANTITIES - CONT

COUNTY:	JEFFERSON CO
ROUTE:	FAS819(W SOUTH ST)
FUNDING:	80% FEDERAL 20% STATE
LOCATION:	RURAL
	ROADWAY
	0005

CODE NUMBER	ITEM DESCRIPTION	UNIT	TOTAL QUANTITY	
70100600	TRAFFIC CONTROL AND PROTECTION, STANDARD 701336	L SUM	1	1
70102620	TRAFFIC CONTROL AND PROTECTION, STANDARD 701501	L SUM	1	1
70102640	TRAFFIC CONTROL AND PROTECTION, STANDARD 701801	L SUM	1	1
70107025	CHANGEABLE MESSAGE SIGN	CAL ■A	28	28
70300100	SHORT TERM PAVEMENT MARKING	FOOT	2912	2912
70300150	SHORT TERM PAVEMENT MARKING REMOVAL	SQ FT	971	971
70300211	TEMPORARY PAVEMENT MARKING LETTERS AND SYMBOLS - PAINT	SQ FT	196	196
70300221	TEMPORARY PAVEMENT MARKING - LINE 4"- PAINT	FOOT	14149	14149
70300241	TEMPORARY PAVEMENT MARKING - LINE 6"- PAINT	FOOT	49	49
70300261	TEMPORARY PAVEMENT MARKING - LINE 12"- PAINT	FOOT	34	34
70300281	TEMPORARY PAVEMENT MARKING - LINE 24"- PAINT	FOOT	108	108
* 78001100	PAINT PAVEMENT MARKING - LETTERS AND SYMBOLS	SQ FT	196	196
* 78001110	PAINT PAVEMENT MARKING - LINE 4"	FOOT	14149	14149
* 78001130	PAINT PAVEMENT MARKING - LINE 6"	FOOT	49	49

\* SPECIALTY ITEM

MODEL: S-Q-2 [Sheet]  
FILE NAME: c:\paw\_work\paw\illinois.gov\marco.andresen@illinois.gov\0974091\0978A40-SHC-S-Q.dgn

USER NAME = marco.andresen	DESIGNED -	REVISED -	STATE OF ILLINOIS DEPARTMENT OF TRANSPORTATION	SUMMARY OF QUANTITIES			F.A.S RTE.	SECTION	COUNTY	TOTAL SHEETS	SHEET NO.
	DRAWN -	REVISED -					819	(41-4,414-1)RS-2	JEFFERSON	27	7
	CHECKED -	REVISED -					CONTRACT NO. 78A40				
PLOT DATE = 8/14/2024	DATE -	REVISED -					ILLINOIS   FED. AID PROJECT				
							(41-4,414-1)RS-2				
				SCALE:	SHEET 7	OF 27 SHEETS	STA	TO STA			

SUMMARY OF QUANTITIES - CONT

COUNTY:	JEFFERSON CO
ROUTE:	FAS819(W SOUTH ST)
FUNDING:	80% FEDERAL 20% STATE
LOCATION:	RURAL
	ROADWAY
	0005

CODE NUMBER	ITEM DESCRIPTION	UNIT	TOTAL QUANTITY	
* 78001150	PAINT PAVEMENT MARKING - LINE 12"	FOOT	34	34
* 78001180	PAINT PAVEMENT MARKING - LINE 24"	FOOT	108	108
* 78100100	RAISED REFLECTIVE PAVEMENT MARKER	EACH	31	31
78300200	RAISED REFLECTIVE PAVEMENT MARKER REMOVAL	EACH	3	3
78300201	PAVEMENT MARKING REMOVAL - GRINDING	SQ FT	5187	5187
X4240430	PORTLAND CEMENT CONCRETE SIDEWALK 5 INCH (SPECIAL)	SQ FT	597	597
X4401198	HOT-MIX ASPHALT SURFACE REMOVAL, VARIABLE DEPTH	SQ YD	738	738
Z0034105	MATERIAL TRANSFER DEVICE	TON	2595	2595
Z0048665	RAILROAD PROTECTIVE LIABILITY INSURANCE	L SUM	1	1

\* SPECIALTY ITEM

MODEL: SoQ-4 [Sheet]  
FILE NAME: c:\paw\work\illinois.gov\_marco.andresen\097408\1D978A40-SoQ.dgn

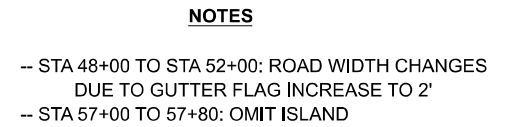

\*MATCH EXISTING SLOPE

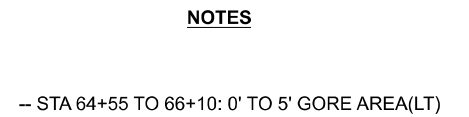

F.A.S RTE.	SECTION	COUNTY	TOTAL SHEETS	SHEET NO.
819	(41-4,41-4-1)RS-2	JEFFERSON	27	9
		CONTRACT NO. 78A40		
		ILLINOIS	FED. AID PROJECT	

MODEL: Typical [Sheet]  
FILE NAME: c:\pw\work\pidot\illinois.gov\_marco.andresen@illinois.gov\0974091D978A40-ShID-Typicals.dgn

MODEL: Typical-1 [Sheet]  
FILE NAME: c:\p\work\illinois.gov\marco.andresen\097409\1D976A40-SHD-Typicals.dgn

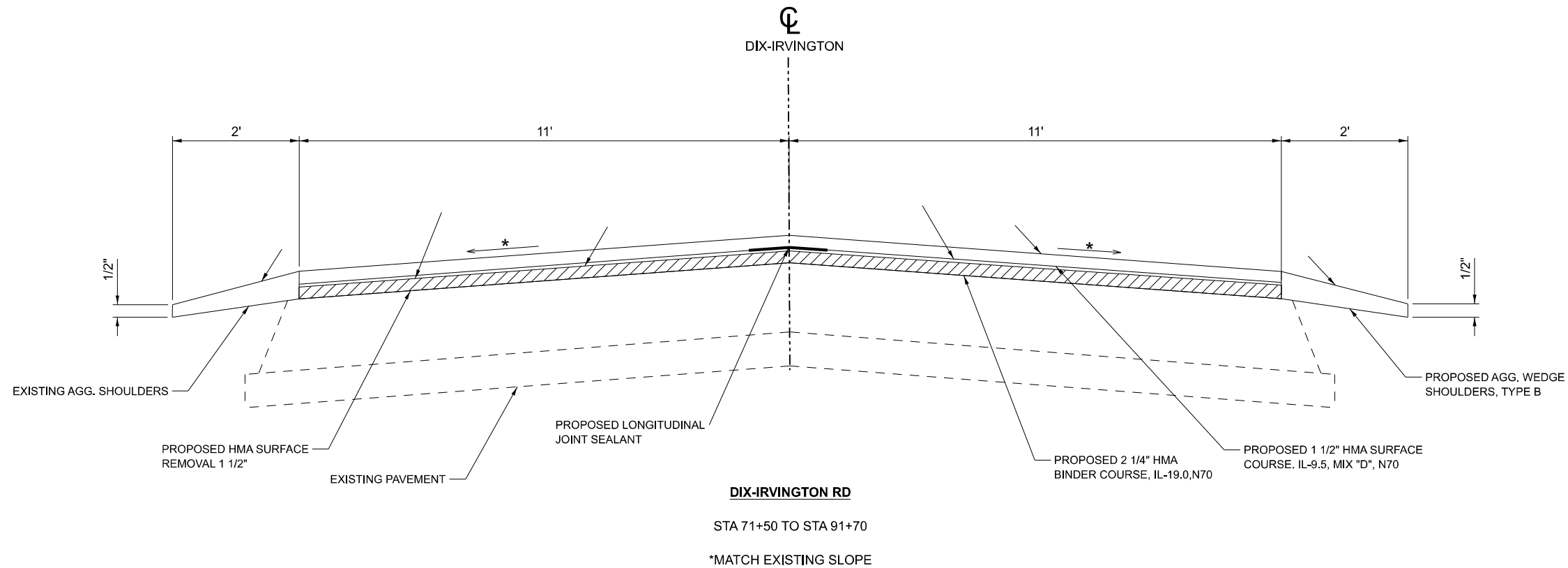
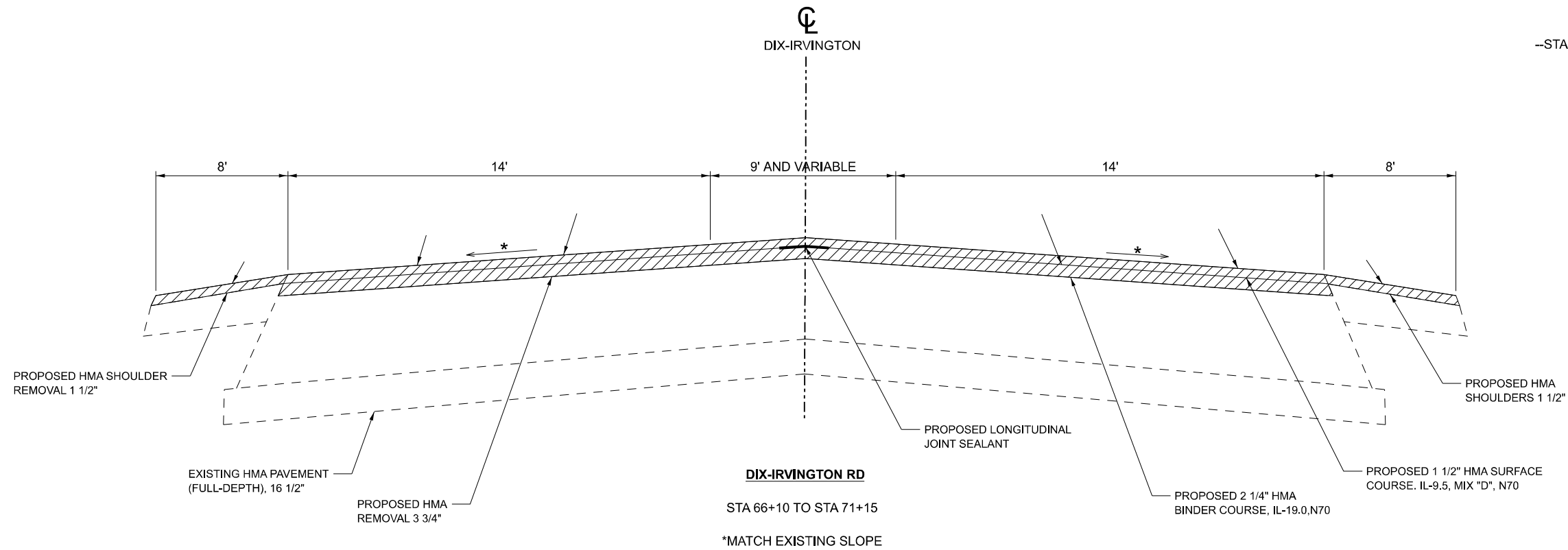

	USER NAME = marco.andresen	DESIGNED -	REVISED -
		DRAWN -	REVISED -
		CHECKED -	REVISED -
	PLOT DATE = 7/30/2024	DATE -	REVISED -

**STATE OF ILLINOIS  
DEPARTMENT OF TRANSPORTATION**

**TYPICAL  
SECTIONS**

SCALE: SHEET 10 OF 27 SHEETS STA. TO STA.

F.A.S RTE.	SECTION	COUNTY	TOTAL SHEETS	SHEET NO.
819	(41-4,41-4-1)RS-2	JEFFERSON	27	10
CONTRACT NO. 78A40				
ILLINOIS FED. AID PROJECT				

(41-4,41-4-1)RS-2



MODEL: Typical-2 [Sheet]  
FILE NAME: c:\p\work\illinois.gov\_marco.andresen\0974091\0978440-SHD-Typicals.dgn

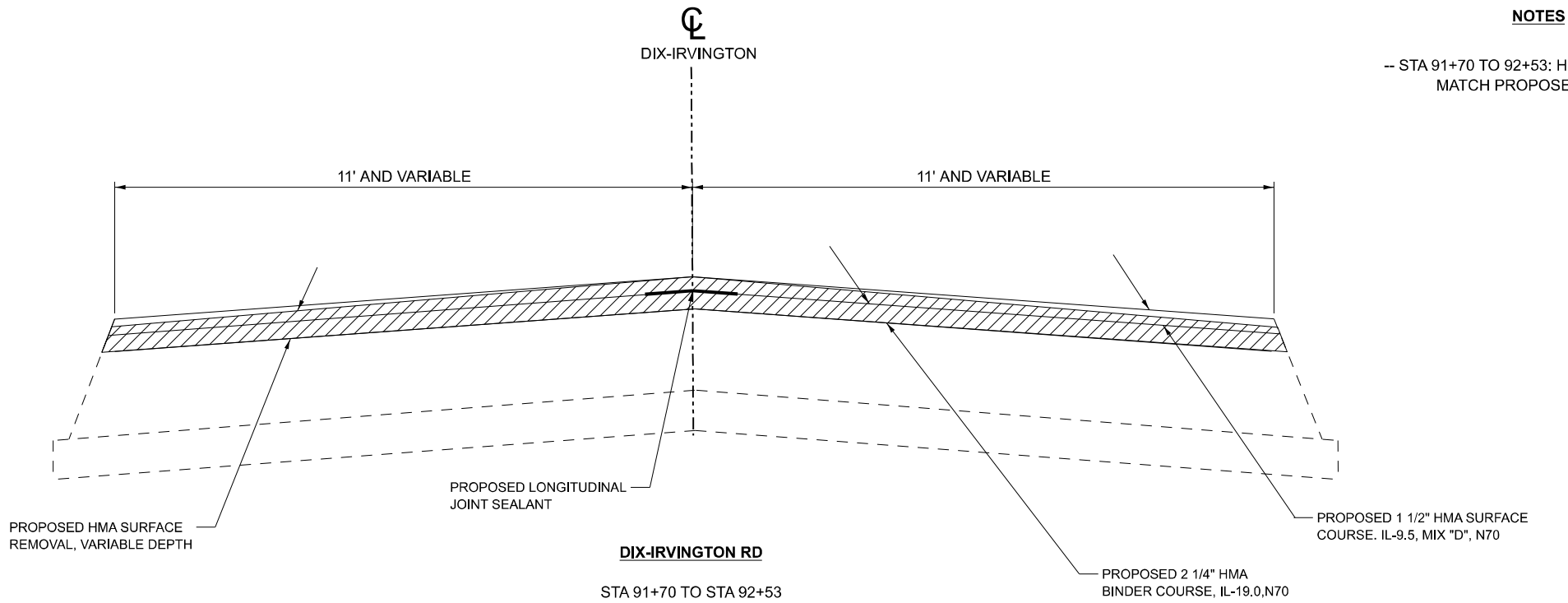

**NOTES**

-- STA 91+70 TO 92+53: HMA VAR. DEPTH SHALL BE USED TO MATCH PROPOSED SIDEWALK ELEV. AT EOP

**STATE OF ILLINOIS  
DEPARTMENT OF TRANSPORTATION**

**TYPICAL  
SECTIONS**

SCALE: SHEET 11 OF 27 SHEETS STA. TO STA.

F.A.S RTE.	SECTION	COUNTY	TOTAL SHEETS	SHEET NO.
819	(41-4,41-4-1)RS-2	JEFFERSON	27	11
CONTRACT NO. 78A40				
ILLINOIS FED. AID PROJECT				

(41-4,41-4-1)RS-2

# W SOUTH ST (FAS 819) MAINLINE RESURFACING SCHEDULE

LOCATION STATION TO STATION					LENGTH	ROADWAY WIDTH	HMA SURFACE REMOVAL (3 3/4")	HMA SURFACE REMOVAL (1 1/2")	HMA SURFACE REMOVAL , VARIABLE DEPTH	HOT-MIX ASPHALT BINDER COURSE, 1L - 19.0, N70 (2 1/4")	HOT-MIX ASPHALT SURFACE COURSE, MIX D, N70 (1 1/2")	MATERIAL TRANSFER DEVICE	BIT. MATERIALS (TACK COAT)	LONG. JOINT SEALANT	TEMP. RAMP	COMMENTS
					FOR INFO. ONLY											
					(FT)	(FT)	(SQ YD)	(SQ YD)	(SQ YD)	(TON)	(TON)	(TON)	(POUND)	(FOOT)	(SQ YD)	
46+02		TO	47+00		98	40	436			55	37	92	294	98	112	TEMP RAMP AT 46+02
47+00		TO	49+00		200	VAR	702			88	59	147	474	200		TURN LANE TAPER
49+00		TO	56+20		720	28	2240			282	188	470	1512		78	TEMP RAMP AT 56+20
56+20		TO	59+50		330	VAR										OMIT PCC INTERSECTION
59+50		TO	61+00		150	40	667			84	56	140	450	150	112	TEMP RAMP AT 59+50
61+00		TO	62+89		189	VAR	593			75	50	125	400	189		TURN LANE TAPER
62+89		TO	66+10		321	28	999			126	84	210	674			
66+10		TO	71+15		505	28	1571			198	132	330	1061	505	78	TEMP RAMP AT 71+15
71+15 TO 71+50 RR CROSSING					35											OMIT RR CROSSING
71+50		TO	71+95		45	22		110		14	9	23	74	45	25	TEMP RAMP AT 71+50
71+95		TO	91+25		1930	22		4718		594	396	990	3185	1930		
91+25		TO	91+70		45	22		110		14	9	23	74	45		TRANSITION TO INLAY
91+70	LT	TO	92+53		83	VAR			518	27	18	45	146	83	385	TEMP RAMP AT 1L37 EOP (92+53)
TOTALS					4286	NA	7208	4718	738	1557	1038	2595	8344	3245	790	

MODEL: Shoulder [Sheet]  
FILE NAME: c:\pw\work\illinois\gov\_marco.andresen\1097840-SNE-Schedules.dgn

W SOUTH ST (FAS 819) SHOULDER SCHEDULE															
STATION TO STATION					LENGTH	SHOULDER LT WIDTH	SHOULDER RT WIDTH	SHOULDER AREA	HMA SURFACE REMOVAL, VARIABLE DETPH	HMA SURFACE REMOVAL (1 1/2")	HMA SHOULDERS (1 1/2")	AGG WEDGE SHOULDER TYPE-B	BITUMINOUS MATERIALS TACK COAT		REMARKS
					(FEET)	(FEET)	(FEET)	(SQ FT)	(SQ YD)	(SQ YD)	(TON)	(TON)	(POUND)		
46+02		TO	56+20	LT & RT	1,018	8	8	16,288		1,810	152.0		814		
56+20		TO	59+50	LT	330	8	0	2,640		293	24.6		132		CONCRETE INTERSECTION, ONLY WB LANE SHOULDER
59+50		TO	65+91	LT & RT	641	8	8	10,256		1,140	95.7		513		
65+91		TO	66+97	LT	106	8	0	848		94	7.9		42		GAP PHILLIPS 66 CONCRETE ENTRANCE TO EOP
66+97		TO	68+25	LT & RT	128	8	8	2,048		228	19.1		102		
68+25		TO	71+15	LT & RT	290	8	8	4,640		516	43.3		232		
71+15 TO 71+50 RR CROSSING															GAP RR TRACKS
71+50		TO	72+38	LT & RT	88	2	2	352				2.5			
72+38		TO	73+16	RT	78	0	2	156				1.1			GAP LEFT ENTRANCE
73+16		TO	73+77	LT & RT	61	2	2	244				1.7			
73+77		TO	74+02	LT	25	2	0	50				0.4			START GAP RIGHT ENTRANCE
74+02		TO	74+49		47	0	0	0				0.0			GAP BOTH SIDES(START OF LH SIDE)
74+49		TO	74+89	LT	40	2	0	80				0.6			GAPING REST OF RIGHT ENTRANCE
74+89		TO	75+69	RT	80	0	2	160				1.1			
75+69		TO	76+05	LT & RT	36	2	2	144				1.0			
76+05		TO	76+73	LT	68	2	0	136				1.0			
76+73		TO	77+05	LT & RT	32	2	2	128				0.9			
77+05		TO	77+52		47	0	0	0				0.0			MARSHALL STREET INTERSECTION
77+52		TO	78+24	LT & RT	72	2	2	288				2.1			
78+24		TO	78+54	RT	30	0	2	60				0.4			GAP LEFT PRIVATE ENTRANCE
78+54		TO	80+00	LT & RT	146	2	2	584				4.2			
80+00		TO	80+31	RT	31	0	2	62				0.4			GAP LEFT PRIVATE ENTRANCE
80+31		TO	81+99	LT & RT	168	2	2	672				4.8			
80+95		TO	81+57	LT	62	2	0	124				0.9			GAP FOR SERVICE ENTRANCE
81+99		TO	82+26	RT	27	0	2	54				0.4			GAP LEFT PRIVATE ENTRANCE
82+26		TO	83+71	LT & RT	145	2	2	580				4.1			
83+71		TO	84+20	LT	49	2	0	98				0.7			GAP ROME SCHOOL ENTRANCE
84+20		TO	84+66	RT	46	0	2	92				0.7			GAP ROME STREET
84+66		TO	86+36	LT & RT	170	2	2	680				4.8			
86+36		TO	86+62	RT	26	0	2	52				0.4			GAP LEFT PRIVATE ENTRANCE
86+62		TO	86+72	LT & RT	10	2	2	40				0.3			
86+72		TO	87+36	LT	64	2	0	128				0.9			GAP ROME SCHOOL ENTRANCE
87+36		TO	87+49	LT & RT	13	2	2	52				0.4			
87+49		TO	88+00	RT	51	0	2	102				0.7			GAP LOW ST
88+00		TO	89+12	LT & RT	112	2	2	448				3.2			
89+12		TO	89+56	RT	44	0	2	88				0.6			GAP JACKSON STREET
89+56		TO	90+81	LT & RT	125	2	2	500				3.6			
90+81		TO	91+20	RT	39	0	2	78				0.6			GAP WEST STREET
91+20		TO	91+70	RT	50	0	2	100				0.7			
91+20		TO	91+70	LT	50	2	0	100		11	1.4				HMA SHOULDER TO MATCH MAINLINE
TOTAL					4645			N/A	0	4092	345	46	1836		

MODEL: Entrances (Sheet)  
FILE NAME: c:\pwwork\illinois.gov\_marco.andresen\1097640-SNE-Schedules.dgn

W SOUTH ST (FAS 819) ENTRANCE AND SIDE ROAD SCHEDULE												
LOCATION			EXISTING SURFACE MATERIAL	WIDTH AT EDGE OF PAVEMENT	O/S TO EOP	WIDTH AT O/S FROM EOP	ROADWAY AREA	HMA SURFACE REMOVAL - BUTT JOINT	INCIDENTAL HMA SURFACING	AGGREGATE WEDGE SHOULDER, TYPE B	BITUMINOUS MATERIALS (TACK COAT)	COMMENTS
				FOR INFORMATIONAL PURPOSES ONLY								
START STATION	SIDE	ENTRANCE TYPE		(FOOT)	(FOOT)	(FOOT)	(SQ YD)	(SQ YD)	(TON)	(TON)	(POUND)	
72+38	LT	COMMERCIAL	AGGREGATE	77.85	4	62.65	31.2		4	0.9	14	PHILS BUILDING
73+77	RT	COMMERCIAL	AGGREGATE	107.28	4	92.94	44.5		6	1.3	20	
74+02	RT	PRIVATE	AGGREGATE	46.74	4	22.18	15.3		2	0.3	7	
74+89	LT	PRIVATE	AGGREGATE	80.17	4	63.83	32.0		4	0.9	14	
76+05	RT	PRIVATE	AGGREGATE	67.9	4	52.06	26.7		3	0.7	12	
77+05	LT	SIDEROAD	HMA	46.54	15	22.18	57.3	57	7		26	MARSHALL STREET
77+05	RT	SIDEROAD	HMA	40	27	12	78.0	78	10		35	MARSHALL STREET **
78+24	LT	PRIVATE	AGGREGATE	29.9	4	21.5	11.4		1	0.3	5	
80+00	LT	PRIVATE	AGGREGATE	31.24	4	25.2	12.5		2	0.4	6	
80+94	RT	PRIVATE	AGGREGATE	62	4	60	27.1		3	0.9	12	UTILITIES ACCESS
81+99	LT	PRIVATE	AGGREGATE	27.6	4	21.66	10.9		1	0.3	5	
83+71	RT	COMMERCIAL	PCC/BITUMINOUS	49	4	42.2	20.3		3		9	ROME SCHOOL
84+24	LT	SIDEROAD	HMA	42.41	15	18.9	51.1	51	6		23	HIGH ST (ROME ST)
86+36	LT	PRIVATE	AGGREGATE	26.21	4	21.55	10.6		1	0.3	5	
86+72	RT	COMMERCIAL	PCC/BITUMINOUS	64.27	4	49.32	25.2		3		11	ROME SCHOOL
87+50	LT	SIDEROAD	HMA	49.76	15	16.9	55.6	56	7		25	LOW ST
89+12	LT	SIDEROAD	HMA	43.98	15	21.94	54.9	55	7		25	JACKSON ST
90+81	LT	SIDEROAD	HMA	38.3	15	15.21	44.6	45	6		20	WEST ST
TOTAL								342	76	7	274	

\*\* EXTRA INCIDENTAL RESURFACING AND HMA SURFACE REMOVAL-BUTT JOINT ON SOUTH MARSHALL TO CONSTRUCT SIDEWALK RAMPS IN COMPLIANCE WITH ADA GUIDELINES

	USER NAME   = marco.andresen	DESIGNED   -	REVISED   -	STATE OF ILLINOIS DEPARTMENT OF TRANSPORTATION	ENTRANCE AND SIDEROAD SCHEDULE				F.A.S RTE.	SECTION	COUNTY	TOTAL SHEETS	SHEET NO.
		DRAWN    -	REVISED   -		819	(41-4,41-4-1)RS-2	JEFFERSON	27	14				
		CHECKED   -	REVISED   -		CONTRACT NO. 78A40								
	PLOT DATE   = 8/6/2024	DATE       -	REVISED   -		ILLINOIS FED. AID PROJECT								
				SCALE:	SHEET 14	OF 27	SHEETS	STA.	TO STA.				

MODEL: Pav Markings (Sheet)  
FILE NAME: c:\p\work\pav\illinois.gov\marco.andresen@illinois.gov\097409\1\097840-S\ME-Schedules.dgn

W SOUTH ST (FAS 819) PAVEMENT MARKING SCHEDULE																	
LOCATION STATION TO STATION				LENGTH  (FEET)	***EDGE LINE OMISSION  (FEET)	PAINT PAVEMENT MARKING						LETTERS AND SYMBOLS  (SQ FT)	RAISED REFLECTIVE PAVEMENT MARKER REMOVAL  (EACH)	RAISFD REFLECTIVE PAVEMENT MARKER PROPOSED  (EACH)	COMMENTS		
						LINE 4"				LINE 6"	LINE 12"	LINE 24"					
						WHITE	YELLOW	YELLOW	YELLOW	WHITE	WHITE	WHITE					
						SOLID	DOUBLE	SOLID	SKIP - DASH	SOLID	SOLID	SOLID					
DIX- IRVINGTON RD (FAS 819)																	
46+02		TO	56+20	1018		2036		2036									CENTER CURB
46+02	LT		47+06	104		104											ADDITIONAL 4" LINE WHITE FOR TURN LANE
46+37	LT											15.6					LEFT TURN ARROW
46+59	LT											20.8					"ONLY"
56+20	LT	TO	59+50	330	330	330											IL57 EXIT RAMP PPC INTERSECTION
59+50		TO	68+00	850	130	1570		1700									ADAMS(LT) AND WARREN(RT) ST OMISSION
57+80	LT	TO	60+30	250		250											ADDITIONAL 4" LINE WHITE FOR TURN LANE
59+83	LT											15.6					LEFT TURN ARROW
60+05	LT											20.8					"ONLY"
64+55		TO	67+42	287			574										GORE AREA AT END OF CURB
68+00		TO	71+15	315		630							3	4			
68+00	RT											14					RR STOP BAR
68+25	RT											54.0					RR CROSSING "X"
68+25	RT											7.2					RR CROSSING "R" x2
68+50	RT											14					RR STOP BAR
70+95	RT											12					RR STOP BAR
71+15 TO 71+50 RR CROSSING																	
71+50		TO	92+53	2103	267	3939		450	530						26		SOLID YELLOW AFTER TRACKS(LT), OMISSION FOR ALL SIDEROADS
71+61	LT											12					RR STOP BAR
74+48	LT											12					RR STOP BAR
74+73	LT											54.0					RR CROSSING "X"
74+73	LT											7.2					RR CROSSING "R" x2
74+98	LT											12					RR STOP BAR
84+20		TO	84+26							48.4	33.2						CROSSWALK ACROSS DIX AT HIGH ST (ROME)
92+23	RT											31.2					STOP LINE FOR DIX RD TO 37
SUB-TOTALS				5257	727	8859	574	4186	530	49	34	108	196	3	31		
TOTALS				5257	727	14149				49	34	108	196	3	31		

\*\*\*SIDEROADS OR PCC INTERSECTIONS

	USER NAME   = marco.andresen	DESIGNED   -	REVISED   -	STATE OF ILLINOIS DEPARTMENT OF TRANSPORTATION	PAVEMENT MARKING SCHEDULE				F.A.S RTE.	SECTION	COUNTY	TOTAL SHEETS	SHEET NO.
		DRAWN    -	REVISED   -						819	(41-4,41-4-1)RS-2	JEFFERSON	27	15
		CHECKED   -	REVISED   -						CONTRACT NO. 78A40				
	PLOT DATE   = 8/7/2024	DATE       -	REVISED   -						ILLINOIS FED. AID PROJECT				
SCALE:					SHEET 15    OF 27   SHEETS			STA.                   TO STA.					



MODEL: S:\dev\alks [Sheet]  
FILE NAME: c:\p\work\pwt\illinois.gov\_marco.andresen@illinois.gov\097409\1\0978A40-S\NE-Schedules.dgn

PATCHING SCHEDULE													
LOCATION (APPROX STA)	EASTBOUND LANE			WESTBOUND LANE			CLASS C			CLASS D			COMMENTS
	LENGTH	WIDTH	AREA	LENGTH	WIDTH	AREA	TY II, 10"	TY III, 10"	TY IV, 10"	TY II, 14"	TY I, 17"	TY II, 17"	
	(FOOT)	(FOOT)	(SQ YD)	(FOOT)	(FOOT)	(SQ YD)	(SQ YD)	(SQ YD)	(SQ YD)	(SQ YD)	(SQ YD)	(SQ YD)	
56+51				15.0	14.0	23.3		23					
56+86	15.0	6.0	10.0				10						
57+37	10.0	14.0	15.6	10.0	27.0	30.0		16	30				All the way across including turn lane
58+90				8.0	27.0	24.0		24					Across Turn lane and thru lane.
67+00	10.0	3.0	3.3	10.0	3.0	3.3					7		
70+11	8.0	8.0	7.1	8.0	9.0	8.0						15	Near East Entrance to UPS Parking Lot.
91+15	8.0	7.0	6.2							6			EBL Near IL37 Intersection
TOTALS			42.2			88.7	10	63	30	6	7	15	



MODEL: Patching [Sheet]  
FILE NAME: c:\pa\_work\work\illinois.gov\_marco.andresen@illinois.gov\0974091\0974040-SNE-Schedules.dgn

SIDEWALK SCHEDULE				
LOCATION	SIDEWALK REMOVAL	PORTLAND CEMENT CONCRETE SIDEWALK 5 INCH (SPECIAL)	DETECTABLE WARNINGS	COMMENTS
	(SQ FT)	(SQ FT)	(SQ FT)	
MARSHALL ST				
NE CORNER	39.06	39.76	8	
SE CORNER	126.7	132.55	16	
SW CORNER	60	60	8	**
HIGH ST				
NW CORNER	33.82	35.06	8	
SW CORNER	50.49	51.13	8	
IL 37				
NW CORNER	64.57	68	8	
SW CORNER	170.61	209.7	9.5	
TOTALS	546	597	66	

\*\* QUANTITY FOR RECONSTRUCTING SW SIDEWALK TO MATCH INCIDENTAL SURFACING;  
SIDEWALK TO BE CONSTRUCTED USING STANDARD 424001

DRAINAGE SCHEDULE		
LOCATION (APPROX STA)	MANHOLES TO BE ADJUSTED	COMMENTS
	(EACH)	
77+30	1	
80+97	1	
84+37	1	
87+66	1	
90+90	1	
TOTALS	5	

CURB & GUTTER SCHEDULE				
LOCATION (APPROX STA)	COMB. CURB & GUTTER REMOVAL	COMB. CONC. CURB & GUTTER TYPE B 6.06	PROTECTIVE COAT	COMMENTS
	(FOOT)	(FOOT)	(SQ YD)	
54+47	137.0	137.0	31.7	REPLACEMENT ON EBL
54+48	98.0	98.0	22.7	REPLACEMENT ON WBL
58+50	6.0	6.0	1.4	REPLACEMENT ON WBL
62+10	16.0	16.0	3.7	REPLACEMENT ON WBL
TOTALS	257	257	60	



MODEL: Geopak\_elements-1 [Sheet]  
FILE NAME: c:\pw\_work\pwidot\illinois.gov\_marco.andresen@illinois.gov\d974096\ID978A40-GEOPAK.dgn

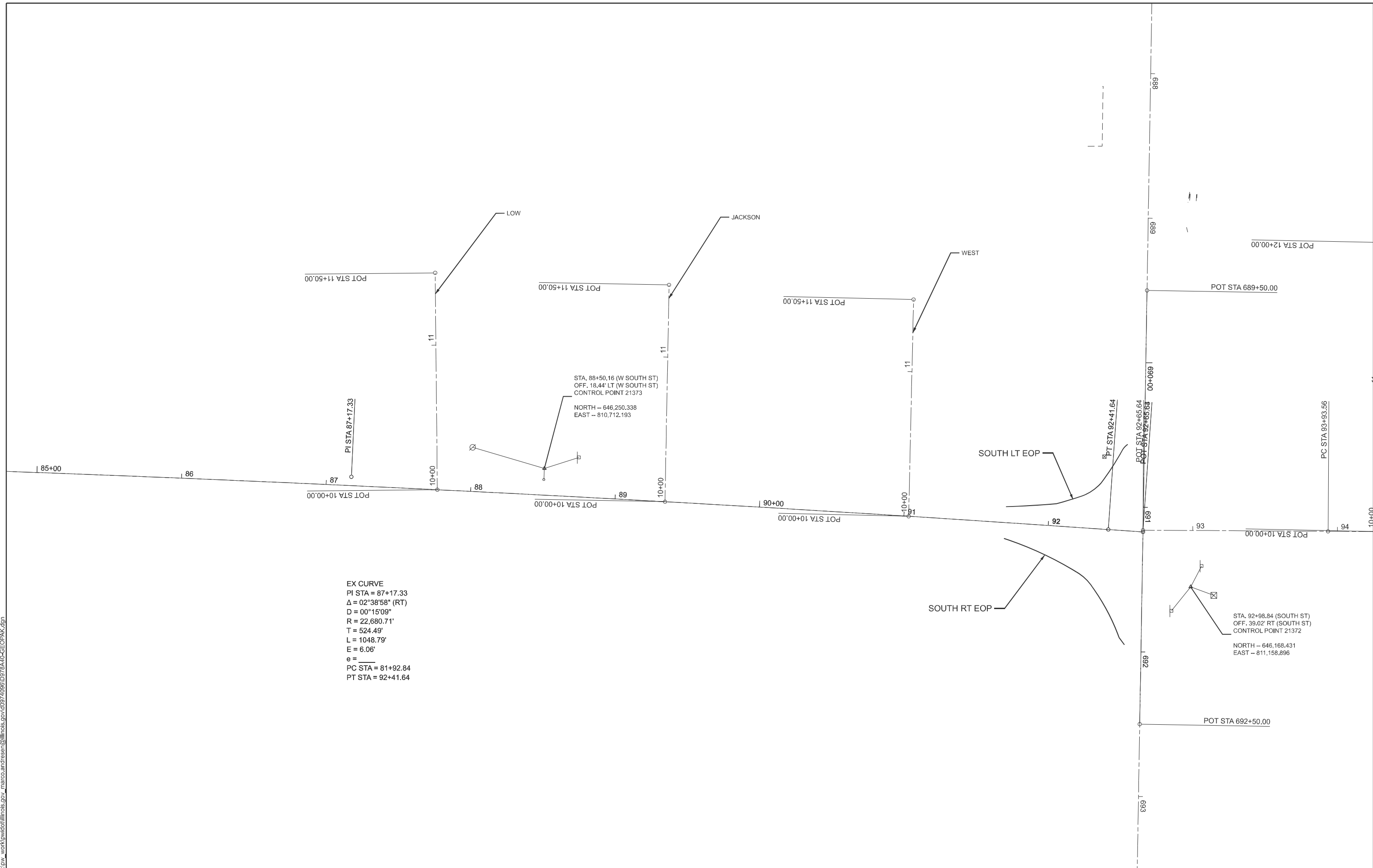

USER NAME = marco.andresen	DESIGNED -	REVISED -
	DRAWN -	REVISED -
	CHECKED -	REVISED -
PLOT DATE = 8/6/2024	DATE -	REVISED -

**STATE OF ILLINOIS**  
**DEPARTMENT OF TRANSPORTATION**

## GEOPAK ELEMENTS AND CONTROL POINTS-CONT

SCALE:	SHEET 19	OF 27	SHEETS	STA.	TO STA.
--------	----------	-------	--------	------	---------

F.A.S RTE.	SECTION	COUNTY	TOTAL SHEETS	SHEET NO.
819	(41-4,41-4-1)RS-2	JEFFERSON	27	19
		CONTRACT NO. 78A40		
ILLINOIS		FED. AID PROJECT		

(41-4,41-4-1)RS-2

MODEL: TIES (Sheet)  
FILE NAME: c:\p\work\illinois.gov\marco.andresen@illinois.gov\0974096\097840-GEOPAK.dgn

SOUTH ST

77

10+00

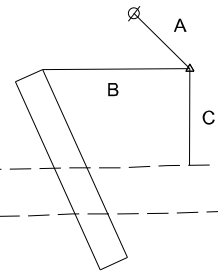

POINT 24377

A=2.95' (STREET SIGN)  
B=7.2' (NORTH EDGE/WALK)  
C=7.4' (END OF 15' RCP)  
STA. 77+09.25 (SOUTH ST)  
OFF. 21.83' RT (SOUTH ST)  
NORTH -- 646,246.233  
EAST -- 809,570.435



MARSHALL ST

HIGH ST



POINT 24376

A=12' (STREET SIGN)  
B=20.3' (STOP SIGN)  
C=6.7' (WEST EDGE WALK @EOP)  
STA. 84+14.81 (SOUTH ST)  
OFF. 15.28' RT (SOUTH ST)  
NORTH -- 646,265.781  
EAST -- 810,276.793

84

10+00

SOUTH ST

POT STA 10+00.00

POINT 21373

A=7.7' (MAG IN EOP)  
B=51.7' (MAG IN POLEW/LIGHT)  
C=26.0' (SCHOOL ZONE SIGN W/MAG)  
STA. 88+50.16 (SOUTH ST)  
OFF. 18.44' LT (SOUTH ST)  
NORTH -- 646,250.338  
EAST -- 810,712.193



88

SOUTH ST

89

93

SOUTH ST



POINT 21372

A=16.15' (STREET SIGN)  
B=16.75' (RIGHT OF WAY MARKER)  
C=21.20' (I-57 SIGN W/MAG)  
STA. 92+98.84 (SOUTH ST)  
OFF. 39.02' RT (SOUTH ST)  
NORTH -- 646,168.431  
EAST -- 811,158.896

STATE OF ILLINOIS  
DEPARTMENT OF TRANSPORTATION

TIE  
POINTS

SCALE: SHEET 20 OF 27 SHEETS STA. TO STA.

F.A.S RTE.	SECTION	COUNTY	TOTAL SHEETS	SHEET NO.
819	(41-4,41-4-1)RS-2	JEFFERSON	27	20
CONTRACT NO. 78A40				
ILLINOIS FED. AID PROJECT				

(41-4,41-4-1)RS-2



77

1000

78

– EXTRA INCIDENTAL RESURFACING AND HMA SURFACE REMOVAL-BUTT JOINT ON SOUTH MARSHALL TO CONSTRUCT SIDEWALK RAMPS IN COMPLIANCE WITH ADA GUIDELINES

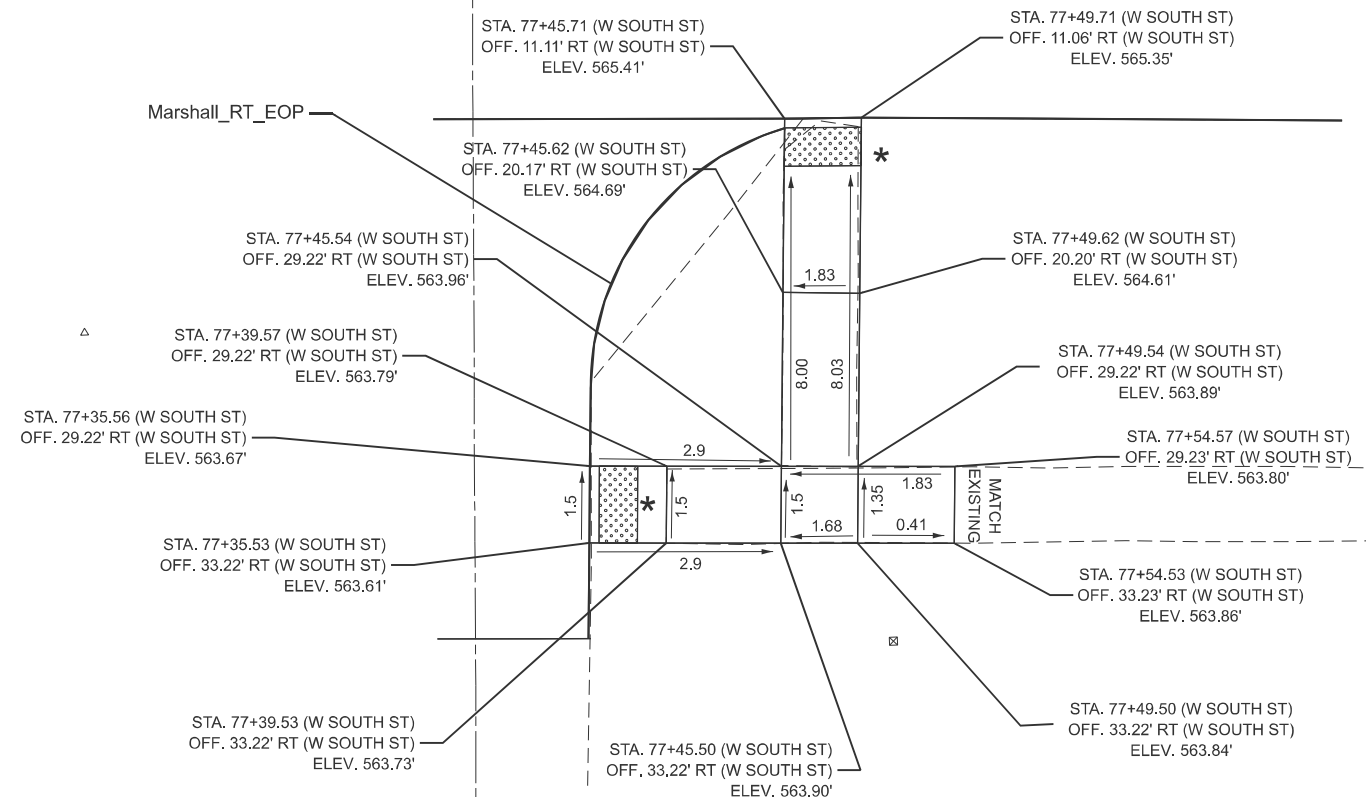

USER NAME = marco.andresen	DESIGNED -	REVISED -
	DRAWN -	REVISED -
	CHECKED -	REVISED -
PLOT DATE = 8/14/2024	DATE -	REVISED -

**STATE OF ILLINOIS**  
**DEPARTMENT OF TRANSPORTATION**

## MARSHALL STREET ADA RAMPS

SCALE:	SHEET 21	OF 27	SHEETS	STA.	TO STA.
--------	----------	-------	--------	------	---------

F.A.S RTE.	SECTION	COUNTY	TOTAL SHEETS	SHEET NO.
819	(41-4,41-4-1)RS-2	JEFFERSON	27	21
		CONTRACT NO. 78A40		
		ILLINOIS	FED. AID PROJECT	

(41-4,41-4-1)RS-2

MODEL: Marshall ADA [Sheet]  
FILE NAME: c:\pw\_work\pwtod\illinois.gov\_marco.andresen@illinois.gov\d0974096\ID978A40-Marshalldesign.dgn





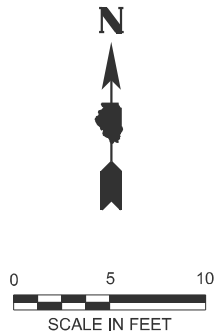

SOUTH\_LT\_EOP

EX CURVE  
PI STA = 87+17.33  
Δ = 02°38'58" (RT)  
D = 00°15'09"  
R = 22,680.71'  
T = 524.49'  
L = 1048.79'  
E = 6.06'  
e =  
PC STA = 81+92.84  
PT STA = 92+41.64

W SOUTH ST

92

STA. 92+21.98 (W SOUTH ST)  
OFF. 30.96' RT (W SOUTH ST)  
ELEV. 576.69'

STA. 92+30.37 (W SOUTH ST)  
OFF. 27.43' LT (W SOUTH ST)  
ELEV. 579.13'

STA. 92+30.19 (W SOUTH ST)  
OFF. 31.26' LT (W SOUTH ST)  
ELEV. 579.20'

STA. 92+30.04 (W SOUTH ST)  
OFF. 34.44' LT (W SOUTH ST)  
ELEV. 579.49'

STA. 92+29.76 (W SOUTH ST)  
OFF. 40.26' LT (W SOUTH ST)  
ELEV. 580.02'

STA. 92+29.48 (W SOUTH ST)  
OFF. 46.24' LT (W SOUTH ST)  
ELEV. 580.57'

MATCH  
EXISTING

PT STA 92+41.64

STA. 92+33.75 (W SOUTH ST)  
OFF. 40.45' LT (W SOUTH ST)  
ELEV. 580.04'

STA. 92+34.03 (W SOUTH ST)  
OFF. 34.64' LT (W SOUTH ST)  
ELEV. 579.55'

STA. 92+34.18 (W SOUTH ST)  
OFF. 31.45' LT (W SOUTH ST)  
ELEV. 579.28'

STA. 92+33.47 (W SOUTH ST)  
OFF. 46.43' LT (W SOUTH ST)  
ELEV. 580.54'

POT STA 92+65.63

IL37 CL

MODEL: 37 N [Sheet]  
FILE NAME: c:\p\work\pilot\illinois.gov\_marco.andresen@illinois.gov\0974096\0978A40-IL37DESIGN.dgn

	USER NAME = marco.andresen	DESIGNED -	REVISED -
		DRAWN -	REVISED -
		CHECKED -	REVISED -
	PLOT DATE = 8/14/2024	DATE -	REVISED -

STATE OF ILLINOIS  
DEPARTMENT OF TRANSPORTATION

ADA RAMPS  
IL37 N INTERSECTION

SCALE: SHEET 23 OF 27 SHEETS STA. TO STA.

F.A.S RTE.	SECTION	COUNTY	TOTAL SHEETS	SHEET NO.
819	(41-4,41-4-1)RS-2	JEFFERSON	27	23
CONTRACT NO. 78A40				
ILLINOIS FED. AID PROJECT				

(41-4,41-4-1)RS-2

MODEL: 37S ADA [Sheet]  
FILE NAME: c:\pw\_work\pwwillinois.gov\_marco.andresen@illinois.gov\d097d096\097d096-IL37DESIGN.dgn

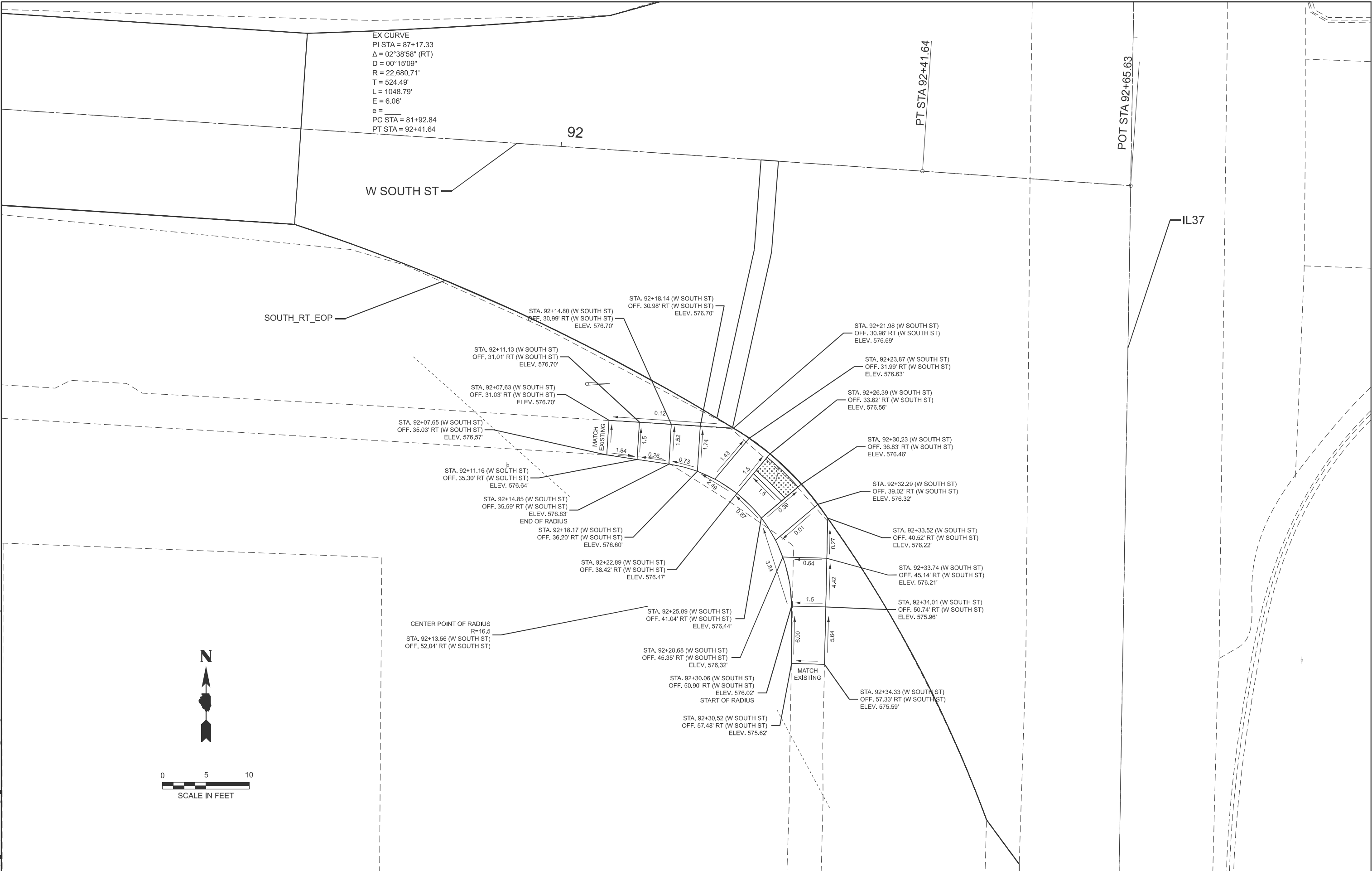

PLOT DATE = 8/14/2024	USER NAME = marco.andresen	DESIGNED -	REVISED -
		DRAWN -	REVISED -
		CHECKED -	REVISED -
	DATE -		REVISED -

STATE OF ILLINOIS  
DEPARTMENT OF TRANSPORTATION

ADA RAMP IL37 S INTERSECTION			
SCALE:	SHEET 24	OF 27 SHEETS	STA. TO STA.

F.A.S RTE.	SECTION	COUNTY	TOTAL SHEETS	SHEET NO.
819	(41-4,41-4-1)RS-2	JEFFERSON	27	24
CONTRACT NO. 78A40				
ILLINOIS FED. AID PROJECT				

(41-4,41-4-1)RS-2

W SOUTH ST SIDEROAD AND ENTRANCE DETAILS

HMA, PCC OR OIL & CHIP SIDEROADS WITH BUTT JOINT

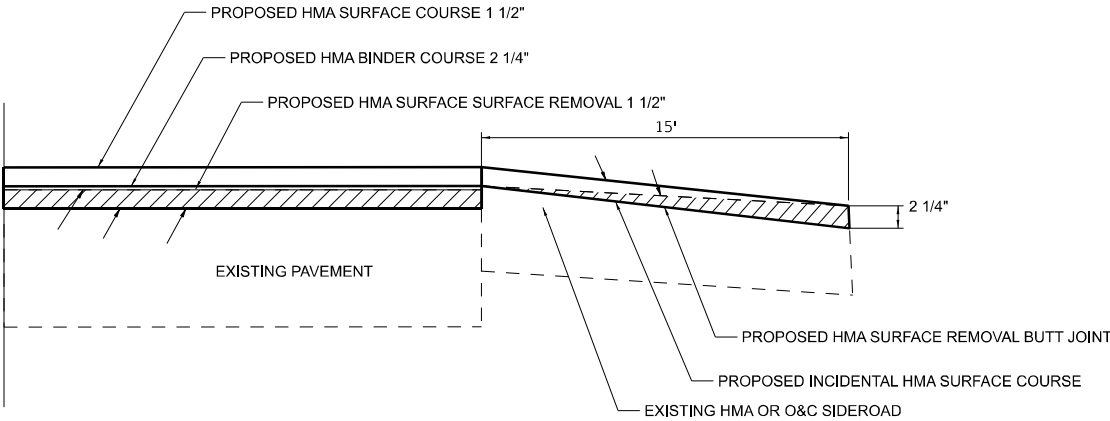

AGGREGATE ENTRANCE

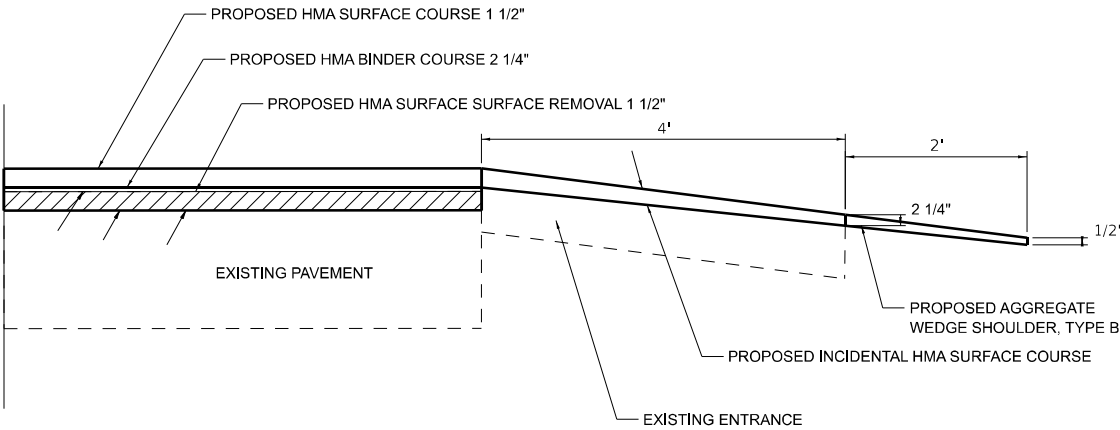

BITUMINOUS OR PCC ENTRANCE

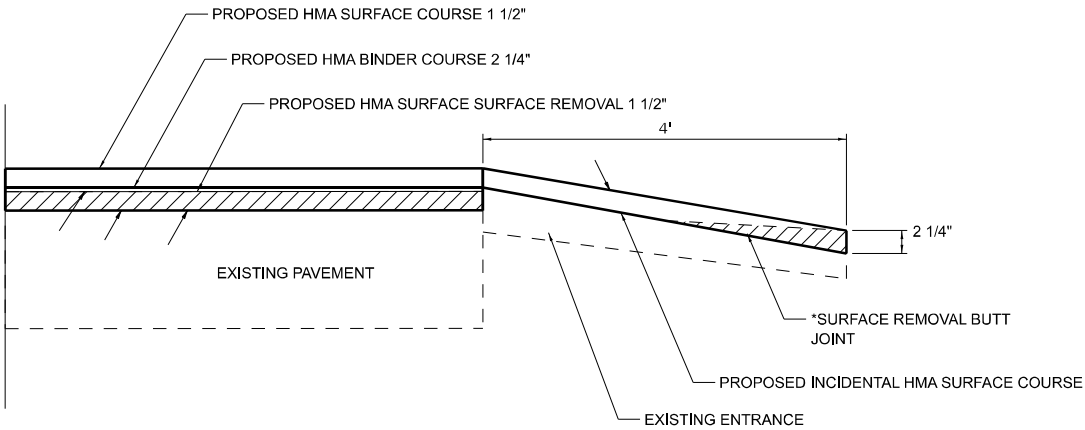

1. IF THE EXISTING SUBBASE IS INADEQUATE, AS DETERMINED BY THE ENGINEER, THE SIDE ROADS SHALL BE CORED OUT AND AGGREGATE SUBBASE, TYPE B SHALL BE PLACED FOR BASE. THE COST OF CORING OUT THE SIDEROAD AND ANY AGGREGATE BASE COURSE SHALL BE PAID FOR AS SPECIFIED IN ART. 109.04 OF THE STANDARD SPECIFICATIONS FOR ROAD AND BRIDGE CONSTRUCTION. IF EXISTING SUBBASE IS DETERMINED TO BE ADEQUATE, THE PREPARATION OF THE BASE SHALL BE CONSTRUCTED ACCORDING TO ARTICLE 406.09.
2. VARIABLE SHAPING IS INCLUDED IN THE COST OF INCIDENTAL HOT-MIX ASPHALT SURFACING.
3. \*SURFACE REMOVAL BUTT JOINT ON ENTRANCES IS INCLUDED IN THE COST OF INCIDENTAL HOT-MIX ASPHALT SURFACING.

MODEL: DETAIL Sideroads (Sheet)  
FILE NAME: c:\p\work\illinois\gov\marco.andresen\0974091\097840-SHS-DistrictStds.dgn

	USER NAME = marco.andresen	DESIGNED -	REVISED -	STATE OF ILLINOIS DEPARTMENT OF TRANSPORTATION	DETAILS: SIDEROAD			F.A.S RTE.	SECTION	COUNTY	TOTAL SHEETS	SHEET NO.
		DRAWN -	REVISED -					819	(41-4,41-4-1)RS-2	JEFFERSON	27	25
		CHECKED -	REVISED -					CONTRACT NO. 78A40				
	PLOT DATE = 7/26/2024	DATE -	REVISED -		SCALE:	SHEET 25	OF 27 SHEETS	STA.	TO STA.	ILLINOIS	FED. AID PROJECT	

(41-4,41-4-1)RS-2

RESURFACING TRANSITION

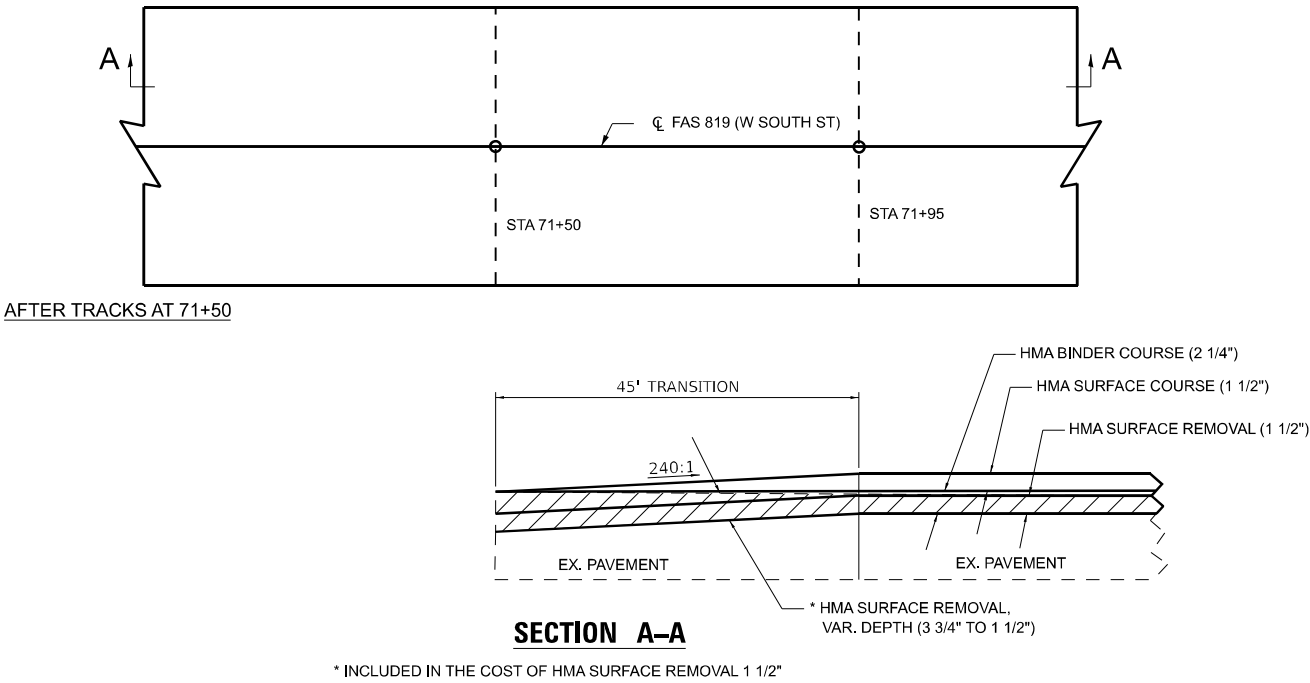

RESURFACING TRANSITION

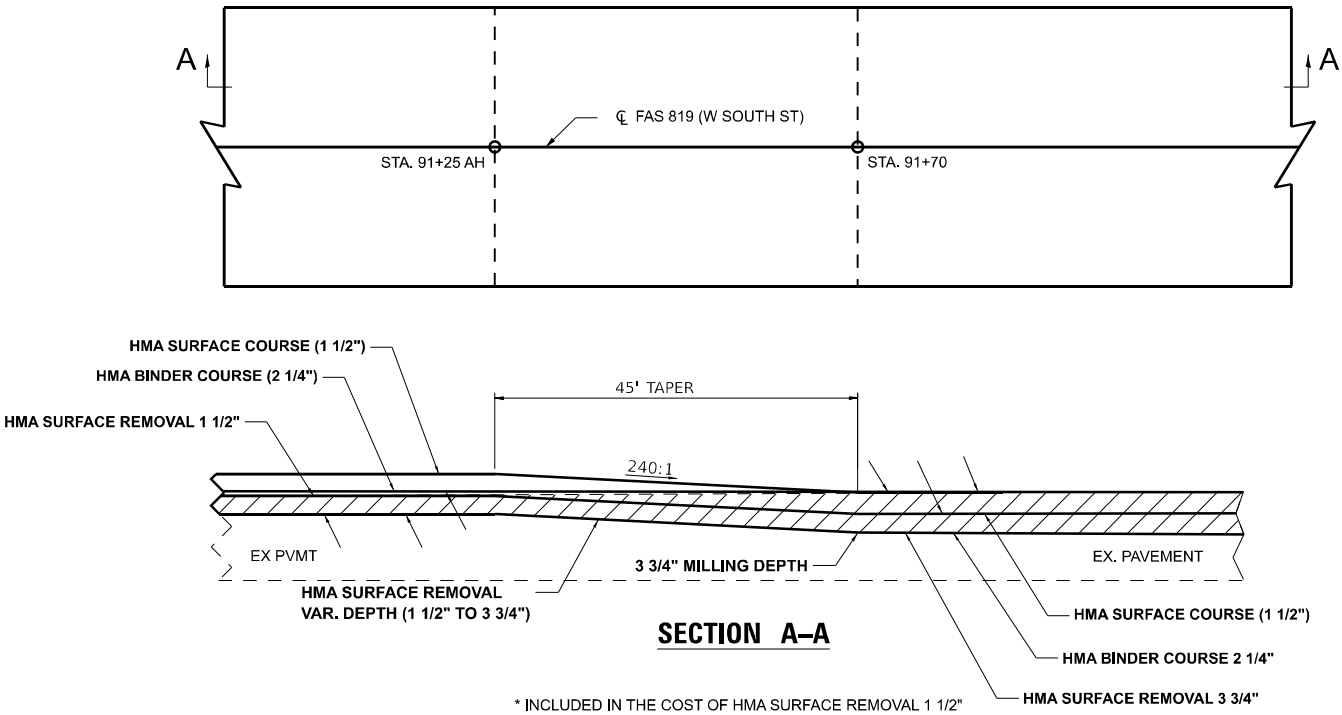

MODEL: DETAIL S-transition (Sheet)  
FILE NAME: c:\p\work\illinois\gov\marco.andresen\097409\1\097640-SHS-DistrictStds.dgn

USER NAME = marco.andresen	DESIGNED -	REVISED -
	DRAWN -	REVISED -
	CHECKED -	REVISED -
PLOT DATE = 7/26/2024	DATE -	REVISED -

STATE OF ILLINOIS  
DEPARTMENT OF TRANSPORTATION

DETAILS:  
HMA TRANSITIONS

SCALE: SHEET 26 OF 27 SHEETS STA. TO STA.

F.A.S RTE.	SECTION	COUNTY	TOTAL SHEETS	SHEET NO.
819	(41-4,41-4-1)RS-2	JEFFERSON	27	26
CONTRACT NO. 78A40				
ILLINOIS FED. AID PROJECT				

(41-4,41-4-1)RS-2

UNEVEN LANES SIGN  
W8-11 (48" X 48")

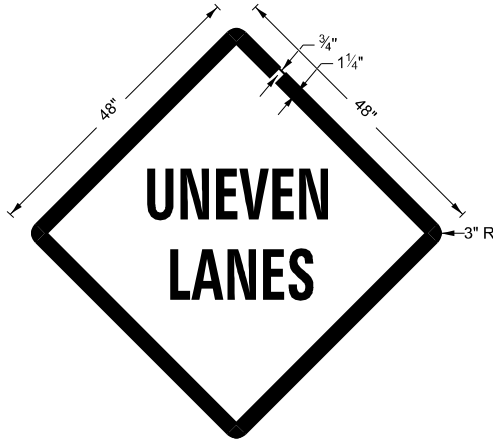

COLORS:

LEGEND AND BORDER - BLACK NON-REFLECTORIZED  
BACKGROUND - ORANGE REFLECTORIZED

NOTE: PRIOR TO ALLOWING TRAFFIC ON ANY PORTION OF THE ROADWAY THAT HAS BEEN COLDMILLED OR BEFORE RESURFACING OPERATIONS BEGIN, THE CONTRACTOR SHALL HAVE ERECTED "UNEVEN PAVEMENT" SIGNS THAT CONFORM TO THE ABOVE DETAILS. A MINIMUM OF ONE SIGN AT EACH END OF THE IMPROVEMENT WILL BE REQUIRED. THE CONTRACTOR SHALL MAINTAIN THE "UNEVEN PAVEMENT" SIGNS UNTIL THE RESURFACING OPERATIONS ARE COMPLETED.

IF AT ANY TIME THE SIGNS ARE IN PLACE BUT NOT APPLICABLE, THEY SHALL BE TURNED FROM THE VIEW OF MOTORISTS OR COVERED AS DIRECTED BY THE ENGINEER.

THE COST OF FURNISHING, ERECTING, MAINTAINING, AND REMOVING THE REQUIRED SIGNS SHALL BE INCLUDED IN THE CONTRACT.

DRAWN	02-15-89
REVISED	05-08-08
REVISED	10-21-21
REVISED	05-27-22

STD. 9-24

ILLINOIS STANDARD  
ROUGH GROOVED SURFACE SIGN

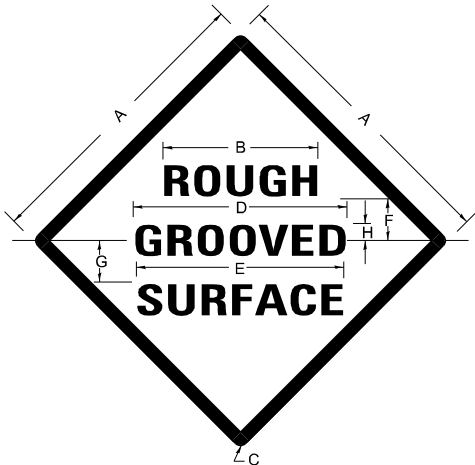

COLORS

LEGEND AND BORDER- BLACK NON-REFLECTORIZED  
BACKGROUND- ORANGE REFLECTORIZED

SIGN SIZE	DIMENSIONS							
	A	B	C	D	E	F	G	H
48X48	48.0	24.1	3.0	34.0	33.0	6.0	13.0	3.5

SIGN SIZE	SERIES			MAR- GIN	BOR- DER	BLANK STD.
	LINES					
	1	2	3			
48X48	7C	7C	7C	0.8	1.2	B4-48D

ALL DIMENSIONS IN INCHES

NOTES

PRIOR TO ALLOWING TRAFFIC ON ANY PORTION OF THE ROADWAY THAT HAS BEEN COLDMILLED, THE CONTRACTOR SHALL HAVE ERECTED "ROUGH GROOVED SURFACE" SIGNS THAT CONFORM TO THE ABOVE DETAILS. A MINIMUM OF ONE SIGN AT EACH END OF THE IMPROVEMENT WILL BE REQUIRED. THE CONTRACTOR SHALL MAINTAIN THE "ROUGH GROOVED SURFACE" SIGNS UNTIL THE COLDMILLED SURFACE IS COVERED WITH LEVELING BINDER OR SURFACE COURSE.

IF AT ANY TIME THE SIGNS ARE IN PLACE BUT NOT APPLICABLE, THEY SHALL BE TURNED FROM THE VIEW OF MOTORISTS OR COVERED AS DIRECTED BY THE ENGINEER.

THE COST OF FURNISHING, ERECTING, MAINTAINING, AND REMOVING THE REQUIRED SIGNS SHALL BE INCLUDED IN THE CONTRACT.

DRAWN	02-15-89
REVISED	03-27-08
REVISED	10-21-21
REVISED	05-27-22

STD. 9-23

TEMPORARY HOT-MIX ASPHALT TRANSITIONS

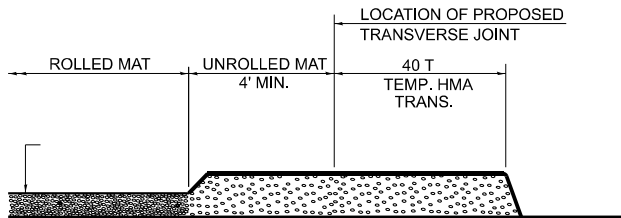

STEP I

1. PLACE HOT-MIX ASPHALT MAT, LENGTH 40 TIMES THE THICKNESS OF THE MAT BEING PLACED PAST THE PROPOSED TRANSVERSE JOINT LOCATION USING NORMAL OPERATING PROCEDURES.
2. EXTREME CARE SHOULD BE TAKEN TO MAINTAIN ENOUGH MATERIAL IN FRONT OF THE SCREED TO MAINTAIN REQUIRED PAVING DEPTH.

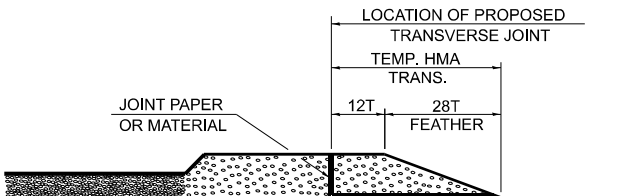

STEP III

1. JOINT PAPER OR OTHER PRESELECTED JOINT MATERIAL IS THEN PLACED IN THE CLEARED AREA AND THE EXCESS ASPHALT USED TO HAND FORM A TRANSITION TO THE DIMENSIONS SHOWN ABOVE.
2. NOTE THAT IN CONSTRUCTING THE TRANSITION, THE MAT DEPTH IS CONTINUED AS PART OF THE TRANSITION BEFORE FORMING THE FEATHER.

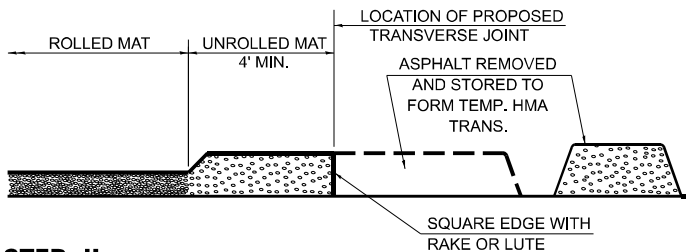

STEP II

1. MOVE THE PAVER OUT OF THE WAY AND REMOVE THE ASPHALT FROM THE AREA OF THE PROPOSED TEMPORARY HOT-MIX ASPHALT TRANSITION.
2. SQUARE UP THE END OF THE MAT WITH A RAKE OR LUTE.
3. NOTE THAT THE MAT WITHIN 4' OF THE END OF JOINT IS NOT TO BE ROLLED AT THIS TIME.

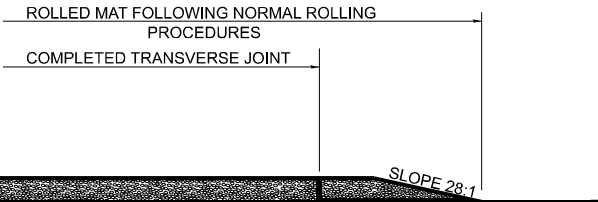

STEP IV

1. COMPLETE TEMPORARY TRANSITION BY ROLLING.
2. TO RESUME PAVING, AT THE JOINT, REMOVE TEMPORARY TRANSITION AND DISPOSE OF THE MATERIAL ACCORDING TO ART. 202.03 OF THE STD. SPECS. (COST INCLUDED IN THE CONTRACT).
3. CONSTRUCTING THE TEMPORARY TRANSITIONS WILL NOT BE PAID FOR SEPARATELY IN ACCORDANCE WITH ARTICLE 406.14 OF THE STANDARD SPECIFICATIONS.

DRAWN	02-15-89
REVISED	01-09-07
REVISED	10-21-21
REVISED	05-26-22

STD. 9-18

PEDESTRIAN CROSSING PAVEMENT MARKING DETAIL

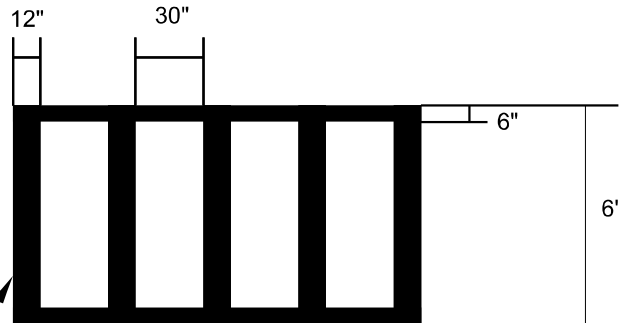

PROP. PAINT PAVEMENT MARKING

LINE 12"(WHITE)  
LINE 6"(WHITE)  
UNLESS OTHERWISE NOTED

MODEL: DETAIL-S-tempramps (Sheet)  
FILE NAME: c:\paw\work\illinois\gov\marco.andresen\097408\1097640-SHS-DistrictStds.dgn

USER NAME = marco.andresen	DESIGNED -	REVISED -
	DRAWN -	REVISED -
	CHECKED -	REVISED -
PLOT DATE = 7/26/2024	DATE -	REVISED -

STATE OF ILLINOIS  
DEPARTMENT OF TRANSPORTATION

DETAILS: UNEVEN LANES, ROUGH GROOVED SURFACE,  
TEMP. HMA TRANSITIONS, PEDESTRIAN CROSSING MARKING

SCALE: SHEET 27 OF 27 SHEETS STA. TO STA.

F.A.S. RTE.	SECTION	COUNTY	TOTAL SHEETS	SHEET NO.
819	(41-4,41-4-1)RS-2	JEFFERSON	27	27
CONTRACT NO. 78A40				
ILLINOIS FED. AID PROJECT				

(41-4,41-4-1)RS-2