

11-08-2024 LETTING ITEM 112

FOR INDEX OF SHEETS, SEE SHEET NO. 2  
FOR LIST OF HIGHWAY STANDARDS SEE SHEET NO. 2

**FUNCTIONAL CLASSIFICATION**  
ASHLAND AVE (W OF DOUGLAS AVE) - MAJOR COLLECTOR  
ASHLAND AVE (E OF DOUGLAS AVE) - MINOR COLLECTOR

**TRAFFIC DATA**  
2018 ADT W. OF DOUGLAS AVE = 6,150  
2018 ADT E. OF DOUGLAS AVE = 4,000

**POSTED SPEED LIMIT**  
ASHLAND AVE = 30 MPH

**DESIGN SPEED LIMIT**  
ASHLAND AVE = 30 MPH

# STATE OF ILLINOIS

## DEPARTMENT OF TRANSPORTATION

# PLANS FOR PROPOSED FEDERAL AID HIGHWAY

**FAU ROUTE 1650 (ASHLAND AVE.)  
IL ROUTE 25/BROADWAY TO UNION ST.  
ROADWAY RESURFACING  
SECTION NO.: 24-00366-00-RS  
PROJECT NO.: LG5Q(579)  
CITY OF AURORA  
KANE COUNTY**

FAU ATE.	SECTION	COUNTY	TOTAL SHEETS	SHEET NO.
1650	24-00366-00-RS	KANE	24	1
		ILLINOIS	CONTRACT NO. 61K66	



C-91-246-24

RANGE 8 EAST

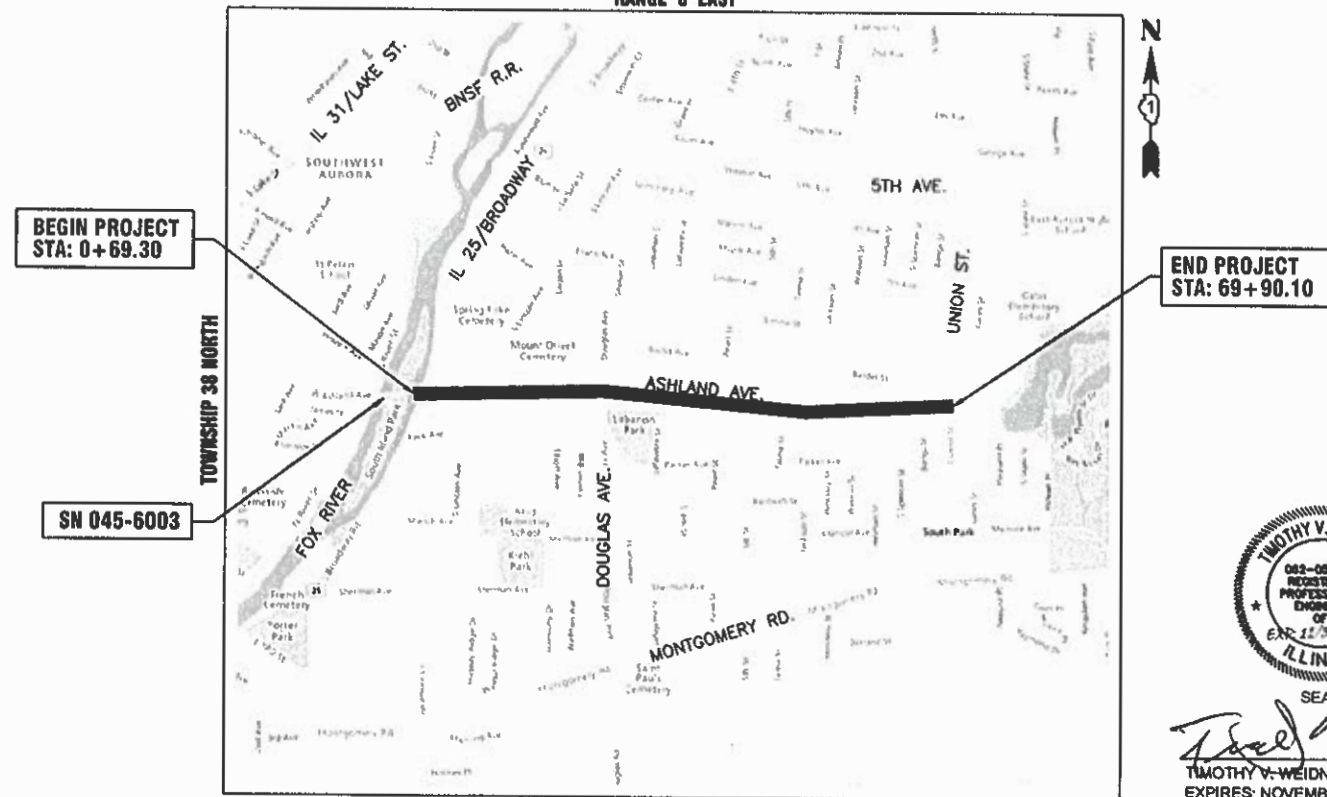

KANE COUNTY - AURORA TOWNSHIP  
THIRD PRINCIPAL MERIDIAN

LOCATION MAP  
NOT TO SCALE

GROSS LENGTH OF PROJECT = 6,921.00 FEET (1.311 MILES)  
NET LENGTH OF PROJECT = 6,921.00 FEET (1.311 MILES)

FEDERAL AID PROGRAM ENGINEER: CARMEN E. RAMOS, P.E., SCHAUMBURG, IL

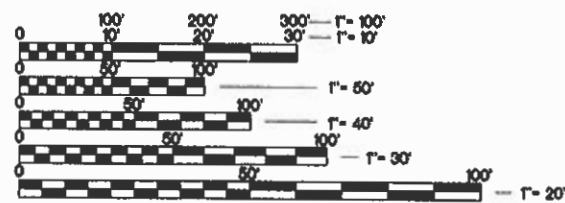

FULL SIZE PLANS HAVE BEEN PREPARED USING STANDARD ENGINEERING SCALES. REDUCED SIZED PLANS WILL NOT CONFORM TO STANDARD SCALES. IN MAKING MEASUREMENTS ON REDUCED PLANS, THE ABOVE SCALES MAY BE USED.

J.U.L.I.E.  
JOINT UTILITY LOCATION INFORMATION FOR EXCAVATION  
811 OR 1-800-892-0123

Dial 811 or 1-800-892-0123 JULIE DESIGN TICKET NUMBER: # X000760492



Know what's below.  
Call before you dig.

WITH THE FOLLOWING:  
COUNTY KANE  
CITY-TOWNSHIP AURORA-AURORA TOWNSHIP  
SEC. & 1/4 SEC. NO. 24-00366-00-RS-38 N-8 E.

(2) Working Days before you dig  
(Including Sat., Sun. & Holidays)

CONTRACT NO. 61K66

STATE OF ILLINOIS  
DEPARTMENT OF TRANSPORTATION

APPROVED July 29, 2024  
Timothy V. Weidner  
CITY OF AURORA, ENGINEERING COORDINATOR

PASSED September 4, 2024  
C.F. Rios / JAF  
DISTRICT 1 ENGINEER OF LOCAL ROADS & STREETS

RELEASING FOR BID  
BASED ON LIMITED  
REVIEW September 4, 2024  
[Signature]  
REGIONAL ENGINEER



SEAL  
Timothy V. Weidner  
TIMOTHY V. WEIDNER, P.E.  
EXPIRES: NOVEMBER 30, 2025

PLANS PREPARED BY  
THE CITY OF AURORA

PRINTED BY THE AUTHORITY  
OF THE STATE OF ILLINOIS

**INDEX OF SHEETS**

SHEET NO.	DESCRIPTION
1	COVER SHEET
2	INDEX OF SHEETS, DETAILS, HIGHWAY STANDARDS AND GENERAL NOTES
3 - 5	SUMMARY OF QUANTITIES
6 - 7	TYPICAL SECTIONS
8 - 14	RESURFACING PLANS
15	EROSION CONTROL DETAILS
16 - 24	I.D.O.T. DISTRICT 1 DETAILS

**ILLINOIS URBAN MANUAL EROSION CONTROL DETAILS**

IUM-654SB	TEMPORARY CONCRETE WASHOUT FACILITY - STRAW BALE
IUM-561C	INLET PROTECTION - PAVED AREAS CURB PROTECTION
IUM-561D	INLET PROTECTION - PAVED AREAS DROP-IN PROTECTION

**DISTRICT ONE DETAILS**

BD-08	DETAILS FOR FRAMES AND LIDS ADJUSTMENT WITH MILLING
BD-22	PAVEMENT PATCHING FOR HMA SURFACED PAVEMENT
BD-24	CURB OR CURB AND GUTTER REMOVAL AND REPLACEMENT
BD-32	BUTT JOINT AND HMA TAPER DETAILS
TC-10	TRAFFIC CONTROL AND PROTECTION FOR SIDE ROADS, INTERSECTIONS, AND DRIVEWAYS
TC-13	DISTRICT ONE TYPICAL PAVEMENT MARKINGS
TC-16	SHORT TERM PAVEMENT MARKING LETTERS AND SYMBOLS
TC-22	ARTERIAL ROAD INFORMATION SIGN
TC-26	DRIVEWAY ENTRANCE SIGNING

**HIGHWAY STANDARDS**

000001-08	STANDARD SYMBOLS, ABBREVIATIONS AND PATTERNS
001006	DECIMAL OF AN INCH AND OF A FOOT
280001-07	TEMPORARY EROSION CONTROL SYSTEMS
420001-10	PAVEMENT JOINTS
442201-03	CLASS C AND D PATCHES
604001-05	FRAME AND LIDS TYPE 1
604051-04	FRAME AND LIDS TYPE 11
606001-08	CONCRETE CURB TYPE B AND COMBINATION CONCRETE CURB AND GUTTER
701006-05	OFF-RD OPERATIONS, 2L, 2W, 15' (4.5M) TO 24" (600 MM) FROM PAVEMENT EDGE
701011-04	OFF-RD MOVING OPERATIONS, 2L, 2W, DAY ONLY
701101-05	OFF-RD OPERATIONS, MULTILANE, 15' (4.5 M) TO 24" (600 MM) FROM PAVEMENT EDGE
701301-04	LANE CLOSURE, 2L, 2W, SHORT TIME OPERATIONS
701311-03	LANE CLOSURE, 2L, 2W, MOVING OPERATIONS-DAY ONLY
701501-06	URBAN LANE CLOSURE, 2L, 2W, UNDIVIDED
701502-09	URBAN LANE CLOSURE, 2L, 2W, WITH BIDIRECTIONAL LEFT TURN LANE
701701-10	URBAN LANE CLOSURE, MULTILANE INTERSECTION
701801-06	SIDEWALK, CORNER OR CROSSWALK CLOSURE
701901-09	TRAFFIC CONTROL DEVICES
780001-05	TYPICAL PAVEMENT MARKING

**GENERAL NOTES**

- ALL REFERENCES TO "STANDARD SPECIFICATIONS" IN THESE GENERAL NOTES SHALL BE INTERPRETED TO MEAN THE ILLINOIS DEPARTMENT OF TRANSPORTATION "STANDARD SPECIFICATIONS FOR ROAD AND BRIDGE CONSTRUCTION", JANUARY 1, 2022 AND SUPPLEMENTAL SPECIFICATIONS AND RECURRING SPECIAL PROVISIONS, JANUARY 1, 2024.
- IT SHALL BE THE CONTRACTOR'S RESPONSIBILITY TO VERIFY ALL DIMENSIONS AND CONDITIONS EXISTING IN THE FIELD PRIOR TO CONSTRUCTION AND ORDERING OF MATERIALS. IN ADDITION, THE CONTRACTOR MUST VERIFY THE ENGINEER'S LINE AND GRADE STAKES. IN THE EVENT OF A DISCREPANCY BETWEEN THE PLANS AND FIELD CONDITIONS, THE CONTRACTOR SHALL SECURE WRITTEN INSTRUCTIONS FROM THE ENGINEER PRIOR TO PROCEEDING WITH ANY PART OF THE WORK AFFECTED BY THE IDENTIFIED DISCREPANCIES.
- BEFORE STARTING ANY EXCAVATION, THE CONTRACTOR SHALL CALL "JULIE" (JOINT UTILITY LOCATION INFORMATION FOR EXCAVATION) AT (800) 892-0123 FOR FIELD LOCATIONS OF BURIED UTILITIES (48 HOURS NOTIFICATION IS REQUIRED).
- THE CONTRACTOR WILL NOT BE ALLOWED TO SET UP A YARD OR FIELD OFFICE ON CITY, STATE, OR PRIVATE PROPERTY WITHOUT WRITTEN PERMISSION FROM THE ENGINEER.
- THE STORAGE OF EQUIPMENT AND/OR MATERIALS WITHIN THE RIGHT-OF-WAY OF ANY STREET AND/OR PARK PROPERTY SHALL REQUIRE PRIOR APPROVAL OF THE ENGINEER.
- OFFSET LOCATIONS GIVEN IN THE PLANS FOR STRUCTURES, EDGE OF PAVEMENT, ETC. ARE FROM THE ROADWAY CENTERLINE.
- SIDEWALK REMOVAL AND REPLACEMENT AND COMBINATION CONCRETE CURB AND GUTTER REMOVAL AND REPLACEMENT AS SHOWN ON THE PLANS IS FOR INFORMATIONAL PURPOSES ONLY. ACTUAL LOCATIONS AND QUANTITIES ARE TO BE DETERMINED AND MARKED BY THE ENGINEER PRIOR TO CONSTRUCTION.
- BUTT JOINTS WILL BE INSTALLED AT THE ENDS OF RESURFACING (WHERE RESURFACING MEETS EXISTING PAVEMENT) IN ACCORDANCE WITH THE "BUTT JOINT AND HMA TAPER DETAILS" SHEET INCLUDED IN THE PLANS.
- THE CONTRACTOR SHALL VERIFY THAT ALL CRACKS, JOINTS, AND FLANGWAYS ARE CLEAN AND DRY PRIOR TO PLACEMENT OF MIXTURE FOR CRACKS, JOINTS, AND FLANGWAYS.
- THE CONTRACTOR SHALL MAINTAIN THE SITE IN A CLEAN AND ORDERLY MANNER. DEBRIS AND SURPLUS MATERIAL SHALL BE REMOVED AND RESTORATION SHALL PROCEED AS THE WORK PROCEEDS. IF THE ENGINEER SO DIRECTS, THE CONTRACTOR SHALL STOP ALL OTHER WORK AND CONCENTRATE ON CLEAN-UP AND RESTORATION. DEBRIS AND SURPLUS MATERIAL SHALL BE DISPOSED BY THE CONTRACTOR OFF-SITE.
- DRIVEWAY ENTRANCES WILL BE KEPT OPEN TO TRAFFIC AT ALL TIMES. THE CONTRACTOR WILL BE ALLOWED TO CLOSE A MAXIMUM OF HALF THE AREA OF ANY ONE ENTRANCE AT ANY TIME. IT IS ESSENTIAL THAT THE ENTRANCES REMAIN OPEN AND 'DRIVE-ABLE' FOR TWO-WAY TRAFFIC AT ALL TIMES. THE CONTRACTOR WILL BE RESPONSIBLE FOR MAINTAINING TRAFFIC CONTROL AND PROTECTION. WHERE NEW CURB AND GUTTER IS TO BE INSTALLED ACROSS A DRIVEWAY, IT IS EXPECTED THAT ONLY HALF OF THE DRIVEWAY ENTRANCE MAY BE REMOVED AND REPLACED AT ANY ONE TIME. ONLY AFTER PROPER CONCRETE CURE TIME HAS OCCURRED MAY THE CONTRACTOR BEGIN REMOVAL AND REPLACEMENT OPERATIONS ON THE REMAINING HALF OF THE CURB AND GUTTER. THE CONTRACTOR WILL NOT BE ALLOWED TO CLOSE A HALF OF DRIVEWAY ENTRANCE FOR MORE THAN 48 HOURS UNDER ANY CIRCUMSTANCE.
- CONTRACTOR SHALL TAKE PRECAUTION BY PRESERVING EXISTING TREES WITHIN THE RIGHT OF WAY. IF ANY DAMAGE OCCURS, TREES SHALL BE REPLACED IN KIND PER ARTICLE 201.07 REPAIR OR REPLACEMENT OF EXISTING PLANT MATERIAL REQUIREMENTS STATED HEREIN
- WHEN MILLED PAVEMENT IS OPEN TO TRAFFIC, THE MAXIMUM GRADE DIFFERENTIAL BETWEEN PASSES OF THE MILLING MACHINE SHALL NOT EXCEED 1.5 INCHES WHERE THE SPEED IS 45 MPH OR LESS, WITH WRITTEN APPROVAL FROM THE RESIDENT ENGINEER, A MAXIMUM GRADE DIFFERENTIAL OF 3 INCHES MAY BE ALLOWED IF THE EDGE OF THE MILLING IS SLOPED A MINIMUM OF 1V:3H.
- THE CONTRACTOR SHALL CONTACT KALPANA KANNAN-HOSADURGA, THE DISTRICT ONE TRAFFIC CONTROL SUPERVISOR AT KALPANA.KANNAN-HOSADURGA@ILLINOIS.GOV A MINIMUM 72 HOURS IN ADVANCE OF BEGINNING WORK.
- ALL NITROGEN, PHOSPHOROUS, AND POTASSIUM FERTILIZER NUTRIENTS HAVE BEEN INTENTIONALLY OMITTED FROM THE CONTRACT ON THE SEEDING OR SODDING APPLICATION.
- TREES RECEIVING TREE TRUNK PROTECTION AND TREE ROOT PRUNING ARE TO BE DETERMINED BY THE ENGINEER IN THE FIELD.

**UTILITIES**

- THE CONTRACTOR SHALL BE RESPONSIBLE FOR CONTACTING THE OWNER OF ALL EXISTING UTILITIES FACILITIES SO THAT THE UTILITIES AND THEIR APPURTENANCES MAY BE LOCATED AND ADJUSTED OR MOVED, IF NECESSARY, PRIOR TO THE START OF CONSTRUCTION OPERATIONS. ALL UTILITY COMPANIES AND THE CITY OF AURORA SHALL BE NOTIFIED AT LEAST 3 DAYS PRIOR TO THE START OF CONSTRUCTION.
- EXISTING BROKEN FRAMES AND LIDS SHALL BE REMOVED AND DISPOSED OF BY THE CONTRACTOR AND SHALL BE REPLACED AS DIRECTED BY THE ENGINEER.
- ONLY PRECAST CONCRETE ADJUSTMENT RINGS, MAXIMUM OF 12 INCHES IN HEIGHT, WILL BE ALLOWED IN THE ADJUSTMENT OF CATCH BASINS, MANHOLES, INLETS AND VALVE VAULT STRUCTURES. COMMON BRICK WILL NOT BE ALLOWED.
- THE CONTRACTOR SHALL ENSURE THAT ALL WATER SYSTEM VALVES (IN VALVE BOXES AND VALVE VAULTS) SHALL REMAIN READILY ACCESSIBLE TO THE CITY FOR EMERGENCY OPERATIONS AND NOT BURIED DURING CONSTRUCTION, UNLESS APPROVED BY THE ENGINEER. THE LOCATIONS OF ALL WATER FACILITIES SHALL BE MARKED AND READILY VISIBLE AT ALL TIMES. FOR ALL OTHER STRUCTURES THAT NEED TO BE ADJUSTED THAT ARE NOT WATER, THE CONTRACTOR CAN CHOOSE TO ADJUST THEM ACCORDING TO BD-08. THE CONTRACTOR CAN ALSO CHOOSE TO BURY WATER STRUCTURES ACCORDING TO BD-08 WITH APPROVAL BY THE ENGINEER. THE CONTRACTOR WOULD NEED TO PROVIDE A DETAILED SCHEDULE OF MILLING, PAVING, AND ADJUSTMENT TIMELINES FOR THE ENGINEER'S REVIEW. APPROVAL BY THE ENGINEER IS NOT GUARANTEED AND WOULD BE CONTINGENT ON THE CONTRACTOR BURYING WATER STRUCTURES LAST AND ADJUSTING THEM FIRST. THE CONTRACTOR IS TO DETERMINE ANY PROTECTION OR RAMPING THAT IS REQUIRED AROUND STRUCTURES IF THEY ARE NOT BURIED. OPEN LID STORM MANHOLE STRUCTURES IN THE PAVEMENT MAY NOT BE ABLE TO BE ADJUSTED ACCORDING TO BD-08.
- THE INDISCRIMINATE USE OF FIRE HYDRANTS OR EXISTING STREAMS, CREEKS, WETLANDS OR PONDS IS STRICTLY PROHIBITED. THE CONTRACTOR SHALL PROVIDE A WATER TRUCK AND DRIVER AS REQUIRED TO OBTAIN AND TRANSPORT THIS WATER. THE CONTRACTOR SHALL BE RESPONSIBLE FOR OBTAINING WATER FROM AN APPROVED SOURCE. IF THIS WATER IS FROM A SOURCE OTHER THAN THEIR YARD, WRITTEN APPROVAL FROM THE AGENCY HAVING JURISDICTION FOR THE SOURCE OF THE WATER MUST BE RECEIVED BY THE ENGINEER PRIOR TO USE OF THE WATER.

**SIGNING AND STRIPING**

- ALL EXISTING SIGNS (INCLUDING THOSE LOCATED ON UTILITY/LIGHT POLES) THAT DO NOT CONFLICT WITH THE IMPROVEMENTS SHALL REMAIN IN PLACE UNLESS DIRECTED BY THE ENGINEER.
- SIGNS SHALL NOT BE MOVED OR COVERED UNTIL PROGRESS OF WORK NECESSITATES IT.
- SEE IDOT DISTRICT ONE DETAILS TC-13 (DISTRICT ONE TYPICAL PAVEMENT MARKINGS), AND TC-16 (SHORT TERM PAVEMENT MARKINGS LETTERS AND SYMBOLS) AND PLAN SHEETS FOR PAVEMENT MARKING DETAILS.
- GRINDING OF PAVEMENT MARKINGS ON NEWLY CONSTRUCTED HOT-MIX ASPHALT SHALL NOT BE PERMITTED.

**COMMITMENTS**

FINAL PAVEMENT ELEVATIONS SHALL NOT BE CHANGED IN THE FLOODPLAIN EAST OF STA. 52+00.

COMPANY NAME: PROJECT CONTACT: 9/26/2024 8:50 AM  
 CLIENT: Ashland Ave-Cover-Ph2  
 DATE PLOTTED: Ashland Ave-Cover-Ph2  
 FILE NAME: DWG To PDF.pc3  
 PLOT DRIVER: ILDOT-Standard.ctb  
 PEN TABLE:

USER NAME = HOPPM	DESIGNED -- AN	REVISED --
FILE NAME = Ashland Ave-Cover-Ph2	DRAWN -- MH	REVISED --
PLOT SCALE = N.T.S.	CHECKED -- TW	REVISED --
PLOT DATE = 9/26/2024	DATE -- 03/01/2024	REVISED --

**STATE OF ILLINOIS  
 DEPARTMENT OF TRANSPORTATION**

**INDEX OF SHEETS, DETAILS, HIGHWAY STANDARDS AND GENERAL NOTES**

SCALE: N.T.S. SHEET NO. OF SHEETS STA. TO STA.

FAU RTE.	SECTION	COUNTY	TOTAL SHEETS	SHEET NO.
1650	23-00366-00-RS	KANE	24	2
CONTRACT NO. 61K66				
ILLINOIS FED. AID PROJECT				

CODE NUMBER	ITEM DESCRIPTION	UNIT	QUANTITY	
			ROADWAY	80% FEDERAL 20% LOCAL 0005
20101100	TREE TRUNK PROTECTION	EACH	5	
20101200	TREE ROOT PRUNING	EACH	5	
21101615	TOPSOIL FURNISH AND PLACE, 4"	SQ YD	461	
25200110	SODDING, SALT TOLERANT	SQ YD	461	
25200200	SUPPLEMENTAL WATERING	UNIT	24.9	
31101000	SUBBASE GRANULAR MATERIAL, TYPE B	TON	95	
40600290	BITUMINOUS MATERIALS (TACK COAT)	POUND	22379	
40600370	LONGITUDINAL JOINT SEALANT	FOOT	8784	
40600400	MIXTURE FOR CRACKS, JOINTS, AND FLANGEWAYS	TON	13.3	
40600982	HOT-MIX ASPHALT SURFACE REMOVAL - BUTT JOINT	SQ YD	399	
40603200	POLYMERIZED HOT-MIX ASPHALT BINDER COURSE, IL-4.75, N50	TON	1824	
40604060	HOT-MIX ASPHALT SURFACE COURSE, IL-9.5, MIX "D", N50	TON	3714	
42400200	PORTLAND CEMENT CONCRETE SIDEWALK 5 INCH	SQ FT	6750	
42400800	DETECTABLE WARNINGS	SQ FT	460	
44000161	HOT-MIX ASPHALT SURFACE REMOVAL, 3"	SQ YD	33153	
44000600	SIDEWALK REMOVAL	SQ FT	6750	

† INDICATES SPECIALTY ITEM

COMPANY NAME:  
PROJECT CONTACT:  
CLIENT:  
DATE PLOTTED:  
FILE NAME:  
PLOT DRIVER:  
PLOT DATE:

9/19/2024 10:59 AM  
Ashland Ave-Cover-Ph2  
DWG To PDF.plt  
LUP21-2024.dwg

USER NAME = HOPPM	DESIGNED - AN	REVISED -
FILE NAME = Ashland Ave-Cover-Ph2	DRAWN - MH	REVISED -
PLOT SCALE = N.T.S.	CHECKED - TW	REVISED -
PLOT DATE = 8/19/2024	DATE - 03/01/2024	REVISED -

STATE OF ILLINOIS  
DEPARTMENT OF TRANSPORTATION

SUMMARY OF QUANTITIES

SCALE: N.T.S. SHEET NO. 01 OF 03 SHEETS STA. TO STA.

FAU RTE.	SECTION	COUNTY	TOTAL SHEETS	SHEET NO.
1650	23-00366-00-R5	KANE	24	3
CONTRACT NO. 61K66				
ILLINOIS   FED. AID PROJECT				

CODE NUMBER	ITEM DESCRIPTION	UNIT	QUANTITY
			ROADWAY 80% FEDERAL 20% LOCAL 0005
44201737	CLASS D PATCHES, TYPE I, 8 INCH	SQ YD	170
44201741	CLASS D PATCHES, TYPE II, 8 INCH	SQ YD	330
44201745	CLASS D PATCHES, TYPE III, 8 INCH	SQ YD	660
44201747	CLASS D PATCHES, TYPE IV, 8 INCH	SQ YD	500
67100100	MOBILIZATION	L SUM	1
70102620	TRAFFIC CONTROL AND PROTECTION, STANDARD 701501	L SUM	1
70102622	TRAFFIC CONTROL AND PROTECTION, STANDARD 701502	L SUM	1
70102635	TRAFFIC CONTROL AND PROTECTION, STANDARD 701701	L SUM	1
70102640	TRAFFIC CONTROL AND PROTECTION, STANDARD 701801	L SUM	1
70300100	SHORT TERM PAVEMENT MARKING	FOOT	4894
70300150	SHORT TERM PAVEMENT MARKING REMOVAL	SQ FT	1632
t 78000100	THERMOPLASTIC PAVEMENT MARKING - LETTERS AND SYMBOLS	SQ FT	255
t 78000200	THERMOPLASTIC PAVEMENT MARKING - LINE 4"	FOOT	5894
t 78000400	THERMOPLASTIC PAVEMENT MARKING - LINE 6"	FOOT	2934
t 78000600	THERMOPLASTIC PAVEMENT MARKING - LINE 12"	FOOT	224
t 78000650	THERMOPLASTIC PAVEMENT MARKING - LINE 24"	FOOT	461

t INDICATES SPECIALTY ITEM

COMPANY NAME:  
PROJECT CONTACT:  
CLIENT:  
DATE PLOTTED:  
FILE NAME:  
CUT DRIVER:  
PLOT DATE:

8/19/2024 10:59 AM  
Ashland Ave-Cover-Ph2  
DNC 16 PDR.plt  
LUCAS-STANGORUB

USER NAME = HOPPM	DESIGNED - AN	REVISED -
FILE NAME = Ashland Ave-Cover-Ph2	DRAWN - MH	REVISED -
PLOT SCALE = N.T.S.	CHECKED - TW	REVISED -
PLOT DATE = 8/19/2024	DATE - 03/01/2024	REVISED -

STATE OF ILLINOIS  
DEPARTMENT OF TRANSPORTATION

SUMMARY OF QUANTITIES

SCALE: N.T.S. SHEET NO. 02 OF 03 SHEETS STA. TO STA.

FAU RTE.	SECTION	COUNTY	TOTAL SHEETS	SHEET NO.
1650	23-00366-00-RS	KANE	24	4
CONTRACT NO. 61K66				
ILLINOIS   FED. AID PROJECT				





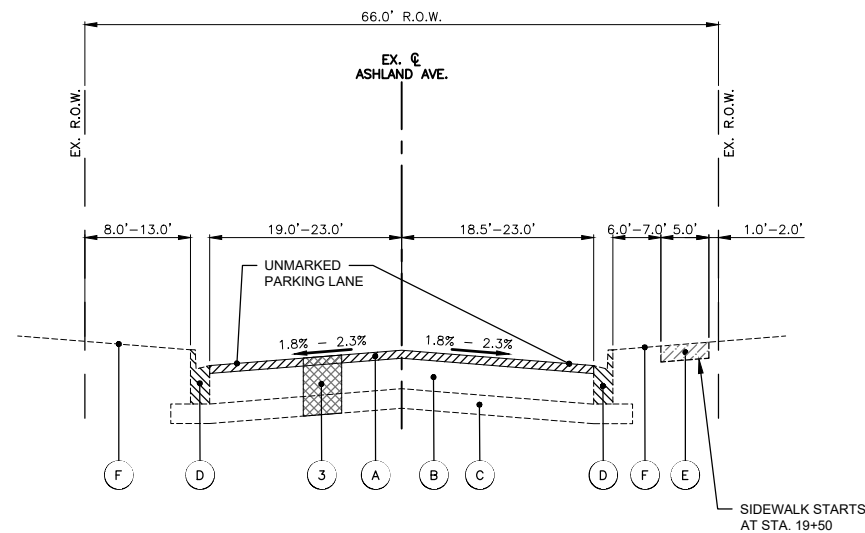

**EXISTING TYPICAL SECTION - ASHLAND AVE.**

STA: 0+69.3 - STA: 24+50.0

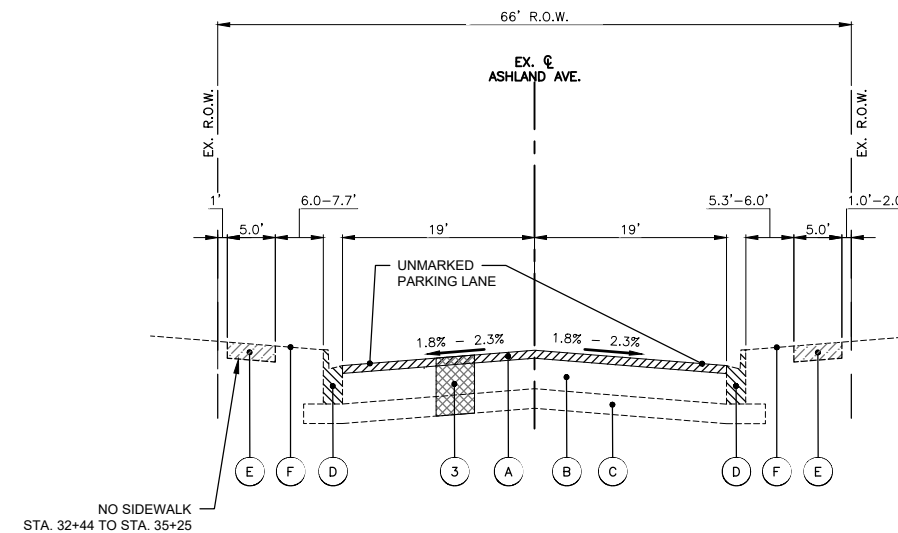

**EXISTING TYPICAL SECTION - ASHLAND AVE.**

STA: 24+50.0 - STA: 51+00.0

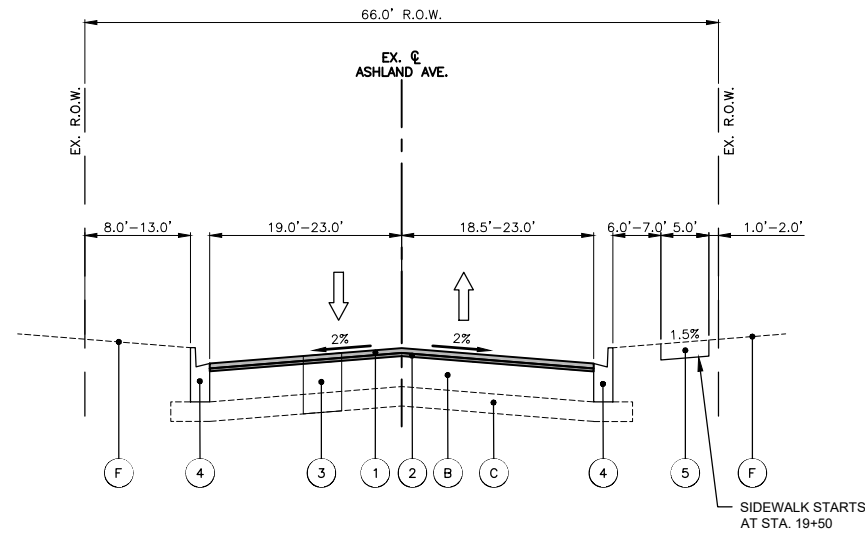

**PROPOSED TYPICAL SECTION - ASHLAND AVE.**

STA: 0+69.3 - STA: 24+50.0

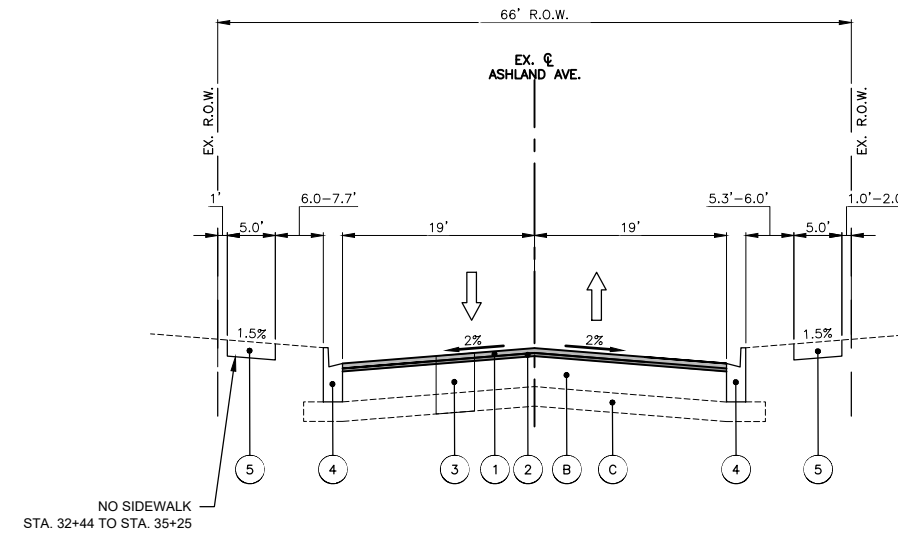

**PROPOSED TYPICAL SECTION - ASHLAND AVE.**

STA: 24+50.0 - STA: 51+00.0

**HOT-MIX ASPHALT MIXTURE REQUIREMENTS**

OPERATION	MIXTURE TYPE	AIR VOIDS @ NDES	QMP
PAVEMENT RESURFACING	HOT-MIX ASPHALT SURFACE COURSE, MIX "D", IL-9.5, N50, 2"	4% @ 50 GYR.	LR1030-2
	POLYMERIZED HOT-MIX ASPHALT BINDER COURSE, IL-4.75, N50, 1"	3.5% @ 50 GYR.	LR1030-2
CLASS D PATCHES	HOT-MIX ASPHALT BINDER COURSE, IL-19.0, N70, 8"	4% @ 70 GYR.	LR1030-2
QMP DESIGNATION: QUALITY CONTROL/QUALITY ASSURANCE (QC/QA) PER LR1030-2			

THE UNIT WEIGHT USED TO CALCULATE ALL HMA SURFACE MIXTURE QUANTITIES IS 112 LBS/SQ YD/IN  
 THE "AC TYPE" FOR POLYMERIZED HMA MIXES SHALL BE "SBS/SBR PG 76-22" AND FOR NON-POLYMERIZED HMA THE "AC TYPE" SHALL BE "PG64-22" UNLESS MODIFIED BY RECLAIMED MATERIALS SPECIFICATIONS.  
 THE LONGITUDINAL JOINT SEALANT SHALL BE PLACED OVER THE P HMA BC IL-4.75 N50.

**EXISTING LEGEND**

- A HOT-MIX ASPHALT SURFACE REMOVAL, 3.0"
- B EXISTING PAVEMENT HMA, 11"
- C AGGREGATE SUBBASE, 4"
- D COMBINATION CONCRETE CURB & GUTTER, VARIES FROM TYPE B-6.12 TO B-6.24
- E PORTLAND CEMENT CONCRETE SIDEWALK, 5"
- F EXISTING GROUND

**PROPOSED LEGEND**

- 1 HOT-MIX ASPHALT SURFACE COURSE, MIX "D", IL-9.5, N50, 2"
- 2 POLYMERIZED HOT-MIX ASPHALT BINDER COURSE, IL-4.75, N50, 1"
- 3 CLASS D PATCHES WITH SUBBASE GRANULAR MATERIAL TYPE B, 8" (SPOT REMOVAL & REPLACEMENT AS DIRECTED BY THE ENGINEER)
- 4 COMBINATION CONCRETE CURB & GUTTER, VARIES FROM TYPE B-6.12 TO B-6.24 (SPOT REMOVAL & REPLACEMENT AS DIRECTED BY THE ENGINEER)
- 5 PCC SIDEWALK, 5" (SPOT REMOVAL & REPLACEMENT AS DIRECTED BY THE ENGINEER)

NOTES:  
 • THE PATCHING QUANTITIES HAVE BEEN ESTIMATED BASED ON FIELD OBSERVATIONS DURING DESIGN. ACTUAL QUANTITIES TO BE DETERMINED DURING CONSTRUCTION BY THE ENGINEER.  
 • NO PROPOSED WORK WILL TAKE PLACE OUTSIDE OF THE EXISTING R.O.W.  
 • FINAL PAVEMENT ELEVATIONS SHALL REMAIN UNCHANGED IN THE FLOODPLAIN.

COMPANY NAME: PROJECT CONTACT:  
 CLIENT: 8/19/2024 10:59 AM  
 FILE NAME: Ashland Ave-Typ Sections  
 DATE PLOTTED: 8/19/2024 10:59 AM  
 PLOT DRIVER: DWG To PDF.pc3  
 PEN TABLE: ILDOT-Standard.ctb

USER NAME = HOPPM	DESIGNED - AN	REVISED -
FILE NAME = Ashland Ave-Typ Sections	DRAWN - MH	REVISED -
PLOT SCALE = N.T.S.	CHECKED - TW	REVISED -
PLOT DATE = 8/19/2024	DATE - 03/01/2024	REVISED -

**STATE OF ILLINOIS  
 DEPARTMENT OF TRANSPORTATION**

**ASHLAND AVENUE  
 TYPICAL SECTIONS**

SCALE: N.T.S.	SHEET NO. 01 OF 02 SHEETS	STA. TO STA.	FAU RTE. 1650	SECTION 23-00366-00-RS	COUNTY KANE	TOTAL SHEETS 24	SHEET NO. 6
CONTRACT NO. 61K66							ILLINOIS FED. AID PROJECT

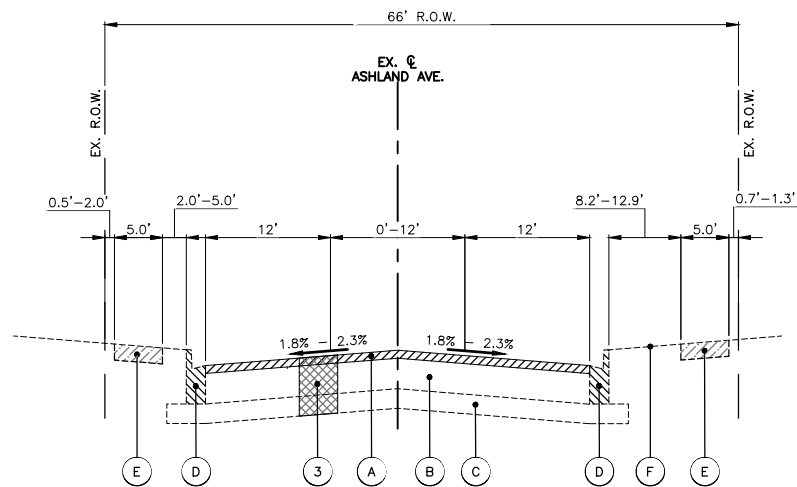

**EXISTING TYPICAL SECTION - ASHLAND AVE.**

STA: 51+00.0 - STA: 69+90.1

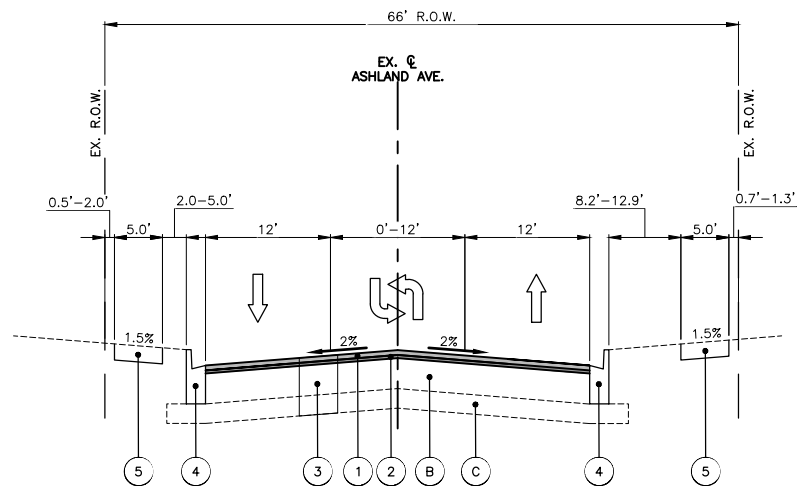

**PROPOSED TYPICAL SECTION - ASHLAND AVE.**

STA: 51+00.0 - STA: 69+90.1

**EXISTING LEGEND**

- A HOT-MIX ASPHALT SURFACE REMOVAL, 3.0"
- B EXISTING HMA PAVEMENT, 11"
- C AGGREGATE SUBBASE, 4"
- D COMBINATION CONCRETE CURB & GUTTER, VARIES FROM TYPE B-6.12 TO B-6.24
- E PORTLAND CEMENT CONCRETE SIDEWALK, 5"
- F EXISTING GROUND

NOTES:

- THE PATCHING QUANTITIES HAVE BEEN ESTIMATED BASED ON FIELD OBSERVATIONS DURING DESIGN. ACTUAL QUANTITIES TO BE DETERMINED DURING CONSTRUCTION BY THE ENGINEER.
- NO PROPOSED WORK WILL TAKE PLACE OUTSIDE OF THE EXISTING R.O.W.
- FINAL PAVEMENT ELEVATIONS SHALL REMAIN UNCHANGED IN THE FLOODPLAIN.

**PROPOSED LEGEND**

- 1 HOT-MIX ASPHALT SURFACE COURSE, MIX "D", IL-9.5, N50, 2"
- 2 POLYMERIZED HOT-MIX ASPHALT BINDER COURSE, IL-4.75, N50, 1"
- 3 CLASS D PATCHES WITH SUBBASE GRANULAR MATERIAL TYPE B, 8" (SPOT REMOVAL & REPLACEMENT AS DIRECTED BY THE ENGINEER)
- 4 COMBINATION CONCRETE CURB & GUTTER, VARIES FROM TYPE B-6.12 TO B-6.24 (SPOT REMOVAL & REPLACEMENT AS DIRECTED BY THE ENGINEER)
- 5 PCC SIDEWALK, 5" (SPOT REMOVAL & REPLACEMENT AS DIRECTED BY THE ENGINEER)

COMPANY NAME: PROJECT CONTACT: 8/19/2024 10:59 AM  
 CLIENT: Ashland Ave-Typ Sections  
 FILE NAME: Ashland Ave-Typ Sections  
 PLOT DRIVER: DWG To PDF.pc3  
 PEN TABLE: ILDOT-Standard.ctb

USER NAME = HOPPM	DESIGNED - AN	REVISED -
FILE NAME = Ashland Ave-Typ Sections	DRAWN - MH	REVISED -
PLOT SCALE = N.T.S.	CHECKED - TW	REVISED -
PLOT DATE = 8/19/2024	DATE - 03/01/2024	REVISED -

**STATE OF ILLINOIS  
DEPARTMENT OF TRANSPORTATION**

**ASHLAND AVENUE  
TYPICAL SECTIONS**

SCALE: N.T.S. SHEET NO. 02 OF 02 SHEETS STA. TO STA.

FAU RTE.	SECTION	COUNTY	TOTAL SHEETS	SHEET NO.
1650	23-00366-00-RS	KANE	24	7
CONTRACT NO. 61K66				
ILLINOIS FED. AID PROJECT				

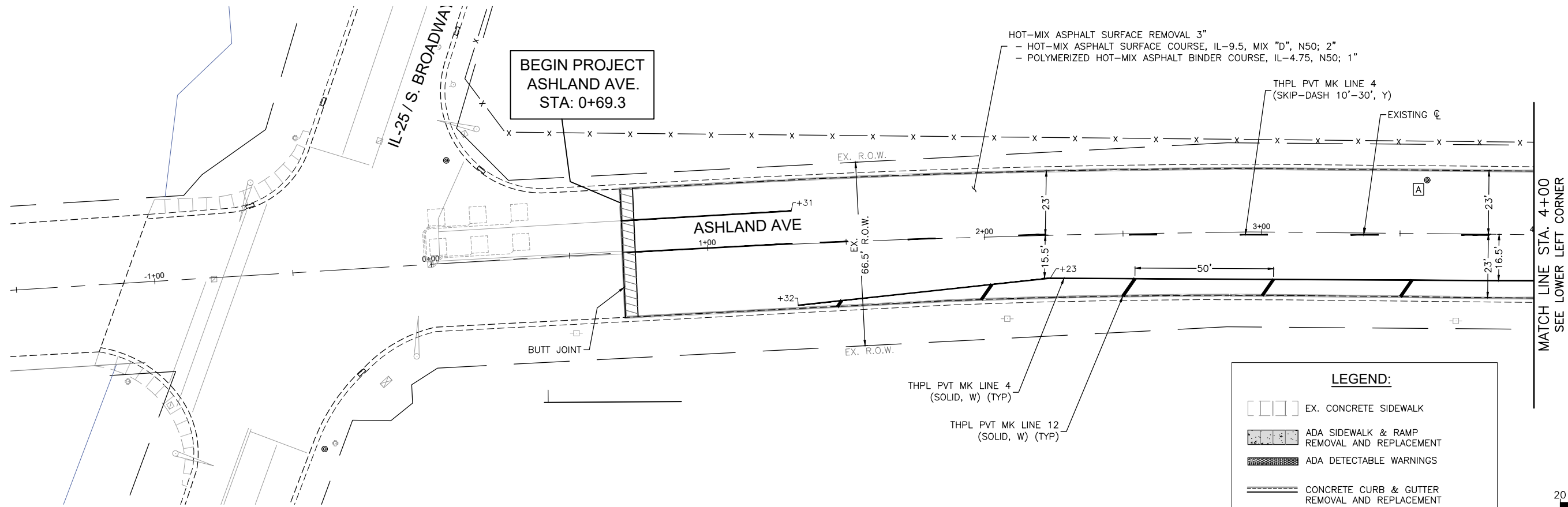

**LEGEND:**

- EX. CONCRETE SIDEWALK
- ADA SIDEWALK & RAMP REMOVAL AND REPLACEMENT
- ADA DETECTABLE WARNINGS
- CONCRETE CURB & GUTTER REMOVAL AND REPLACEMENT
- DEPRESSED CURB
- EXISTING ADA COMPLIANT CURB RAMP TO REMAIN IN PLACE
- REMOVE CURB RAMP AND DO NOT REPLACE

**NOTE:**  
 ANY SOILS GENERATED FROM CURB AND SIDEWALK REPAIRS SHALL REMAIN ON SITE IN THE RIGHT-OF-WAY. ANY SUCH SOIL SHALL BE PLACED AROUND LANDSCAPED RADIUS RETURNS OR WITHIN LANDSCAPED DITCH AREAS AS DIRECTED BY THE ENGINEER AND RESTORED.

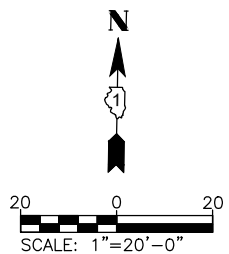
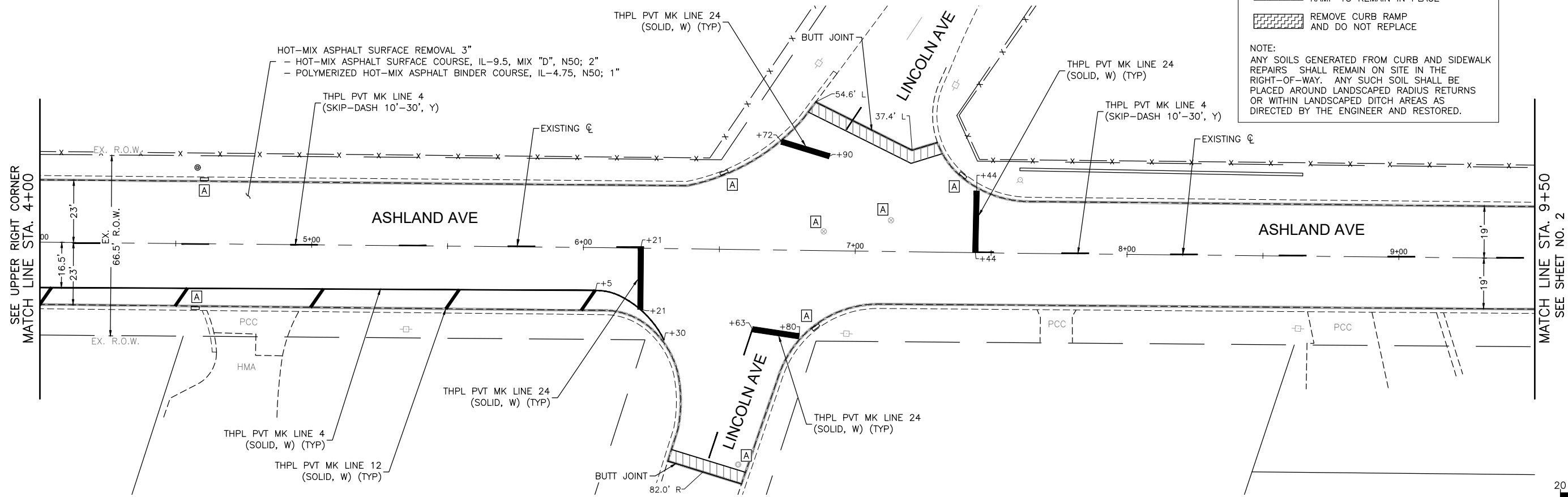
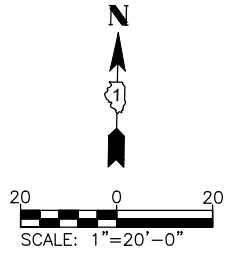

COMPANY NAME: HOPPM  
 PROJECT CONTACT: AN  
 CLIENT: ASHLAND RESURFICING  
 DATE PLOTTED: 8/19/2024 11:00 AM  
 FILE NAME: Ashland\_Resurf\_Plans\_Ph 2  
 PLOT DRIVER: DWG To PDF.pc3  
 PEN TABLE: ILDOT-Standard.ctb

USER NAME = HOPPM	DESIGNED - AN	REVISED -
FILE NAME = Ashland_Resurf_Plans_Ph 2	DRAWN - MH	REVISED -
PLOT SCALE = 1"=20'	CHECKED - TW	REVISED -
PLOT DATE = 8/19/2024	DATE - 03/01/2024	REVISED -

**STATE OF ILLINOIS  
 DEPARTMENT OF TRANSPORTATION**

**ASHLAND AVENUE  
 RESURFACING AND PAVEMENT MARKING PLAN**

SCALE: 1"=20' SHEET NO. 1 OF 7 SHEETS STA. 0+00 TO STA. 9+50

FAU RTE.	SECTION	COUNTY	TOTAL SHEETS	SHEET NO.
1650	23-00366-00-RS	KANE	24	8
CONTRACT NO. 61K66				
ILLINOIS FED. AID PROJECT				

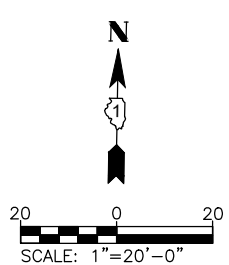
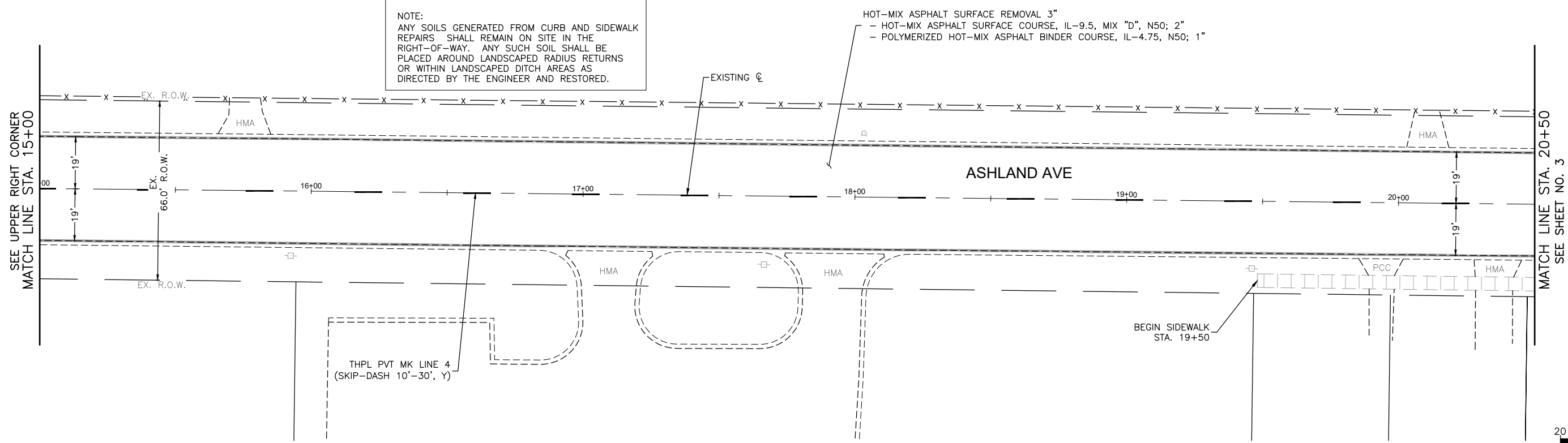
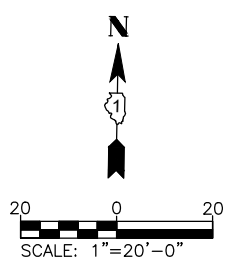
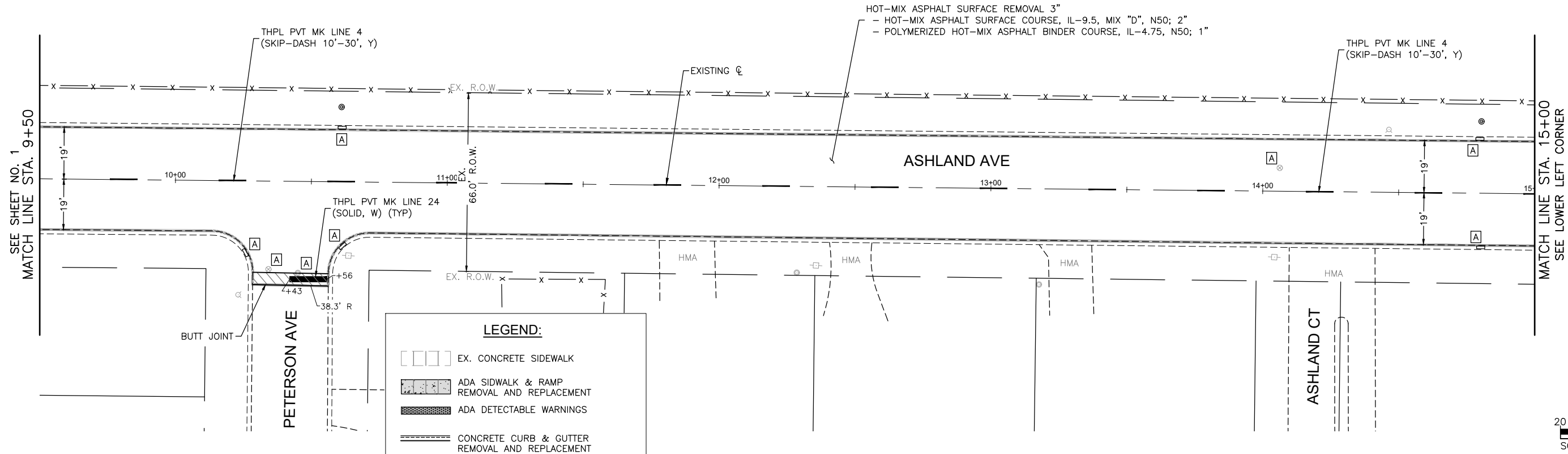

**LEGEND:**

- EX. CONCRETE SIDEWALK
- ADA SIDEWALK & RAMP REMOVAL AND REPLACEMENT
- ADA DETECTABLE WARNINGS
- CONCRETE CURB & GUTTER REMOVAL AND REPLACEMENT
- DEPRESSED CURB
- EXISTING ADA COMPLIANT CURB RAMP TO REMAIN IN PLACE
- REMOVE CURB RAMP AND DO NOT REPLACE

**NOTE:**  
 ANY SOILS GENERATED FROM CURB AND SIDEWALK REPAIRS SHALL REMAIN ON SITE IN THE RIGHT-OF-WAY. ANY SUCH SOIL SHALL BE PLACED AROUND LANDSCAPED RADIUS RETURNS OR WITHIN LANDSCAPED DITCH AREAS AS DIRECTED BY THE ENGINEER AND RESTORED.

COMPANY NAME: HOPPM  
 PROJECT CONTACT: HOPPM  
 DATE PLOTTED: 8/19/2024 11:00 AM  
 CLIENT: Ashland\_Resurf Plans\_Ph 2  
 FILE NAME: Ashland\_Resurf Plans\_Ph 2  
 PLOT DRIVER: DWG To PDF.pc3  
 PEN TABLE: ILDOT-Standard.ctb

USER NAME = HOPPM	DESIGNED - AN	REVISED -
FILE NAME = Ashland_Resurf Plans_Ph 2	DRAWN - MH	REVISED -
PLOT SCALE = 1"=20'	CHECKED - TW	REVISED -
PLOT DATE = 8/19/2024	DATE - 03/01/2024	REVISED -

**STATE OF ILLINOIS**  
**DEPARTMENT OF TRANSPORTATION**

**ASHLAND AVENUE**  
**RESURFACING AND PAVEMENT MARKING PLAN**

SCALE: 1"=20' SHEET NO. 2 OF 7 SHEETS STA. 9+50 TO STA. 20+50

FAU RTE.	SECTION	COUNTY	TOTAL SHEETS	SHEET NO.
1650	23-00366-00-RS	KANE	24	9
CONTRACT NO. 61K66				
ILLINOIS FED. AID PROJECT				



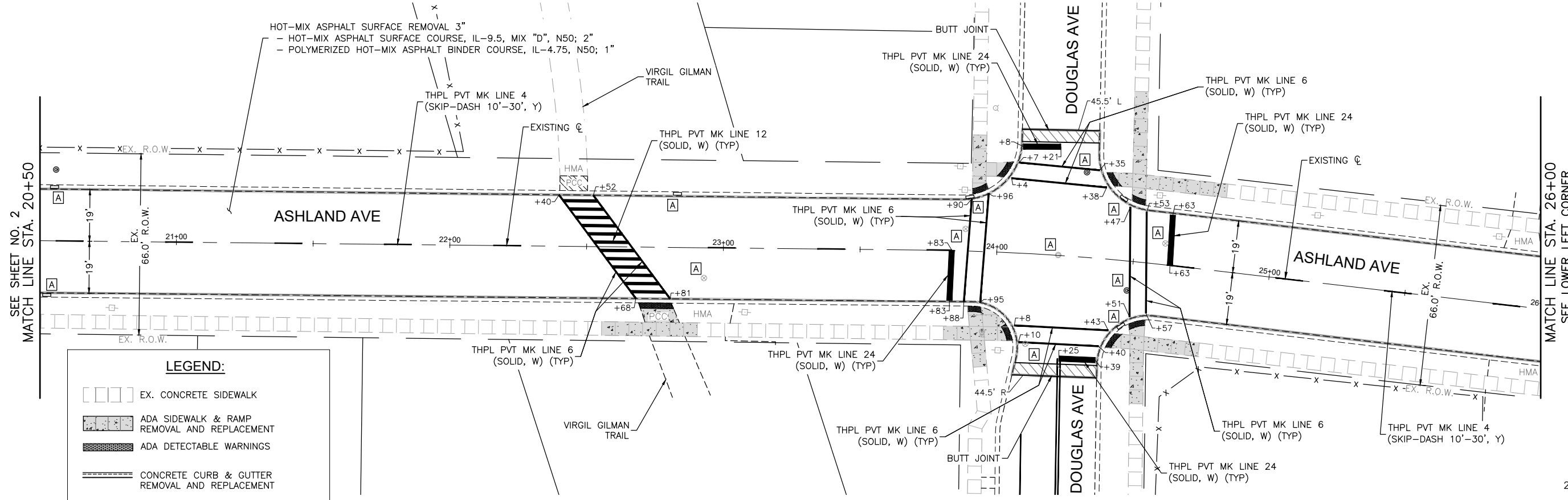

**LEGEND:**

- EX. CONCRETE SIDEWALK
- ADA SIDEWALK & RAMP REMOVAL AND REPLACEMENT
- ADA DETECTABLE WARNINGS
- CONCRETE CURB & GUTTER REMOVAL AND REPLACEMENT
- DEPRESSED CURB
- EXISTING ADA COMPLIANT CURB RAMP TO REMAIN IN PLACE
- REMOVE CURB RAMP AND DO NOT REPLACE

**NOTE:**  
 ANY SOILS GENERATED FROM CURB AND SIDEWALK REPAIRS SHALL REMAIN ON SITE IN THE RIGHT-OF-WAY. ANY SUCH SOIL SHALL BE PLACED AROUND LANDSCAPED RADIUS RETURNS OR WITHIN LANDSCAPED DITCH AREAS AS DIRECTED BY THE ENGINEER AND RESTORED.

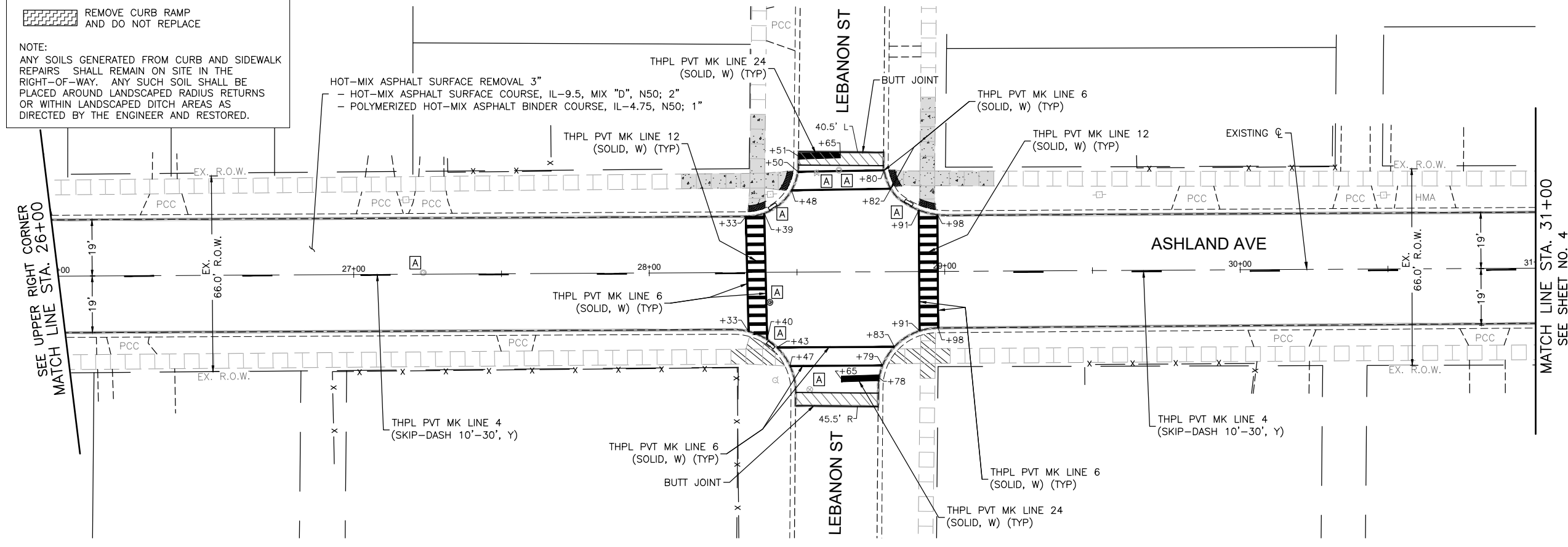

COMPANY NAME:   
 PROJECT CONTACT:   
 CLIENT:   
 DATE PLOTTED: 8/19/2024 11:00 AM   
 FILE NAME: Ashland\_Resurf Plans\_Ph 2   
 PLOT DRIVER: DWG To PDF.pc3   
 PEN TABLE: ILDOT-Standard.ctb

USER NAME = HOPPM	DESIGNED - AN	REVISED -
FILE NAME = Ashland_Resurf Plans_Ph 2	DRAWN - MH	REVISED -
PLOT SCALE = 1"=20'	CHECKED - TW	REVISED -
PLOT DATE = 8/19/2024	DATE - 03/01/2024	REVISED -

**STATE OF ILLINOIS  
 DEPARTMENT OF TRANSPORTATION**

**ASHLAND AVENUE  
 RESURFACING AND PAVEMENT MARKING PLAN**

SCALE: 1"=20' SHEET NO. 3 OF 7 SHEETS STA. 20+50 TO STA. 31+00

FAU RTE.	SECTION	COUNTY	TOTAL SHEETS	SHEET NO.
1650	23-00366-00-RS	KANE	24	10
CONTRACT NO. 61K66				
ILLINOIS FED. AID PROJECT				

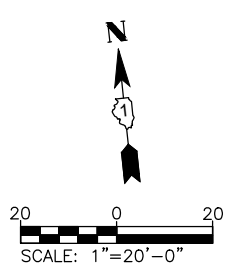
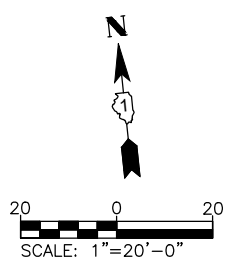
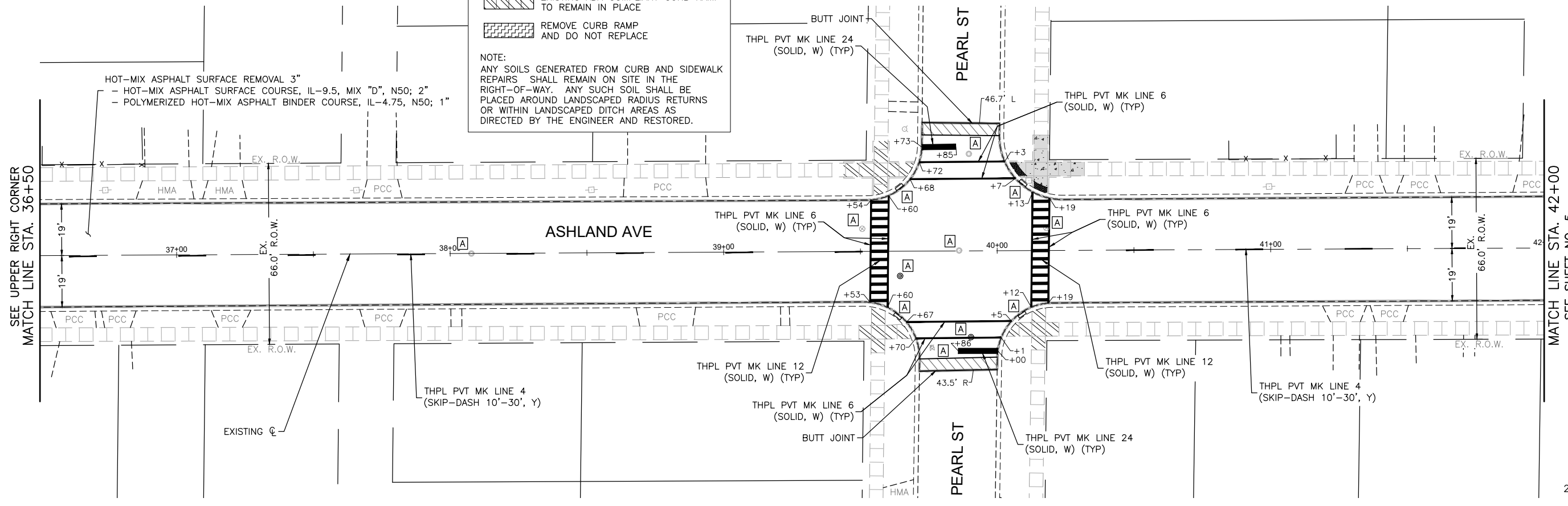
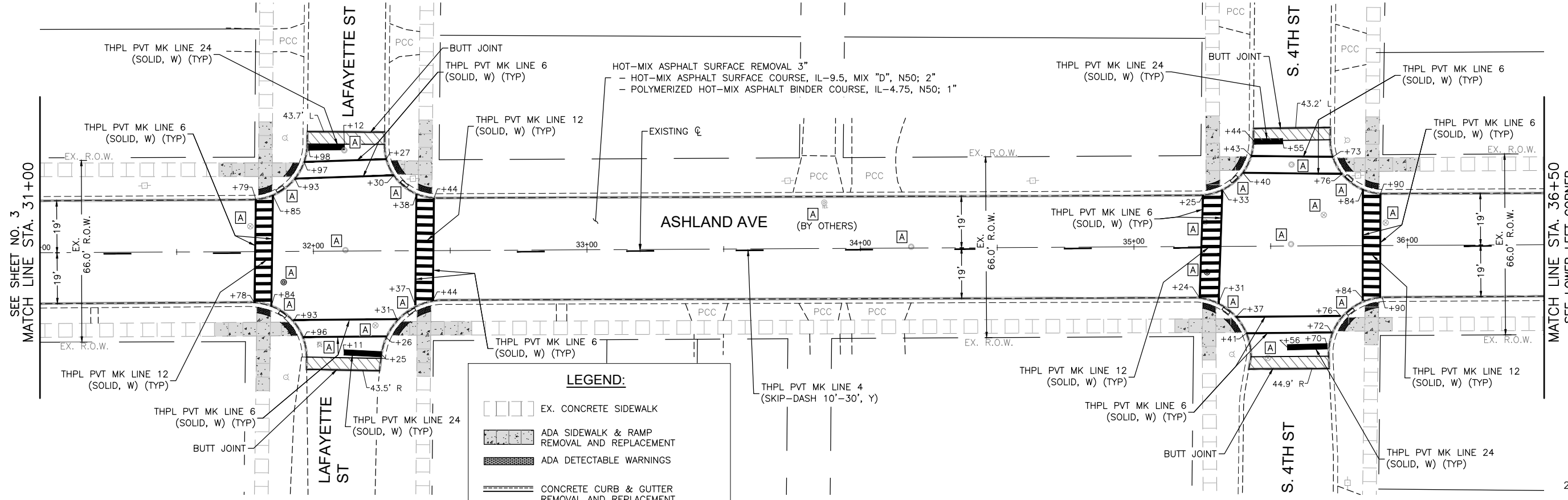

COMPANY NAME:   
 PROJECT CONTACT:   
 DATE PLOTTED: 8/19/2024 11:00 AM   
 CLIENT: Ashland\_Resurf Plans\_Ph 2   
 FILE NAME: Ashland\_Resurf Plans\_Ph 2   
 PLOT DRIVER: DWG To PDF.pc3   
 PEN TABLE: ILDOT-Standard.ctb

USER NAME = HOPPM	DESIGNED - AN	REVISED -
FILE NAME = Ashland_Resurf Plans_Ph 2	DRAWN - MH	REVISED -
PLOT SCALE = 1"=20'	CHECKED - TW	REVISED -
PLOT DATE = 8/19/2024	DATE - 03/01/2024	REVISED -

**STATE OF ILLINOIS  
 DEPARTMENT OF TRANSPORTATION**

**ASHLAND AVENUE  
 RESURFACING AND PAVEMENT MARKING PLAN**

SCALE: 1"=20' SHEET NO. 4 OF 7 SHEETS STA. 31+00 TO STA. 42+00

FAU RTE.	SECTION	COUNTY	TOTAL SHEETS	SHEET NO.
1650	23-00366-00-RS	KANE	24	11
CONTRACT NO. 61K66				
ILLINOIS FED. AID PROJECT				

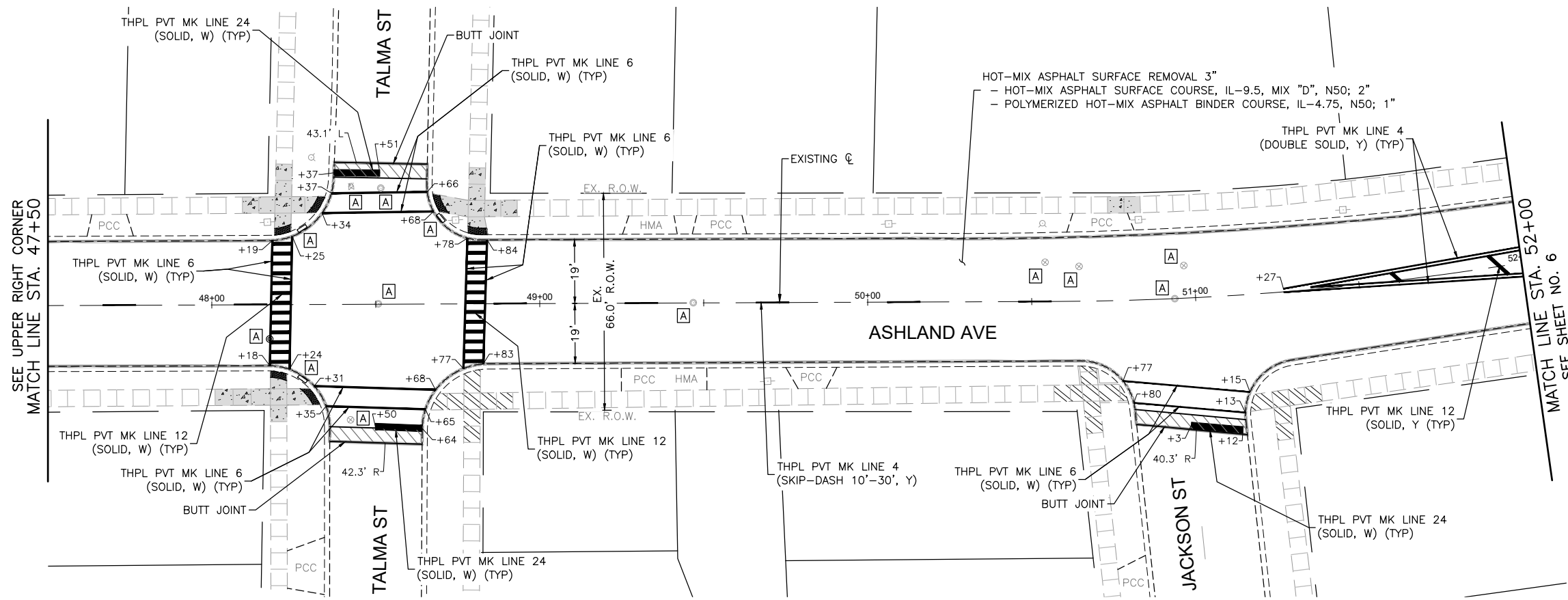
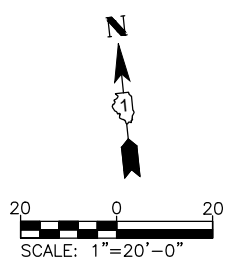
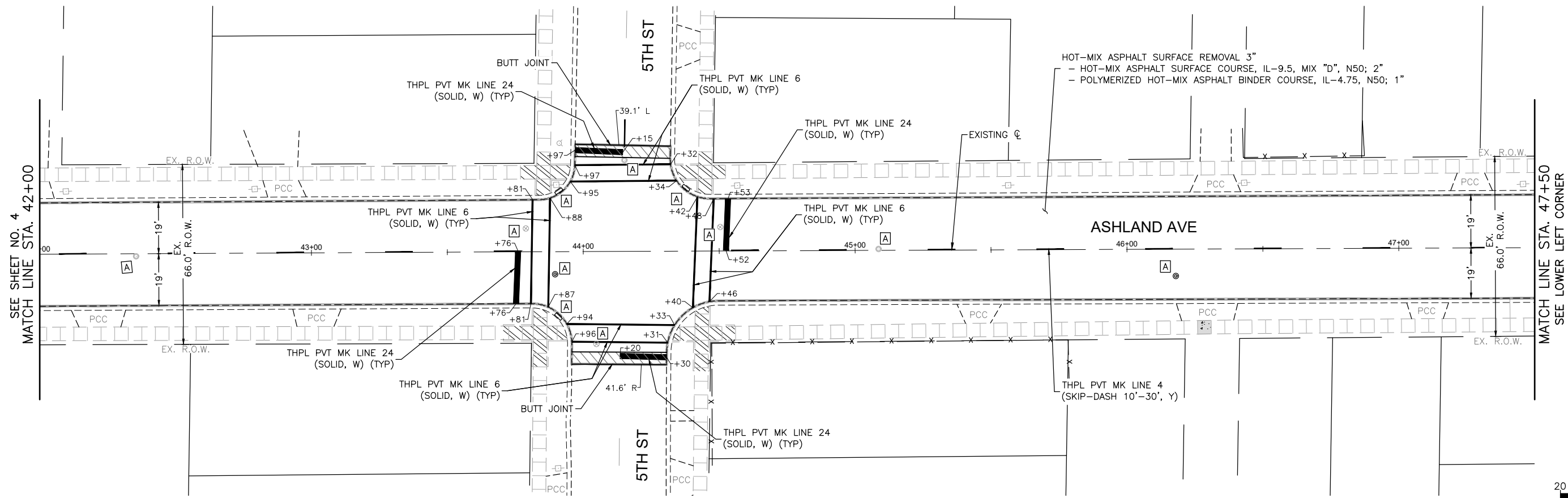

**LEGEND:**

- EX. CONCRETE SIDEWALK
- ADA SIDEWALK RAMP REMOVAL AND REPLACEMENT
- ADA DETECTABLE WARNINGS
- CONCRETE CURB & GUTTER REMOVAL AND REPLACEMENT
- DEPRESSED CURB
- EXISTING ADA COMPLIANT CURB RAMP TO REMAIN IN PLACE
- REMOVE CURB RAMP AND DO NOT REPLACE

**NOTE:**  
 ANY SOILS GENERATED FROM CURB AND SIDEWALK REPAIRS SHALL REMAIN ON SITE IN THE RIGHT-OF-WAY. ANY SUCH SOIL SHALL BE PLACED AROUND LANDSCAPED RADIUS RETURNS OR WITHIN LANDSCAPED DITCH AREAS AS DIRECTED BY THE ENGINEER AND RESTORED.

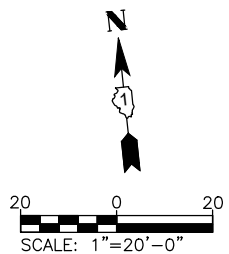

COMPANY NAME:   
 PROJECT CONTACT:   
 DATE PLOTTED: 8/19/2024 11:00 AM   
 CLIENT: Ashland\_Resurf\_Plans\_Ph 2   
 FILE NAME: Ashland\_Resurf\_Plans\_Ph 2   
 PLOT DRIVER: DWG To PDF.pc3   
 PEN TABLE: ILDOT-Standard.ctb

USER NAME = HOPPM	DESIGNED - AN	REVISED -
FILE NAME = Ashland_Resurf_Plans_Ph 2	DRAWN - MH	REVISED -
PLOT SCALE = 1"=20'	CHECKED - TW	REVISED -
PLOT DATE = 8/19/2024	DATE - 03/01/2024	REVISED -

**STATE OF ILLINOIS**  
**DEPARTMENT OF TRANSPORTATION**

**ASHLAND AVENUE**  
**RESURFACING AND PAVEMENT MARKING PLAN**

SCALE: 1"=20' SHEET NO. 5 OF 7 SHEETS STA. 42+00 TO STA. 52+00

FAU RTE.	SECTION	COUNTY	TOTAL SHEETS	SHEET NO.
1650	23-00366-00-RS	KANE	24	12
CONTRACT NO. 61K66				
ILLINOIS FED. AID PROJECT				

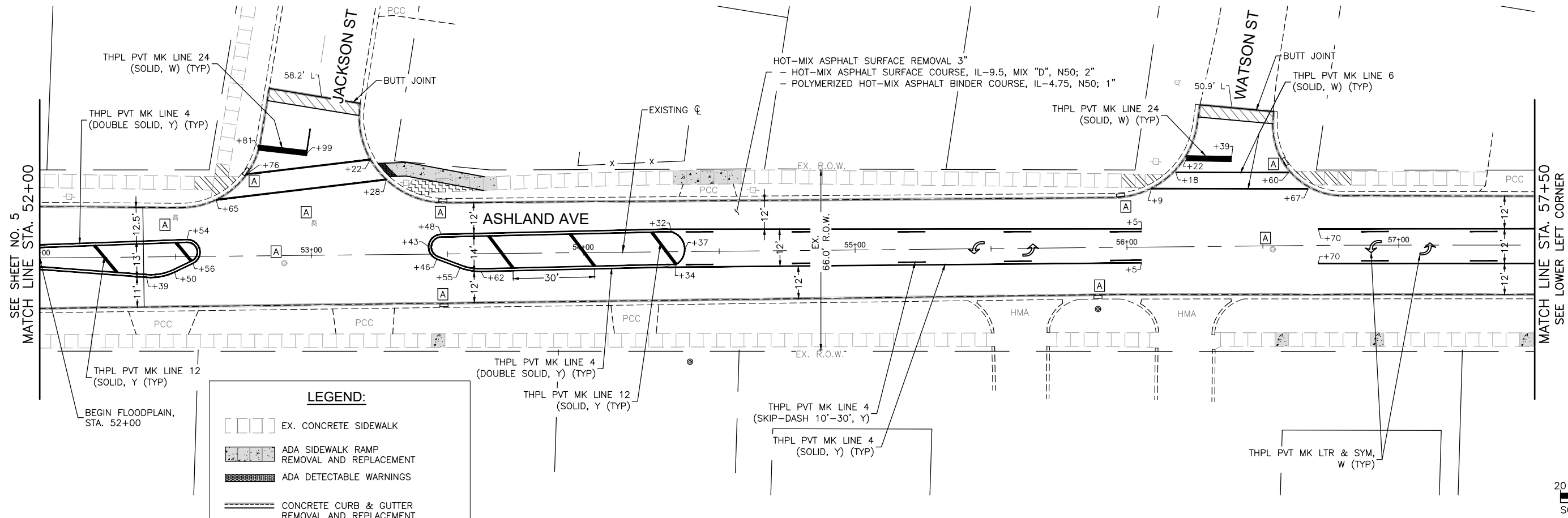

**LEGEND:**

- EX. CONCRETE SIDEWALK
- ADA SIDEWALK RAMP REMOVAL AND REPLACEMENT
- ADA DETECTABLE WARNINGS
- CONCRETE CURB & GUTTER REMOVAL AND REPLACEMENT
- DEPRESSED CURB
- EXISTING ADA COMPLIANT CURB RAMP TO REMAIN IN PLACE
- REMOVE CURB RAMP AND DO NOT REPLACE

**NOTE:**  
 ANY SOILS GENERATED FROM CURB AND SIDEWALK REPAIRS SHALL REMAIN ON SITE IN THE RIGHT-OF-WAY. ANY SUCH SOIL SHALL BE PLACED AROUND LANDSCAPED RADIUS RETURNS OR WITHIN LANDSCAPED DITCH AREAS AS DIRECTED BY THE ENGINEER AND RESTORED.

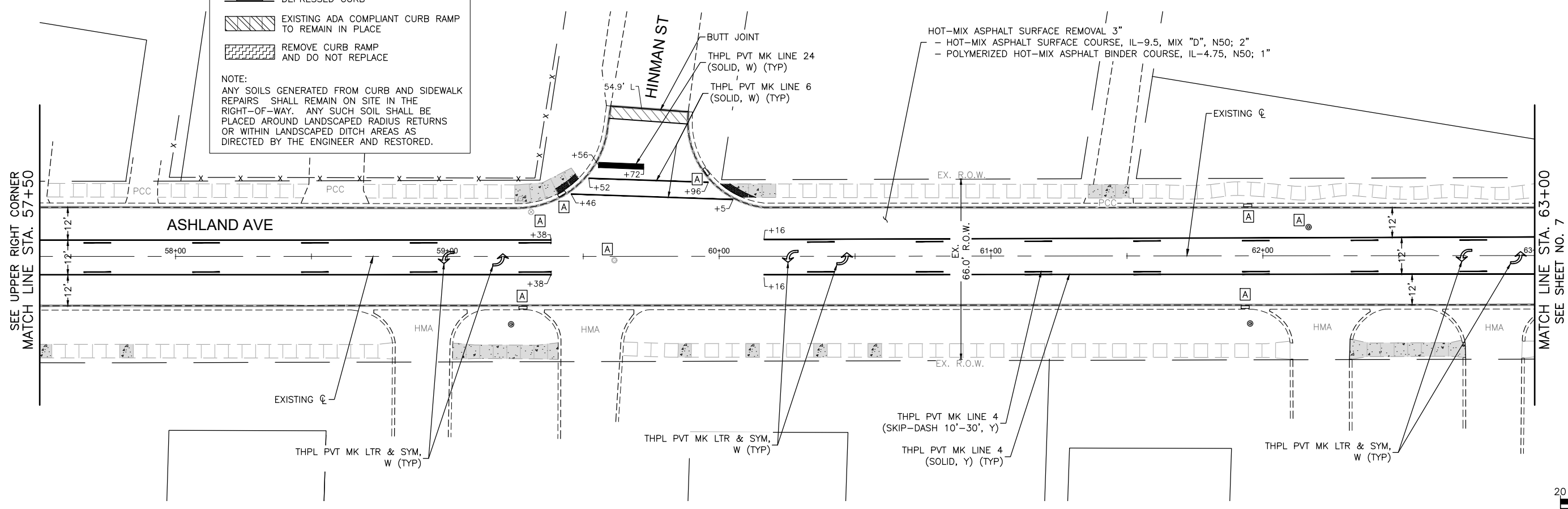
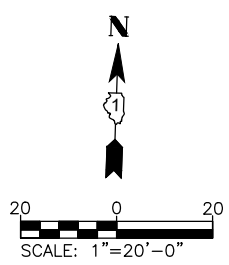

**LEGEND:**

- EX. CONCRETE SIDEWALK
- ADA SIDEWALK RAMP REMOVAL AND REPLACEMENT
- ADA DETECTABLE WARNINGS
- CONCRETE CURB & GUTTER REMOVAL AND REPLACEMENT
- DEPRESSED CURB
- EXISTING ADA COMPLIANT CURB RAMP TO REMAIN IN PLACE
- REMOVE CURB RAMP AND DO NOT REPLACE

**NOTE:**  
 ANY SOILS GENERATED FROM CURB AND SIDEWALK REPAIRS SHALL REMAIN ON SITE IN THE RIGHT-OF-WAY. ANY SUCH SOIL SHALL BE PLACED AROUND LANDSCAPED RADIUS RETURNS OR WITHIN LANDSCAPED DITCH AREAS AS DIRECTED BY THE ENGINEER AND RESTORED.

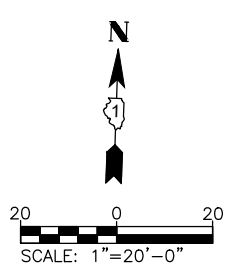

COMPANY NAME:   
 PROJECT CONTACT:   
 CLIENT:   
 DATE PLOTTED: 8/19/2024 11:00 AM   
 FILE NAME: Ashland\_Resurf Plans\_Ph 2   
 PLOT DRIVER: DWG To PDF.pc3   
 PEN TABLE: ILDOT-Standard.ctb

USER NAME = HOPPM	DESIGNED - AN	REVISED -
FILE NAME = Ashland_Resurf Plans_Ph 2	DRAWN - MH	REVISED -
PLOT SCALE = 1"=20'	CHECKED - TW	REVISED -
PLOT DATE = 8/19/2024	DATE - 03/01/2024	REVISED -

**STATE OF ILLINOIS  
 DEPARTMENT OF TRANSPORTATION**

**ASHLAND AVENUE  
 RESURFACING AND PAVEMENT MARKING PLAN**

SCALE: 1"=20' SHEET NO. 6 OF 7 SHEETS STA. 52+00 TO STA. 63+00

FAU RTE.	SECTION	COUNTY	TOTAL SHEETS	SHEET NO.
1650	23-00366-00-RS	KANE	24	13
CONTRACT NO. 61K66				
ILLINOIS FED. AID PROJECT				

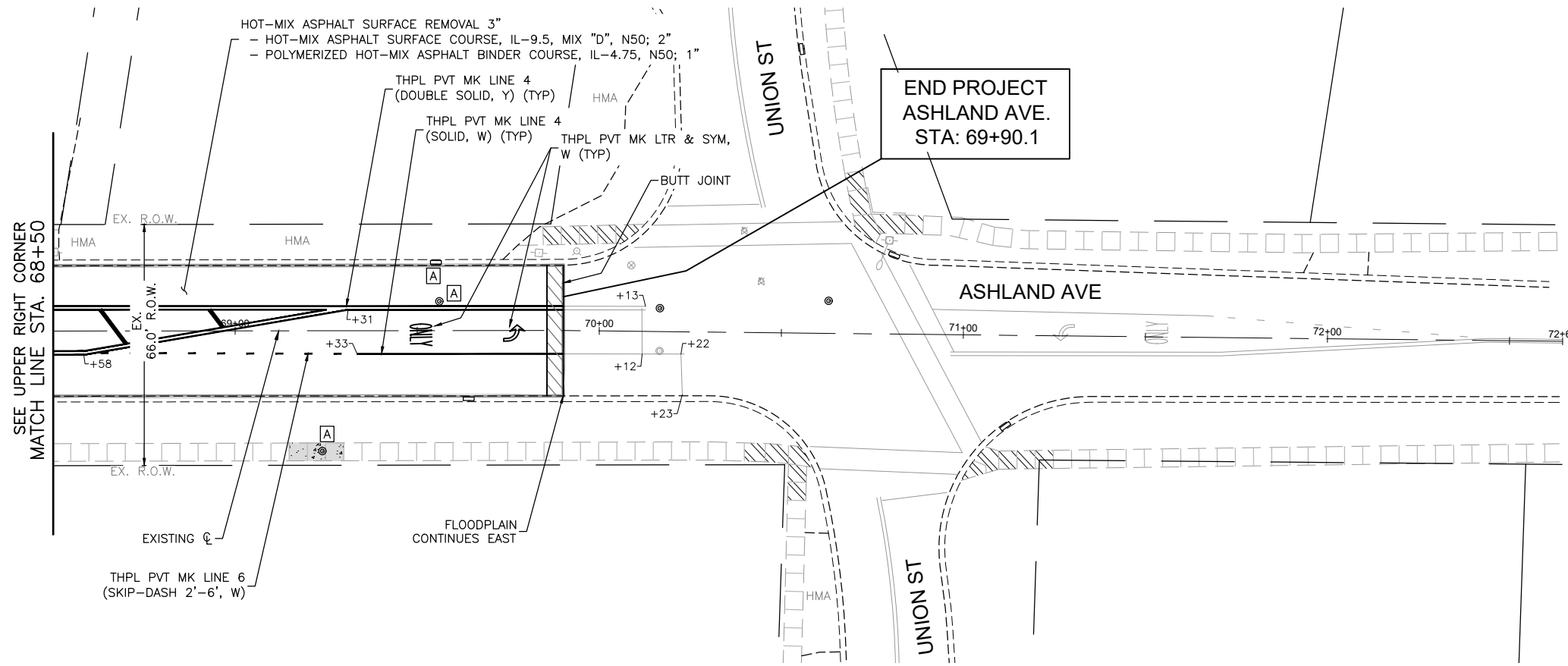
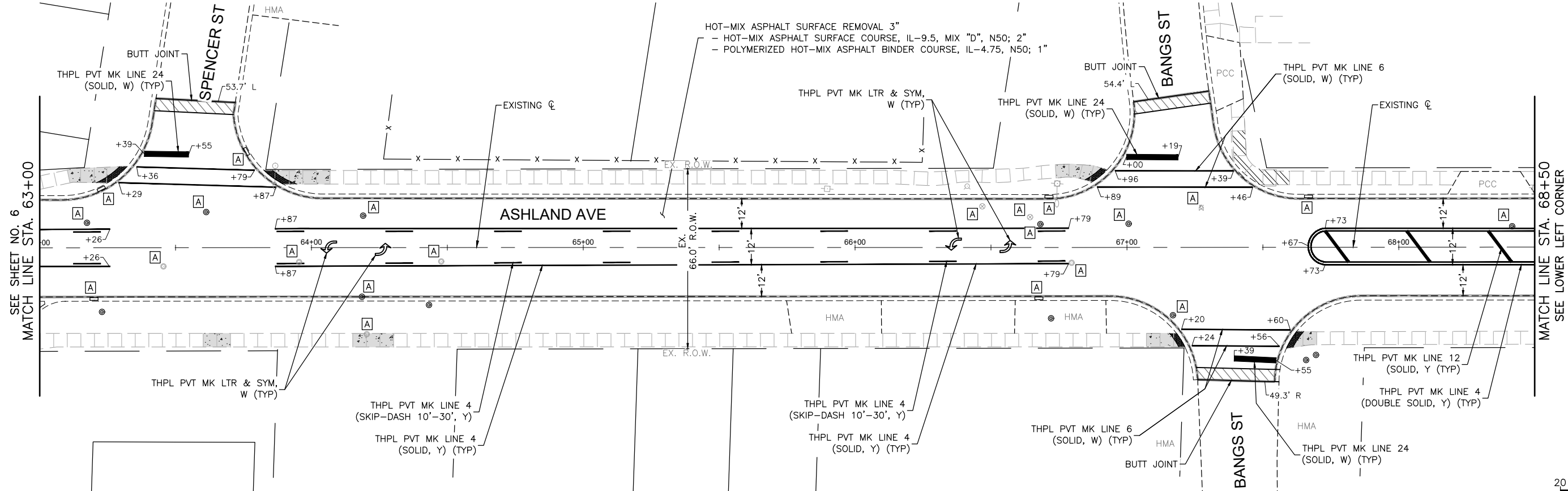

**LEGEND:**

- [ ] EX. CONCRETE SIDEWALK
- [ ] ADA SIDEWALK RAMP REMOVAL AND REPLACEMENT
- [ ] ADA DETECTABLE WARNINGS
- [ ] CONCRETE CURB & GUTTER REMOVAL AND REPLACEMENT
- [ ] DEPRESSED CURB
- [ ] EXISTING ADA COMPLIANT CURB RAMP TO REMAIN IN PLACE
- [ ] REMOVE CURB RAMP AND DO NOT REPLACE

**NOTE:**  
 ANY SOILS GENERATED FROM CURB AND SIDEWALK REPAIRS SHALL REMAIN ON SITE IN THE RIGHT-OF-WAY. ANY SUCH SOIL SHALL BE PLACED AROUND LANDSCAPED RADIUS RETURNS OR WITHIN LANDSCAPED DITCH AREAS AS DIRECTED BY THE ENGINEER AND RESTORED.

COMPANY NAME:   
 PROJECT CONTACT:   
 CLIENT:   
 DATE PLOTTED: 8/19/2024 11:00 AM   
 FILE NAME: Ashland\_Resurf Plans\_Ph 2   
 PLOT DRIVER: DWG To PDF.pc3   
 PEN TABLE: ILDOT-Standard.ctb

USER NAME = HOPPM	DESIGNED - AN	REVISED -
FILE NAME = Ashland_Resurf Plans_Ph 2	DRAWN - MH	REVISED -
PLOT SCALE = 1"=20'	CHECKED - TW	REVISED -
PLOT DATE = 8/19/2024	DATE - 03/01/2024	REVISED -

**STATE OF ILLINOIS**  
**DEPARTMENT OF TRANSPORTATION**

**ASHLAND AVENUE**  
**RESURFACING AND PAVEMENT MARKING PLAN**

SCALE: 1"=20' SHEET NO. 7 OF 7 SHEETS STA. 63+00 TO STA. 70+00

FAU RTE.	SECTION	COUNTY	TOTAL SHEETS	SHEET NO.
1650	23-00366-00-RS	KANE	24	14
CONTRACT NO. 61K66				
ILLINOIS FED. AID PROJECT				



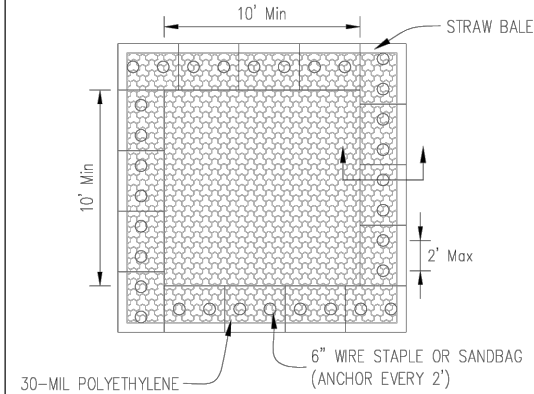

PLAN VIEW

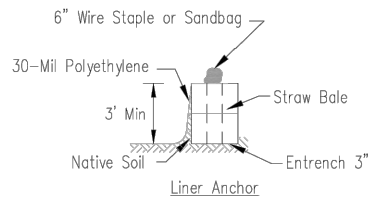

STRAW BALE ANCHOR SECTIONS

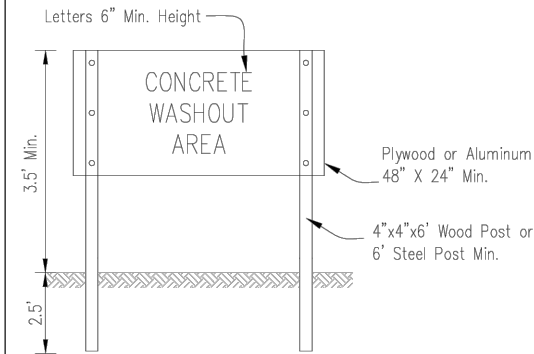

SIGN DETAIL

NOTES:

- Maintaining temporary concrete washout facilities shall include removing and disposing of hardened concrete and/or slurry and returning the facilities to a functional condition.
- Facility shall be cleaned or reconstructed in a new area once washout becomes two-thirds full.
- Each straw bale is to be staked in place using (2) 2"x2"x4" wooden stakes.

INLET PROTECTION - PAVED AREAS  
CURB PROTECTION

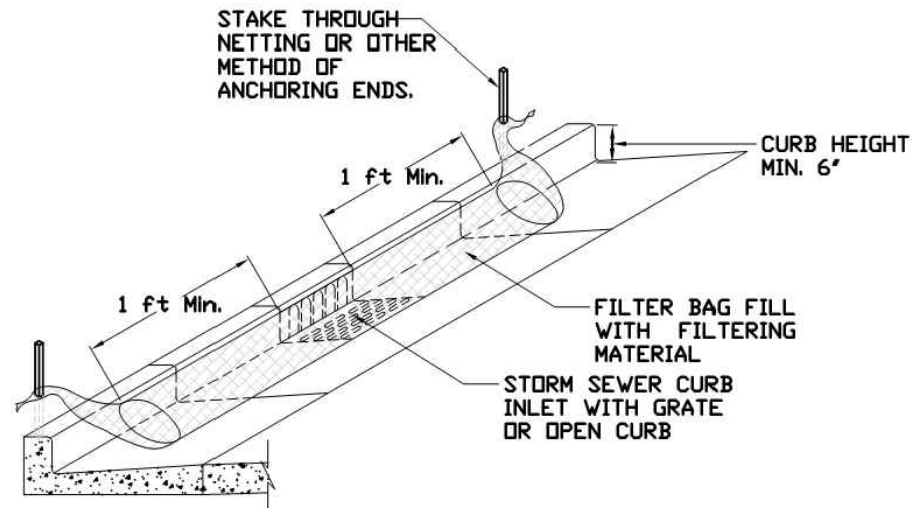

INLET PROTECTION - PAVED AREAS  
DROP-IN PROTECTION

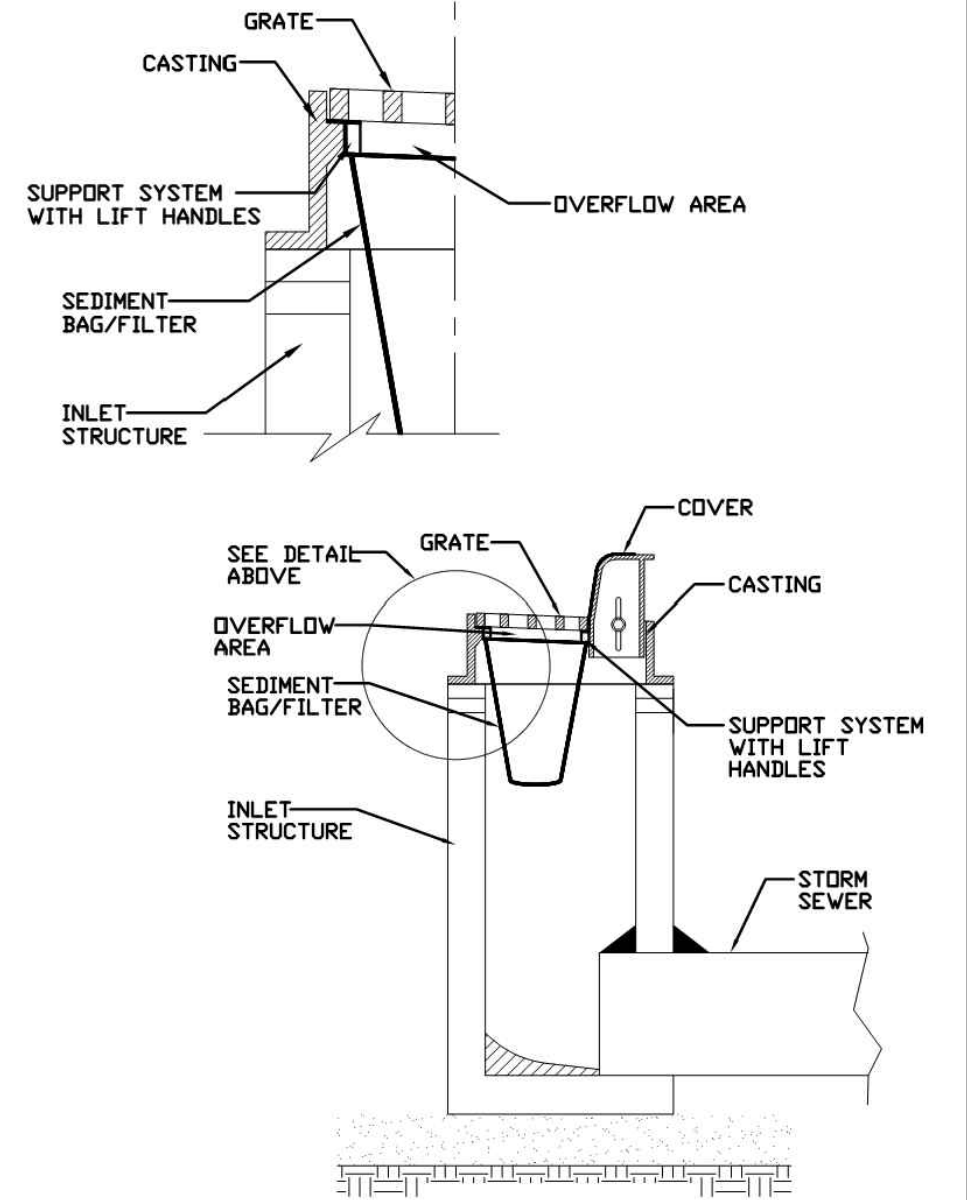

TEMPORARY CONCRETE  
WASHOUT FACILITY - STRAW BALE

Project	_____	Date	_____
Designed	_____	Date	_____
Drawn	B. JOHNSON	Date	6/08
Checked	_____	Date	_____
Approved	_____	Date	_____



STANDARD DWG. NO.  
**IUM-561C**  
SHEET 1 OF 1  
DATE 01-11-11

Project	_____	Date	_____
Designed	_____	Date	_____
Checked	_____	Date	_____
Approved	_____	Date	_____



STANDARD DWG. NO.  
**IUM-561D**  
SHEET 1 OF 1  
DATE 01-11-11

COMPANY NAME: \_\_\_\_\_  
PROJECT CONTACT: \_\_\_\_\_  
CLIENT: \_\_\_\_\_  
DATE PLOTTED: 8/19/2024 11:00 AM  
FILE NAME: Ashland-Details  
PLOT DRIVER: DWG To PDF.pc3  
PEN TABLE: SEC-Standard.ctb

USER NAME = HOPPM	DESIGNED - AN	REVISED -
FILE NAME = Ashland-Details	DRAWN - MH	REVISED -
PLOT SCALE = N.T.S.	CHECKED - TW	REVISED -
PLOT DATE = 8/19/2024	DATE - 03/01/2024	REVISED -

STATE OF ILLINOIS  
DEPARTMENT OF TRANSPORTATION

EROSION CONTROL DETAILS

SCALE: N.T.S. SHEET NO. 01 OF 01 SHEETS STA. \_\_\_\_\_ TO STA. \_\_\_\_\_

FAU RTE.	SECTION	COUNTY	TOTAL SHEETS	SHEET NO.
1650	23-00366-00-RS	KANE	24	15
CONTRACT NO. 61K66				
ILLINOIS FED. AID PROJECT				

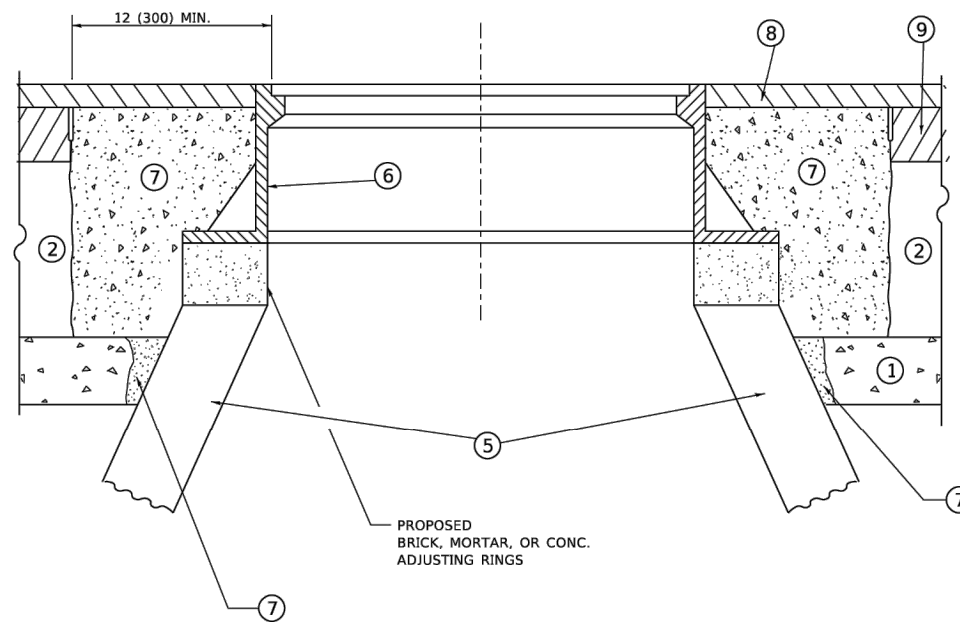
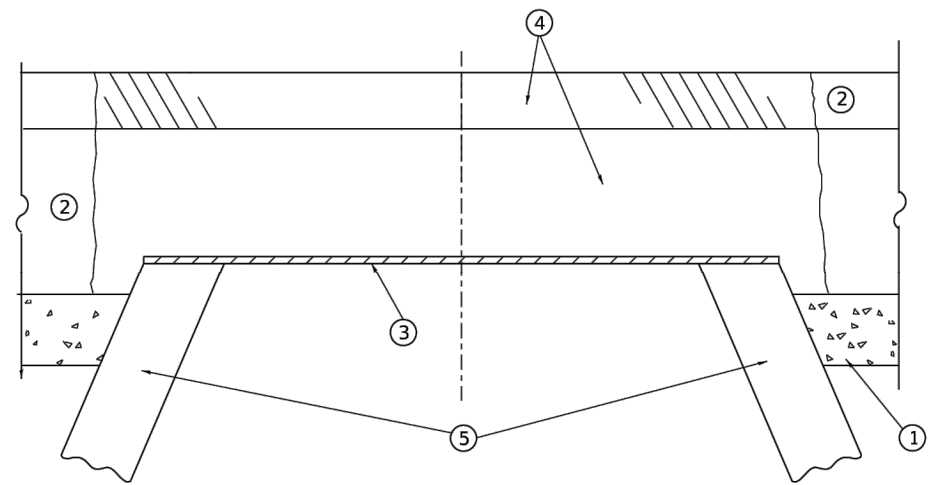

**DETAILS FOR FRAMES AND LIDS ADJUSTMENT  
WITH MILLING**

**NOTES**

- EXISTING BROKEN FRAMES AND LIDS SHALL BE REMOVED AND DISPOSED OF BY THE CONTRACTOR AND SHALL BE REPLACED AS DIRECTED BY THE ENGINEER. REPLACEMENT FRAMES AND LIDS WILL BE PAID FOR IN ACCORDANCE WITH ARTICLE 109.04 OF THE STANDARD SPECIFICATIONS UNLESS A SEPARATE PAY ITEM HAS BEEN PROVIDED.
- IF THE EXISTING LIDS ARE OPEN, THE FRAME WILL BE ADJUSTED TO THE ELEVATION OF THE MILLED PAVEMENT SURFACE PRIOR TO THE MILLING OPERATION. THE FRAME WILL NOT BE REMOVED AND COVERED BY THE METAL PLATE.
- CITY OF CHICAGO CASTINGS ARE THE PROPERTY OF THE CITY AND THE CONTRACTOR SHALL NOTIFY THE CITY FOR REMOVAL AND DISPOSITION OF THE CASTINGS.
- THE METAL PLATE USED TO COVER THE STRUCTURE SHALL REMAIN THE PROPERTY OF THE CONTRACTOR.
- THE CONTRACTOR SHALL REMOVE ALL TRAFFIC CONTROL DEVICES BY THE END OF EACH WORK SHIFT.

**CONSTRUCTION PROCEDURES**

**STAGE 1 (BEFORE PAVEMENT MILLING)**

- REMOVE A MINIMUM OF 12 (300) OF THE PAVEMENT FROM AROUND THE STRUCTURE.
- REMOVE THE EXISTING FRAME AND LID FROM THE STRUCTURE.
- COVER THE STRUCTURE OPENING WITH A 36 (900) DIAMETER METAL PLATE.
- BACKFILL WITH CRUSHED STONE AND HMA SURFACE MIX APPROVED BY THE ENGINEER. (MIN. 3 (80) HMA TO REMAIN AFTER MILLING).

**STAGE 2 (AFTER PAVEMENT MILLING)**

- REMOVE THE HMA SURFACE MIX AND CRUSHED STONE.
- INSTALL THE FRAME AND LID; ADJUST THE FRAME TO ITS FINAL SURFACE ELEVATION.
- THE SURROUNDING SPACE SHALL BE FILLED WITH CLASS PP-2\* CONCRETE TO THE ELEVATION OF THE SURFACE OF THE EXISTING BASE COURSE OR THE BINDER COURSE.

\* UNLESS OTHERWISE SPECIFIED IN THE PLANS.

THE PROCEDURE EXPLAINED ABOVE SHALL CONFORM TO THE APPLICABLE PORTIONS OF SECTIONS 353, 406, 602, AND 603 OF THE STANDARD SPECIFICATIONS EXCEPT THAT "THE CONTRACTOR SHALL ADJUST THE STRUCTURES TO THE FINISHED PAVEMENT ELEVATION NO MORE THAN 5 CALENDAR DAYS PRIOR TO PLACEMENT OF THE FINAL LIFT OF SURFACE UNLESS APPROVED BY THE ENGINEER."

**LEGEND**

- |  |                               |
|--|-------------------------------|
| ① SUB-BASE GRANULAR MATERIAL                 | ⑥ FRAME AND LID (SEE NOTES)   |
| ② EXISTING PAVEMENT                          | ⑦ CLASS PP-2* CONCRETE        |
| ③ 36 (900) DIAMETER METAL PLATE              | ⑧ PROPOSED HMA SURFACE COURSE |
| ④ PROPOSED CRUSHED STONE AND HMA SURFACE MIX | ⑨ PROPOSED HMA BINDER COURSE  |
| ⑤ EXISTING STRUCTURE                         |                               |

**LOCATION OF STRUCTURES**

THE CONTRACTOR WILL BE REQUIRED TO KEEP A RECORD OF THE LOCATIONS OF THE BURIED STRUCTURES ACCORDING TO THE STATION AND DISTANCE LEFT OR RIGHT OF THE CENTERLINE OF PAVEMENT. UPON COMPLETION OF THE WORK, THE CONTRACTOR WILL DELIVER THE RECORD TO THE ENGINEER.

**BASIS OF PAYMENT**

- REMOVING FRAMES AND LIDS ON DRAINAGE AND UTILITY STRUCTURES IN THE PAVEMENT PRIOR TO MILLING, AND ADJUSTING TO FINAL GRADE PRIOR TO PLACING THE SURFACE COURSE, WILL BE PAID FOR AT THE CONTRACT UNIT PRICE EACH FOR "FRAMES AND LIDS TO BE ADJUSTED (SPECIAL)."
- THIS WORK WILL NOT BE PAID FOR WHEN DRAINAGE AND UTILITY STRUCTURES ARE SPECIFIED FOR PAYMENT AS STRUCTURE RECONSTRUCTION.
- NEW FRAMES AND LIDS, WHEN SPECIFIED, WILL BE PAID FOR SEPARATELY.
- WHEN STRUCTURES ARE TO BE ADJUSTED OR RECONSTRUCTED, THE LOWERING AND RAISING OF THE FRAMES AND LIDS WILL NOT BE PAID FOR SEPARATELY BUT WILL BE INCLUDED IN THE COST OF THE CORRESPONDING PAY ITEM.

ALL DIMENSIONS ARE IN INCHES (MILLIMETERS) UNLESS OTHERWISE SHOWN

**STATE OF ILLINOIS  
DEPARTMENT OF TRANSPORTATION**

**DETAILS FOR  
FRAMES AND LIDS ADJUSTMENT WITH MILLING**

USER NAME = Lawrence.DeManche	DESIGNED - R. SHAH	REVISED - R. BORO 03-09-11
	DRAWN -	REVISED - R. BORO 12-06-11
PLOT SCALE = 100.0000' / in.	CHECKED -	REVISED - K. SMITH 11-18-22
PLOT DATE = 9/15/2023	DATE - 10-25-94	REVISED - K. SMITH 09-15-23

SCALE: NONE	SHEET 1 OF 1 SHEETS	STA. TO STA.
-------------	---------------------	--------------

F.A. RTE.	SECTION	COUNTY	TOTAL SHEETS	SHEET NO.
1650	23-00366-00-RS	KANE	24	16
BD600-03 (BD-08)			CONTRACT NO. 61K66	
ILLINOIS FED. AID PROJECT				

FILE NAME: W:\BIDDING\23\100000.dgn









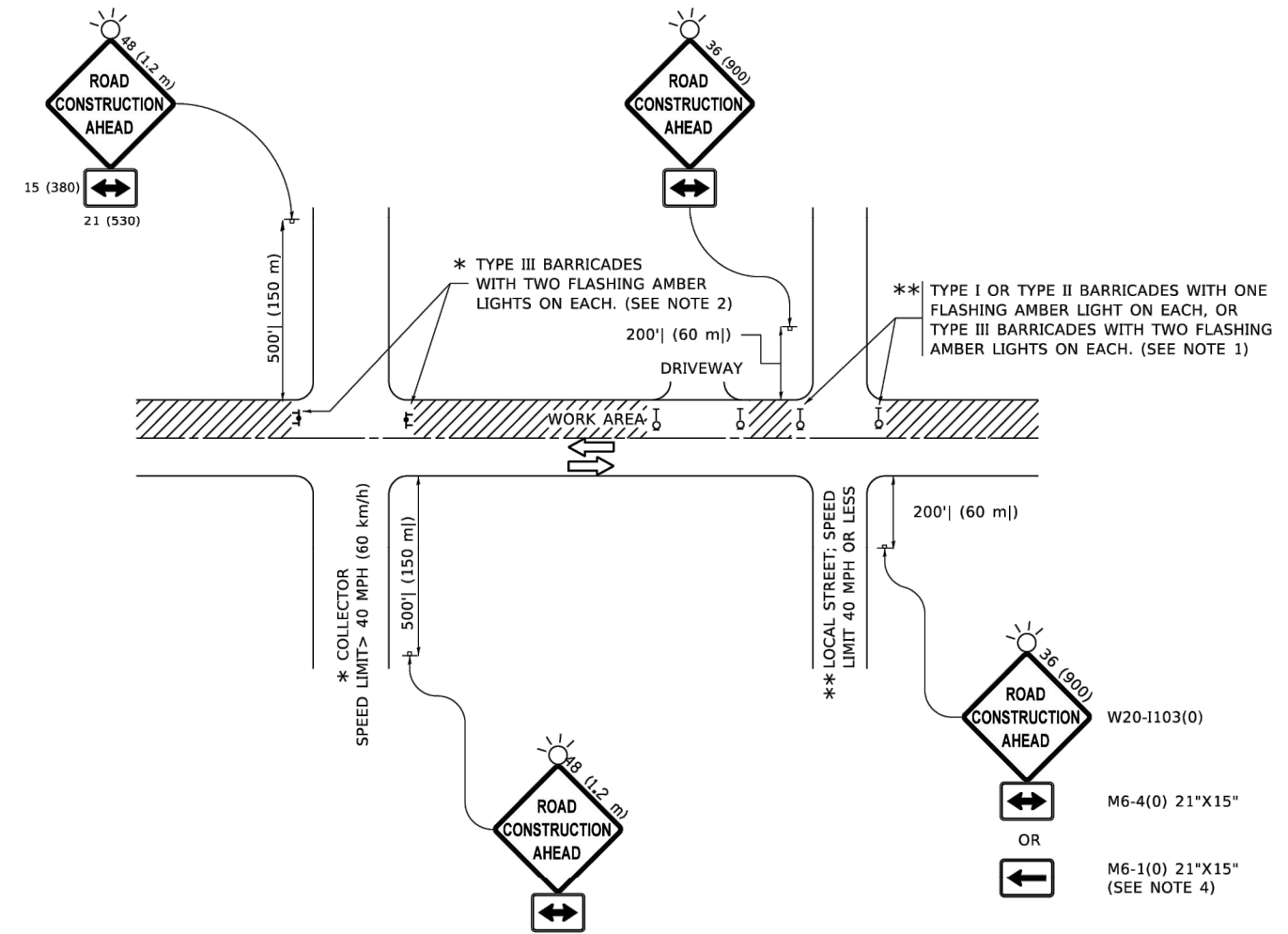

**NOTES:**

1. SIDE ROAD WITH A SPEED LIMIT OF 40 MPH (60 km/h) OR LESS AS SHOWN ON THE DRAWING AND AS DIRECTED BY THE ENGINEER:
  - a) ONE "ROAD CONSTRUCTION AHEAD" SIGN 36 x 36 (900x900) WITH A FLASHER MOUNTED ON IT APPROXIMATELY 200' (60 m) IN ADVANCE OF THE MAIN ROUTE.
  - b) THE CLOSED PORTION OF THE MAIN ROUTE SHALL BE PROTECTED BY BLOCKING WITH TYPE I, TYPE II OR TYPE III BARRICADES, 1/3 OF THE CROSS SECTION OF THE CLOSED PORTION.
2. SIDE ROAD WITH A SPEED LIMIT GREATER THAN 40 MPH (60 km/h) AS SHOWN ON THE DRAWING AND AS DIRECTED BY THE ENGINEER:
  - a) ONE "ROAD CONSTRUCTION AHEAD" SIGN 48 x 48 (1.2 m x 1.2 m) WITH A FLASHER MOUNTED ON IT APPROXIMATELY 500' (150 m) IN ADVANCE OF THE MAIN ROUTE.
  - b) BLOCKING WITH TYPE III BARRICADES, 1/2 OF THE CROSS SECTION OF THE CLOSED PORTION.
3. CONES MAY BE SUBSTITUTED FOR BARRICADES OR DRUMS AT HALF THE SPACING DURING DAY OPERATIONS. CONES SHALL BE A MINIMUM OF 28 (710) IN HEIGHT.
4. WHEN THE SIDE ROAD LIES BETWEEN THE BEGINNING OF THE MAINLINE AND THE WORK ZONE, A SINGLE HEADED ARROW (M6-1) SHALL BE USED IN LIEU OF THE DOUBLE HEADED ARROW (M6-4).
5. WHEN WORK IS BEING PERFORMED ON A SIDE ROAD OR DRIVEWAY, FOLLOW THE APPLICABLE STANDARD(S). THE DIRECTIONAL ARROW (M6-1 OR M6-4) SHALL BE COVERED OR REMOVED WHEN NO LONGER CONSISTENT WITH THE TRAFFIC CONTROL SET-UP.
6. ADVANCE WARNING SIGNS ARE TO BE OMITTED ON DRIVEWAYS UNLESS OTHERWISE SPECIFIED IN THE PLANS OR BY THE ENGINEER.
7. THE TRAFFIC CONTROL AND PROTECTION FOR SIDE ROADS, INTERSECTIONS, AND DRIVEWAYS SHALL BE INCLUDED IN THE COST OF SPECIFIED TRAFFIC CONTROL STANDARDS OR ITEMS.

All dimensions are in inches (millimeters) unless otherwise shown.

FILE NAME: p:\1\dot-pw-bentley.com-PW\DOT\Documents\DOT\_Offices\District\_1\Projects\Dist1\Stz23\4\CAD\at\CAD\sheet1c10.dgn

USER NAME = Lawrence.DeManche	DESIGNED - L.H.A.	REVISED - T. RAMMACHER 01-06-00
	DRAWN -	REVISED - A. SCHUETZE 07-01-13
PLOT SCALE = 100.0000' / in.	CHECKED -	REVISED - A. SCHUETZE 09-15-16
PLOT DATE = 5/3/2024	DATE - 06-89	REVISED - D. SENDERAK 05-03-24

**STATE OF ILLINOIS  
DEPARTMENT OF TRANSPORTATION**

<b>TRAFFIC CONTROL AND PROTECTION FOR SIDE ROADS, INTERSECTIONS, AND DRIVEWAYS</b>			
SCALE: NONE	SHEET 1 OF 1 SHEETS	STA.	TO STA.

F.A. RTE.	SECTION	COUNTY	TOTAL SHEETS	SHEET NO.
1650	23-00366-00-RS	KANE	24	20
<b>TC-10</b>			CONTRACT NO. 61K66	
ILLINOIS FED. AID PROJECT				

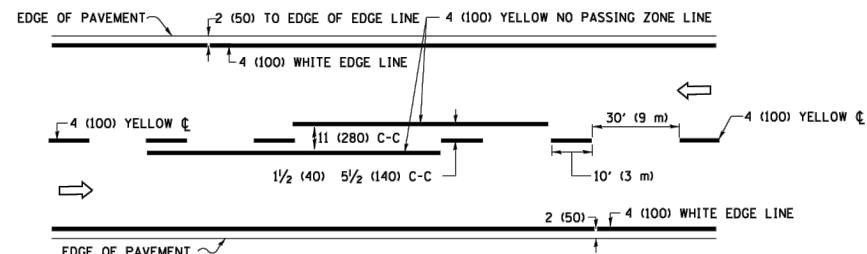

**2-LANE ROADWAY**

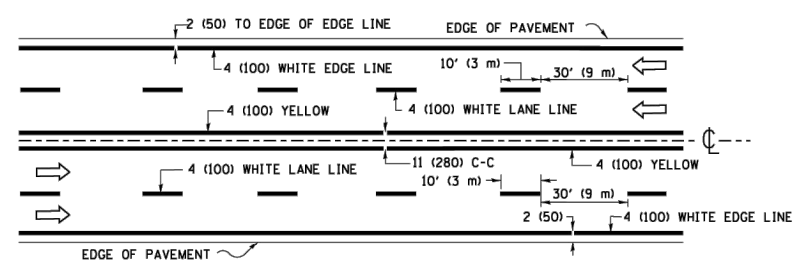

**MULTI-LANE UNDIVIDED**

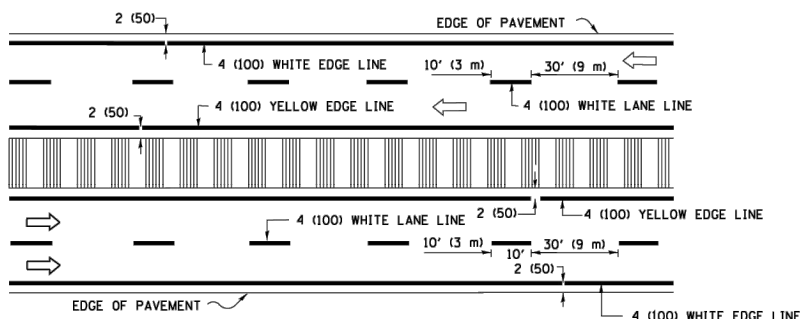

**MULTI-LANE DIVIDED WITH MEDIAN**

**TYPICAL LANE AND EDGE LINE MARKING**

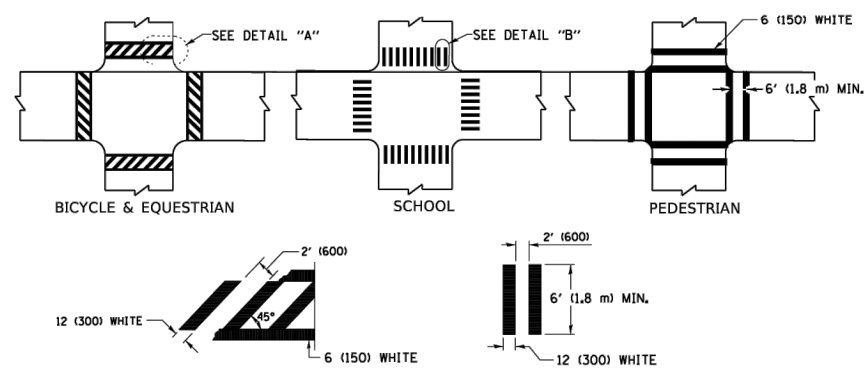

**TYPICAL CROSSWALK MARKING**

\* MARKINGS SHALL BE INSTALLED PARALLEL TO THE CENTERLINE OF THE ROAD WHICH IT CROSSES

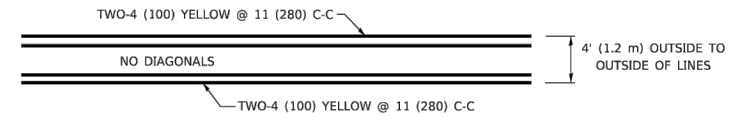

**4' (1.2 m) WIDE MEDIANS ONLY**

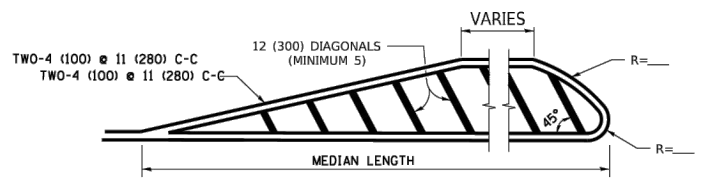

FOR MEDIAN LENGTHS WHERE DIAGONAL SPACING CANNOT BE ATTAINED, USE 5 (FIVE) EQUALLY SPACED DIAGONAL LINES.

DIAGONAL LINE SPACING: 50' (15 m) C-C (LESS THAN 30MPH (50 km/h))  
75' (25 m) C-C 30MPH (50 km/h) TO 45MPH (70 km/h)  
150' (45 m) C-C (MORE THAN 45MPH (70 km/h))

**MEDIANS OVER 4' (1.2 m) WIDE**

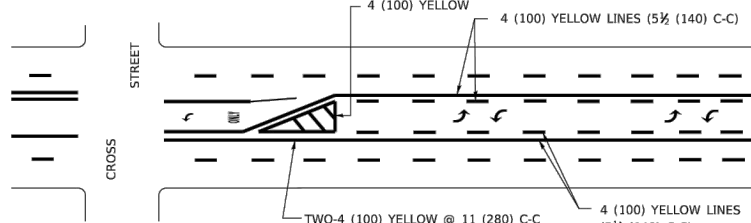

A MINIMUM OF TWO PAIRS OF TURN ARROWS SHALL BE USED, WHITE IN COLOR. ADDITIONAL PAIRS SHALL BE PLACED AT 200' (60 m) TO 300' (90 m) INTERVALS.

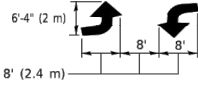

**MEDIAN WITH TWO-WAY LEFT TURN LANE**

**TYPICAL PAINTED MEDIAN MARKING**

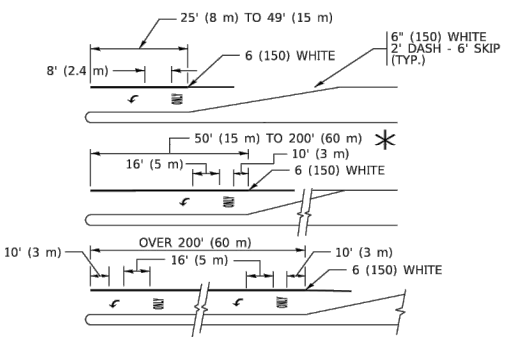

FULL SIZE LETTERS 8' (2.4 m) AND ARROWS SHALL BE USED.  
AREA = 15.6 SQ. FT. (1.5 m<sup>2</sup>) ONLY AREA = 20.8 SQ. FT. (1.9 m<sup>2</sup>)

\* TURN LANES IN EXCESS OF 400' (120 m) IN LENGTH MAY HAVE AN ADDITIONAL SET OF ARROW - "ONLY" INSTALLED MIDWAY BETWEEN THE OTHER TWO SETS OF ARROW - "ONLY".

**TYPICAL LEFT (OR RIGHT) TURN LANE**

**TYPICAL TURN LANE MARKING**

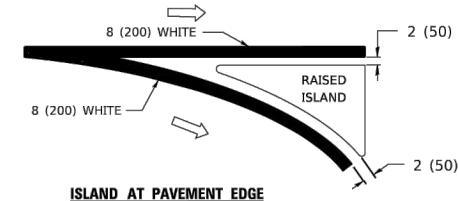
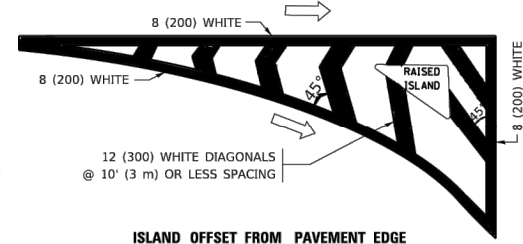

**TYPICAL ISLAND MARKING**

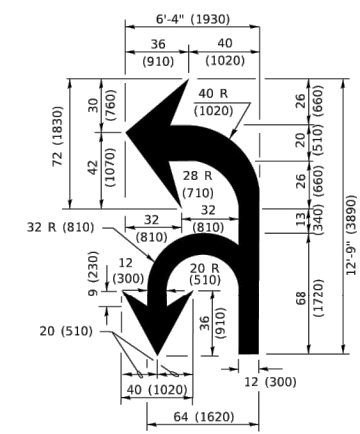

**COMBINATION LEFT AND U-TURN**

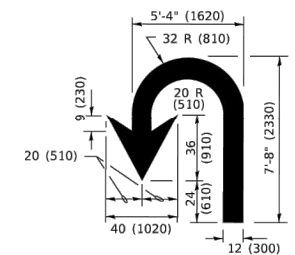

**U-TURN**

**LANE REDUCTION TRANSITION**

\* LANE REDUCTION ARROWS REQUIRED AT SPEEDS OF 45 MPH OR GREATER OR WHEN SPECIFIED IN PLANS.

D(FT)	SPEED LIMIT
345	30
425	35
500	40
580	45
665	50
750	55

TYPE OF MARKING	WIDTH OF LINE	PATTERN	COLOR	SPACING / REMARKS
CENTERLINE ON 2 LANE PAVEMENT	4 (100)	SKIP-DASH	YELLOW	10' (3 m) LINE WITH 30' (9 m) SPACE
CENTERLINE ON MULTI-LANE UNDIVIDED PAVEMENT	2 @ 4 (100)	SOLID	YELLOW	11 (280) C-C
NO PASSING ZONE LINES: FOR ONE DIRECTION FOR BOTH DIRECTIONS	4 (100) 2 @ 4 (100)	SOLID SOLID	YELLOW YELLOW	5 1/2 (140) C-C FROM SKIP-DASH CENTERLINE 11 (280) C-C OMIT SKIP-DASH CENTERLINE BETWEEN
LANE LINES	4 (100) 5 (125) ON FREEWAYS	SKIP-DASH SKIP-DASH	WHITE WHITE	10' (3 m) LINE WITH 30' (9 m) SPACE
DOTTED LINES (EXTENSIONS OF CENTER, LANE OR TURN LANE MARKINGS)	SAME AS LINE BEING EXTENDED	SKIP-DASH	SAME AS LINE BEING EXTENDED	2' (600) LINE WITH 6' (1.8 m) SPACE
EDGE LINES	4 (100)	SOLID	YELLOW-LEFT WHITE-RIGHT	OUTLINE MEDIANS IN YELLOW
TURN LANE MARKINGS	6 (150) LINE: FULL SIZE LETTERS & SYMBOLS (8' (2.4m))	SOLID	WHITE	SEE TYPICAL TURN LANE MARKING DETAIL
TWO WAY LEFT TURN MARKING	2 @ 4 (100) EACH DIRECTION 8' (2.4m) LEFT ARROW	SKIP-DASH AND SOLID IN PAIRS	YELLOW WHITE	10' (3 m) LINE WITH 30' (9 m) SPACE FOR SKIP-DASH; 5 1/2 (140) C-C BETWEEN SOLID LINE AND SKIP-DASH LINE SEE TYPICAL TWO-WAY LEFT TURN MARKING DETAIL
CROSSWALK LINES (PEDESTRIAN) A. DIAGONALS (BIKE & EQUESTRIAN) B. LONGITUDINAL BARS (SCHOOL)	2 @ 6 (150) 12 (300) @ 45° 12 (300) @ 90°	SOLID SOLID SOLID	WHITE WHITE WHITE	NOT LESS THAN 6' (1.8 m) APART 2' (600) APART SEE TYPICAL CROSSWALK MARKING DETAILS.
STOP LINES	24 (600)	SOLID	WHITE	PLACE 4' (1.2 m) IN ADVANCE OF AND PARALLEL TO CROSSWALK, IF PRESENT. OTHERWISE, PLACE AT DESIRED STOPPING POINT. PARALLEL TO CROSSROAD CENTERLINE, WHERE POSSIBLE
PAINTED MEDIANS	2 @ 4 (100) WITH 12 (300) DIAGONALS @ 45° NO DIAGONALS USED FOR 4' (1.2 m) WIDE MEDIANS	SOLID	YELLOW: TWO WAY TRAFFIC WHITE: ONE WAY TRAFFIC	11 (280) C-C FOR THE DOUBLE LINE SEE TYPICAL PAINTED MEDIAN MARKING.
GORE MARKING AND CHANNELIZING LINES	8 (200) WITH 12 (300) DIAGONALS @ 45°	SOLID	WHITE	DIAGONALS: 15' (4.5 m) C-C (LESS THAN 30MPH (50 km/h)) 20' (6 m) C-C 30MPH (50 km/h) TO 45MPH (70 km/h) 30' (9 m) C-C (OVER 45MPH (70 km/h))
RAILROAD CROSSING	24 (600) TRANSVERSE LINES: "RR" 15 6' (1.8 m) LETTERS; 16 (400) LINE FOR "X"	SOLID	WHITE	SEE STATE STANDARD 780001 AREA OF: "R"=3.6 SQ. FT. (0.33 m <sup>2</sup> ) EACH "X"=54.0 SQ. FT. (5.0 m <sup>2</sup> )
SHOULDER DIAGONALS (REQUIRED FOR SHOULDERS ≥ 8')	12 (300) @ 45°	SOLID	WHITE - RIGHT YELLOW - LEFT	50' (15 m) C-C (LESS THAN 30MPH (50 km/h)) 75' (25 m) C-C (30 MPH (50 km/h) TO 45MPH (70 km/h)) 150' (45 m) C-C (OVER 45MPH (70 km/h))
U TURN ARROW	SEE DETAIL	SOLID	WHITE	16.3 SF
2 ARROW COMBINATION LEFT AND U TURN	SEE DETAIL	SOLID	WHITE	30.4 SF

FOR FURTHER DETAILS ON PAVEMENT MARKING REFER TO STANDARD SPECIFICATIONS FOR ROAD AND BRIDGE CONSTRUCTION AND STATE STANDARD 780001.

All dimensions are in inches (millimeters) unless otherwise shown.

MODEL: Default  
FILE NAME: p:\w\01\04\EB\B\1\TEG.illinois.gov.P\W\01\Documents\DOT\_Offices\District\_1\Projects\Illinois2023\CAD\Drawings\TC13.dgn

USER NAME = footemj	DESIGNED - EVERS	REVISED - C. JUCIUS 09-09-09
	DRAWN -	REVISED - C. JUCIUS 07-01-13
PLOT SCALE = 50.0000" / in.	CHECKED -	REVISED - C. JUCIUS 12-21-15
PLOT DATE = 3/4/2019	DATE - 03-19-90	REVISED - C. JUCIUS 04-12-16

**STATE OF ILLINOIS  
DEPARTMENT OF TRANSPORTATION**

**DISTRICT ONE  
TYPICAL PAVEMENT MARKINGS**

SCALE: NONE SHEET 1 OF 2 SHEETS STA. TO STA.

F.A. RTE.	SECTION	COUNTY	TOTAL SHEETS	SHEET NO.
1650	23-00366-00-RS	KANE	24	21
TC-13			CONTRACT NO. 61K66	
ILLINOIS FED. AID PROJECT				

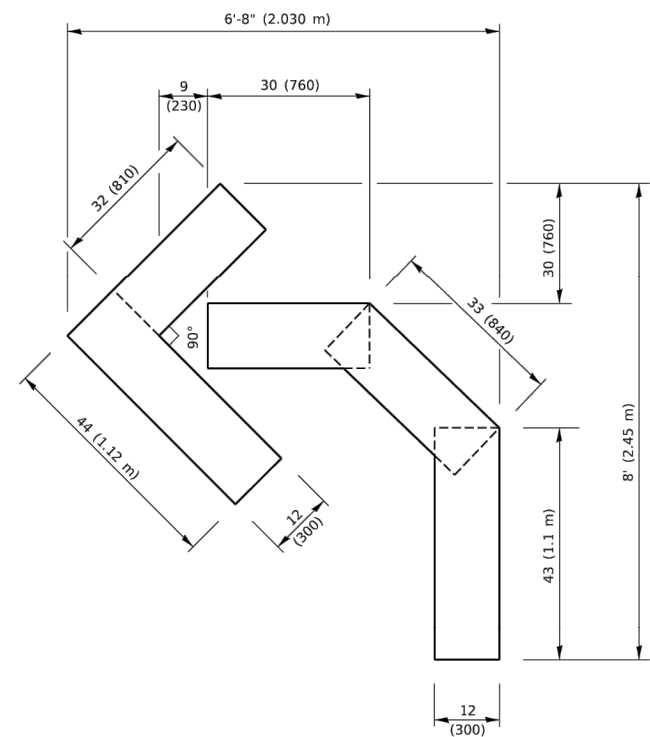

**QUANTITY**

4 (100) LINE = 45.5 ft. (13.9 m)  
15.2 sq. ft. (1.41 sq. m)

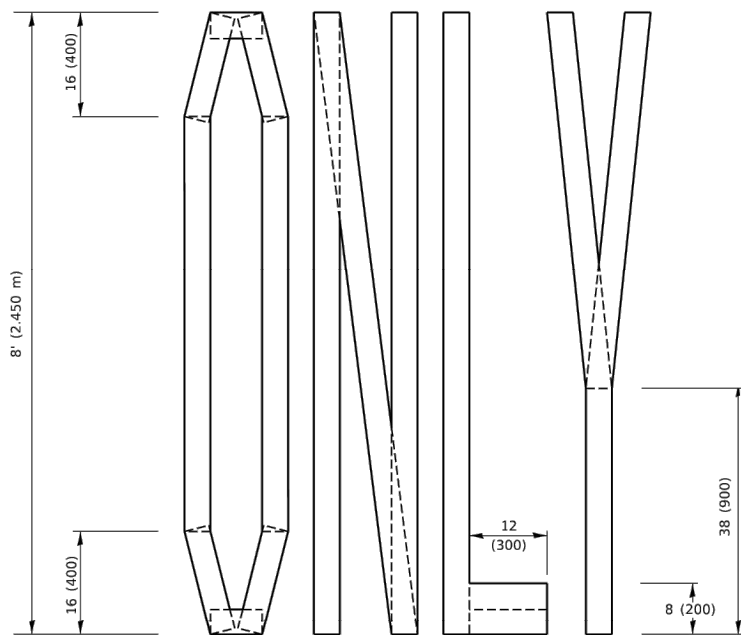
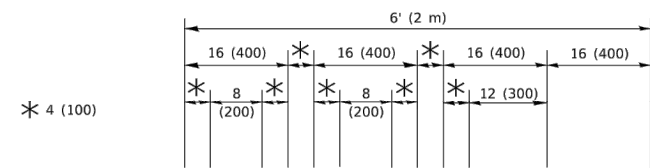

**QUANTITY**

4 (100) LINE = 64.1 ft. (19.5 m)  
21.4 sq. ft. (1.99 sq. m)

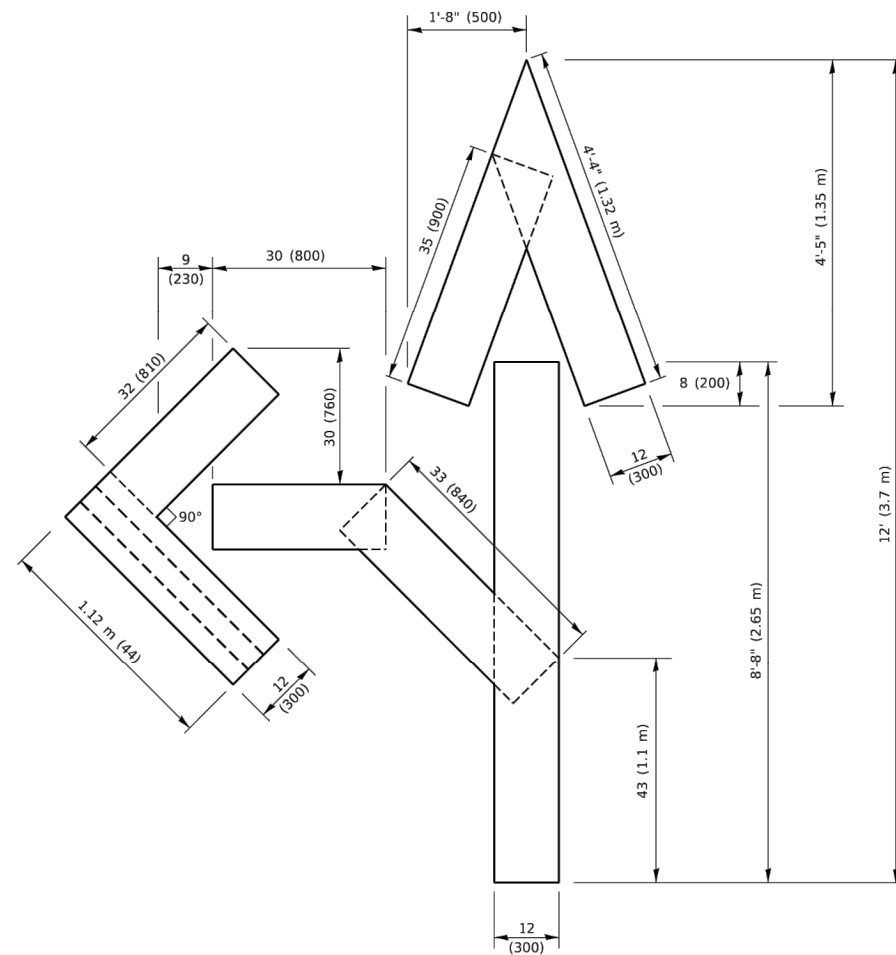

**QUANTITY**

4 (100) LINE = 82.5 ft. (25.1 m)  
27.5 sq. ft. (2.53 sq. m)

**NOTE:**

ALL QUANTITIES OF PLACEMENT ARE REPRESENTED IN LINEAR FEET OF 4" LINES TO MATCH THE 4" TEMPORARY TAPE PAY ITEM AND REPRESENTS THE TOTAL QUANTITY OF 4" TAPE REQUIRED.

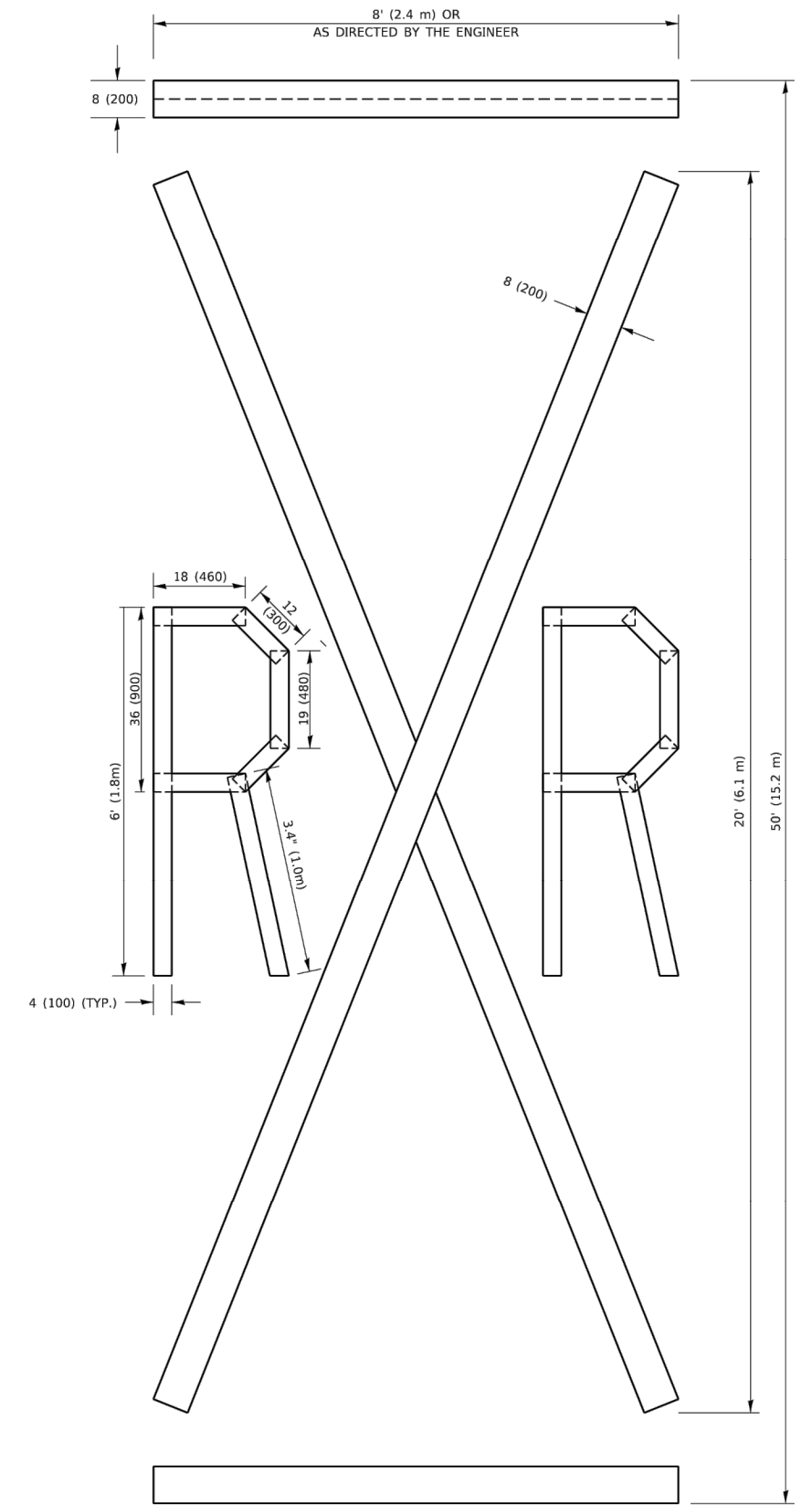

**QUANTITY**

4 (100) LINE = 225.9 ft. (68.9 m)  
75.3 sq. ft. (6.99 sq. m)

All dimensions are in inches (millimeters) unless otherwise shown.

MODEL: Default; FILE NAME: p:\11\08\FEB\NITEG.illinois.gov-PWIDOT\Documents\DOT\_Offices\District\_1\Projects\Dist1\St22\24\CAD\Drawn\CAD\sheet1.ctb.dgn

USER NAME = footemj	DESIGNED -	REVISED - T. RAMMACHER 03-02-98
	DRAWN -	REVISED - E. GOMEZ 08-28-00
PLOT SCALE = 50.0068" / in.	CHECKED -	REVISED - E. GOMEZ 08-28-00
PLOT DATE = 3/4/2019	DATE - 09-18-94	REVISED - A. SCHUETZE 09-15-16

**STATE OF ILLINOIS  
DEPARTMENT OF TRANSPORTATION**

**SHORT TERM PAVEMENT MARKING LETTERS AND SYMBOLS**

SCALE: NONE SHEET 1 OF 1 SHEETS STA. TO STA.

F.A. RTE.	SECTION	COUNTY	TOTAL SHEETS	SHEET NO.
1650	23-00366-00-RS	KANE	24	22
<b>TC-16</b>			CONTRACT NO. 61K66	
ILLINOIS FED. AID PROJECT				

MODEL: Default  
 FILE NAME: p:\u01684848\BID\NTEG\_IL\Illinois.gov.PWIDOT\Documents\DOT\_Offices\District\_1\Projects\US54\2344\CAD\Drawings\CADsheets\22.dgn

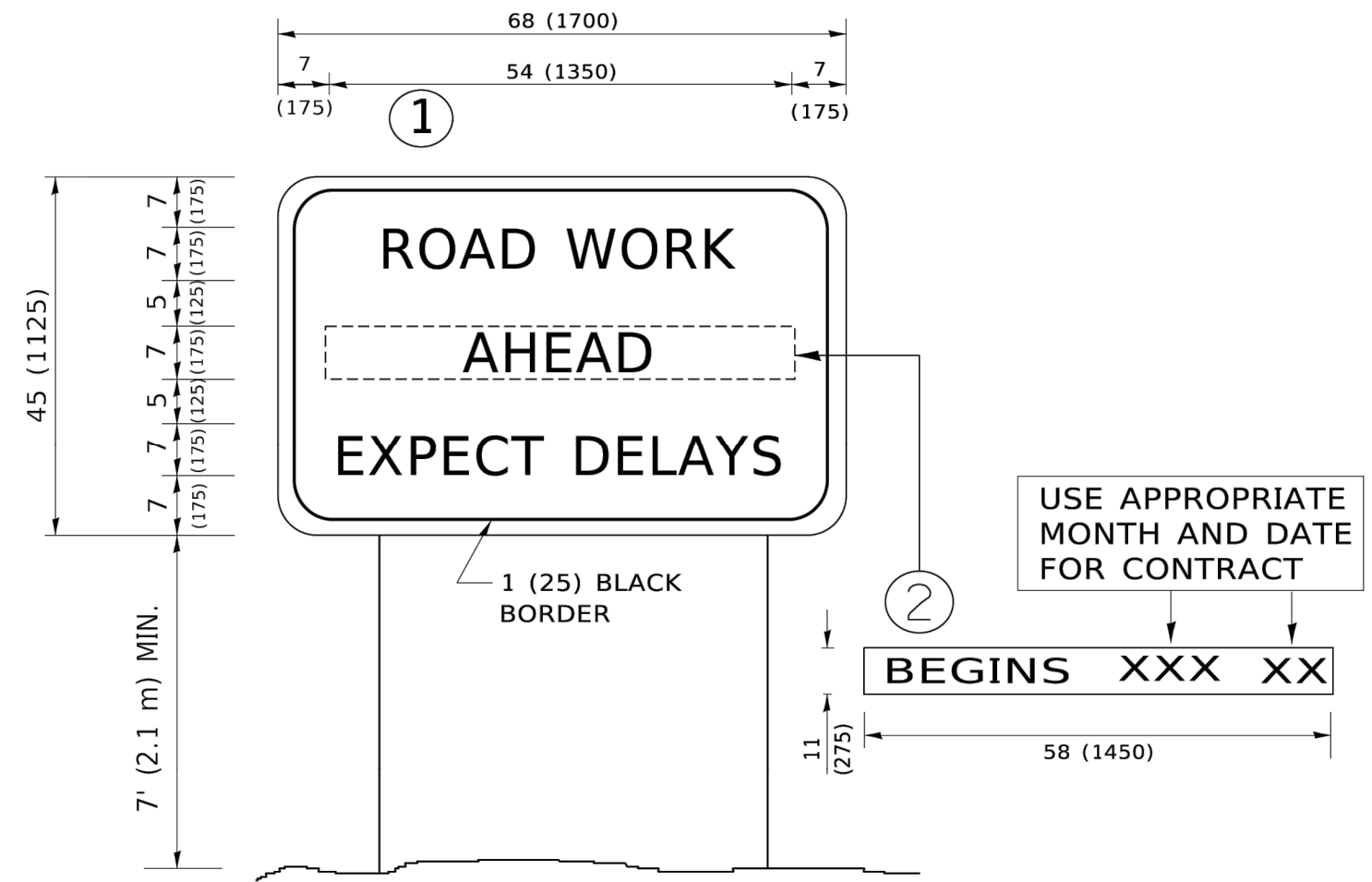

**NOTES:**

1. USE BLACK LETTERING ON ORANGE BACKGROUND.
2. ERECT SIGNS IN ADVANCE OF THE LOCATION FOR THE "ROAD CONSTRUCTION AHEAD" SIGN AT LOCATIONS AS DIRECTED BY THE ENGINEER.
3. ERECT SIGN ① WITH INSTALLED PANEL ② ONE WEEK PRIOR TO THE START OF CONSTRUCTION.
4. REMOVE PANEL ② SOON AFTER THE START OF CONSTRUCTION.
5. SEE SPECIAL PROVISION FOR "TEMPORARY INFORMATION SIGNING" FOR ADDITIONAL INFORMATION.
6. ONE SIGN ASSEMBLY EQUALS 25.70 SQ. FT. (2.3 SQ. M.)
7. SHALL BE PAID FOR AS TEMPORARY INFORMATION SIGNING.

ALL DIMENSIONS ARE IN INCHES (MILLIMETERS) UNLESS OTHERWISE SHOWN.

USER NAME = footemj	DESIGNED -	REVISED - R. MIRS 09-15-97
	DRAWN -	REVISED - R. MIRS 12-11-97
PLOT SCALE = 50.0000" / in.	CHECKED -	REVISED - T. RAMMACHER 02-02-99
PLOT DATE = 3/4/2019	DATE -	REVISED - C. JUCIUS 01-31-07

**STATE OF ILLINOIS  
 DEPARTMENT OF TRANSPORTATION**

<b>ARTERIAL ROAD    INFORMATION SIGN</b>	
SCALE: NONE	SHEET 1 OF 1 SHEETS
STA.	TO STA.

F.A. RTE.	SECTION	COUNTY	TOTAL SHEETS	SHEET NO.
1650	23-00366-00-RS	KANE	24	23
<b>TC-22</b>			CONTRACT NO. 61K66	
ILLINOIS FED. AID PROJECT				



3.0" RADIUS, 0.5" BORDER, WHITE ON GREEN; REFLECTORIZED  
 "DRIVEWAY" D; "ENTRANCE" D; STANDARD ARROW CUSTOM 12.0" x 5.0"

**NOTES:**

1. HALF OF THE SIGNS WILL REQUIRE A LEFT HAND FACING ARROW.
2. TWO SIGNS SHALL BE USED AT EACH COMMERCIAL ENTRANCE PLACED BACK-TO-BACK: ONE WITH A RIGHT HAND ARROW (SHOWN) SHALL BE PLACED ON THE NEAR RIGHT SIDE THE DRIVEWAY AND ONE WITH A LEFT HAND ARROW SHALL BE PLACED ON THE FAR LEFT SIDE OF THE DRIVEWAY.
3. SIGNS TO BE PAID FOR AS ITEM "TEMPORARY INFORMATION SIGNING".

MODEL - Default  
 FILE NAME - pw\jg\jgroom.dwg  
 ILLINOIS.gov:PW\DOT\Documents\DOT - Offices\District 1\Projects\1650\23-00366-00-RS\23-00366-00-RS\Sheet26.dgn

USER NAME = leysa	DESIGNED -	REVISED - C. JUCIUS 02-15-07
	DRAWN -	REVISED -
PLOT SCALE = 50.0000' / in.	CHECKED -	REVISED -
PLOT DATE = 8/6/2021	DATE -	REVISED -

**STATE OF ILLINOIS  
 DEPARTMENT OF TRANSPORTATION**

**DRIVEWAY ENTRANCE SIGNING**

SCALE: NONE SHEET 1 OF 1 SHEETS STA. TO STA.

F.A. RTE.	SECTION	COUNTY	TOTAL SHEETS	SHEET NO.
1650	23-00366-00-RS	KANE	24	24
<b>TC-26</b>			CONTRACT NO. 61K66	
ILLINOIS FED. AID PROJECT				