

PRE-STAGE 1

TRAFFIC SIGNAL AT IL 31 & IL 72 SHALL BE MODIFIED TO BE USED FOR TEMPORARY TRAFFIC SIGNAL. SEE SIGNAL PLANS FOR DETAILS. THIS WORK SHALL BE PERFORMED UNDER IDOT STANDARD 701701-07.

STAGE 1

1. PRIOR TO THE START OF STAGE 1, THE CONTRACTOR IS RESPONSIBLE FOR THE REMOVAL OF CONFLICTING PAVEMENT MARKINGS IN PREPARATION FOR STAGE 1 TRAFFIC CONTROL. PLACE ALL TRAFFIC CONTROL PER THE STAGE 1 MAINTENANCE OF TRAFFIC DRAWINGS. ADJUST SIGNALS FOR NEW TRAFFIC PATTERN. REMOVE ALL PAVEMENT, CURB AND GUTTER, AND UTILITIES WITHIN THE WORK ZONE AS SHOWN ON THE REMOVAL PLANS. THE CONTRACTOR SHALL INSTALL PROPOSED CURB & GUTTER, SIDEWALK, ALL UTILITY IMPROVEMENTS, SUBBASE, BASECOURSE, LEVELING BINDER, BINDER COURSE, AND ALL OTHER APPURTENANCES PERTAINING TO THE ROADWAY WIDENING. ALL HOT-MIX ASPHALT SHALL BE INSTALLED TO THE BINDER ONLY. THE FINAL SURFACE IS TO BE INSTALLED DURING THE FINAL STAGE. IF THERE IS ANY NEED TO SHUT DOWN A LANE TO FACILITATE CONSTRUCTION, THE CONTRACTOR CAN ONLY PERFORM THIS WORK DURING DAILY LANE CLOSURE PER IDOT STANDARD 701601-07 AND 701701-07.
2. STORM SEWER LINES P-48 AND P-49, STRUCTURES ST-49a, ST-49b, AND ST-50, AND IT'S PAVEMENT PATCHING SHALL BE INSTALLED UNDER DAILY LANE CLOSURE PER IDOT STANDARD 701606-08.

STAGE 2

1. PRIOR TO THE START OF STAGE 2, THE CONTRACTOR IS RESPONSIBLE FOR THE REMOVAL OF CONFLICTING PAVEMENT MARKINGS IN PREPARATION FOR STAGE 2 TRAFFIC CONTROL. PLACE ALL TRAFFIC CONTROL PER THE STAGE 2 MAINTENANCE OF TRAFFIC DRAWINGS. ADJUST SIGNALS FOR NEW TRAFFIC PATTERN. REMOVE ALL PAVEMENT, CURB AND GUTTER, AND UTILITIES WITHIN THE WORK ZONE AS SHOWN ON THE REMOVAL PLANS. THE CONTRACTOR SHALL INSTALL PROPOSED CURB & GUTTER, SIDEWALK, ALL UTILITY IMPROVEMENTS, SUBBASE, BASECOURSE, LEVELING BINDER, BINDER COURSE, AND ALL OTHER APPURTENANCES PERTAINING TO THE ROADWAY WIDENING. ALL HOT-MIX ASPHALT SHALL BE INSTALLED TO THE BINDER ONLY. THE FINAL SURFACE IS TO BE INSTALLED DURING THE FINAL STAGE. IF THERE IS ANY NEED TO SHUT DOWN A LANE TO FACILITATE CONSTRUCTION, THE CONTRACTOR CAN ONLY PERFORM THIS WORK DURING DAILY LANE CLOSURE PER IDOT STANDARD 701601-07 AND 701701-07.
2. STORM SEWER LINE P-61 UP TO LIMITS OF STAGE 3 WORKZONE, STRUCTURE, ST-62, AND IT'S PAVEMENT PATCHING SHALL BE INSTALLED UNDER DAILY LANE CLOSURE PER IDOT STANDARD 701606-08.

STAGE 3

1. PRIOR TO THE START OF STAGE 3, THE CONTRACTOR IS RESPONSIBLE FOR THE REMOVAL OF CONFLICTING PAVEMENT MARKINGS IN PREPARATION FOR STAGE 3 TRAFFIC CONTROL. PLACE ALL TRAFFIC CONTROL PER THE STAGE 3 MAINTENANCE OF TRAFFIC DRAWINGS. ADJUST SIGNALS FOR NEW TRAFFIC PATTERN. REMOVE ALL PAVEMENT, CURB AND GUTTER, AND UTILITIES WITHIN THE WORK ZONE AS SHOWN ON THE REMOVAL PLANS. THE CONTRACTOR SHALL INSTALL PROPOSED MEDIANS, CURB & GUTTER, ALL UTILITY IMPROVEMENTS, SUBBASE, BASECOURSE, BINDER COURSE, AND ALL OTHER APPURTENANCES PERTAINING TO THE ROADWAY WIDENING. ALL HOT-MIX ASPHALT SHALL BE INSTALLED TO THE BINDER ONLY. THE FINAL SURFACE IS TO BE INSTALLED DURING THE FINAL STAGE. IF THERE IS ANY NEED TO SHUT DOWN A LANE TO FACILITATE CONSTRUCTION, THE CONTRACTOR CAN ONLY PERFORM THIS WORK DURING DAILY LANE CLOSURE PER IDOT STANDARD 701601-07 AND 701701-07.
2. INSTALLATION OF STORM SEWER LINE P-61 AND STRUCTURE ST-61 SHALL BE COMPLETED DURING THIS STAGE.

STAGE 4 (NOT ILLUSTRATED)

1. REMOVE TEMPORARY TRAFFIC SIGNALS. INSTALL AND ACTIVATE PERMANENT TRAFFIC SIGNALS AT THE INTERSECTION OF IL 31 & IL 72 (NOTE: THE TEMPORARY SIGNALS SHALL BE TURNED OFF AT THE SAME TIME THE PERMANENT SIGNALS ARE ACTIVATED).
2. INSTALL HMA SURFACE COURSE TO THE BINDER AND ALL PERMANENT PAVEMENT MARKINGS AS SHOWN ON THE PAVEMENT MARKING PLANS ALONG IL 31 & IL 72 PER IDOT STANDARD 701601-07 AND 701701-07.
3. REMOVE CONSTRUCTION SIGNS, INSTALL FINAL ROADWAY SIGNAGE, AND OPEN ALL LANES TO TRAFFIC.

MAINTENANCE OF TRAFFIC GENERAL NOTES

1. TRAFFIC CONTROL DEPICTED IN THESE PLANS AND THE APPLICABLE I.D.O.T. DETAILS AND STANDARDS ARE THE MINIMUM REQUIREMENTS. OTHER WORK OR SIGNING MAY BE REQUIRED BY THE ENGINEER. TRAFFIC CONTROL AND PROTECTION SHALL BE PERFORMED IN ACCORDANCE WITH THE STANDARD SPECIFICATIONS, DIVISION 700; APPLICABLE GUIDELINES IN THE ILLINOIS MANUAL ON UNIFORM TRAFFIC CONTROL DEVICES FOR STREETS AND HIGHWAYS; AND APPLICABLE HIGHWAY STANDARDS FOR TRAFFIC CONTROL, UNLESS HEREIN REVISED.
2. THE EXACT NUMBER, LOCATION AND SPACING OF ALL SIGNS AND TRAFFIC CONTROL DEVICES SHALL FIT FIELD CONDITIONS AS DIRECTED BY THE ENGINEER.
3. ALL CONSTRUCTION SIGNS SHALL HAVE FLUORESCENT ORANGE BACKGROUNDS.
4. ALL SIGNS THAT ARE TO BE IN PLACE MORE THAN 4 DAYS SHALL BE MOUNTED ON METAL POSTS WHEN POSSIBLE, 7 FEET FROM THE TOP OF PAVEMENT TO THE BOTTOM OF THE SIGN, AND DRIVEN A MINIMUM OF 3 FEET INTO THE GROUND. A J.U.L.I.E. LOCATE SHALL BE PERFORMED PRIOR TO THE INSTALLATION OF THE POSTS.
5. BARRICADES WILL BE REQUIRED ADJACENT TO PAVEMENT EDGES WHERE WIDENING, CURB AND GUTTER OR OVERLAYING WORK IS BEING DONE, AS SPECIFIED IN SECTION 701 OF THE STANDARD SPECIFICATIONS, EXCEPT THAT THE BARRICADES SHALL BE TYPE II OR DRUMS, NON-METALLIC WITH MONO-DIRECTIONAL STEADY-BURN LIGHTS. SPACING SHALL BE AS SHOWN ON THE CONSTRUCTION STAGING PLANS UNLESS OTHERWISE DIRECTED BY THE ENGINEER. BARRICADES THAT MUST BE PLACED IN EXCAVATED AREAS SHALL HAVE LEG EXTENSIONS INSTALLED SUCH THAT THE TOPS OF THE BARRICADES ARE IN COMPLIANCE WITH THE HEIGHT REQUIREMENTS OF STANDARD 701901-01.
6. ALL BARRICADES AT LANE DIVERSIONS WITHIN TAPER SECTIONS SHALL HAVE DIRECTION INDICATOR PANELS FACING THE AFFECTED DIRECTION OF TRAVEL ONLY. THE ARROW PANEL ON THE OPPOSITE SIDE OF THE BARRICADE SHALL BE CHANGED OUT WHEN NECESSARY.
7. TYPE II BARRICADES OR DRUMS EQUIPPED WITH ONE-WAY FLASHING LIGHTS WILL BE REQUIRED AT ALL OPEN TRENCHES, EXCAVATIONS, OPEN OR EXPOSED SEWER STRUCTURES, AND AT ANY OTHER LOCATIONS DESIGNATED BY THE ENGINEER OR LAW ENFORCEMENT AGENCIES. BARRICADES SHALL BE PLACED AT 20' CENTERS ALONG TANGENTS, 15' ALONG TAPERS AND 10' AROUND RADII.
8. TYPE II BARRICADES AND DRUMS SHALL HAVE ALTERNATING REFLECTORIZED TYPE AA OR TYPE AP FLUORESCENT ORANGE AND REFLECTORIZED WHITE HORIZONTAL, CIRCUMFERENTIAL STRIPES.
9. DRUMS AND BARRICADES SHALL MEET THE REQUIREMENTS OF THE NATIONAL COOPERATIVE HIGHWAY RESEARCH PROGRAM (NCHRP) REPORT 350.
10. THE CONTRACTOR SHALL INFORM THE ENGINEER OF ANY STAGE CHANGE AT LEAST TWO WEEKS IN ADVANCE OF THE CHANGE.
11. EXISTING TRAFFIC CONTROL SIGNS AND DEVICES SHALL BE REMOVED OR RELOCATED BY THE CONTRACTOR AFTER THE TRAFFIC CONTROL REQUIREMENTS ARE MET OR AS AUTHORIZED BY THE ENGINEER; ANY SIGNS OR DEVICES LEFT IN PLACE ARE TO BE PROTECTED FROM DAMAGE AND MAINTAINED.
12. THE FIRST TWO WARNING SIGNS IN EACH DIRECTION OF TRAVEL SHALL BE EQUIPPED WITH MONO-DIRECTIONAL AMBER FLASHING LIGHTS DURING HOURS OF DARKNESS. FLAGS ARE OPTIONAL.
13. EXISTING TRAFFIC CONTROL DEVICES ARE TO BE PROTECTED FROM DAMAGE BY THE CONTRACTOR. ANY DAMAGE CAUSED BY THIS WORK SHALL BE REPAIRED TO THE SATISFACTION OF THE ENGINEER AT THE EXPENSE OF THE CONTRACTOR.
14. "WORKERS" SIGNS SHALL ONLY BE ERECTED WHEN WORKERS ARE PRESENT. SIGNS MUST BE COVERED OR REMOVED WHEN NO WORKERS ARE PRESENT.
15. "FRESH OIL" SIGNS (W21-2-4848) WITH DATE SIGNS SHALL BE ERECTED 48 HOURS PRIOR TO PRIMING. THE COST OF THESE SIGNS SHALL BE INCLUDED IN THE PAY ITEM "TRAFFIC CONTROL AND PROTECTION, (SPECIAL)".
16. THE CONTRACTOR SHALL ERECT TEMPORARY STREET NAME SIGNS ON METAL POSTS THROUGHOUT CONSTRUCTION TO THE SATISFACTION OF THE ENGINEER. THE COST OF THESE SIGNS SHALL BE INCLUDED IN THE PAY ITEM "TRAFFIC CONTROL AND PROTECTION, (SPECIAL)".
17. ALL PAVEMENT MARKINGS SHOWN ON MAINTENANCE OF TRAFFIC SHEETS SHALL BE PAID FOR AS "PAVEMENT MARKING TAPE, TY III" OF THE SIZE SPECIFIED.
18. ARROW BOARDS WILL BE REQUIRED WHEN IMPLEMENTING ALL LANE CLOSURES, AND SHALL BE INCLUDED IN THE PAY ITEM "TRAFFIC CONTROL AND PROTECTION, (SPECIAL)".

19. THE COST OF SUPPLYING, ERECTING, AND MAINTAINING BARRICADES, DRUMS, WARNING LIGHTS, AND SIGNS SHALL BE INCLUDED IN THE COST OF "TRAFFIC CONTROL AND PROTECTION, (SPECIAL)". QUANTITIES FOR PAVEMENT MARKING REMOVAL, SHORT-TERM PAVEMENT MARKINGS, TEMPORARY PAVEMENT MARKINGS, AND WORK ZONE PAVEMENT MARKING REMOVAL ARE NOT INCLUDED IN THE ITEM "TRAFFIC CONTROL AND PROTECTION, (SPECIAL)" AND SHALL BE MEASURED SEPARATELY FOR PAYMENT.
20. A QUANTITY FOR "CHANGEABLE MESSAGE SIGN" HAS BEEN INCLUDED FOR USE WHEN DIRECTED BY THE ENGINEER.
21. ACCESS TO PROPERTIES SHALL BE MAINTAINED AT ALL TIMES BY STAGE. THE CONTRACTOR SHALL ERECT DRIVEWAY ENTRANCE AS PROVIDED IN THE MOT PLANS TO PROVIDE GUIDANCE SIGNS. WHEN A DRIVEWAY MUST BE CLOSED TEMPORARILY FOR CONSTRUCTION OF THE DRIVEWAY APRON, PROPERTIES WITH MULTIPLE ENTRANCES SHALL HAVE ONLY ONE ENTRANCE CLOSED AT A TIME. THE COST OF THESE SIGNS ARE INCLUDED IN "TEMPORARY INFORMATION SIGNING".
22. ALL STAGING SWITCH-OVERS SHALL OCCUR AT OFF PEAK HOURS.
23. ALL PERSONNEL WORKING OUTSIDE A VEHICLE WITHIN THE PUBLIC RIGHT-OF-WAY MUST BE WEARING A GARMENT THAT MEETS ANSI CLASS 2 REQUIREMENTS, OR CLASS 3 REQUIREMENTS FOR NIGHT OPERATIONS.
24. FLAGGERS MUST BE CERTIFIED AND CARRY THEIR CERTIFICATION CARD ON THEM WHEN WORKING, PROPER STOP/SLOW PADDLES MUST BE UTILIZED AND ALL REQUIRED SAFETY GARMENTS MUST BE WORN ON THE JOB SITE. "FLAGGER" WARNING SIGNS MUST BE IN PLACE WHENEVER FLAGGERS ARE PRESENT. THESE SIGNS MUST BE COVERED AND REMOVED WHEN NOT APPLICABLE.
25. "CAUTION" TAPE OR RIBBON IS NOT TO BE USED BETWEEN BARRICADES.
26. ALL EXISTING SIGNS WITHIN THE LIMITS OF MAINTENANCE OF TRAFFIC WHICH ARE OBTSCURED BY OR OTHERWISE INTERFERED WITH BY THE CONSTRUCTION OPERATIONS AND MAINTENANCE OF TRAFFIC, SHALL BE COVERED OR REMOVED BY THE CONTRACTOR UNLESS SPECIFIED IN THE PLANS OR WHEN DIRECTED BY THE ENGINEER. THIS WORK SHALL BE IN ACCORDANCE WITH ARTICLE 107.25 OF THE IDOT STANDARD SPECIFICATIONS FOR ROAD AND BRIDGE CONSTRUCTION.
27. THE CONTRACTOR SHALL CONTACT THE IDOT TRAFFIC CONTROL SUPERVISOR AT (847) 705-4470 A MINIMUM OF 72 HOURS IN ADVANCE OF BEGINNING WORK.
28. ALL DRUMS, TYPE I, AND TYPE II BARRICADES SHALL HAVE A MONODIRECTIONAL STEADY BURN LIGHT.

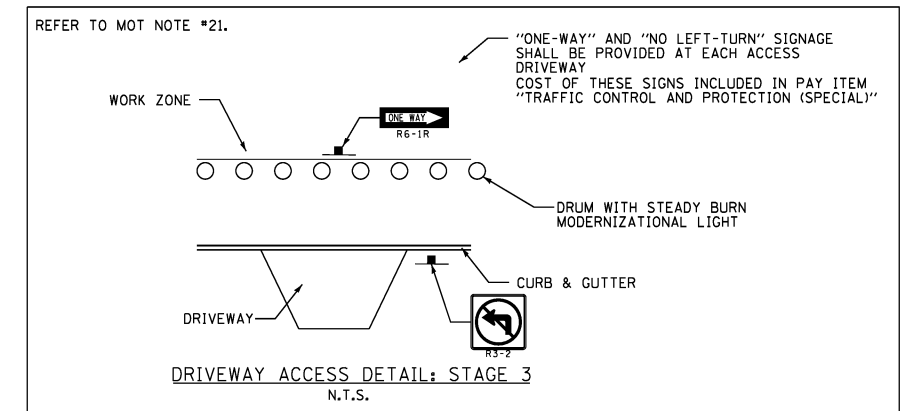
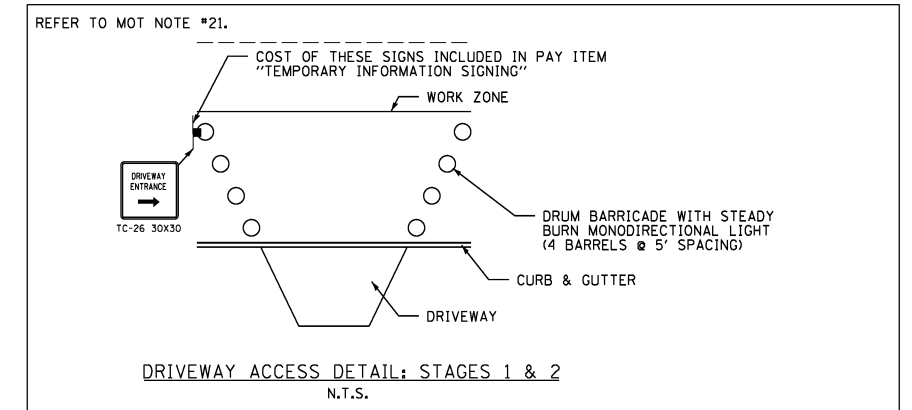

USER NAME = #USER#	DESIGNED <i>ESI</i>	REVISED -
DRAWN <i>ESI</i>	REVISED -	
PLOT SCALE = #SCALE#	CHECKED <i>GJS</i>	REVISED -
PLOT DATE = #DATE#	DATE <i>07/03/12</i>	REVISED -

**STATE OF ILLINOIS
DEPARTMENT OF TRANSPORTATION**

**SUGGESTED MAINTENANCE OF TRAFFIC
GENERAL NOTES**

SCALE: 1" = 50' SHEET NO. 1 OF 7 SHEETS STA. TO STA.

F.A.U. RTE.	SECTION	COUNTY	TOTAL SHEETS	SHEET NO.
3887	S-N	KANE	153	56
CONTRACT NO. 60A95				
FED. ROAD DIST. NO. 1 ILLINOIS FED. AID PROJECT				