

| F.A.U. RTE. | SECTION | COUNTY | TOTAL SHEETS       | SHEET NO. |
|-------------|---------|--------|--------------------|-----------|
| 1320        | 581-N-1 | COOK   | 50                 | 1         |
| ILLINOIS    |         |        | CONTRACT NO. 60L43 |           |

STATE OF ILLINOIS  
DEPARTMENT OF TRANSPORTATION  
DIVISION OF HIGHWAYS

**PROPOSED  
HIGHWAY PLANS**

FAU ROUTE 1320: IL. RTE. 58 (SUMMIT STREET)  
AT SHALES PARKWAY / COUNTRYFIELD LANE  
SECTION: 581-N-1  
PROJECT: *HSIP-1320(004)*  
INTERSECTION IMPROVEMENT  
COOK COUNTY  
C-91-697-10

FOR INDEX OF SHEETS, SEE SHEET NO. 2

THE PROJECT IS LOCATED IN THE  
CITY OF ELGIN

TRAFFIC DATA:  
IL RTE 58 2009 ADT = 10,800  
POSTED SPEED LIMIT = 45 MPH  
  
SHALES PKWY 2009 ADT = 9,200  
POSTED SPEED LIMIT = 30 MPH

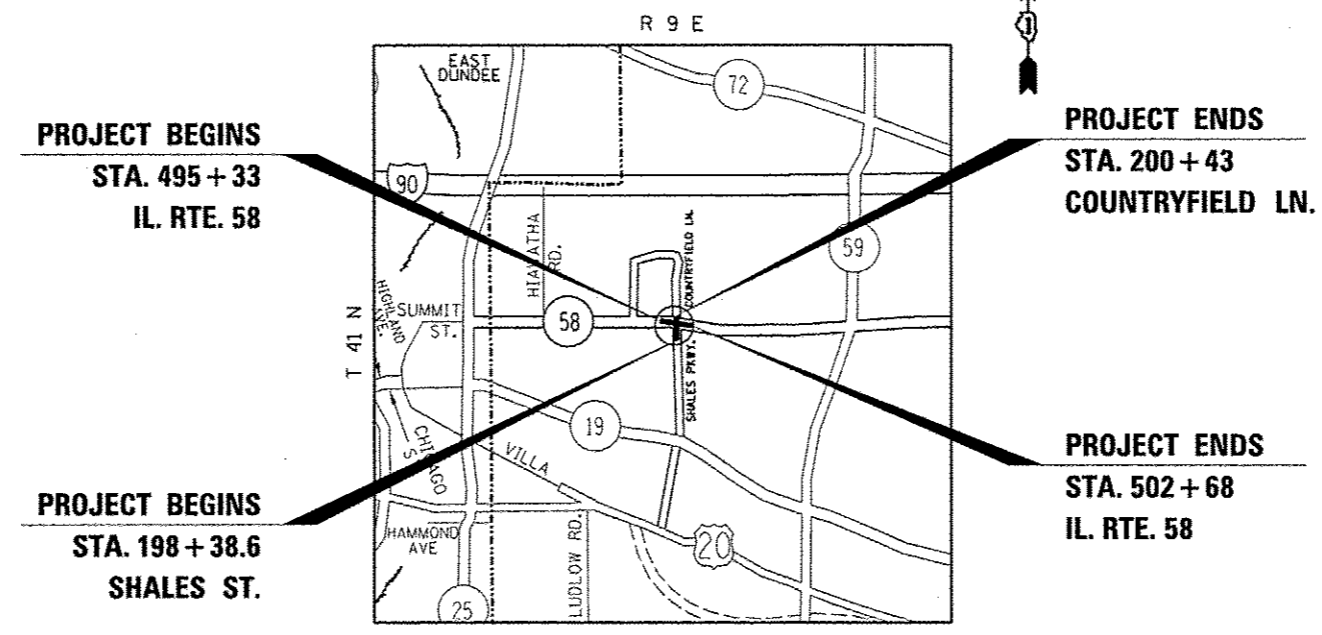
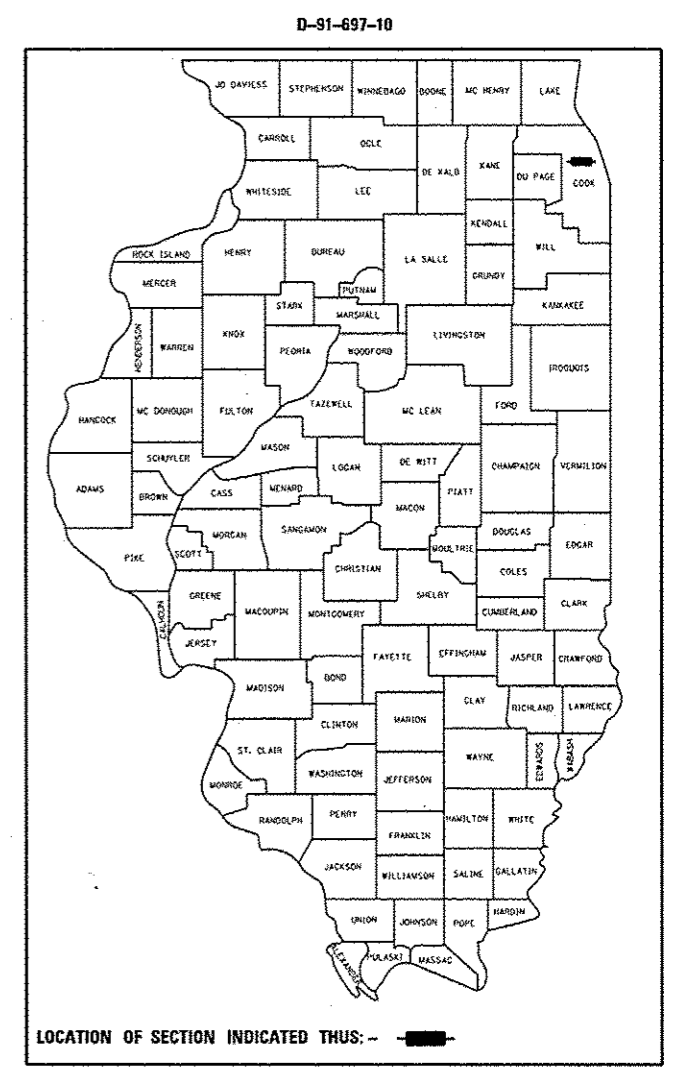

FULL SIZE PLANS HAVE BEEN PREPARED USING STANDARD ENGINEERING SCALES. REDUCED SIZED PLANS WILL NOT CONFORM TO STANDARD SCALES. IN MAKING MEASUREMENTS ON REDUCED PLANS, THE ABOVE SCALES MAY BE USED.

J.U.L.I.E.  
JOINT UTILITY LOCATION INFORMATION FOR EXCAVATION  
1-800-892-0123  
OR 811

PROJECT ENGINEER KARI SMITH (847) 705-4437  
PROJECT MANAGER KEN ENG (847) 705-4247

IL. RTE. 58 - GROSS AND NET LENGTH = 735.00 FT. = 0.139 MILE  
SHALES PKWY./CONTRNYFIELD LN. - GROSS AND NET LENGTH = 204.4 FT. = 0.039 MILE  
TOTAL GROSS AND NET LENGTH = 939.4 FT. = 0.178 MILE

STATE OF ILLINOIS  
DEPARTMENT OF TRANSPORTATION  
DIVISION OF HIGHWAYS

SUBMITTED *JANUARY 31, 2012*

*Diana M. O'Keefe*  
DEPUTY DIRECTOR OF HIGHWAYS, REGION ENGINEER

*May 11 2012*  
*John D. Baranzelli P.E.*  
ENGINEER OF DESIGN AND ENVIRONMENT

*May 11 2012*  
*William B. Frey*  
DIRECTOR OF HIGHWAYS, CHIEF ENGINEER

PRINTED BY THE AUTHORITY  
OF THE STATE OF ILLINOIS