

ROUTE	SECTION	COUNTY	TOTAL SHEETS	SHEET NUMBER
FAI 290 & FAP 342	2012-026 BR	COOK & DUPAGE	29	3

Contract 60T70

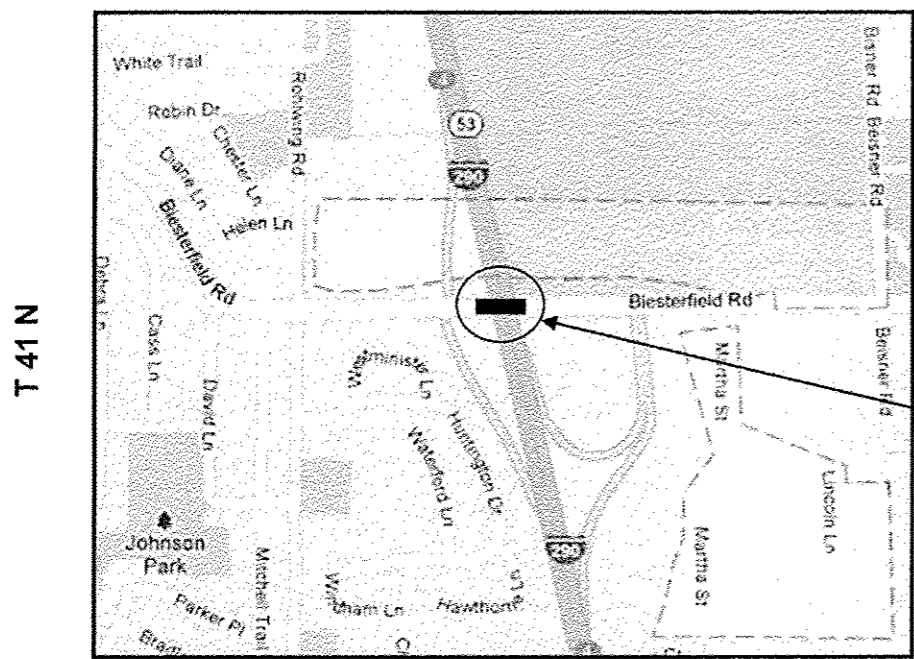

ELK GROVE TOWNSHIP
COOK COUNTY



**LOCATION 2: SN 016-0960
VILLAGE OF ELK GROVE
I-290 AT BIESTERFIELD RD**

**LOCATION 3: SN 022-0091
VILLAGE OF ITASCA
I-290 AT IL 19 (IRVING PARK RD)**

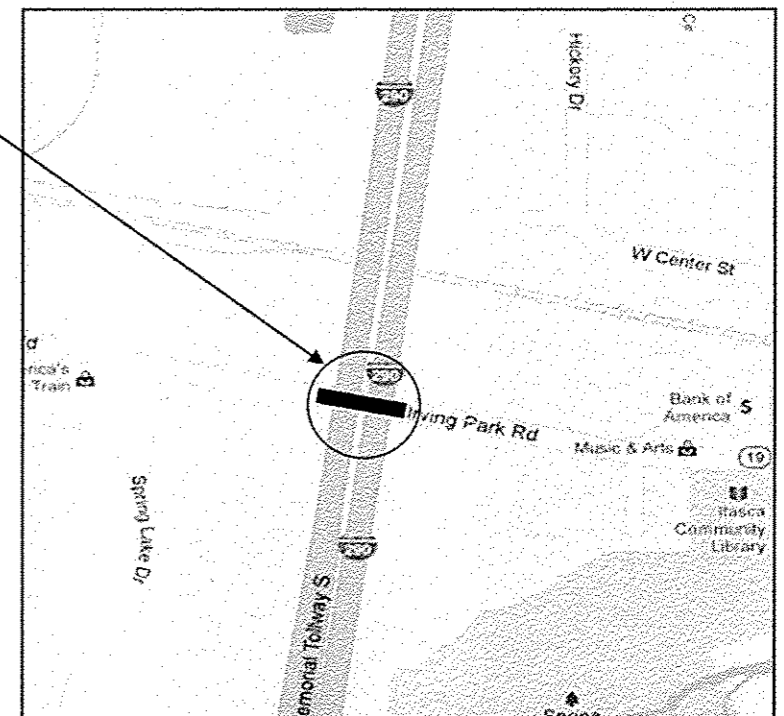

ADDISON TOWNSHIP
DUPAGE COUNTY



**LOCATION 1: SN 016-3215
VILLAGE OF PALATINE
IL 53 EXTENSION AT
LAKE-COOK RD**

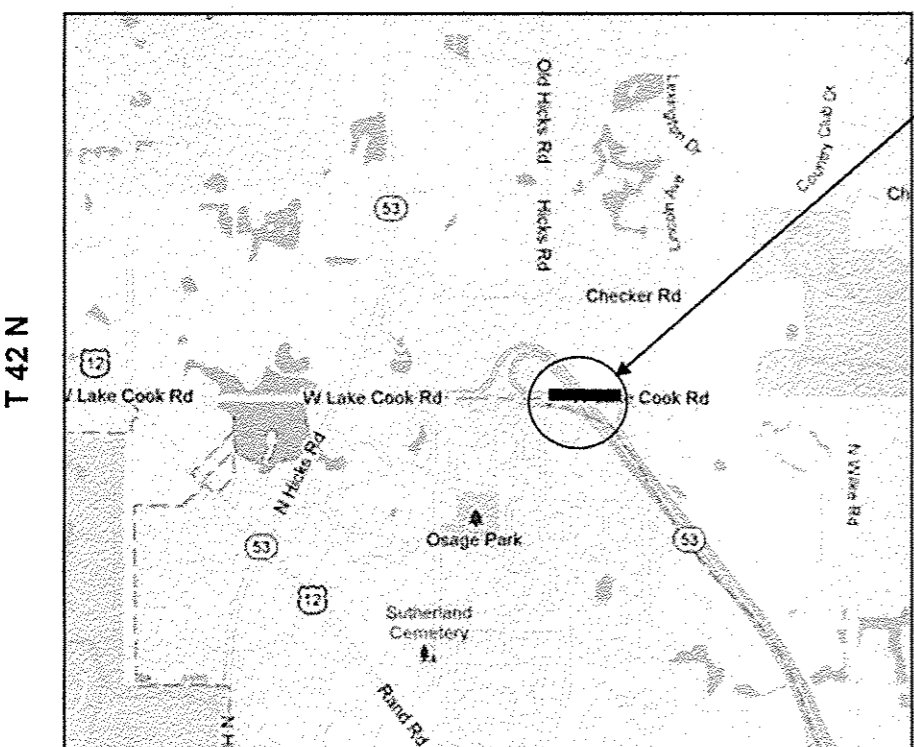

PALATINE TOWNSHIP
COOK COUNTY



TRAFFIC DATA:

I-290: SPEED LIMIT = 55 MPH
2010 ADT = 188,300

IL 53(EXTENSION): SPEED LIMIT = 35-55 MPH
2010 ADT = 69,400

**ILLINOIS DEPARTMENT OF
TRANSPORTATION**

LOCATION MAPS