

**EAST ABUTMENT CURTAIN WALL
LOOKING SOUTH**

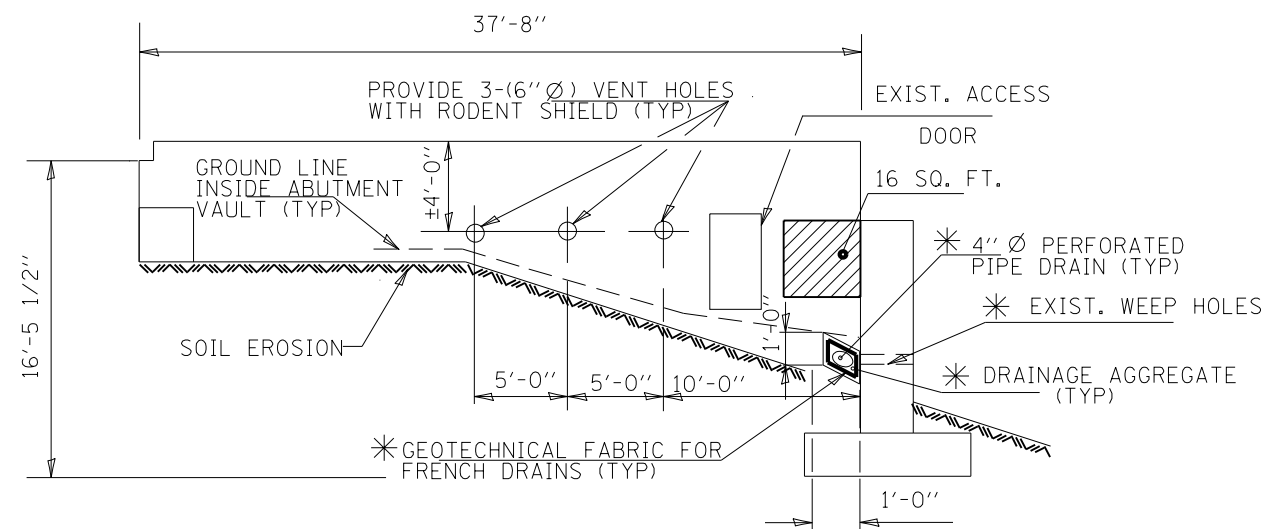
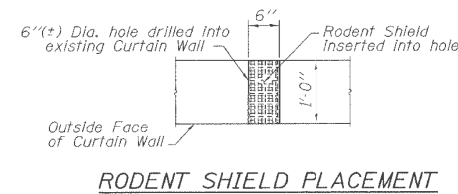
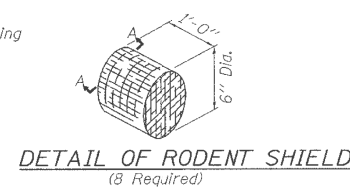
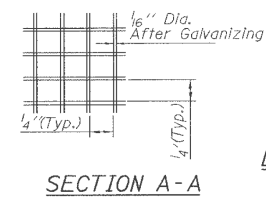

**WEST ABUTMENT CURTAIN WALL
LOOKING NORTH**

LEGEND:

STRUCTURAL REPAIR OF CONCRETE \leq 5"

NOTES:

COST OF CORING 12 VENT HOLES (3 EACH SIDE AT EACH ABUTMENT) AND SHIELDS INCLUDED WITH "STRUCTURAL REPAIR OF CONCRETE \leq 5".

* CLEAN EXISTING WEEP HOLE IN THE EXIST. WINGWALL TO ACCOMODATE THE 4"Ø PERFORATED PIPE DRAIN. AFTER INSTALLATION SEAL AROUND THE PIPE DRAIN. COST INCLUDED IN THE COST OF PIPE UNDERDRAINS FOR STRUCTURES 4".

EXCAVATED SOIL FOR PIPE UNDERDRAIN INSTALLATION SHALL BE PLACED ON TOP OF SLOPED GROUND INSIDE VAULT. COST INCLUDED IN " PIPE UNDERDRAIN FOR STRUCTURES 4".

BILL OF MATERIALS (CURTAIN WALLS)

ITEM	UNIT	QUANTITY
STRUCTURAL REPAIR OF CONCRETE \leq 5"	SQ. FT.	31.0

*FAI 290 & FAP 342

FILE NAME =	USER NAME = gorengautab	DESIGNED -	REVISD -
		DRAWN -	REVISD -
		CHECKED -	REVISD -
		DATE -	REVISD -

**STATE OF ILLINOIS
DEPARTMENT OF TRANSPORTATION**

**LOCATION NO 1. IL 53 EXTENSION AT LAKE-COOK RD (SN 016-3215)
CURTAIN WALL REPAIRS**

SCALE: _____ SHEET 5 OF 7 SHEETS STA. _____ TO STA. _____

F.A.I. RTE.	SECTION	COUNTY	TOTAL SHEETS	SHEET NO.
*	2012-026 BR	COOK & DuPAGE	29	9
CONTRACT NO. 60770			ILLINOIS FED. AID PROJECT	