

CABLE PLAN

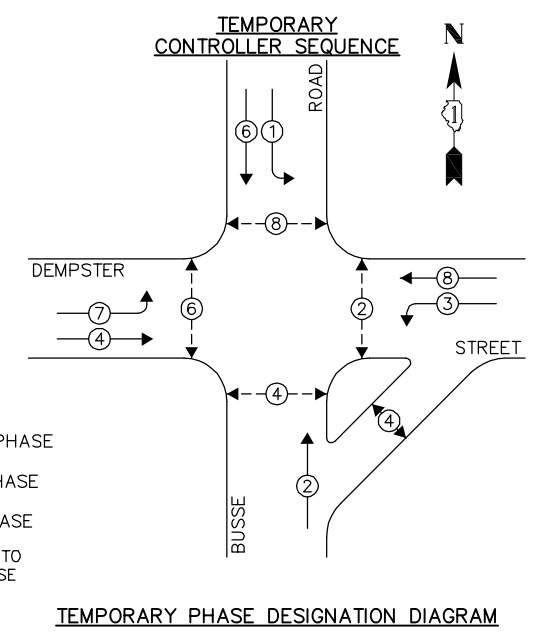

- LEGEND:**
- ← \* → SINGLE ENTRY PHASE
  - ← \* DUAL ENTRY PHASE
  - ← \* → PEDESTRIAN PHASE
  - \* NUMBER REFERS TO ASSOCIATED PHASE
  - ← \* OL → OVERLAP

TEMPORARY PHASE DESIGNATION DIAGRAM

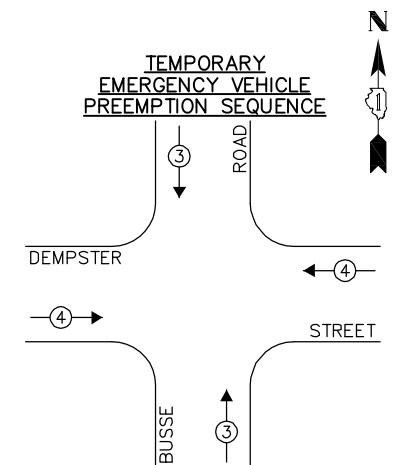

TEMPORARY EMERGENCY VEHICLE PREEMPTION SEQUENCE

TEMPORARY EMERGENCY VEHICLE PREEMPTORS		
EMERGENCY VEHICLE PREEMPTOR	3	4
MOVEMENT	↑	→

I.D.O.T. TRAFFIC SIGNAL INSTALLATION ELECTRICAL SERVICE REQUIREMENTS					TOTAL WATTAGE
TYPE	NO. LAMPS	WATTAGE		% OPERATION	
		INCAND.	L.E.D.		
SIGNAL (RED)	12	135	17	0.50	102.0
SIGNAL (YELLOW)	12	135	25	0.25	75.0
SIGNAL (GREEN)	12	135	15	0.25	45.0
ARROW	16	135	12	0.10	19.2
PED. SIGNAL	8	90	25	1.00	200.0
CONTROLLER	1	-	100	1.00	100.0
LUMINAIRE	-	-	250	0.50	-
L.E.D. ST. NAME SIGN	-	-	64	0.50	-
VIDEO SYSTEM	1	-	150	1.00	150.0
BATTERY BACKUP	1	-	25	1.00	25.0
ILLUMINATED SIGN	-	-	25	0.05	-
TOTAL =					716.2

ENERGY COSTS - BILLED TO: VILLAGE OF MOUNT PROSPECT  
 (ADDRESS) 1700 W. CENTRAL AVE  
 (ADDRESS) MT. PROSPECT, IL 60056  
 ENERGY SUPPLY - CONTACT: NEW BUSINESS  
 PHONE: (866) 639-3552  
 COMPANY: COM-ED LIBERTYVILLE

THE TRAFFIC SIGNAL CONTROL EQUIPMENT FOR THIS PROJECT SHALL BE "ECONOLITE" TO MATCH THE EXISTING ADJACENT SYSTEM.

USER NAME = ZACH WALLSTEN	DESIGNED - JRD	REVISED -
PLOT SCALE = 1" = .0833'	DRAWN - ZCW	REVISED -
PLOT DATE = 8/15/2012	CHECKED - KLB	REVISED -
	DATE - 8/15/2012	REVISED -

**STATE OF ILLINOIS**  
**DEPARTMENT OF TRANSPORTATION**

**TEMPORARY CABLE PLAN, TEMPORARY PHASE DESIGNATION DIAGRAM, & TEMPORARY VEHICLE PREEMPTION SEQUENCE**  
**DEMPSTER STREET AT BUSSE ROAD**

F.A.P. RTE.	SECTION	COUNTY	TOTAL SHEETS	SHEET NO.
-	2012-030TS	COOK	39	17
CONTRACT #:			60182	
ILINOIS FED. AID PROJECT				

FILE NAME = 4085.882-Cable.dwg



GHA #4085.882