

CABLE PLAN

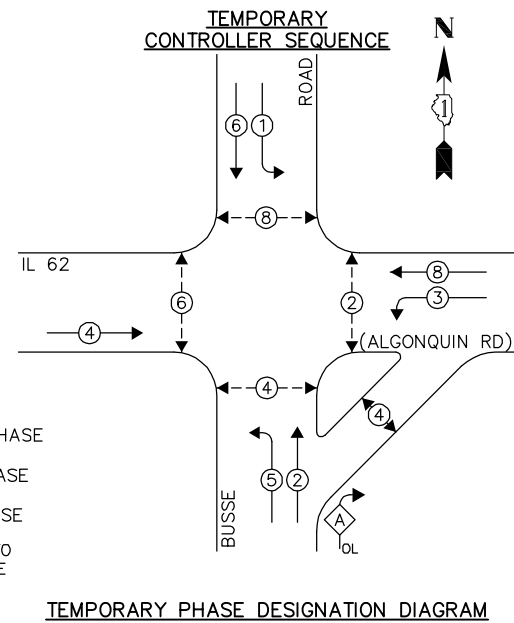

TEMPORARY PHASE DESIGNATION DIAGRAM

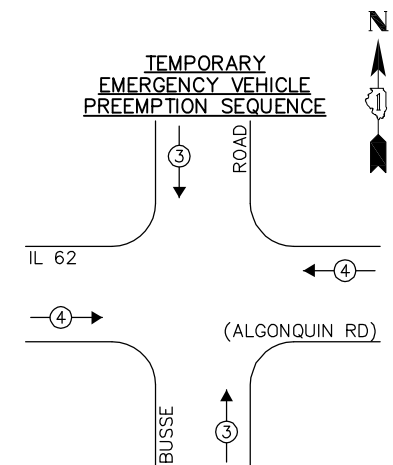

TEMPORARY EMERGENCY VEHICLE PREEMPTION SEQUENCE

TEMPORARY EMERGENCY VEHICLE PREEMPTORS		
EMERGENCY VEHICLE PREEMPTOR	3	4
MOVEMENT	↑	→

I.D.O.T. TRAFFIC SIGNAL INSTALLATION ELECTRICAL SERVICE REQUIREMENTS					TOTAL WATTAGE
TYPE	NO. LAMPS	INCAND.	L.E.D.	% OPERATION	
SIGNAL (RED)	12	135	17	0.50	102.0
SIGNAL (YELLOW)	12	135	25	0.25	75.0
SIGNAL (GREEN)	12	135	15	0.25	45.0
ARROW	12	135	12	0.10	14.4
PED. SIGNAL	8	90	25	1.00	200.0
CONTROLLER	1	-	100	1.00	100.0
LUMINAIRE	-	-	250	0.50	-
L.E.D. ST. NAME SIGN	-	-	64	0.50	-
VIDEO SYSTEM	1	-	150	1.00	150.0
BATTERY BACKUP	1	-	25	1.00	25.0
ILLUMINATED SIGN	-	-	25	0.05	-
TOTAL =					711.4

ENERGY COSTS - BILLED TO: VILLAGE OF MOUNT PROSPECT
 (ADDRESS) 1700 W. CENTRAL AVE
 (ADDRESS) MT. PROSPECT, IL 60056
 ENERGY SUPPLY - CONTACT: NEW BUSINESS
 PHONE: (866) 639-3552
 COMPANY: COM-ED LIBERTYVILLE

THE TRAFFIC SIGNAL CONTROL EQUIPMENT FOR THIS PROJECT SHALL BE "ECONOLITE" TO MATCH THE EXISTING ADJACENT SYSTEM.

USER NAME = ZACH WALLSTEN	DESIGNED - JRD	REVISED -
PLOT SCALE = 1" = .0833'	DRAWN - ZCW	REVISED -
PLOT DATE = 8/15/2012	CHECKED - KLB	REVISED -
	DATE - 8/15/2012	REVISED -

**STATE OF ILLINOIS
DEPARTMENT OF TRANSPORTATION**

**TEMPORARY CABLE PLAN, TEMPORARY PHASE DESIGNATION
DIAGRAM, & TEMPORARY VEHICLE PREEMPTION SEQUENCE
IL 62 (ALGONQUIN RD) AT BUSSE ROAD**

F.A.P. RTE.	SECTION	COUNTY	TOTAL SHEETS	SHEET NO.
-	2012-030TS	COOK	39	23
CONTRACT #:			60182	
ILLINOIS FED. AID PROJECT				

FILE NAME = 4085.882-Cable.dwg

GHA #4085.882