

TRAFFIC DATA

US-12/20/45 (W. LA GRANGE RD)
 2009 ADT = 74,300
 POSTED SPEED LIMIT = 45 MPH

R 12 E

T 38 N

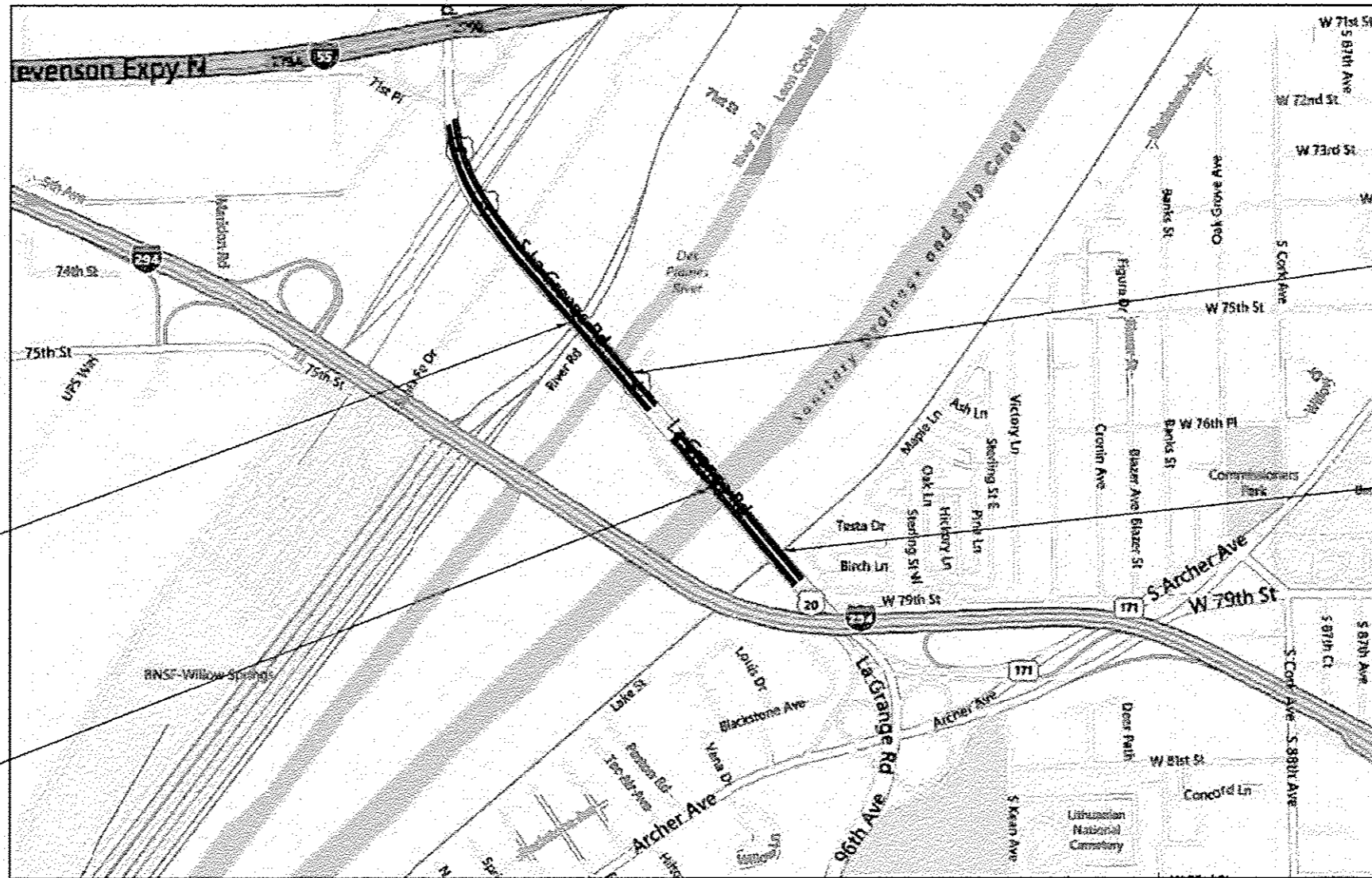

LOCATION 1
 SN 016-2407
 US-12/20/45 SB (LA GRANGE RD)
 OVER DES PLAINES RIVER,
 SANTA FE DR, ET AL
 VILLAGE OF HODGKINS

LOCATION 3
 SN 016-2406
 US-12/20/45 SB (LA GRANGE RD)
 OVER S&S CANAL, I&M CANAL,
 AND ICG RR
 VILLAGE OF WILLOW SPRINGS

LOCATION 2
 SN 016-2467
 US-12/20/45 NB (LA GRANGE RD)
 OVER DES PLAINES RIVER,
 SANTA FE DR, ET AL
 VILLAGE OF HODGKINS

LOCATION 4
 SN 016-2468
 US-12/20/45 NB (LA GRANGE RD)
 OVER S&S CANAL, I&M CANAL,
 AND ICG RR
 VILLAGE OF WILLOW SPRINGS

LYONS TOWNSHIP

FILE NAME *	USER NAME *	DESIGNED -	REVISED -
di:\p\work\pavido\pughst\0013773\0100512-shrt-plan.dgn	pughst	DRAWN -	REVISED -
PLOT SCALE * 1/80.0000 ** 1/16		CHECKED -	REVISED -
PLOT DATE * 9/21/2012		DATE -	REVISED -

STATE OF ILLINOIS
 DEPARTMENT OF TRANSPORTATION

BRIDGE PAINTING LOCATION MAP - COOK COUNTY
 US 12/20/45 (LA GRANGE ROAD)

SCALE: SHEET 1 OF 1 SHEETS STA. TO STA.

F.A. RTE.	SECTION	COUNTY	TOTAL SHEETS	SHEET NO.
330	2012-054 BP	COOK	75	5
CONTRACT NO. 60V56				
ILLINOIS FED. AID PROJECT				