

DATE	BY
SURVEYED	
PLOTTED	
TEMPLATE	
NOTE BOOK	
AREAS CHECKED	
NO.	

DATE	BY
SURVEYED	
PLOTTED	
TEMPLATE	
NOTE BOOK	
AREAS CHECKED	
NO.	

FILE NAME = s:\proj\63800-68701\6842\887\mstrs\crosdtd\104+50.00.dwg

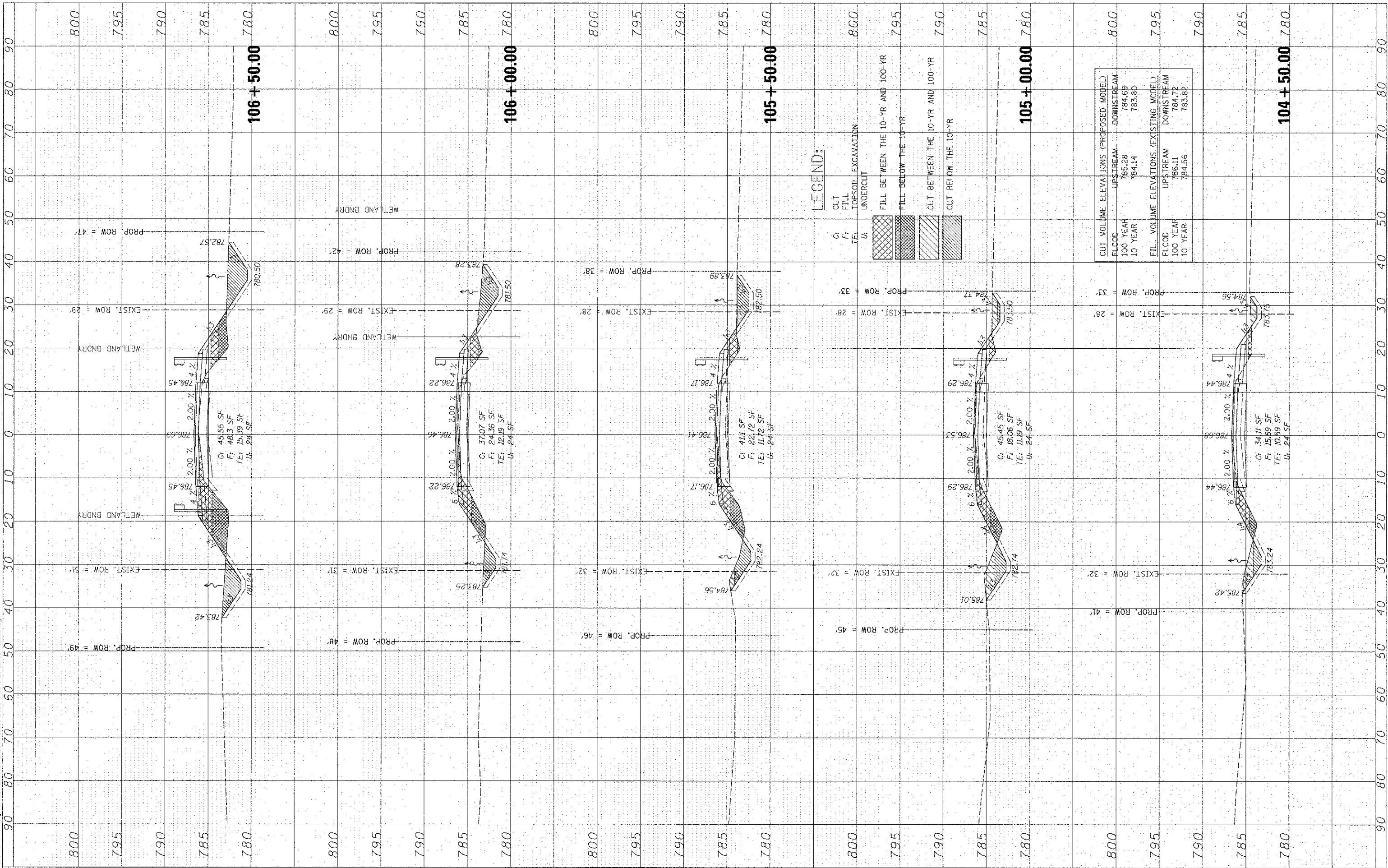

LEGEND:

- C: CUT
 - F: FILL
 - TE: TOPSOIL EXCAVATION
 - U: UNDERCUT
- FILL BETWEEN THE 10-YR AND 100-YR
 FILL BELOW THE 10-YR
 CUT BETWEEN THE 10-YR AND 100-YR
 CUT BELOW THE 10-YR

CUT VOLUME ELEVATIONS (PROPOSED MODEL)	
FLOOD	UPSTREAM 784.69
100 YEAR	785.28
10 YEAR	784.14
DOWNSTREAM	783.80
FILL VOLUME ELEVATIONS (EXISTING MODEL)	
FLOOD	UPSTREAM 786.11
100 YEAR	784.56
10 YEAR	784.56
DOWNSTREAM	784.72
	783.82



USER NAME = dennisw	DESIGNED -	REVISED -
PLT SCALE = 1/8" = 1' / IN.	DRAWN -	REVISED -
PLT DATE = 8/23/2012	CHECKED -	REVISED -
	DATE -	REVISED -

**STATE OF ILLINOIS
DEPARTMENT OF TRANSPORTATION**

CROSS SECTIONS

SCALE: SHEET OF SHEETS STA. 104+50.00 TO STA. 106+50.00

F.A.P. RTE. 646	SECTION 101 BR-3	COUNTY WHITESIDE	TOTAL SHEETS 77	SHEET NO. 72
ILLINOIS FED. AID PROJECT				CONTRACT NO. 64C17