

SECTION A-A

BILL OF MATERIAL

Bar	No.	Size	Length	Shape
$h_1(E)$	36	#5	10'-7"	—
$p_2(E)$	10	#7	17'-11"	—
$p_3(E)$	10	#7	26'-5"	—
$s(E)$	96	#4	9'-1"	U
$u(E)$	10	#6	9'-10"	—
$v_1(E)$	46	#5	3'-6"	L
$v_2(E)$	14	#5	10'-4"	—
Structure Excavation			Cu. Yd.	100
Concrete Structures			Cu. Yd.	20.8
Reinforcement Bars, Epoxy Coated			Pound	2360
Furnishing Metal Shell Piles 12"x0.25"			Foot	280
Driving Piles			Foot	280
Test Pile Metal Shells			Each	1
Bar Splicers			Each	10
Protective Coat			Sq. Yd.	9

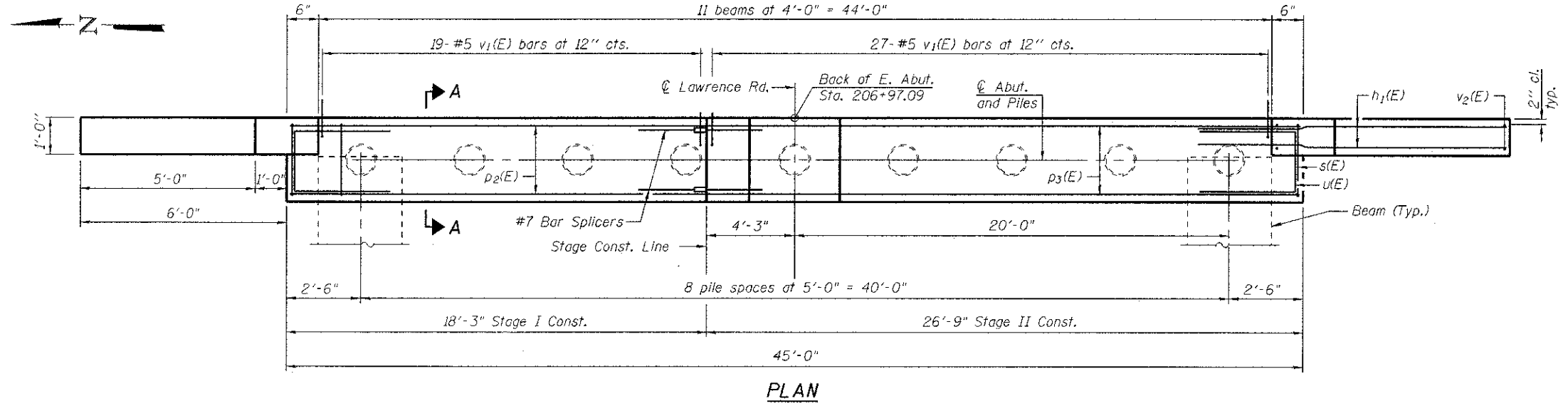

PILE DATA

Type: Metal Shell Piles 12" ϕ with 0.25" walls
 Nominal Required Bearing: 264 kips
 Factored Resistance Available: 145 kips
 Est. Length: 35'
 No. Production Piles: 8
 No. Test Piles: 1

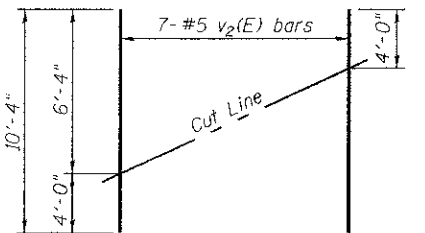

FIELD CUTTING DIAGRAM

Order $v_2(E)$ bars full length. Cut as shown and use remainder of bars in opposite face.

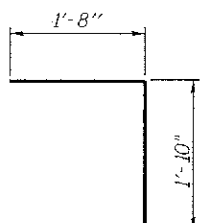
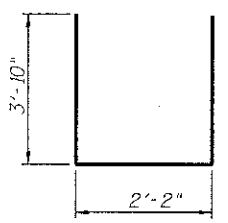
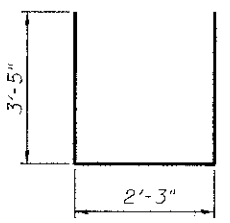

AD-1721-0

7-1-10

Bollinger, Lach & Associates, Inc.
 ITASCA, ILLINOIS

USER NAME = gonzalo
 DESIGNED JMT
 CHECKED JJI
 DRAWN GM
 CHECKED JJI
 PLOT SCALE =
 PLOT DATE = 8/17/2012

DESIGNED JMT
 CHECKED JJI
 REVISIONS:
 REVISIONS:
 REVISIONS:
 REVISIONS:

McHENRY COUNTY
DIVISION OF TRANSPORTATION
LAWRENCE ROAD BRIDGE OVER PISCASAW CREEK

EAST ABUTMENT
STRUCTURE NO. 056-3184
 SHEET NO. 22 OF 33 SHEETS

F.A.S. RTE.	SECTION	COUNTY	TOTAL SHEETS	SHEET NO.
0028	08-00355-01-BR	McHENRY	87	54

CONTRACT NO. 63694
 ILLINOIS FED. AID PROJECT

FILE NAME: s:\1755-012 Invercove phase 1\Acadd sheets\structure\0863184-0808-022.dgn