

SURVEYED \_\_\_\_\_  
 PLOTTED \_\_\_\_\_  
 NOTE BOOK \_\_\_\_\_  
 NO. \_\_\_\_\_  
 AREAS CHECKED \_\_\_\_\_

SURVEYED \_\_\_\_\_  
 PLOTTED \_\_\_\_\_  
 NOTE BOOK \_\_\_\_\_  
 NO. \_\_\_\_\_  
 AREAS CHECKED \_\_\_\_\_

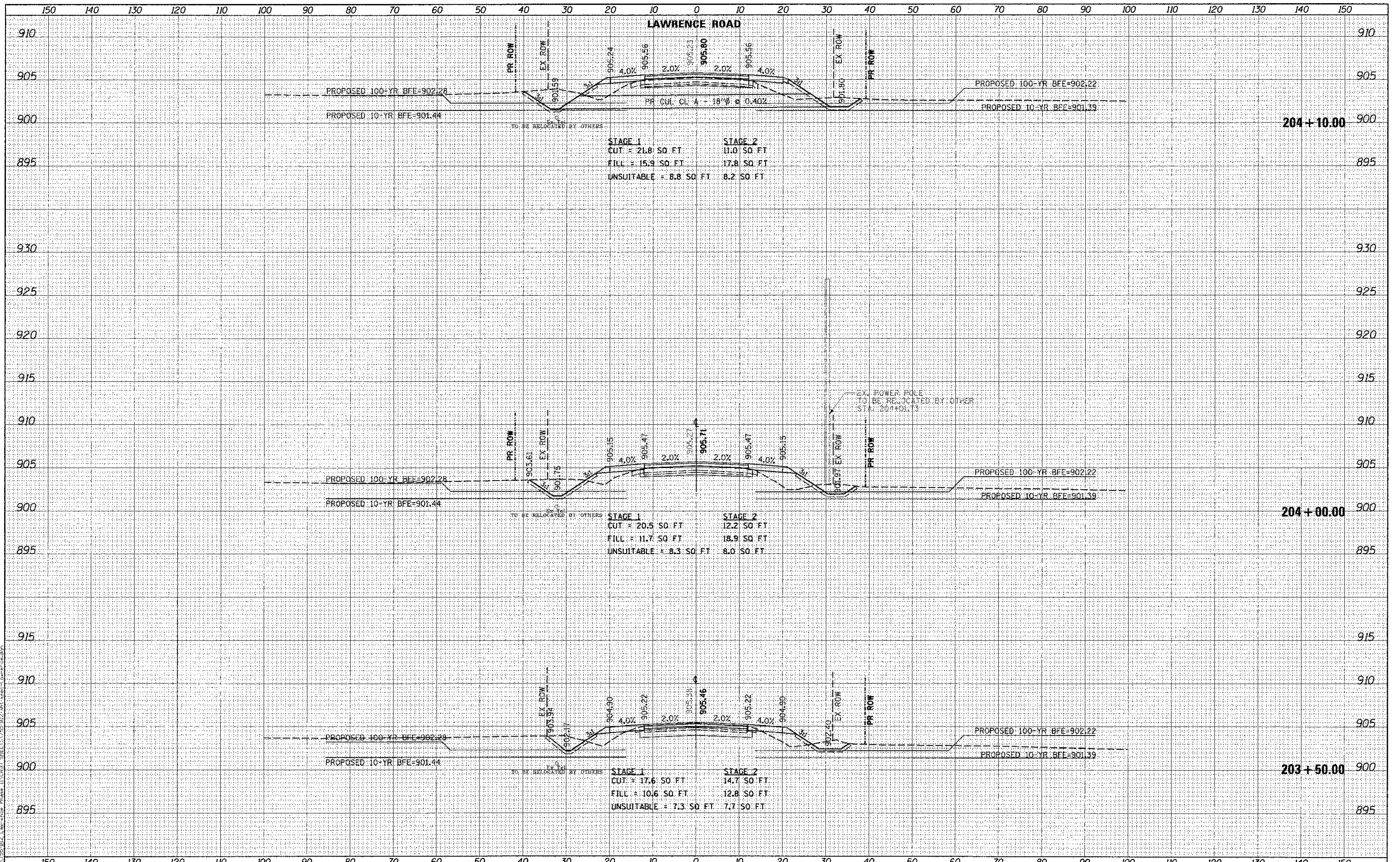

**Bollinger, Lach & Associates, Inc.**  
 FTASCA, ILLINOIS

USER NAME = gollwanger  
 PLOT SCALE = 10.0000' / in.  
 PLOT DATE = 10/3/2012

DESIGNED - GJE  
 DRAWN - GJE  
 CHECKED - CRF  
 DATE - 08/17/12

REVISED -  
 REVISED -  
 REVISED -  
 REVISED -

**MCHENRY COUNTY**  
**DIVISION OF TRANSPORTATION**  
**LAWRENCE ROAD BRIDGE OVER PISCASAW CREEK**  
**LAWRENCE ROAD CROSS SECTION**  
 1"=5' VT  
 SCALE: 1"=10' HZ

F.A.S. RTE. 0028	SECTION 08-00355-01-BR	COUNTY MCHENRY	TOTAL SHEETS 87	SHEET NO. 76
				CONTRACT NO. 63694
ILLINOIS FED. AID PROJECT				

FILE NAME = M:\255-012 Lawrence Phase II\2010 SHEETS\255-012-10-03-2012.dwg