

SURVEYED  
 PLOTTED  
 NO. 1 BOOK  
 SURVEY  
 PLOTTED  
 TEMPLATE  
 AREAS  
 CHECKED  
 DATE

SURVEYED  
 PLOTTED  
 NO. 1 BOOK  
 SURVEY  
 PLOTTED  
 TEMPLATE  
 AREAS  
 CHECKED  
 DATE

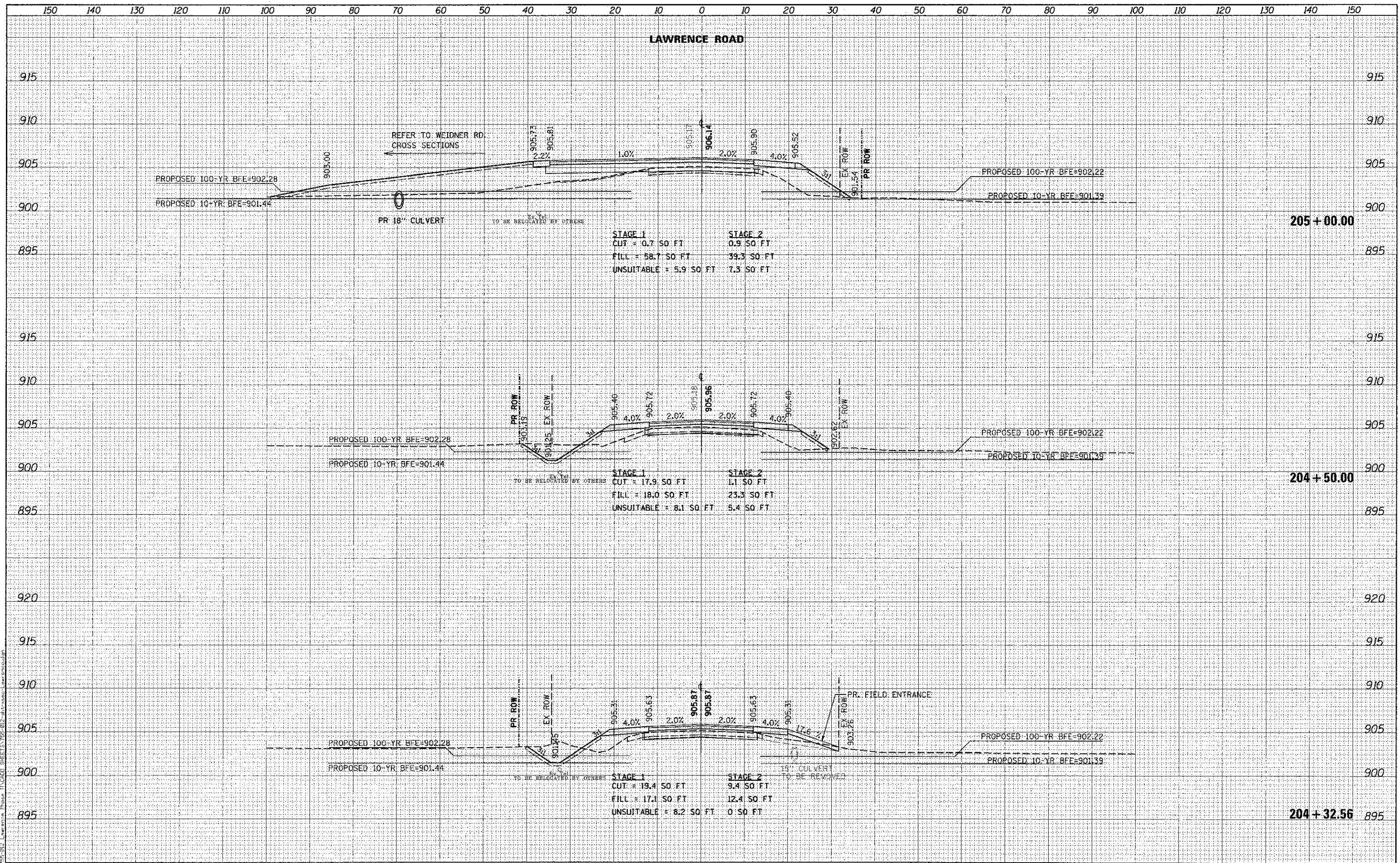

**Bollinger, Lach & Associates, Inc.**  
 ITASCA, ILLINOIS

USER NAME = gollwanger  
 DESIGNED - GJE  
 DRAWN - GJE  
 CHECKED - CRF  
 PLOT DATE = 08/17/12

REVISED -  
 REVISED -  
 REVISED -  
 REVISED -  
 REVISED -

**MCHENRY COUNTY**  
**DIVISION OF TRANSPORTATION**

**LAWRENCE ROAD BRIDGE OVER PISCASAW CREEK**  
**LAWRENCE ROAD CROSS SECTION**

SCALE: 1"=10' HZ  
 SHEET NO. 77 OF 87 SHEETS  
 STA. 204+32.56 TO STA. 205+00.00

F.A.S. RTE. 0028	SECTION 08-00355-01-BR	COUNTY MCHENRY	TOTAL SHEETS 87	SHEET NO. 77
CONTRACT NO. 63694			ILLINOIS FED. AID PROJECT	