

STAGE 1

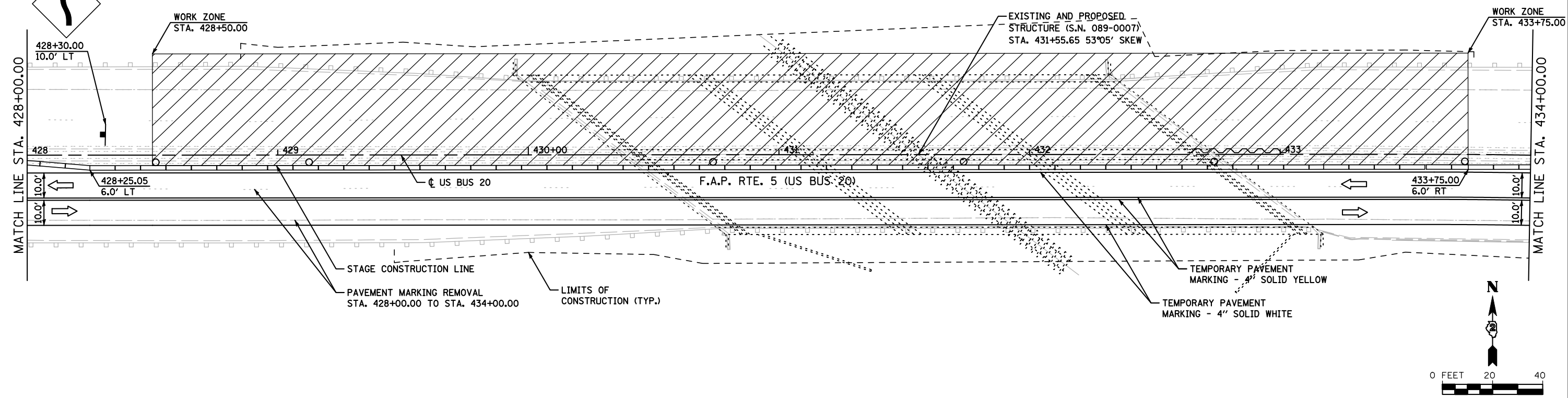

STAGE 1 NOTES:

1. INSTALL TEMPORARY TRAFFIC SIGNS ACCORDING TO STANDARD 701431.
2. CONSTRUCT THE NORTH SIDE OF THE BRIDGE INCLUDING SHOULDERS AND GUARDRAIL.
3. INSTALL TEMPORARY CONCRETE BARRIER ACCORDING TO STANDARD 704001.
4. DRIVE TEMPORARY SHEET PILING AS REQUIRED.
5. HOT-MIX ASPHALT SURFACE REMOVAL, 1 1/2" FROM STA. 415+00.00 TO STA. 428+85.04 LT, STA. 433+48.34 TO STA. 448+45.00 LT USING STANDARD 701421.
6. PLACE 1 1/2" HOT-MIX ASPHALT SURFACE COURSE MIX "C", N50 FROM STA. 415+00.00 TO STA. 428+85.04 LT, STA. 433+48.34 TO STA. 448+45.00 LT WHERE SHOULDER WILL BE DRIVEN ON FOR STAGE 2 CONSTRUCTION.

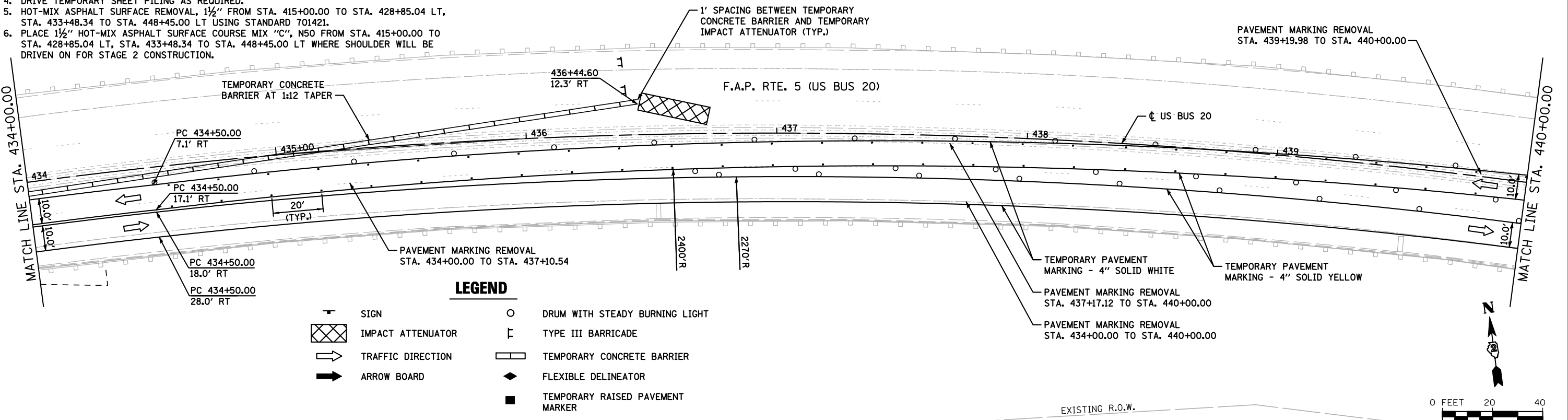

LEGEND

	SIGN		DRUM WITH STEADY BURNING LIGHT
	IMPACT ATTENUATOR		TYPE III BARRICADE
	TRAFFIC DIRECTION		TEMPORARY CONCRETE BARRIER
	ARROW BOARD		FLEXIBLE DELINEATOR
			TEMPORARY RAISED PAVEMENT MARKER

FILE NAME = s:\p1\6380--6395\6346\025\macro\cadd sheets\12264E76-ahf-stage1-03.dgn

SA STRAND ASSOCIATES
1170 SOUTH HOUBOLT ROAD
JOLIET, ILLINOIS 60431
(815) 744-4200

USER NAME = briant
DESIGNED - EMD
DRAWN - BJB
PLOT SCALE = 48.0000' / IN.
CHECKED - MAG
DATE - 03/13/12
REVISD -

DESIGNED - EMD
DRAWN - BJB
CHECKED - MAG
DATE - 03/13/12
REVISD -

DESIGNED - EMD
DRAWN - BJB
CHECKED - MAG
DATE - 03/13/12
REVISD -

**STATE OF ILLINOIS
DEPARTMENT OF TRANSPORTATION**

**SUGGESTED MAINTENANCE OF TRAFFIC
STAGE I**
SCALE: AS SHOWN SHEET NO. OF SHEETS STA. 428+00.00 TO STA. 440+00.00

F.A.P. RTE.	SECTION	COUNTY	TOTAL SHEETS	SHEET NO.
5	(19VB-1D)	STEPHENS	73	23
CONTRACT NO. 64E76				
FED. ROAD DIST. NO. 2 (ILLINOIS) FED. AID PROJECT				