

STAGE 2

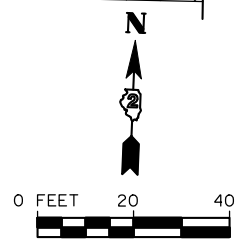

STAGE 2 NOTES:

1. RELOCATE TEMPORARY TRAFFIC SIGNS ACCORDING TO STANDARD 701431.
2. CONSTRUCT THE SOUTH SIDE OF THE BRIDGE INCLUDING SHOULDERS AND GUARDRAIL.
3. RELOCATE TEMPORARY CONCRETE BARRIER ACCORDING TO STANDARD 704001.
4. REMOVE TRAFFIC CONTROL AND TEMPORARY TRAFFIC SIGNS FROM STAGE II MAINTENANCE OF TRAFFIC DETAILS USING STANDARD 701431.
5. INSTALL PERMANENT PAVEMENT MARKINGS AND SHOULDER RUMBLE STRIPS, 8" USING STANDARDS 701421 AND 701426.

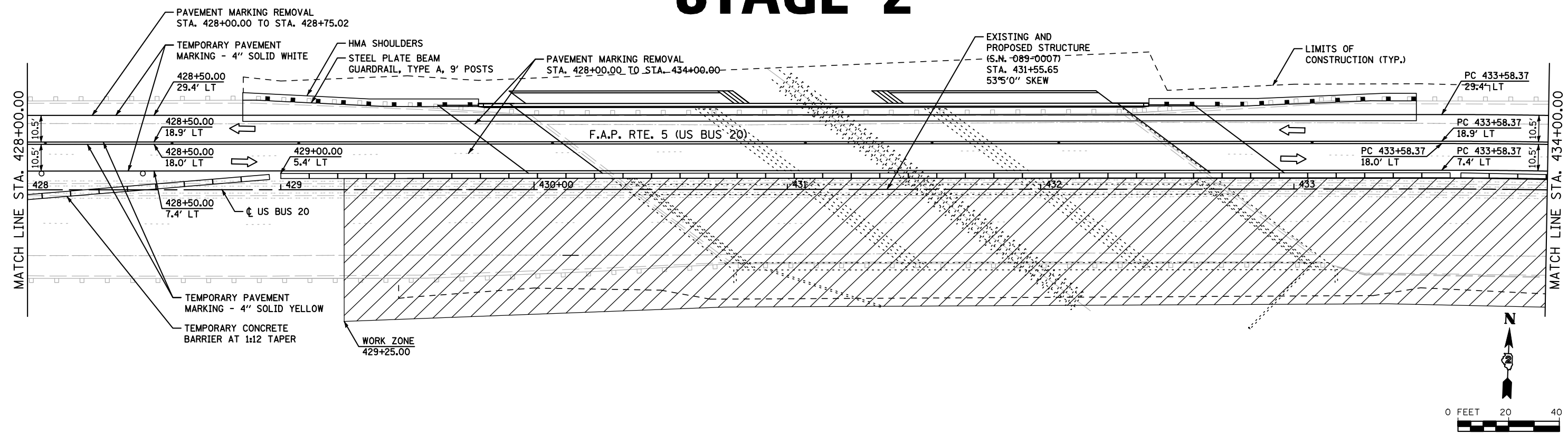
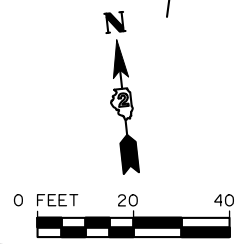
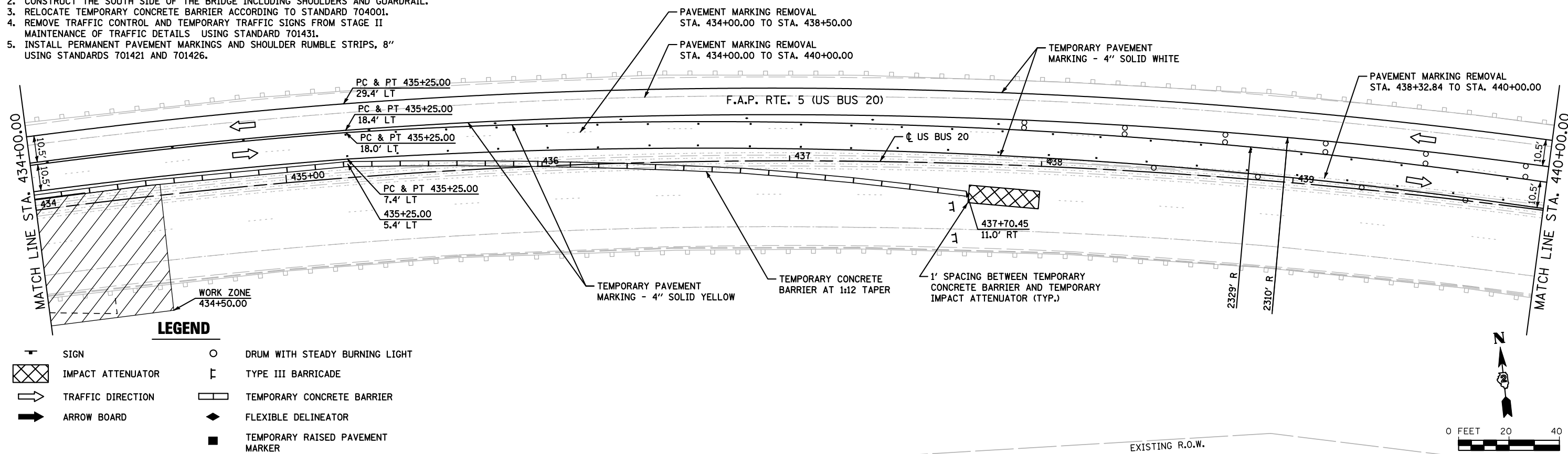

LEGEND

- | | | | |
|--|-------------------|--|----------------------------------|
| | SIGN | | DRUM WITH STEADY BURNING LIGHT |
| | IMPACT ATTENUATOR | | TYPE III BARRICADE |
| | TRAFFIC DIRECTION | | TEMPORARY CONCRETE BARRIER |
| | ARROW BOARD | | FLEXIBLE DELINEATOR |
| | | | TEMPORARY RAISED PAVEMENT MARKER |

FILE NAME = s:\p1\6380--6395\6346\025\micro\cadd sheets\PI168K77-ahc-staging2-02.dgn

SA STRAND ASSOCIATES
1170 SOUTH HOUBOLT ROAD
JOLIET, ILLINOIS 60431
(815) 744-4200

USER NAME = briant	DESIGNED - EMD	REVISED -
PLOT SCALE = 40.0000' / IN.	DRAWN - BJF	REVISED -
PLOT DATE = 8/6/2012	CHECKED - MAG	REVISED -
	DATE - 03/13/12	REVISED -

**STATE OF ILLINOIS
DEPARTMENT OF TRANSPORTATION**

SUGGESTED MAINTENANCE OF TRAFFIC STAGE II			
SCALE: AS SHOWN	SHEET NO.	OF SHEETS	STA. 428+00.00 TO STA. 440+00.00

F.A.P. RTE.	SECTION	COUNTY	TOTAL SHEETS	SHEET NO.
5	(19VB-1)D	STEPHENSON	73	28
CONTRACT NO. 64E76				
FED. ROAD DIST. NO. 2 (ILLINOIS) FED. AID PROJECT				