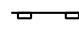
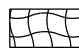

NOTES:

1. ALL ITEMS SHALL BE CONSTRUCTED AS SHOWN ON THE PLANS, ON STANDARD 280001, AND AS DIRECTED BY THE ENGINEER.
2. TEMPORARY EROSION CONTROL SEEDING TO BE USED ON ALL ERODIBLE/BARE AREAS.
3. EROSION CONTROL MEASURES TO BE IN PLACE BEFORE DISTURBING THE GROUND.

LEGEND

-  PERIMETER EROSION BARRIER
-  HEAVY DUTY EROSION CONTROL BLANKET, AND SEEDING, CLASS 2A

• SEEDING, CLASS 2A TO BE PAID FOR AS EARTH EXCAVATION. SEE GENERAL NOTES.

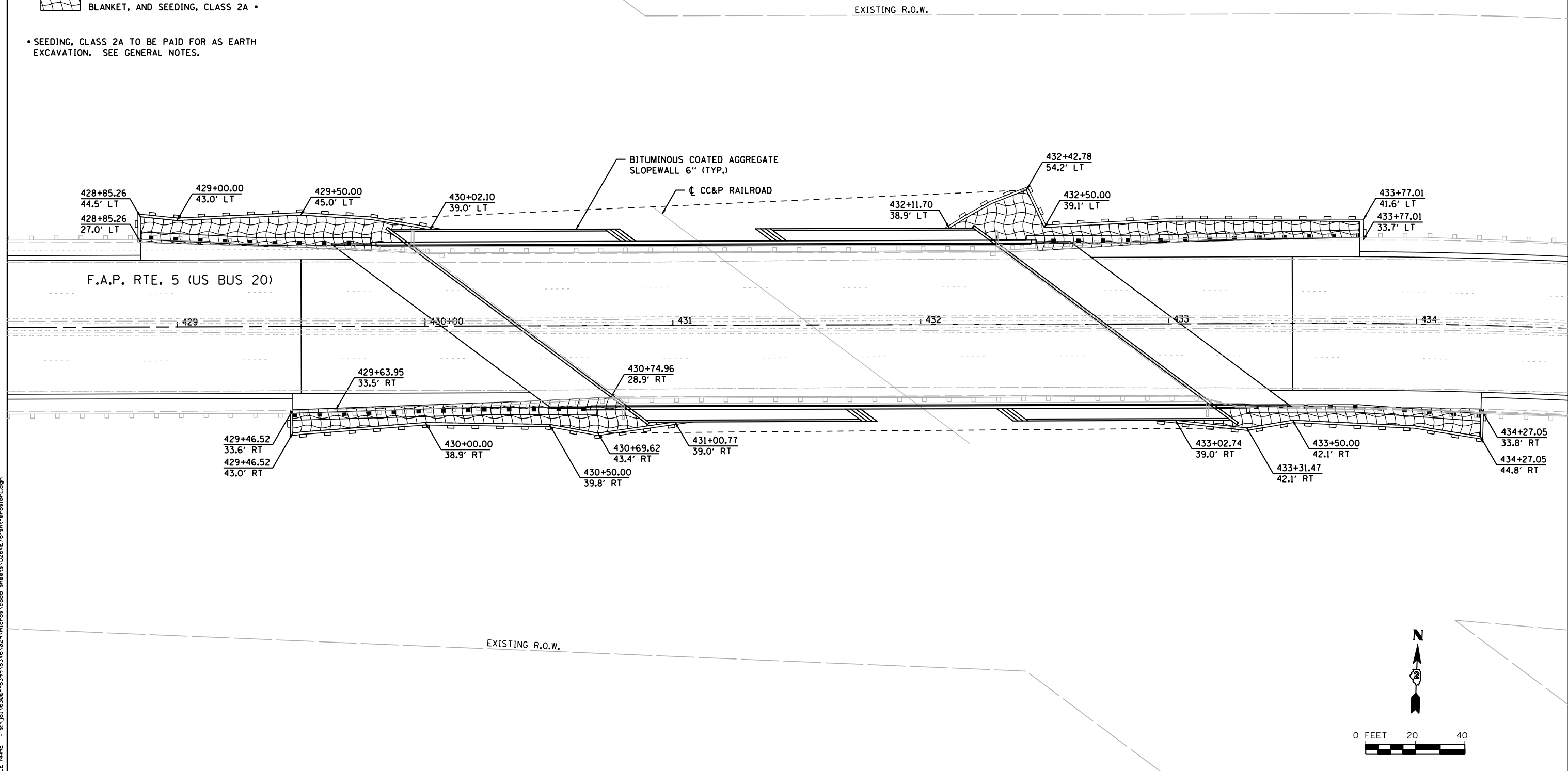

FILE NAME = s:\p1\6380--6395\6346\025\micro\cadd sheets\0264E76-sh-erosion.dgn

SA STRAND ASSOCIATES
 1170 SOUTH HOUBOLT ROAD
 JOLIET, ILLINOIS 60431
 (815) 744-4200

USER NAME = brianf	DESIGNED - EMD	REVISED -
DRAWN - BJF	REVISIONS -	
PLOT SCALE = 40.0000' / IN.	CHECKED - MAG	REVISED -
PLOT DATE = 8/6/2012	DATE - 03/13/12	REVISED -

**STATE OF ILLINOIS
 DEPARTMENT OF TRANSPORTATION**

EROSION CONTROL	
SCALE: AS SHOWN	SHEET NO. 1 OF 1 SHEETS
STA. 428+50.00 TO STA. 434+50.00	

F.A.P. RTE.	SECTION	COUNTY	TOTAL SHEETS	SHEET NO.
5	(19VB-1)D	STEPHENSON	73	31
CONTRACT NO. 64E76				
FED. ROAD DIST. NO. 2 [ILLINOIS] FED. AID PROJECT				