

DATE	
BY	
REVISIONS	
NO.	
DATE	
BY	
REVISIONS	
NO.	
DATE	
BY	
REVISIONS	
NO.	

DATE	
BY	
REVISIONS	
NO.	
DATE	
BY	
REVISIONS	
NO.	
DATE	
BY	
REVISIONS	
NO.	

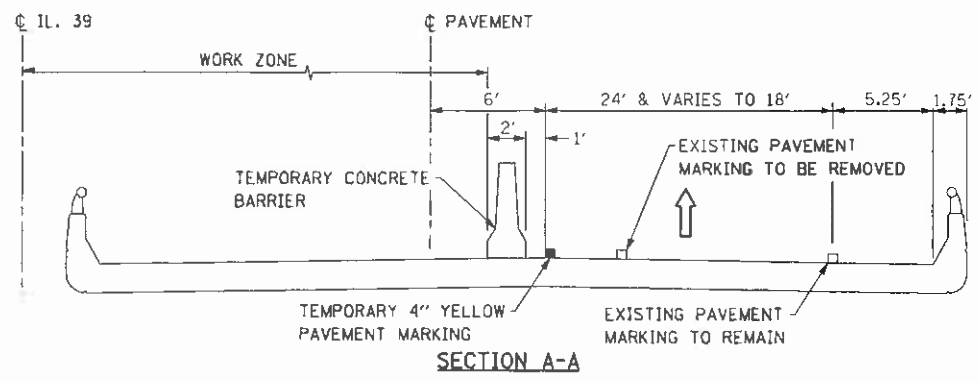

- LEGEND**
- PROPOSED HMA SURFACE REMOVAL, 2" HMA SURFACE COURSE, MIX 'C', N50, 2"
 - TEMPORARY CONCRETE BARRIER
 - IMPACT ATTENUATOR, TEMPORARY (NON-REDIRECTIVE) TEST LEVEL 3
 - TRAFFIC FLOW ARROW
 - WORK ZONE
 - DRUMS SPACED AT INTERVALS AS NOTED
 - TEMPORARY SIGN WITH MESSAGE
 - TYPE III BARRICADES

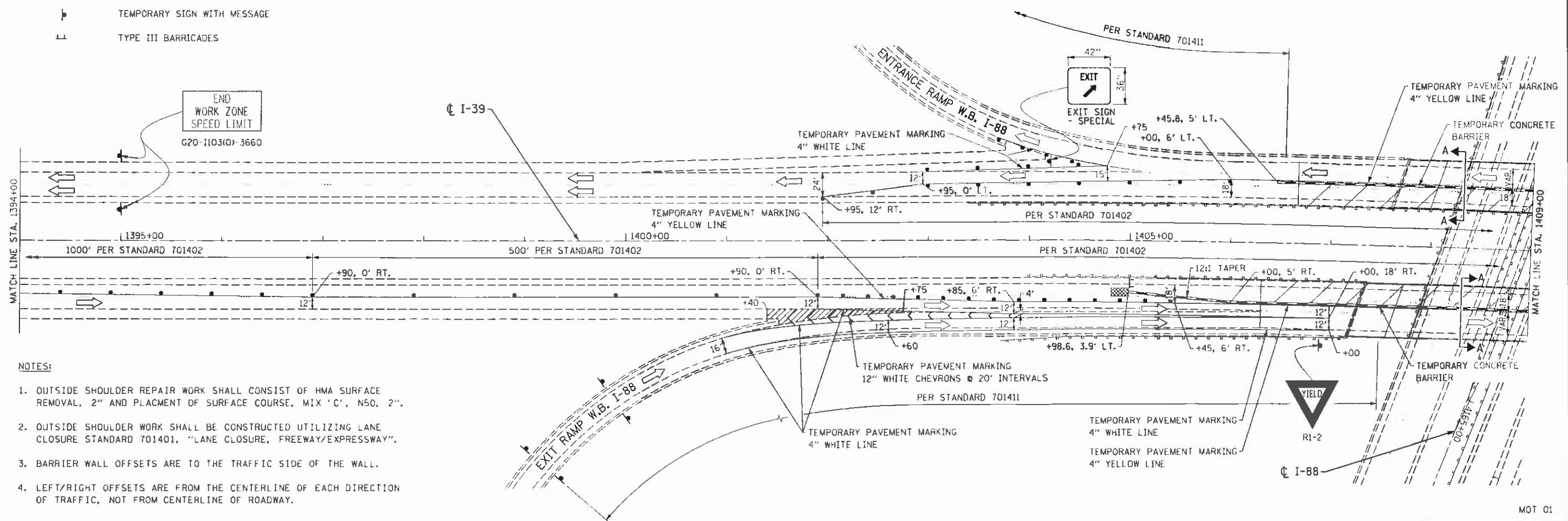
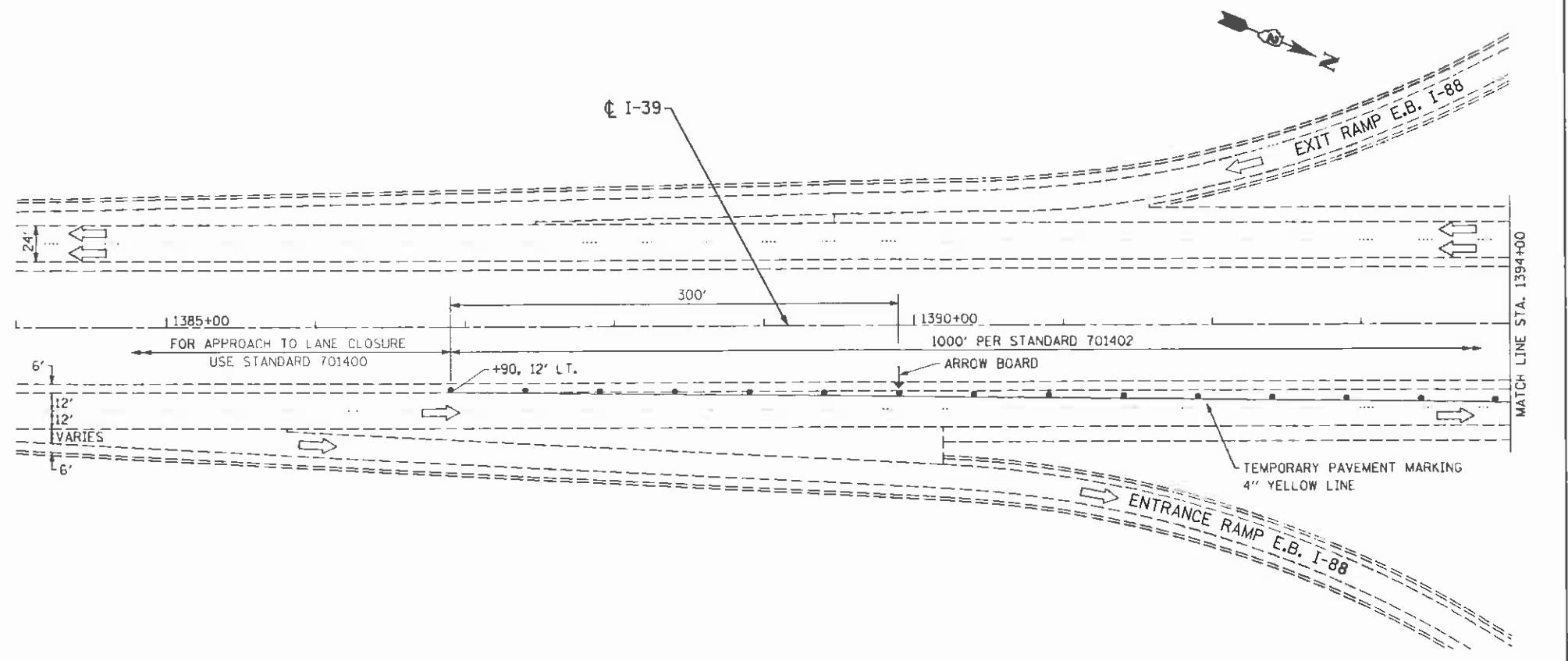

- NOTES:**
1. OUTSIDE SHOULDER REPAIR WORK SHALL CONSIST OF HMA SURFACE REMOVAL, 2" AND PLACMENT OF SURFACE COURSE, MIX 'C', N50, 2".
 2. OUTSIDE SHOULDER WORK SHALL BE CONSTRUCTED UTILIZING LANE CLOSURE STANDARD 701401, "LANE CLOSURE, FREEWAY/EXPRESSWAY".
 3. BARRIER WALL OFFSETS ARE TO THE TRAFFIC SIDE OF THE WALL.
 4. LEFT/RIGHT OFFSETS ARE FROM THE CENTERLINE OF EACH DIRECTION OF TRAFFIC, NOT FROM CENTERLINE OF ROADWAY.

FILE NAME - wht-stg01.dgn
 PLOT DATE - 8/7/2012
 PLOT SCALE - 50.0000 / IN.

CHRISTIAN ROGE & ASSOCIATES, INC.
 ENGINEERS-PLANNERS-SURVEYORS
 211 WEST WACKER DRIVE
 CHICAGO, ILLINOIS 60606
 PHONE: (312)372-2023 FAX: (312)372-5274

DESIGNED -	E.M.	REVISED -	
DRAWN -	B.K.	REVISED -	
CHECKED -	G.F.L.	REVISED -	
DATE -	AUGUST 2012	REVISED -	

STATE OF ILLINOIS
DEPARTMENT OF TRANSPORTATION

TRAFFIC CONTROL AND PROTECTION
I-39 OVER I-88
STAGE I

SCALE: SHEET NO. OF SHEETS STA. TO STA.

FILE NO.	SECTION	COUNTY	TOTAL SHEETS	SHEET NO.
39	D2 DECK REPAIR 2013-1	OGLE	32	8
CONTRACT NO. 64H73				
FED. ROAD DIST. NO. 1 ILLINOIS FED. AID PROJECT				

MOT 01