

DATE	
BY	
APPROVED	
PROJ. NO.	
NOTE BOOK	
AREAS CHECKED	
NO.	

DATE	
BY	
APPROVED	
PROJ. NO.	
NOTE BOOK	
AREAS CHECKED	
NO.	

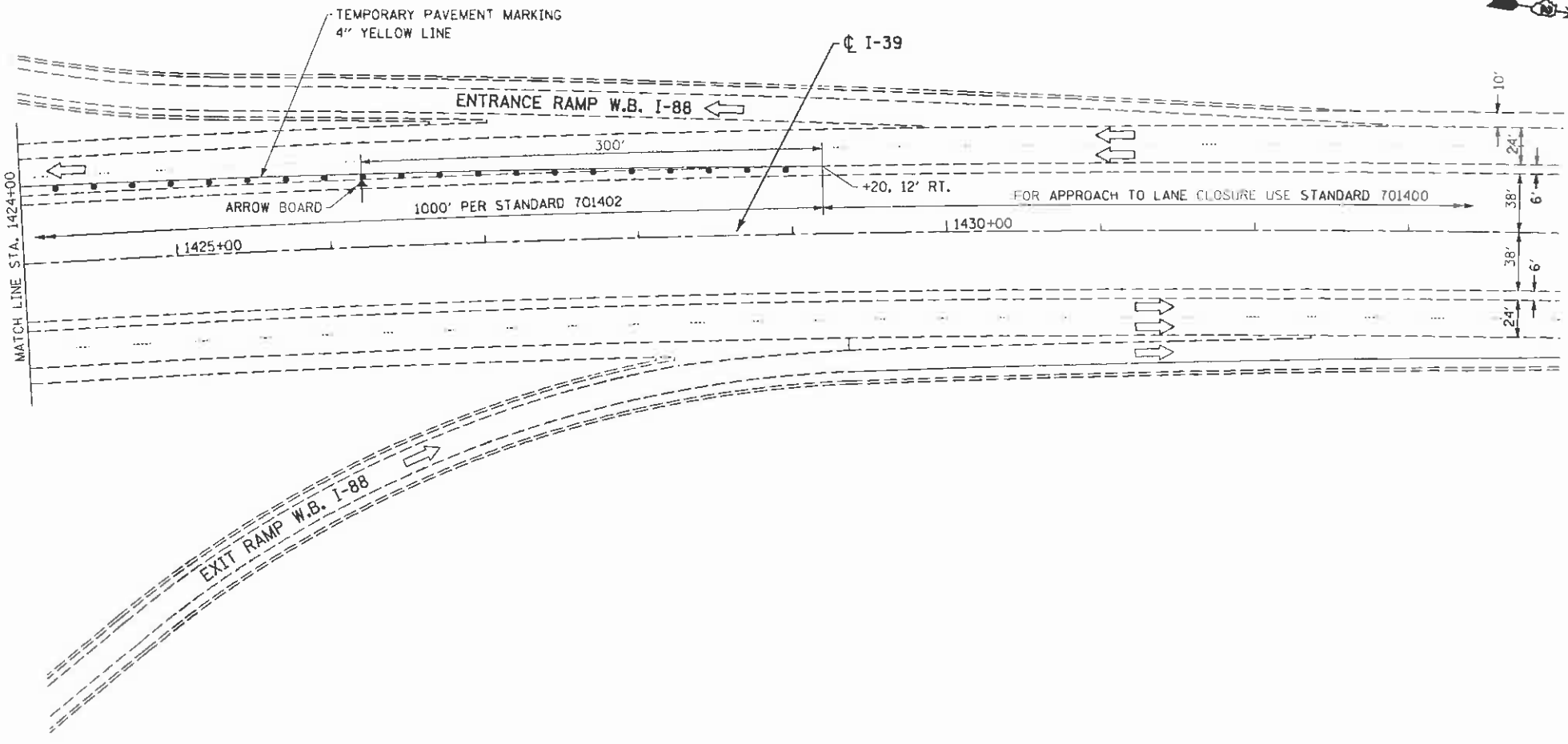
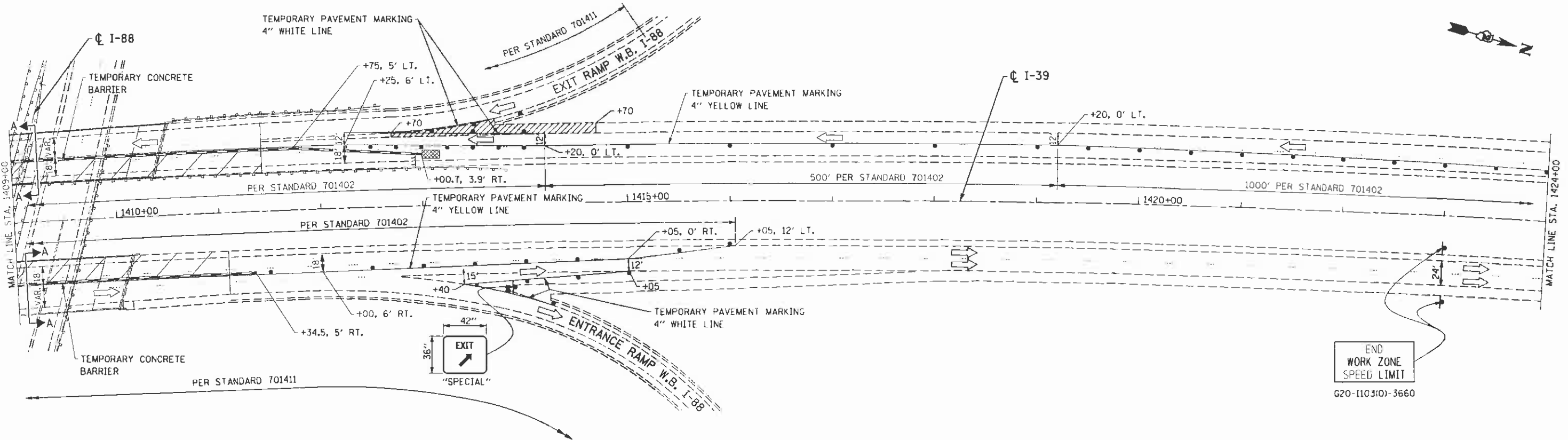

NOTES:

1. OUTSIDE SHOULDER REPAIR WORK SHALL CONSIST OF HMA SURFACE REMOVAL, 2" AND PLACEMENT OF SURFACE COURSE, MIX 'C', N50, 2".
2. OUTSIDE SHOULDER WORK SHALL BE CONSTRUCTED UTILIZING LANE CLOSURE STANDARD 701401, "LANE CLOSURE, FREEWAY/EXPRESSWAY".
3. BARRIER WALL OFFSETS ARE TO THE TRAFFIC SIDE OF THE WALL.
4. LEFT/RIGHT OFFSETS ARE FROM THE CENTERLINE OF EACH DIRECTION OF TRAFFIC, NOT FROM CENTERLINE OF ROADWAY.
5. FOR SECTION A-A SEE SHEET NO. 8.

LEGEND

- PROPOSED HMA SURFACE REMOVAL, 2" HMA SURFACE COURSE, MIX 'C', N50, 2"
- TEMPORARY CONCRETE BARRIER
- IMPACT ATTENUATOR, TEMPORARY (NON-REDIRECTIVE) TEST LEVEL 3
- TRAFFIC FLOW ARROW
- WORK ZONE
- DRUMS SPACED AT INTERVALS AS NOTED
- TEMPORARY SIGN WITH MESSAGE
- TYPE III BARRICADES

END
WORK ZONE
SPEED LIMIT
G20-110310-3660

MOT 02

FILE NAME : aht-stage1.B2.dgn
PLOT DATE : 8/7/2012
PLOT SCALE : 58.8000 / IN.

CR
CHRISTIAN-ROGE & ASSOCIATES INC.
ENGINEERS-PLANNERS-SURVEYORS
211 WEST WACKER DRIVE
CHICAGO, ILLINOIS 60606
PHONE: (312)372-2023 FAX: (312)372-5274

DESIGNED -	E.M.	REVISED -	
DRAWN -	B.K.	REVISED -	
CHECKED -	G.F.L.	REVISED -	
DATE -	AUGUST 2012	REVISED -	

STATE OF ILLINOIS
DEPARTMENT OF TRANSPORTATION

TRAFFIC CONTROL AND PROTECTION			
I-39 OVER I-88			
STAGE I			
SCALE:	SHEET NO.	OF SHEETS	STA. TO STA.

F.A.I. RTE.	SECTION	COUNTY	TOTAL SHEETS	SHEET NO.
39	D2 DECK REPAIR 2013-1	OGLE	32	9
FED. ROAD DIST. NO. 1 ILLINOIS FED. AID PROJECT				CONTRACT NO. 64H73