

| | |
|---------------|--|
| DATE | |
| BY | |
| SUPERVISED | |
| PLOTTED | |
| TEMPERATURE | |
| AREAS CHECKED | |
| NO. | |

| | |
|---------------|--|
| DATE | |
| BY | |
| SUPERVISED | |
| PLOTTED | |
| TEMPERATURE | |
| AREAS CHECKED | |
| NO. | |

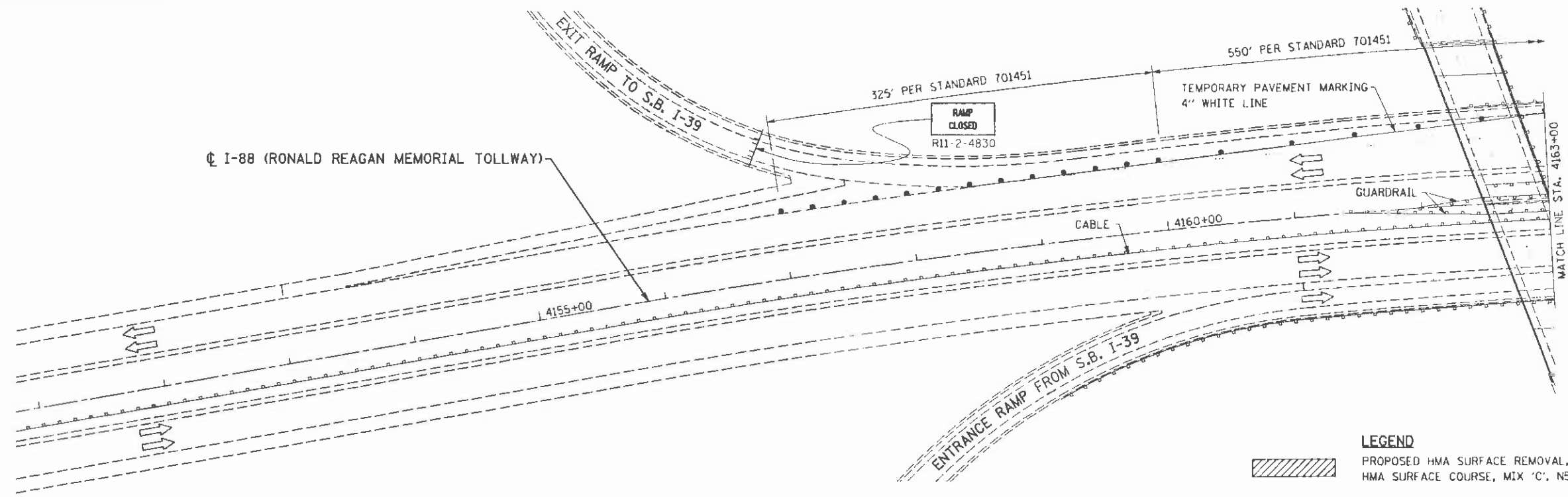

TRAFFIC CONTROL ON TOLLWAY

CONSTRUCTION

1. FULL DEPTH DECK REPAIR (SHIELDING), ABUTMENT AND PIER CONCRETE REPAIR.

MAINTENANCE OF TRAFFIC

1. USE TOLLWAY STANDARDS E-01, E-02, E-03 AND E-05 FOR LANE AND SHOULDER CLOSURES. THE M.O.T. REQUIRED WILL BE PAID FOR IN THE "MAINTENANCE OF TRAFFIC" ITEM.
2. USE IDOT STANDARD 701451 FOR RAMP CLOSURES.
3. FOR DETOUR ROUTING SEE SHEET NO. 7.

LEGEND

- PROPOSED HMA SURFACE REMOVAL, 2" HMA SURFACE COURSE, MIX 'C', N50, 2"
- TEMPORARY CONCRETE BARRIER
- RELOCATED IMPACT ATTENUATOR, TEMPORARY (NON-REDIRECTIVE) TEST LEVEL 3
- TRAFFIC FLOW ARROW
- WORK ZONE
- DRUMS SPACED AT INTERVALS AS NOTED
- TEMPORARY SIGN WITH MESSAGE

PORTABLE CHANGEABLE MESSAGE SIGN. SEE STANDARD E2-02.

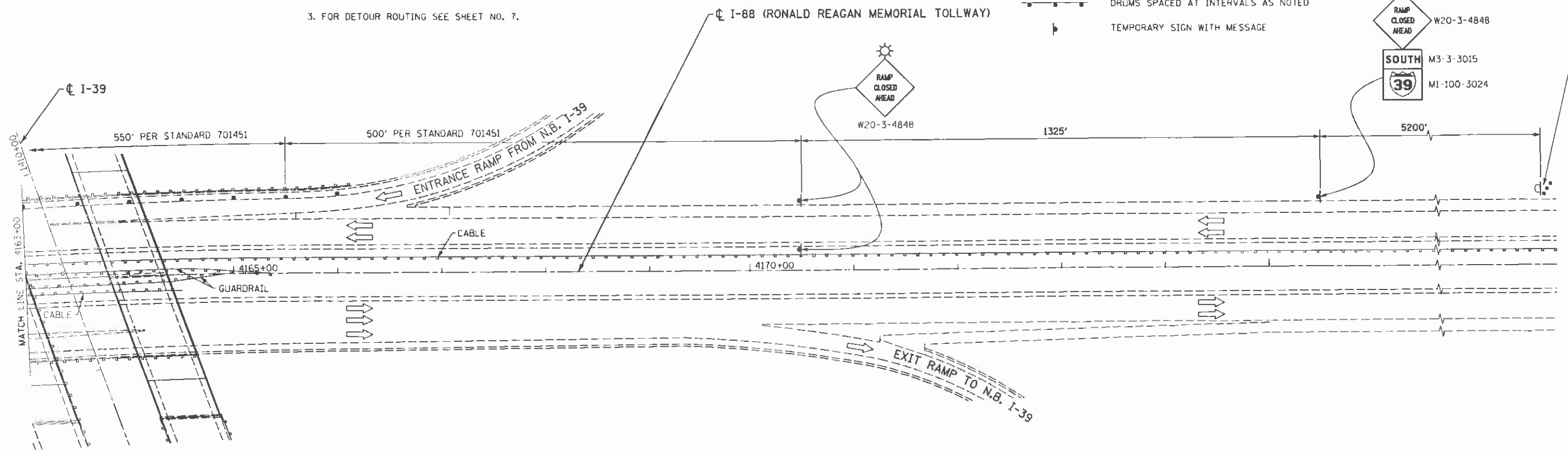

MOT-05

FILE NAME: hrt-stage2.03.dgn
 PLOT DATE: 8/7/2012
 PLOT SCALE: 50.0000' / IN.

CHRISTIAN-BOGE & ASSOCIATES, INC.
 ENGINEERS-PLANNERS-SURVEYORS
 211 WEST WACKER DRIVE
 CHICAGO, ILLINOIS 60606
 PHONE: (312)372-2023 FAX: (312)372-5274

| | |
|--------------------|-----------|
| DESIGNED - E.M. | REVISED - |
| DRAWN - B.K. | REVISED - |
| CHECKED - G.F.L. | REVISED - |
| DATE - AUGUST 2012 | REVISED - |

STATE OF ILLINOIS
DEPARTMENT OF TRANSPORTATION

TRAFFIC CONTROL AND PROTECTION
I-88 UNDER I-39 RAMP CLOSURE
STAGE II

SCALE: SHEET NO. OF SHEETS STA. TO STA.

| F.A.I. RTE. | SECTION | COUNTY | TOTAL SHEETS | SHEET NO. |
|--------------------|-----------------------|--------|---|-----------|
| 39 | D2 DECK REPAIR 2013-1 | OGLE | 32 | 12 |
| CONTRACT NO. 64H73 | | | FED. ROAD DIST. NO. 1 ILLINOIS FED. AID PROJECT | |