

F.A.P. RTE.	SECTION	COUNTY	TOTAL SHEETS	SHEET NO.
603	(50-6HB-1)I-1	LASALLE	13	1
ILLINOIS			CONTRACT NO. 66C38	

INDEX OF SHEETS

1. COVER SHEET
2. GENERAL NOTES
3. SUMMARY OF QUANTITIES
- 4 - 5. TYPICAL SECTIONS
- 6 - 8. SCHEDULES
- 9 - 10. PAVEMENT MARKINGS
11. ROADWAY PLAN
12. CONSTRUCTION DETAILS - RAMP A
13. CONSTRUCTION DETAILS - RAMP C

STANDARDS

000001-06	STANDARD SYMBOLS, ABBREVIATIONS AND PATTERNS
001006	DECIMAL OF AN INCH AND OF A FOOT
420001-07	PAVEMENT JOINTS
420601-05	24' (7.2 m) PCC PAVEMENT
420701-02	PAVEMENT FABRIC
442101-07	CLASS B PATCHES
701006-03	OFF-ROAD OPERATIONS 2L, 2W, 15' (4.5 m) TO 24" (600 mm) FROM PAVEMENT EDGE
701301-04	LANE CLOSURE, 2L, 2W, SHORT TIME OPERATIONS
701456-02	PARTIAL EXIT RAMP CLOSURE FREEWAY/EXPRESSWAY
701901-02	TRAFFIC CONTROL DEVICES

**STATE OF ILLINOIS
DEPARTMENT OF TRANSPORTATION
DIVISION OF HIGHWAYS**

**PROPOSED
HIGHWAY PLANS**

**F.A.P. ROUTE 603 (US 52)
SECTION (50-6HB-1)I-1**

**PAVEMENT PATCHING & REPLACEMENT
US 52 AND I-39 INTERCHANGE
LASALLE COUNTY**

C-93-135-12

D-93-002-12



BEGIN PROJECT
FAP 603 (US 52)
0.47 MILES WEST OF I-39
(STA. 202+00)

END PROJECT
FAP 603 (US 52)
0.35 MILES EAST OF I-39
(STA. 247+00)

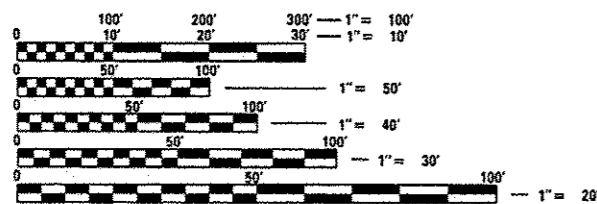
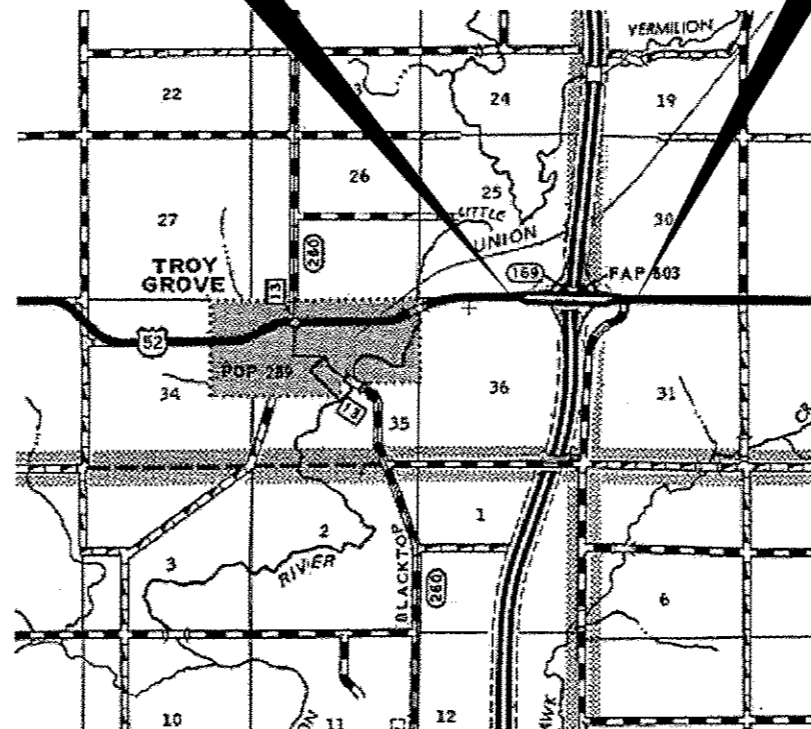

FULL SIZE PLANS HAVE BEEN PREPARED USING STANDARD ENGINEERING SCALES. REDUCED SIZED PLANS WILL NOT CONFORM TO STANDARD SCALES. IN MAKING MEASUREMENTS ON REDUCED PLANS, THE ABOVE SCALES MAY BE USED.

J.U.L.I.E.
JOINT UTILITY LOCATION INFORMATION FOR EXCAVATION
1-800-892-0123
OR 811

DISTRICT 3 NO. (815)-434-6131

PROJECT ENGINEER JOE KANNEL P.E.
UNIT CHIEF RON WOODSHANK
TOWNSHIP TROY GROVE. OPHIR

CONTRACT NO. 66C38

GROSS LENGTH = 4500.00 FT. = 0.852 MILE
NET LENGTH = 894.00 FT. = 0.169 MILE

RURAL	
MINOR ARTERIAL	
FAP 603 (US 52)	
2011	
ADT	1850
P.V.	79.73%
S.U.	8.11%
M.U.	12.16%

STATE OF ILLINOIS
DEPARTMENT OF TRANSPORTATION
DIVISION OF HIGHWAYS

SUBMITTED 7-9 2012
Carl S. Peralta
DEPUTY DIRECTOR OF HIGHWAYS, REGION ENGINEER

August 17 2012
John D. Salamelli, P.E.
ENGINEER OF DESIGN AND ENVIRONMENT

August 17 2012
William R. Freese
DIRECTOR OF HIGHWAYS, CHIEF ENGINEER

**PRINTED BY THE AUTHORITY
OF THE STATE OF ILLINOIS**