

PLAN	SURVEYED	BY	DATE
	PLOTTED		
	ALIGNED		
	CHECKED		
	FILED		
	NO.		

PROFILE	SURVEYED	BY	DATE
	PLOTTED		
	GRADES		
	CHECKED		
	STRUCTURE		
	NOT AT THIS OFFICE		
	NO.		

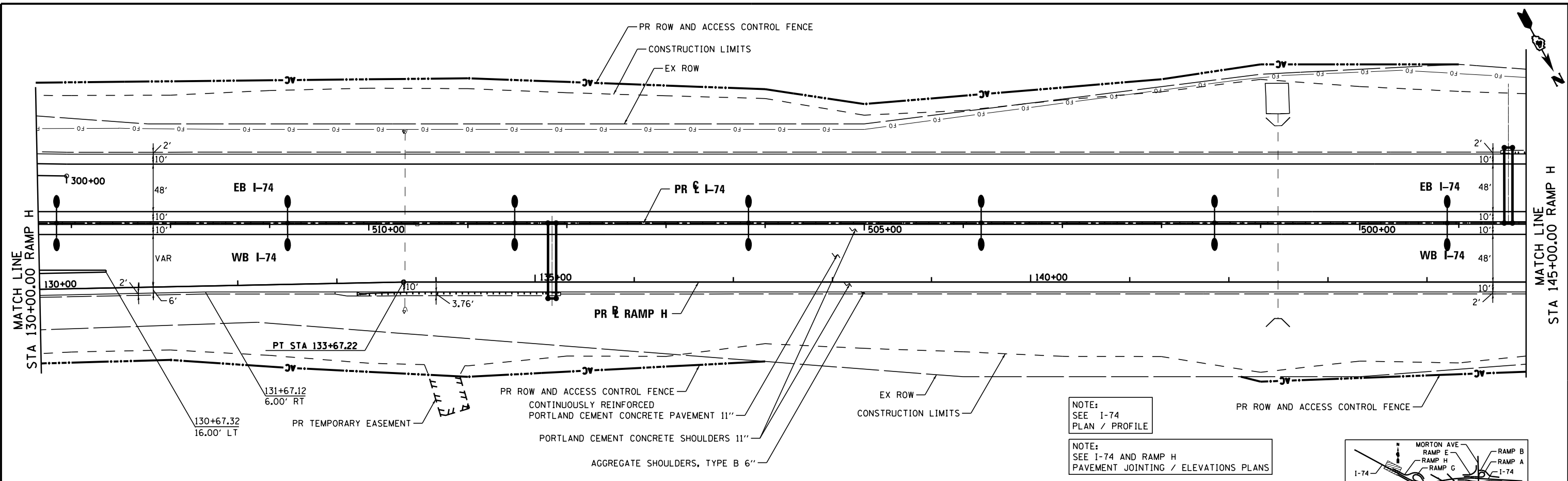

NOTE:  
SEE I-74  
PLAN / PROFILE

NOTE:  
SEE I-74 AND RAMP H  
PAVEMENT JOINTING / ELEVATIONS PLANS

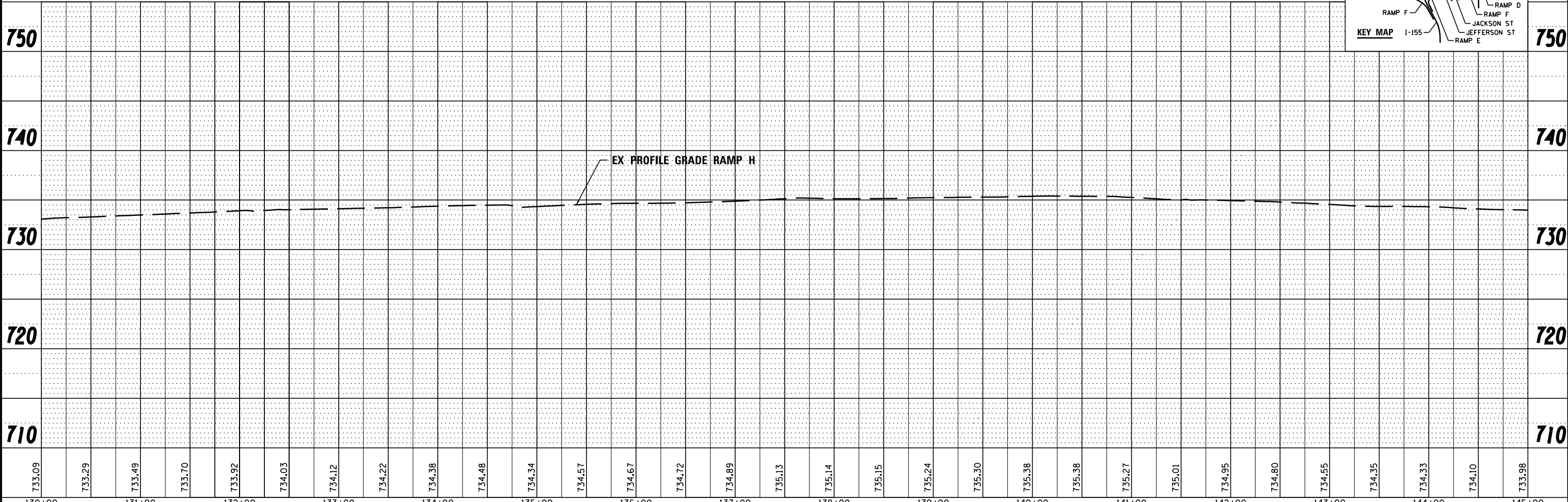
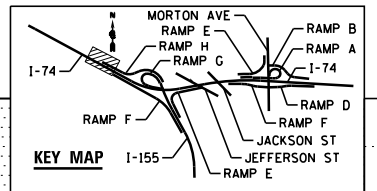

733.09	733.29	733.49	733.70	733.92	734.03	734.12	734.22	734.38	734.48	734.34	734.57	734.67	734.72	734.89	735.13	735.14	735.15	735.24	735.50	735.38	735.38	735.27	735.01	734.95	734.80	734.55	734.35	734.33	734.10	733.98	
130+00	131+00	132+00	133+00	134+00	135+00	136+00	137+00	138+00	139+00	140+00	141+00	142+00	143+00	144+00	145+00																

FILE NAME -	DESIGNED - AJP	REVISED -
...D468620-sh1-1-155-RampH-plnprf28.dgn	DRAWN - TMB	REVISED -
USER NAME = tblank	CHECKED - JNR	REVISED -
PLOT DATE = 7/17/2012	DATE - JULY 20, 2012	REVISED -



STATE OF ILLINOIS  
DEPARTMENT OF TRANSPORTATION

PLAN AND PROFILE  
I-155 RAMP H  
SCALE: 1"=50' SHEET NO. 12 OF 13 SHEETS STA. 128+00.00 TO STA. POE

F.A.I. RTE.	SECTION	COUNTY	TOTAL SHEETS	SHEET NO.
90-[14R(14HB-4,14,14HVB)BR]		TAZEWELL	2433	234
CONTRACT NO. 68620			ILLINOIS FED. AID PROJECT	