

**PAVEMENT MARKING LEGEND**

- ① EXISTING PAVEMENT MARKING
  - ② TEMPORARY PAVEMENT MARKING FROM PREVIOUS STAGE
  - ③ PROPOSED PAVEMENT MARKING IN PLACE (SEE PROPOSED PAVEMENT MARKING PLAN)
  - T PAVEMENT MARKING TAPE, TYPE III
  - P POLYUREA PAVEMENT MARKING TYPE II
- |       |   |      |                                |
|-------|---|------|--------------------------------|
| 4SW   | 4" SOLID WHITE                          | 8SW  | 8" SOLID WHITE                 |
| 4SY   | 4" SOLID YELLOW                         | 12SW | 12" SOLID WHITE @ 20' SPACING  |
| 4SY Y | 4" SOLID DOUBLE YELLOW (11" C-C)        | 12SY | 12" SOLID YELLOW @ 20' SPACING |
| 4KW   | 4" SKIP-DASH WHITE (30' SKIP, 10' DASH) | 24SW | 24" SOLID WHITE STOP BAR       |
| 4DW   | 4" DOTTED WHITE (9' SKIP, 3' DASH)      | LSW  | LETTERS & SYMBOLS, WHITE       |

**LEGEND**

- DRUMS WITH STEADY BURNING WARNING LIGHTS
  - DIRECTION INDICATOR BARRICADE WITH STEADY BURN MONODIRECTIONAL LIGHT
  - VERTICAL DELINEATOR PANELS
  - BARRICADE, TYPE III
  - FLASHING ARROW BOARD
  - DIRECTION OF TRAFFIC FLOW
  - IMPACT ATTENUATOR, TEMPORARY (NON-REDIRECTIVE)
  - IMPACT ATTENUATOR, TEMPORARY (NARROW, REDIRECTIVE)
  - TCP SIGN INCLUDED IN TRAFFIC CONTROL & PROTECTION (SEE SIGN SCHEDULE)
- TEMPORARY PAVEMENT CONSTRUCTION
  - ON-GOING EARTHWORK FOR PROPOSED PAVEMENT
  - PROPOSED PAVEMENT CONSTRUCTION
  - TEMP PVMT REMOVAL (SEE REMOVAL PLAN FOR EX PVMT REMOVAL)
  - REM TEMP AGGREGATE SHOULDERS
  - AGGREGATE SHOULDERS, TYPE B 6"
  - TEMPORARY CONCRETE BARRIER
  - TEMPORARY CONCRETE BARRIER WITH 36" GLARE SCREEN
  - SIGN REFERENCE NUMBER (SEE SIGN SCHEDULE)

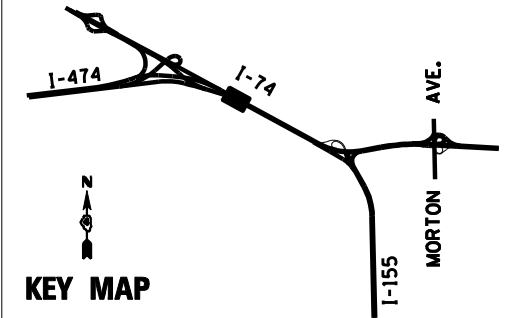
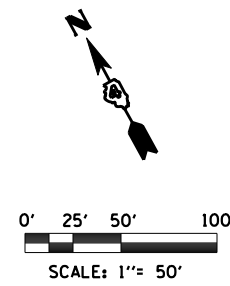

**BE PREPARED TO STOP**

W20-1908(O)-9636  
SIGN TO BE MOUNTED ON ARROW BOARD

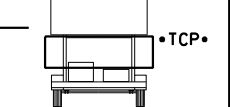

FLASHING ARROW BOARD IN "CAUTION" MODE  
STA. 470+00.00

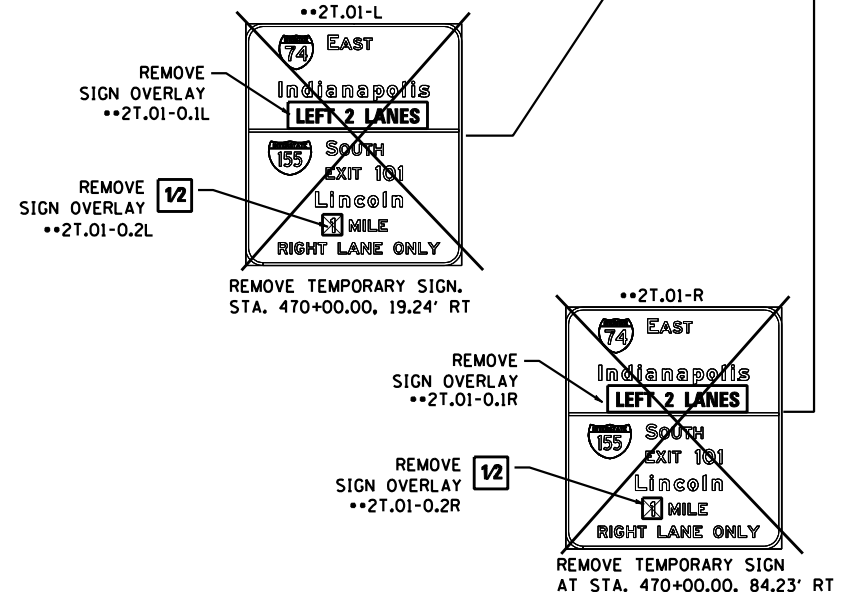
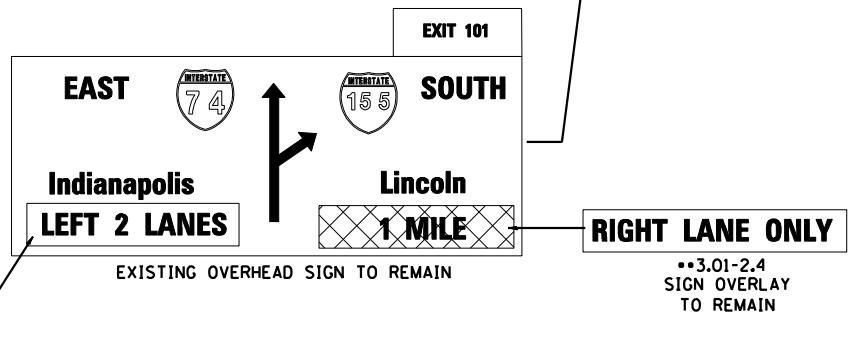
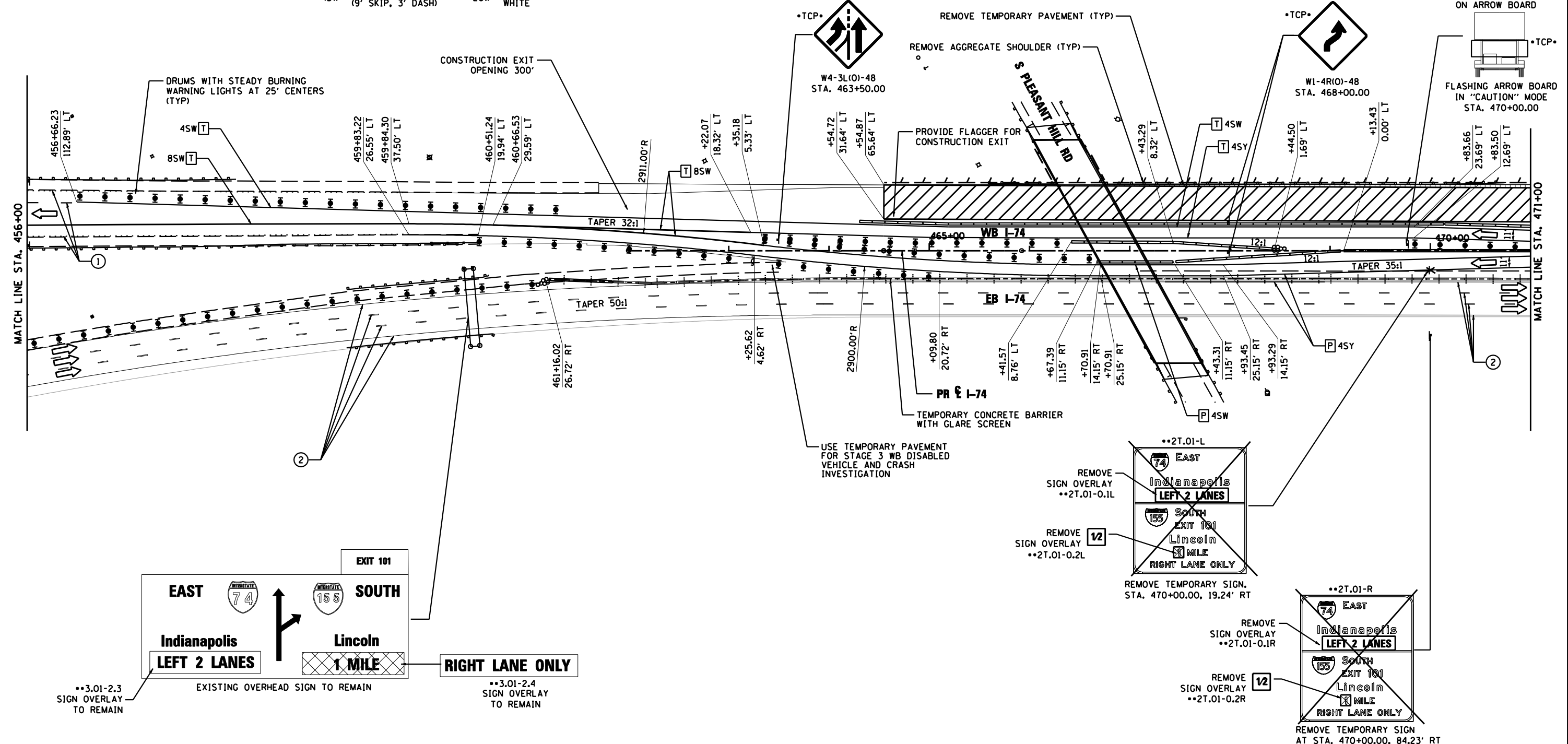

FILE NAME = D468620-sh1-staging03 174-03.dgn	DESIGNED - HTL	REVISED -		<b>STATE OF ILLINOIS</b> <b>DEPARTMENT OF TRANSPORTATION</b>	<b>MAINTENANCE OF TRAFFIC</b> <b>STAGE 3A</b>		F.A.I. RTE. = 90-[14R(14HB-4,14,14HB)BR]	COUNTY = TAZEWELL	TOTAL SHEETS = 2433	SHEET NO. = 615
USER NAME = TERRA	DRAWN - JPS	REVISED -			SCALE: SHEET NO. 9 OF 54 SHEETS	STA. 456+00 TO STA. 471+00	ILLINOIS FED. AID PROJECT		CONTRACT NO. 68620	
PLOT DATE = 7/16/2012	CHECKED - DA/LVA	REVISED -								
	DATE - 7/20/2012	REVISED -								