

**MAINTENANCE OF TRAFFIC
TYPICAL SECTION - STAGE 6
I-155**

STA 11+61 TO STA 36+74.80

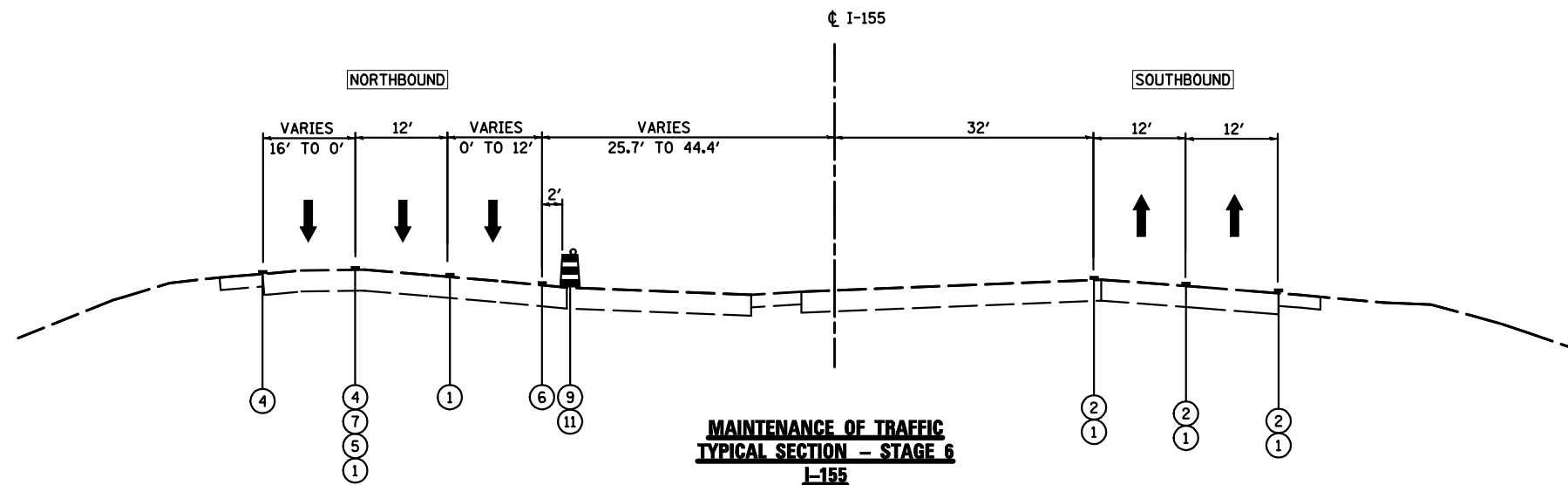

**MAINTENANCE OF TRAFFIC
TYPICAL SECTION - STAGE 6
I-155**

STA 36+74 TO STA 63+25

LEGEND:

- ① EXISTING PAVEMENT MARKING
 - ② TEMPORARY PAVEMENT MARKING FROM PREVIOUS STAGE
 - ③ PROPOSED PAVEMENT MARKING IN PLACE
 - ④ PAVEMENT MARKING, 4" SOLID WHITE
 - ⑤ PAVEMENT MARKING, 8" SOLID WHITE
 - ⑥ PAVEMENT MARKING, 4" SOLID YELLOW
 - ⑦ PAVEMENT MARKING, 4" DOTTED WHITE (3' SKIP, 9' DASH)
 - ⑧ PAVEMENT MARKING, 4" SKIP-DASH WHITE (30' SKIP, 10' DASH)
 - ⑨ DRUMS WITH STEADY BURNING WARNING LIGHTS AT 25' CENTERS
 - ⑩ DRUMS WITH STEADY BURNING WARNING LIGHTS AT 50' CENTERS
 - ⑪ DRUMS WITH STEADY BURNING WARNING LIGHTS AT 100' CENTERS
 - ⑫ DRUMS WITH STEADY BURNING WARNING LIGHTS 1000' CENTERS
 - ⑬ PAVEMENT MARKING, 4" SOLID DOUBLE YELLOW
 - ⑭ VERTICAL DELINEATOR PANELS
 - ⑮ TEMPORARY GEOTEXTILE RETAINING WALL
 - ⑯ PROPOSED CONCRETE BARRIER
 - ⑰ TEMPORARY CONCRETE BARRIER
 - ⑱ GLARE SCREEN
- PROPOSED PAVEMENT CONSTRUCTION
 - TEMPORARY PAVEMENT CONSTRUCTION
 - ON-GOING EARTHWORK FOR PROPOSED PAVEMENT

FILE NAME =	DESIGNED - HTL	REVISED - -
D468620-sh-typical N01-06.dgn	DRAWN - KV/JP	REVISED - -
USER NAME = TERRA	CHECKED - DA/LVA	REVISED - -
PLOT DATE = 7/16/2012	DATE - 7/20/2012	REVISED - -



**STATE OF ILLINOIS
DEPARTMENT OF TRANSPORTATION**

**MAINTENANCE OF TRAFFIC
STAGE 6 - TYPICAL SECTIONS - I-155**

SCALE: SHEET NO. 8 OF 18 SHEETS STA. TO STA.

F.A.I. RTE.	SECTION	COUNTY	TOTAL SHEETS	SHEET NO.
90-14R(14HB-4,14,14HB)BRJ	TAZEWELL	2433	851	
CONTRACT NO. 68620			ILLINOIS FED. AID PROJECT	