

PRIMARY OBJECTIVE

- RECONSTRUCT MORTON AVENUE BARRIER MEDIAN
- CONSTRUCT MORTON RAMP D SHOULDER
- CONSTRUCT GAPPED PORTIONS OF I-74 CONCRETE BARRIER MEDIANS
- REMOVE TEMPORARY MEDIAN CROSS-OVER PAVEMENTS FROM I-74

EMERGENCY TRAFFIC MANAGEMENT

- I-74 : USE AVAILABLE MEDIAN PAVEMENT SEPARATING LANES OR SHOULDERS EAST OF CONSTRUCTION ZONE
- MORTON : USE CRASH INVESTIGATION SITE UNTIL SUB-STAGE 14C



0' 250' 500' 1000'

SCALE: 1" = 500'

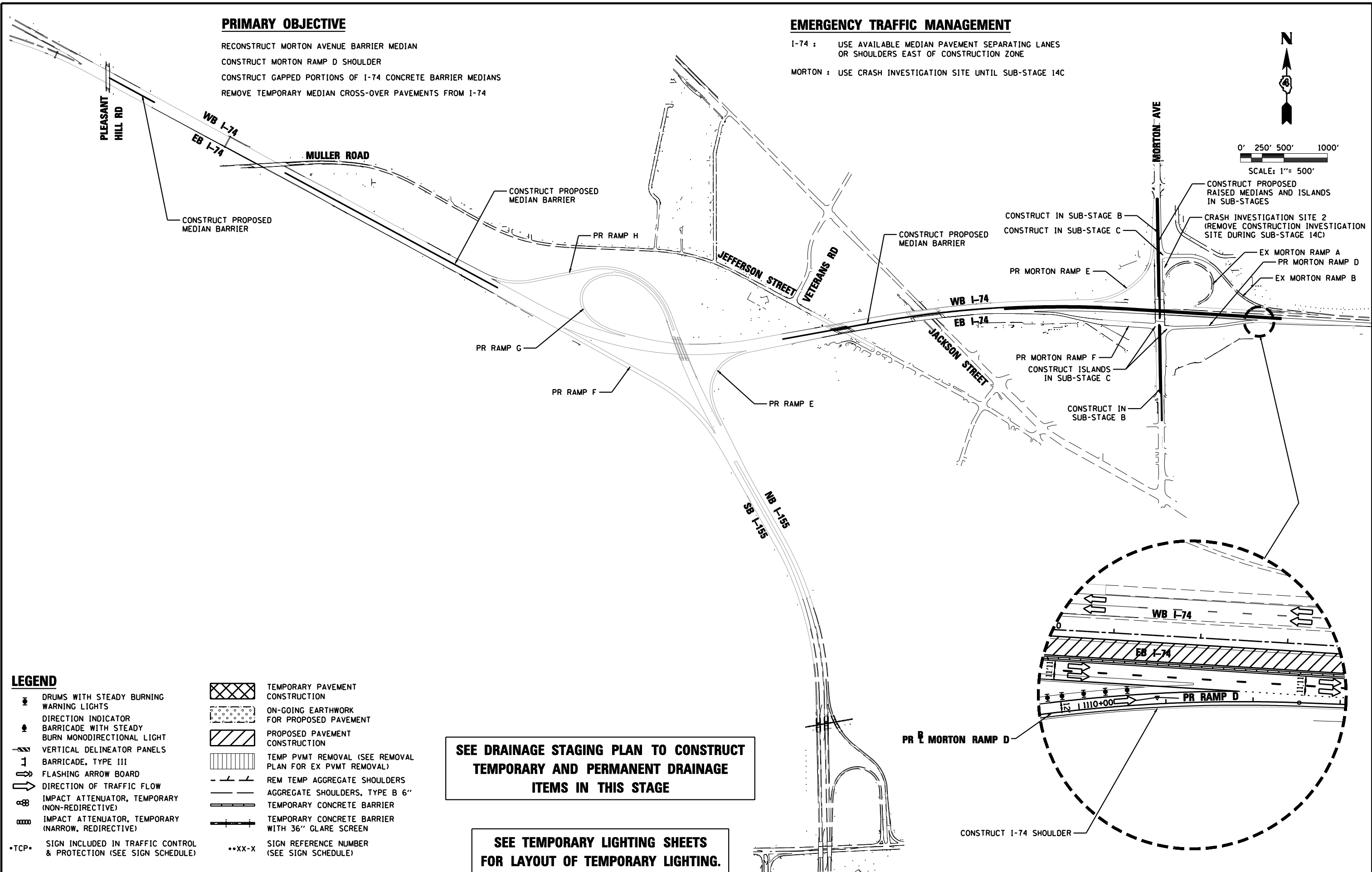

LEGEND

- DRUMS WITH STEADY BURNING WARNING LIGHTS
- DIRECTION INDICATOR
- BARRICADE WITH STEADY BURN MONODIRECTIONAL LIGHT
- VERTICAL DELINEATOR PANELS
- BARRICADE, TYPE III
- FLASHING ARROW BOARD
- DIRECTION OF TRAFFIC FLOW
- IMPACT ATTENUATOR, TEMPORARY (NON-REDIRECTIVE)
- IMPACT ATTENUATOR, TEMPORARY (NARROW, REDIRECTIVE)
- TCP SIGN INCLUDED IN TRAFFIC CONTROL & PROTECTION (SEE SIGN SCHEDULE)
- TEMPORARY PAVEMENT CONSTRUCTION
- ON-GOING EARTHWORK FOR PROPOSED PAVEMENT
- PROPOSED PAVEMENT CONSTRUCTION
- TEMP PVMT REMOVAL (SEE REMOVAL PLAN FOR EX PVMT REMOVAL)
- REM TEMP AGGREGATE SHOULDERS
- AGGREGATE SHOULDERS, TYPE B 6"
- TEMPORARY CONCRETE BARRIER
- TEMPORARY CONCRETE BARRIER WITH 36" GLARE SCREEN
- SIGN REFERENCE NUMBER (SEE SIGN SCHEDULE)

SEE DRAINAGE STAGING PLAN TO CONSTRUCT TEMPORARY AND PERMANENT DRAINAGE ITEMS IN THIS STAGE

SEE TEMPORARY LIGHTING SHEETS FOR LAYOUT OF TEMPORARY LIGHTING.

FILE NAME =	DESIGNED - HTL	REVISED -
D468620-sh1-p1en-14.dgn	DRAWN - JP	REVISED -
USER NAME = TERRA	CHECKED - DA/LVA	REVISED -
PLOT DATE = 7/16/2012	DATE - 7/20/2012	REVISED -



**STATE OF ILLINOIS
DEPARTMENT OF TRANSPORTATION**

**MAINTENANCE OF TRAFFIC
STAGE 14 SCHEMATIC DRAWINGS**

SCALE: SHEET NO. 1 OF 31 SHEETS STA. TO STA.

F.A.I. RTE.	SECTION	COUNTY	TOTAL SHEETS	SHEET NO.
• 90-[14R(14HB-4,14,14HB)BR]		TAZEWELL	2433	1251
CONTRACT NO. 68620				
ILLINOIS FED. AID PROJECT				