



S-C15-1.0-DN
 DR STR FES 36
 STA 33+00.00, 125.0' LT
 INV EL 710.67

C15-1.0
 289.8' - 36" PIPE CULVERT @ 0.15%
 JACKED PIPE

SEE MORTON RAMP F GRADING PLANS
 FOR ADDITIONAL INFORMATION

MATCH LINE MORTON AVE STA. 33+00.00

PR & MORTON AVE

S-C15-1.0-UP
 DR STR FES 36
 STA 33+00.00, 144.0' RT
 INV EL 711.10

SEE MORTON RAMP D GRADING PLANS
 FOR ADDITIONAL INFORMATION

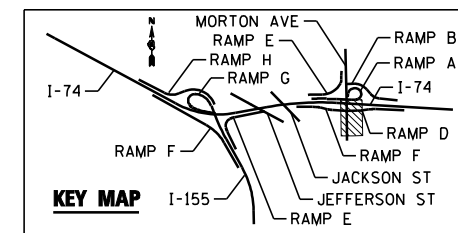

LEGEND:

	EXISTING AERIAL LINE		PROPOSED STORM SEWER
	EXISTING UNDERGROUND CABLE TV		PROPOSED PIPE UNDERDRAIN
	EXISTING UNDERGROUND ELECTRIC		PROPOSED STORM SEWER STRUCTURE CALLOUTS
	EXISTING UNDERGROUND FIBER OPTIC		PROPOSED STORM SEWER PIPE CALLOUTS
	EXISTING UNDERGROUND GAS LINE		SAG
	EXISTING UNDERGROUND SANITARY SEWER		SUMMIT
	EXISTING UNDERGROUND TELEPHONE		DITCH
	EXISTING UNDERGROUND WATER		SWALE
			MANHOLE

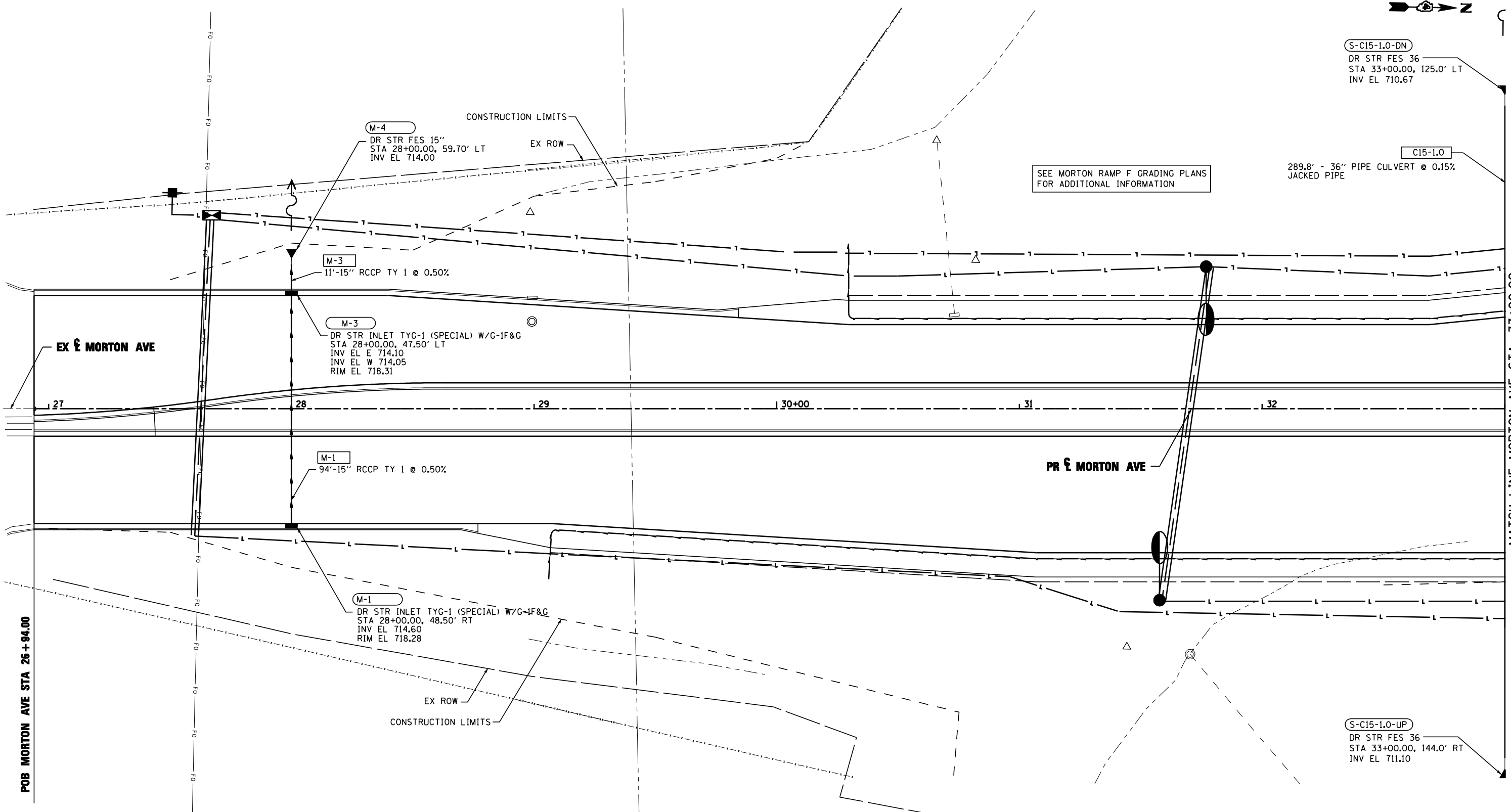

FILE NAME =	DESIGNED - I S	REVISED -		STATE OF ILLINOIS DEPARTMENT OF TRANSPORTATION	DRAINAGE AND UTILITY PLAN AND PROFILE MORTON AVE			F.A.I. SECTION COUNTY TOTAL SHEETS SHEET NO.
...\\D468620-shr-Mor-tonSc20-drain-plan29.dgn	DRAWN - TMB	REVISED -			90-114R(14HB-4,14,14HVB)BRJ TAZEWELL 2433 1438			
USER NAME = toddblank	CHECKED - JNR	REVISED -			SCALE: 1"=20'	SHEET NO. 1 OF 6 SHEETS	STA. POB TO STA. 33+00.00	CONTRACT NO. 68620
PLOT DATE = 7/17/2012	DATE - JULY 20, 2012	REVISED -						ILLINOIS FED. AID PROJECT